

CATALOG #	TYPE	
JOB NAME	WATTAGE	VOLTAGE

SmartLED™ MRI Lighting System

RGBW Shallow Lensed 4" Downlight

Create a patient-centric MRI experience with soothing, dynamic color scenes • Type IC

Specifications

Delivered System Performance

- Nominal lumens: **-750L**; see photometric data for specific color lumens
- Distribution: WFL
- Quad chip RGBW
- Fully sustainable: removable for servicing

Thermal Management System

- Aluminum heat sink and components for cool operation, long life, and low maintenance

SmartLED™ MRI Lighting System Required

- Kirlin DMX remote driver modules, cabinet, and RFI filters required for operation
- Components ordered separately, see [MRI-DMXPS](#)
- The [MRI Configurator](#) can help determine the necessary components

SmartLED™ Emergency Backup System

- [EMI-21220](#) or [EMI-03120](#) available for emergency power
- See specification sheet; order separately

Trim and Lens Assembly

- Tapered aluminum all white (field-paintable) smooth self-flanged trim
- Optional colors and finishes available
- Regressed tempered prismatic spread lens

Acrylic Enameled Aluminum Housing

- Rustproof and corrosion resistant: exceeds 1000 hour ASTM 5% salt spray test; all components fully sustainable
- Shallow depth for restricted plenums
- Cool operation extends component life
- Modular design; visible and fully serviceable through aperture
- Built-in plaster flange

Color & Controls

- Quad chip RGBW LEDs provide rich color palette for full spectrum expression
- DMX control via Kirlin DMX wall panel [MRI-DMXWP](#)
- Wall panel ships preloaded with standard scene configuration and presets - consult factory for custom programs

MRS-04345

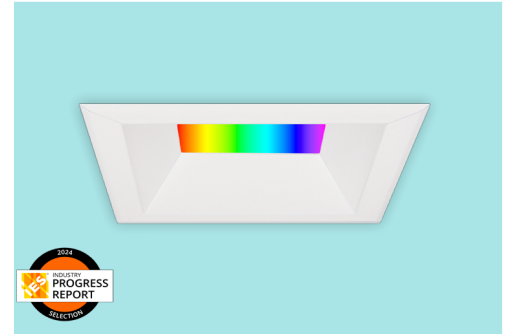

Installation & Hardware

- Requires minimum 18 AWG twisted pair shielded wire from SmartLED MRI driver modules, to filter, and included 35' RJ-45 cable from filter to luminaire
- Recesses in ceilings up to 1-1/4" thick or see Option -79
- Aluminum 27" hanger bars with adjustable mounting brackets (2) supplied.

UL, C-UL (Canada) Listings

- Wet, damp or dry locations, covered ceilings
- Type IC: for direct contact with insulation

IEC & FCC Compliance

- FCC Part 15 certified for EMI/RFI emissions

FIVE YEAR Limited Warranty

- Complete fixture, must be installed with all SmartLED™ components

Options and Ordering Configuration

(Example: MRS-04345-1500L-RGB4-BGT)

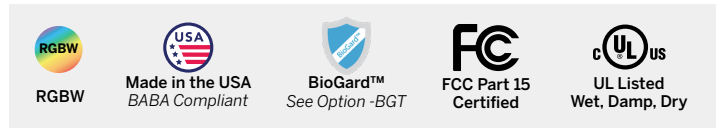

Must Specify			Optional	
Model	Lumens	CCT & CRI	Trim & Lens Options	Other Options
MRS-04345	-750L	-RGB4: RGB + 4000K 80+ CRI	<p>(Blank): White aluminum smooth self-flanged trim with lens above</p> <p>Trim Finishes</p> <ul style="list-style-type: none"> -BGT: BioGard anti-microbial white -BKBG: BioGard anti-microbial black -94: Custom color; consult factory -94BG: BioGard anti-microbial custom color finish <p>Other Trim Features</p> <ul style="list-style-type: none"> -32: White trim extender, specify OD -45: Gasket between trim flange and ceiling -46: Gasket between trim and lens <p>Lens Options</p> <ul style="list-style-type: none"> -21: White translucent flat poly diffuser instead -23: White Frosted micropismatic lens instead -WA: White acrylic (flat) diffuser instead; will produce wide flood distribution 	<p>(Blank): None</p> <p>Mounting</p> <ul style="list-style-type: none"> -79: Extension collar; ceilings up to 2" thick <p>Other Options</p> <ul style="list-style-type: none"> -99: Special modification; consult factory

Dimensions

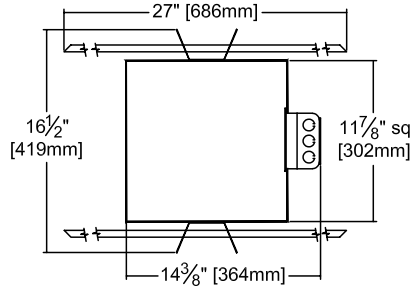
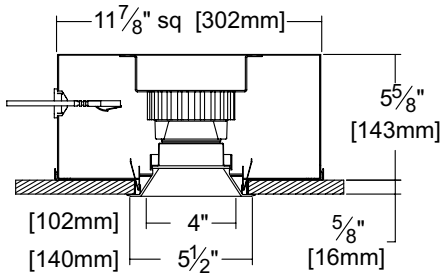

Ceiling Cut-out
5 1/4" Sq.

Photometry - Installed Complete Fixture

LM-79 IESNA Certified Photometry from Independent Lab

Photometry from I.T.L., Boulder, CO

▲ **Cone of Light Key**
Dia. (in ft.) shown is where FC value is half the FC at nadir.
Dist. Distance (Ft.) from fixture
FC Footcandles at nadir (0°)
Dia. Circle of light at 50% of FC

	<p>Lumens: LPW: Beam: SC: ITL Test:</p>
<p>-750L (ALL)</p>	<p>Total System Watts</p>
	<p>Lumens: LPW: Beam: SC: ITL Test:</p>
<p>-750L (WHITE)</p>	<p>Total System Watts</p>

TESTING UNDERWAY

*LED manufacturers maintain a tolerance of +/-7% on flux (lumens) and power (electrical) measurements.

LIMITED WARRANTY: CATALOGED KIRLIN FIXTURES ARE WARRANTED FREE OF DEFECTS IN WORKMANSHIP OR MATERIAL FOR FIVE YEARS FROM DATE OF PURCHASE. INSTALLED TO N.E.C. - IN NORMAL USE. Manufacturer at his option will replace or repair such fixture or refund the purchase price on presentation of proof of purchase and defective fixture at the offices of manufacturer within the years of original shipment. Liability of manufacturer is limited to the foregoing and manufacturer shall not be liable for any other damages, direct or indirect, sustained or suffered by purchaser or any person. This warranty is applied to the buyer in place of all other warranties, expressed or implied. Seller does not warrant as to merchantability or fitness for a particular use, nor will any oral statement constitute a warranty or amend this specific warranty. Abnormal use, abuse of the fixture, improper installation, or repair or modification of the fixture without prior written authorization from the manufacturer will render the warranty void.

SmartLED MRI
NOVEMBER 2024