

CATALOG #	TYPE	
JOB NAME	WATTAGE	VOLTAGE

SmartLED™ MRI Lighting System

4" RGBW Open Appearance Downlight

Create a patient-centric MRI experience with soothing, dynamic color scenes • Type IC

Specifications

Delivered System Performance

- Nominal lumens: **-750L**; see photometric data for specific color lumens
- Distribution: WFL
- Quad chip RGBW
- Fully sustainable: removable for servicing

Thermal Management System

- Aluminum heat sink and components for cool operation, long life, and low maintenance

SmartLED™ MRI Lighting System Required

- Kirlin DMX remote driver modules, cabinet, and RFI filters required for operation
- Components ordered separately, see [MRI-DMXPS](#)
- The [MRI Configurator](#) can help determine the necessary components

SmartLED™ Emergency Backup System

- [EMI-21220](#) or [EMI-03120](#) available for emergency power
- See specification sheet; order separately

Trim and Lens Assembly

- White enamel self-flanged, low glare cone with lens above
- Optional colors and finishes available

Acrylic Enameled Aluminum Housing

- Rustproof and corrosion resistant: exceeds 1000 hour ASTM 5% salt spray test; all components fully sustainable
- Shallow depth for restricted plenums
- Cool operation extends component life
- Modular design; visible and fully serviceable through aperture
- Built-in plaster flange

Color & Controls

- Quad chip RGBW LEDs provide rich color palette for full spectrum expression
- DMX control via Kirlin DMX wall panel [MRI-DMXWP](#)
- Wall panel ships preloaded with standard scene configuration and presets - consult factory for custom programs

MRR-04314

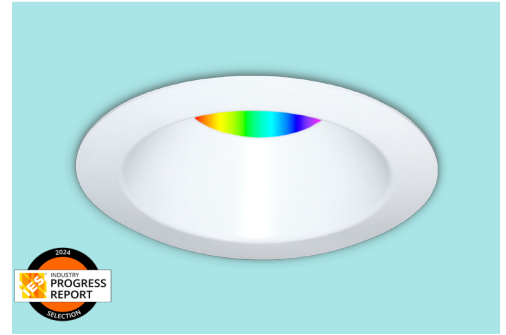

Installation & Hardware

- Requires minimum 18 AWG twisted pair shielded wire from SmartLED MRI driver modules, to filter, and included 35' RJ-45 cable from filter to luminaire
- Recesses in ceilings up to 1-1/8" thick or see Option -79
- Aluminum 27" hanger bars with adjustable mounting brackets (2) supplied.

UL, C-UL (Canada) Listings

- Wet, damp or dry locations, covered ceilings
- Type IC: for direct contact with insulation

IEC & FCC Compliance

- FCC Part 15 certified for EMI/RFI emissions

FIVE YEAR Limited Warranty

- Complete fixture, must be installed with all SmartLED™ components

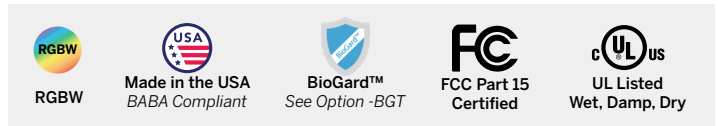

Options and Ordering Configuration

(Example: MRR-04314-1500L-RGB4-BGT)

Must Specify			Optional	
Model	Lumens	CCT & CRI	Trim & Lens Options	Other Options
MRR-04314				
	-750L	-RGB4: RGB + 4000K 80+ CRI	(Blank): All white acrylic enameled cone Trim Finishes -BGT: BioGard anti-microbial white -BKBG: BioGard anti-microbial black -94: Custom color; consult factory -94BG: BioGard anti-microbial custom color finish Other Trim Features -32: White trim extender, specify OD -45: Gasket between trim flange and ceiling Lens Options -23: Frosted micropismatic lens instead -WA: White acrylic (flat) diffuser instead; will produce wide flood distribution	(Blank): None Mounting -79: Extension collar; ceilings up to 2" thick Other Options -99: Special modification; consult factory

Dimensions

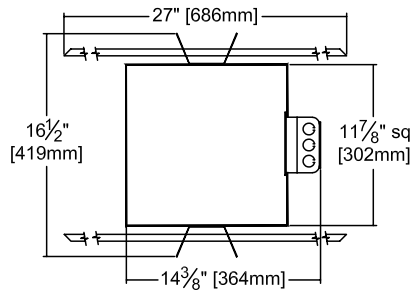
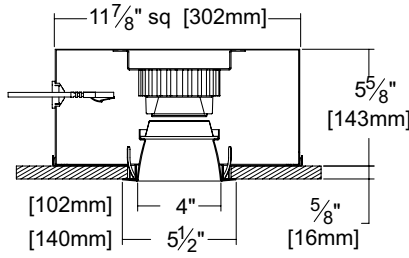

Ceiling Cut-out
5" Dia.

Photometry - Installed Complete Fixture

Photometry from UL Verification Services, Allentown, PA

LM-79 IESNA Certified Photometry from Independent Lab

▲ **Cone of Light Key**
Dia. (in ft.) shown is where FC value is half the FC at nadir.
Dist. Distance (Ft.) from fixture
FC Footcandles at nadir (0°)
Dia. Circle of light at 50% of FC

	<p>Lumens: LPW: Beam: SC: UL Test:</p>	<p>-750L (ALL)</p>	<p>Total System Watts</p>
	<p>Lumens: LPW: Beam: SC: UL Test:</p>	<p>-750L (RED)</p>	<p>Total System Watts</p>

	<p>Lumens: LPW: Beam: SC: UL Test:</p>	<p>-750L (WHITE)</p>	<p>Total System Watts</p>
--	--	-----------------------------	---------------------------

TESTING UNDERWAY

*LED manufacturers maintain a tolerance of +/-7% on flux (lumens) and power (electrical) measurements.

LIMITED WARRANTY: CATALOGED KIRLIN FIXTURES ARE WARRANTED FREE OF DEFECTS IN WORKMANSHIP OR MATERIAL FOR FIVE YEARS FROM DATE OF PURCHASE. INSTALLED TO N.E.C. - IN NORMAL USE. Manufacturer at his option will replace or repair such fixture or refund the purchase price on presentation of proof of purchase and defective fixture at the offices of manufacturer within the years of original shipment. Liability of manufacturer is limited to the foregoing and manufacturer shall not be liable for any other damages, direct or indirect, sustained or suffered by purchaser or any person. This warranty is applied to the buyer in place of all other warranties, expressed or implied. Seller does not warrant as to merchantability or fitness for a particular use, nor will any oral statement constitute a warranty or amend this specific warranty. Abnormal use, abuse of the fixture, improper installation, or repair or modification of the fixture without prior written authorization from the manufacturer will render the warranty void.

SmartLED MRI
NOVEMBER 2024