

| | | |
|-----------|---------|---------|
| CATALOG # | TYPE | |
| JOB NAME | WATTAGE | VOLTAGE |

Symphony Remote Driver Series

Open Appearance 4" Square • LED

Up to 60,000 Hour Life (L70) • Type IC • Wet Location

LM-80 Qualified • LM-79 Certified Photometry

SRS-04640



Specifications

Delivered System Performance

- Lumen Series: **Must Specify**
- 2500L: 2500 nominal lumens (35W)
- Distribution: MFL standard; Optional: -SPT or -NFL
- Color temperature: 3500°K standard; Optional: -27K, -30K, -41K or -50K
- CRI: 80+ standard; Optional: -HC (90+)
- 60,000 hour life (L70)
- Fully sustainable: removable for servicing

Thermal Management System

- All aluminum heat sink, components and housing maximize cool operation and long life while minimizing maintenance

Remote Power Supply Required

- For 0-10V use **SYM-CABNT**
- For DMX with RDM use **SYM-DMXPS**

SmartPower™ Battery Backup

- EMI-21220** for emergency power
- See specification sheet; order separately

Trim

- Clear specular aluminum trim
- Self-flanged, low glare square; prismatic spread lens above
- Optional colors and finishes available

Acrylic Enameled Aluminum Housing

- Rustproof and corrosion resistant: Exceeds 1000 hour ASTM 5% salt spray test
- Shallow depth fits restricted plenums
- Cool operation: Extends life of all components
- Fully sustainable: Entire luminaire, including LED light engine, is modular, easily visible and serviced through aperture
- Built-in plaster flange

Outlet Box

- UL listed J-box with insulated removable cover; prewired 14 GA (NEC) with ½" and ¾" knockouts

Installation

- Requires minimum 16 AWG shielded twisted pair wire from SmartDMX™ to fixtures
- Maximum cable run from driver to fixture is 250'**

- Recess indoor or outdoor
- Accommodates ceilings up to 1¼" thick or see Option -79
- Compatible with fire rated enclosures (by others)
- 27" galvanized hanger bars with adjustable mounting brackets (2) supplied

UL, C-UL (Canada) Listings

- Wet, damp or dry locations, covered ceilings
- Type IC: for direct contact with insulation

FCC Compliance

- FCC Part 15 certified for EMI/RFI emissions

FIVE YEAR Limited Warranty

Complete standard fixture (must be used with SYM-CABNT or SYM-DMXPS)



Options and Ordering Configuration

(Example: SRS-04640-2500L-HC-70T-AT)

| Must Specify | | Optional | | | |
|--------------|--------|---|---|--|--|
| Model | Lumens | Color Temp. (CCT) | Distribution | Lens & Trim | Other Options |
| SRS-04640 | | | | | |
| | -2500L | (Blank): 3500°K -27K: 2700°K instead -30K: 3000°K instead -41K: 4100°K instead -50K: 5000°K instead -HC: 90+ CRI instead | (Blank): MFL -NFL: Narrow flood distribution -SPT: Spot distribution | (Blank): Clear specular trim; lens above -30T: White enamel (complete trim) -30F: White enamel (flange only) -32: White oversize trim ring; specify O.D. -33: Tempered glass Glow Ring suspended beneath trim; shape -37F: Dark bronze enamel (flange only) -38F: Black enamel (flange only) -45: Gasket between trim flange and ceiling -70T: Clear semi-specular SofTex™ (complete trim) -94: Custom color/finish; specify; consult factory -CF: Custom color filter (Rosco); specify | (Blank): None -79: Extension collar for ceilings up to 2" thick -99: Special modification; consult factory -AT: Air tight version; meets ASTM E283 restricted airflow of 2 CFM maximum -DL: Downlight square trim instead; clear specular finish standard or add optional trim selection -RH: Residential mounting hardware instead; suitable for wood joist ceilings with spacing from 14 ½" to 25 ⅞" with ⅝" vertical adjustability |

Dimensions

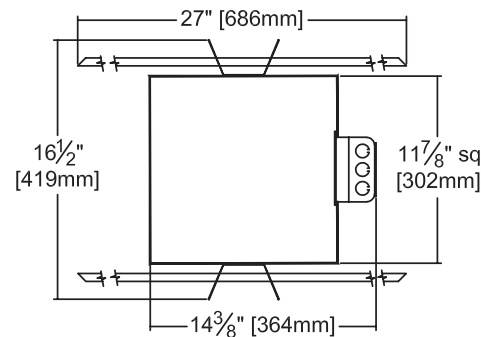
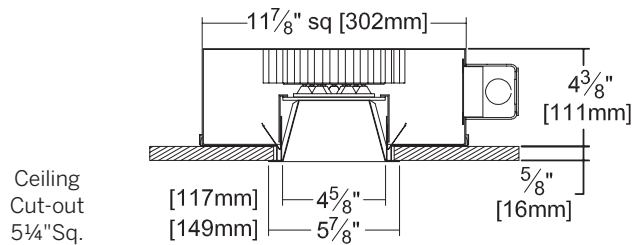

Photometry - Installed Complete Fixture

LM-79 IESNA Certified Photometry from Independent Lab

Photometry from UL Verification Services, Allentown, PA

-2500L STANDARD (MFL)

Lumens: 2944
Beam: ~43°
SC: 0.7
LPW: 80
Efficiency: 79.2%
UL Test: 1259197



Cone of Light ▲

| Dist. | FC | Dia. |
|-------|-------|------|
| 6 | 134.0 | 4.7 |
| 8 | 75.2 | 6.3 |
| 10 | 48.1 | 7.8 |
| 12 | 33.4 | 9.4 |
| 14 | 24.5 | 10.9 |
| 16 | 18.8 | 12.5 |

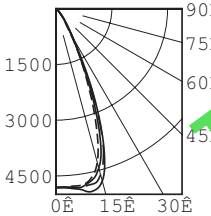

Total System Watts 36.6

| CANDLEPOWER DISTRIBUTION | | | | | |
|--------------------------|------|------|------|------|------|
| | 0.0 | 22.5 | 45.0 | 67.5 | 90.0 |
| 0 | 4811 | 4811 | 4811 | 4811 | 4811 |
| 5 | 4799 | 4846 | 4857 | 4824 | 4859 |
| 15 | 4282 | 4538 | 4803 | 4624 | 4638 |
| 25 | 3706 | 3777 | 2054 | 1903 | 1752 |
| 35 | 385 | 380 | 400 | 173 | 501 |
| 45 | 71 | 10 | 18 | 38 | 85 |
| 55 | 10 | 9 | 12 | 10 | 10 |
| 65 | 4 | 1 | 1 | 1 | 1 |
| 75 | 0 | 0 | 0 | 0 | 0 |
| 85 | 0 | 0 | 0 | 0 | 0 |
| 90 | 0 | 0 | 0 | 0 | 0 |

-2500L Option -SPT

Lumens: 3016
Beam: ~16°
SC: 0.3
LPW: 82
Efficiency: 81.1%
UL Test: 1259196



Cone of Light ▲

| Dist. | FC | Dia. |
|-------|-------|------|
| 6 | 626.0 | 1.7 |
| 8 | 352.0 | 2.3 |
| 10 | 225.0 | 2.9 |
| 12 | 157.0 | 3.5 |
| 14 | 115.0 | 4.0 |
| 16 | 88.0 | 4.6 |

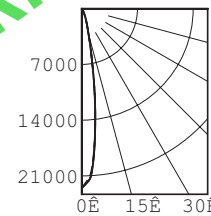

Total System Watts 36.6

| CANDLEPOWER DISTRIBUTION | | | | | |
|--------------------------|-------|-------|-------|-------|-------|
| | 0.0 | 22.5 | 45.0 | 67.5 | 90.0 |
| 0 | 22540 | 22540 | 22540 | 22540 | 22540 |
| 5 | 17780 | 17940 | 17920 | 17970 | 18040 |
| 15 | 3487 | 3365 | 3339 | 3262 | 3300 |
| 25 | 825 | 902 | 1032 | 782 | 715 |
| 35 | 192 | 213 | 280 | 255 | 198 |
| 45 | 43 | 56 | 69 | 58 | 50 |
| 55 | 5 | 5 | 5 | 4 | 4 |
| 65 | 2 | 1 | 1 | 1 | 1 |
| 75 | 1 | 1 | 1 | 1 | 0 |
| 85 | 1 | 1 | 1 | 1 | 1 |
| 90 | 2 | 1 | 1 | 1 | 1 |

-2500L Option -NFL

Lumens: 2753
Beam: ~30°
SC: 0.5
LPW: 75
Efficiency: 74.1%
UL Test: 1264621



Cone of Light ▲

| Dist. | FC | Dia. |
|-------|-------|------|
| 6 | 197.0 | 3.2 |
| 8 | 111.0 | 4.3 |
| 10 | 71.0 | 5.4 |
| 12 | 49.3 | 6.5 |
| 14 | 36.2 | 7.5 |
| 16 | 27.7 | 8.6 |

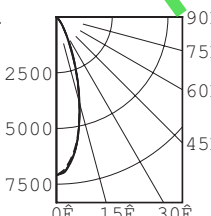

Total System Watts 36.5

| CANDLEPOWER DISTRIBUTION | | | | | |
|--------------------------|------|------|------|------|------|
| | 0.0 | 22.5 | 45.0 | 67.5 | 90.0 |
| 0 | 7099 | 7099 | 7099 | 7099 | 7099 |
| 5 | 6533 | 6581 | 6615 | 6643 | 6663 |
| 15 | 3935 | 3956 | 3959 | 3958 | 4008 |
| 25 | 1484 | 1472 | 1555 | 1423 | 1363 |
| 35 | 417 | 423 | 423 | 473 | 477 |
| 45 | 86 | 114 | 123 | 108 | 102 |
| 55 | 8 | 8 | 10 | 9 | 9 |
| 65 | 1 | 1 | 1 | 1 | 1 |
| 75 | 0 | 0 | 0 | 0 | 0 |
| 85 | 0 | 0 | 0 | 0 | 0 |
| 90 | 0 | 0 | 0 | 0 | 0 |

▲ **Cone of Light Key**
Dia. (in ft.) shown is where FC value is half the FC at nadir.

Dist. Distance (Ft.) from fixture
FC Footcandles at nadir (0°)
Dia. Circle of light at 50% of FC

LED manufacturers maintain a tolerance of +/-7% on flux (lumens) and power (electrical) measurements.