

CATALOG #	TYPE	
JOB NAME	WATTAGE	VOLTAGE

Choice Series

IP65 Rated 7" Downlight • COB LED

50,000+ Hours • High Output • 1.0% Dimming, 0-10V

2 or 3 Step Binning • Wet Listed • LM-80 and LM-79 Certified

Specifications

Delivered System Performance

- Nominal Lumens: **Must Specify**

Type IC	Non-IC
-4000L	-7000L
-3000L	-6000L
-2500L	-5000L
-2000L	
-1500L	
-1000L	

- Select trim & beam distribution: see chart
- Select color (CCT): see chart; 80+ CRI standard; Option -HC for 90+ (15% lumen loss)
- 60,000 hour life, 50,000 in insulation (L70)

Thermal Management System

- Aluminum heat sink and components for cool operation, long life, and low maintenance

LED Driver - INTERNAL

- Indoor/Outdoor: -30°C to 60°C (-22°F to 140°F)
- 0-10V CCR 1.0% dimming standard
- Voltage Options: **Must Specify**
- 120: -120V (50-60Hz); load insensitive
- 277: -277V (50-60Hz); load insensitive

Trim Assembly/Optics

- Smooth tapered self-flanged aluminum trim (-RWF is field paintable)
- Standard diffuse acrylic above 0.125" clear polycarbonate; also see option -WA

IP65 Sealed & Gasketed Trim

- Liquid silicone seals between trim and lens
- Closed cell flange gasket seals trim to ceiling
- U-channel gasket seals trim to housing
- O-rings seal stainless fasteners to trim
- Meets ASTM E283 restricted airflow of 2 CFM

Acrylic Enamelled Aluminum Housing

- Rustproof: Exceeds 1000 hour ASTM 5% salt spray test; all components fully sustainable
- Shallow depth for restricted plenums
- Cool operation extends component life
- Modular design; visible and fully serviceable through aperture

LRC-07IPD

Trim Options



-RWF

Outlet Box (Galvanized)

- UL Listed, 14GA, insulated, removable cover
- 1/2" and 3/4" knockouts
- Up to 4 #12 AWG through-branch conductors

Installation & Hardware

- Indoor/outdoor in ceilings up to 1 1/8" thick
- Compatible with fire rated enclosures (by others)
- 27" hanger bars & adjusting brackets (2) supplied

UL, C-UL (Canada) & FCC Compliance

- UL Listed: wet, damp or dry locations, covered ceilings
- Type IC up to -4000L; Non-IC at -5000L+
- FCC Part 15 certified for EMI/RFI emissions

FIVE YEAR Limited Warranty

- Complete standard fixture

Declare.

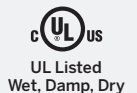

Dimensions

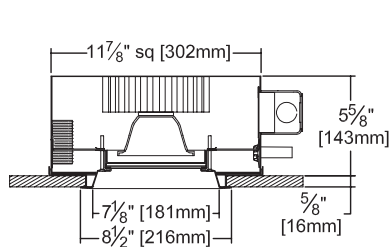

Ceiling Cut-Out

8 1/4" Dia. (-RWF)

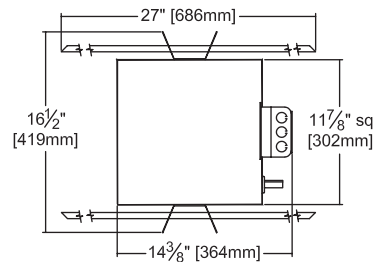

Available Source Options

See page 2 for ordering configurations

SW

Static White
5 CCTs Available

TW

Tunable White

WD

Warm Dimming

Static White Options and Ordering Configuration

(Example: LRC-07IPD-7000L-120V-MFL-30K-BG-SH)

Must Specify						Optional				
Model	Lumens	Volts	Trim	Beam	CCT [†] & CRI	Driver Options	Emergency Options	Trim Options	Other Options *	
LRC-07IPD										
	Non-IC -7000L -6000L -5000L Type IC -4000L -3000L -2500L -2000L -1500L -1000L	-120 -277	-RWF	-SPT -NFL -MFL -WFL	80+ CRI* -27K: 2700°K -30K: 3000°K -35K: 3500°K -40K: 4000°K -50K: 5000°K *Note: Lumen Factor = 0.93 for -27K 90+ CRI** -27K-HC: 2700°K -30K-HC: 3000°K -35K-HC: 3500°K -40K-HC: 4000°K -50K-HC: 5000°K (N/A for -3000L) **Note: Lumen Factor = 0.79 for -27K-HC; All Others = 0.85	(Blank): Standard 0-10V CCR 1.0% dim -D2: 0-10V 0.1% dim -D3: DALI 1.0% dim -D4: DALI 100-0.1% dim -D5: DMX512A 0.1% dim; -4000L max -D6: Triac/ELV dim; 120 volt only ; -4000L max -ECO: Lutron EcoSys; Dim-to-black; -4000L max	(Blank): None -EI: Remote emergency inverter for 100% rated lumens up to -3000L; 90+ minutes; N/A for options -FS -E14: Remote emergency inverter for 100% rated lumens up to -4000L; CEC Compliant; 90+ minutes; N/A for options -FS -E15: Remote emergency inverter for 100% rated lumens up to -5000L; 90+ minutes; N/A for options -FS -ERH: Remote emergency battery pack; Delivers 1000 lumens; CEC Compliant; 90+ minutes	(Blank): Standard white enamel IP65-rated trim and lens Trim Finishes -35T: Silver enamel trim -37T: Dark bronze enamel trim -38T: Black enamel trim -94: Custom color; consult factory -BG: BioGard™ anti-microbial white Other Trim Features -CF: Custom color filter (Rosco); Specify -WA: White acrylic (flat) diffuser instead; with -WFL beam only	(Blank): None -99: Special modification; consult factory -AWN: Athena Wireless Node; N/A for Dimming Options D5, D6, ECO -FS: Fused primary; One per fixture; N/A for Options -EI, -E14, -E15 -SH: Cleanroom rated ISO 5 Class 100 luminaire; Sealed housing, J-Box, trim assembly *Note: For other integrated control solutions, such as nLight, contact factory	
						† For 2 SDCM, consult factory				

Dynamic White Options and Ordering Configuration

(Example: LRC-07IPD-2000L-UNV-MFL-6527-TW-BG-SH)

Must Specify						Optional				
Model	Lumens	Volts	Trim	Beam	CCT & CRI	Driver Options	Emergency Options	Trim Options	Other Options *	
LRC-07IPD										
	Type IC -2000L -1500L -1000L	-UNV	-RWF	-NFL -MFL -WFL	-6527: 6500°K - 2700°K range, 90+ CRI -4018: 4000°K - 1800°K range, 90+ CRI -3518: 3500°K - 1800°K range, 90+ CRI -3018: 3000°K - 1800°K range, 90+ CRI -2718: 2700°K - 1800°K range, 90+ CRI	-TW: Dual 0-10V Tunable White control with 0.1% dimming -TW7: DALI dual drive 0.1% tunable white dimming driver instead -TW8: DALI DT8 dual drive 0.1% tunable white dimming driver instead -WD: Warm Dimming 0-10V control with 0.1% dimming; N/A for Option -6527 -WD7: DALI 0.1% warm dimming driver instead; N/A for Option -6527	(Blank): None -EI: Remote emergency inverter for 100% rated lumen output; 90+ minutes; N/A for options -FS -ERH: Remote emergency battery pack; Delivers 1000 lumens; CEC Compliant; 90+ minutes	(Blank): Standard white enamel IP65-rated trim and lens Trim Finishes -35T: Silver enamel trim -37T: Dark bronze enamel trim -38T: Black enamel trim -94: Custom color; consult factory -BG: BioGard™ anti-microbial white Other Trim Features -WA: White acrylic (flat) diffuser instead; with -WFL beam only	(Blank): None -99: Special modification; consult factory -AWN: Athena Wireless Node; N/A for Dimming Options TW, TW7 -FS: Fused primary; One per fixture; N/A for Option -EI -SH: Cleanroom rated ISO 5 Class 100 luminaire; Sealed housing, J-Box, trim assembly *Note: For other integrated control solutions, such as nLight, contact factory	

Performance Factors - Static White

NOMINAL LUMENS	LUMEN FACTOR	NOMINAL WATTS	LPW FACTOR
-7000L	1.00	80.2	1.00
-6000L	0.89	69.1	1.02
-5000L	0.73	54.4	1.06
-4000L	0.54	36.7	1.17
-3000L	0.41	27.5	1.16
-2500L	0.36	24.7	1.15
-2000L	0.31	20.3	1.20
-1500L	0.23	14.4	1.24
-1000L	0.17	10.7	1.22

* See notes on page 2 for additional info on Lumen Factors

Performance Factors - Tunable White

Lumen factors are based on comparable Static White light output.

NOMINAL LUMENS	6500K LUMEN FACTOR	2700K LUMEN FACTOR	NOMINAL WATTS
-2000L	0.65	0.52	20.8
-1500L	0.65	0.52	14.9
-1000L	0.65	0.52	11.4

Photometry - Static White - Installed Complete Fixture

Photometry from I.T.L., Boulder, CO

LM-79 IESNA Certified Photometry from Independent Lab

-7000L-RWF-SPT

Cone of Light ▲

Dist.	FC	Dia.
6	477.6	2.7
8	268.7	3.7
10	171.9	4.6
12	119.4	5.5
14	87.7	6.4
16	67.2	7.3

Lumens: 7069
LPW: 90
Beam: ~28°
SC: 0.46
ITL Test: 93899

Nominal Lumens	Actual Lumens	Actual LPW
7000L	7069	89.7
6000L	6306	91.3
5000L	5175	95.1
4000L	3838	104.6
3000L	2870	104.4
2500L	2552	103.3
2000L	2191	108.0

-7000L-RWF-NFL

Cone of Light ▲

Dist.	FC	Dia.
6	285.1	3.5
8	160.4	4.7
10	102.6	5.8
12	71.3	7.0
14	52.4	8.1
16	40.1	9.3

Lumens: 6268
LPW: 80
Beam: ~37°
SC: 0.58
ITL Test: 93900

Nominal Lumens	Actual Lumens	Actual LPW
7000L	6268	79.6
6000L	5591	80.9
5000L	4588	84.3
4000L	3404	92.7
3000L	2545	92.5
2500L	2263	91.6
2000L	1943	95.7

-7000L-RWF-MFL

Cone of Light ▲

Dist.	FC	Dia.
6	207.8	4.6
8	116.9	6.1
10	74.8	7.6
12	51.9	9.2
14	38.2	10.7
16	29.2	12.2

Lumens: 6248
LPW: 79
Beam: ~51°
SC: 0.76
ITL Test: 93901

Nominal Lumens	Actual Lumens	Actual LPW
7000L	6248	79.4
6000L	5573	80.7
5000L	4574	84.1
4000L	3393	92.4
3000L	2537	92.2
2500L	2256	91.3
2000L	1937	95.4

-7000L-RWF-WFL

Cone of Light ▲

Dist.	FC	Dia.
6	141.4	6.1
8	79.6	8.1
10	50.9	10.1
12	35.4	12.2
14	26.0	14.2
16	19.9	16.2

Lumens: 7152
LPW: 91
Beam: ~70°
SC: 1.01
ITL Test: 93902

Nominal Lumens	Actual Lumens	Actual LPW
7000L	7152	90.9
6000L	6380	92.3
5000L	5235	96.2
4000L	3884	105.8
3000L	2904	105.6
2500L	2582	104.5
2000L	2217	109.2

LED manufacturers maintain a tolerance of +/-7% on flux (lumens) and power (electrical) measurements.

▲ Cone of Light Key
Dist. Distance (Ft.) from fixture
FC Footcandles at nadir (0°)
Dia. Circle of light at 50% of FC
Dia. (in ft.) shown is where FC value is half the FC at nadir.

LIMITED WARRANTY: KIRLIN LIGHTING FIXTURES ARE WARRANTED FREE OF DEFECTS IN WORKMANSHIP OR MATERIAL FOR FIVE YEARS FROM DATE OF PURCHASE. INSTALLATION MUST BE IN ACCORDANCE WITH THE INSTRUCTIONS PROVIDED WITH THE FIXTURE. THE WARRANTY IS VOID IF THE FIXTURE IS NOT INSTALLED IN ACCORDANCE WITH THE INSTRUCTIONS. THE WARRANTY DOES NOT COVER DAMAGE TO THE FIXTURE OR TO OTHER LIGHTING FIXTURES CAUSED BY IMPROPER INSTALLATION, OVERLOADING, OR OTHER ABUSE. THE WARRANTY IS VOID IF THE FIXTURE IS USED IN AN APPLICATION NOT INTENDED BY THE MANUFACTURER. THE WARRANTY IS VOID IF THE FIXTURE IS REPAIRED OR MODIFIED BY ANY OTHER PERSON. THIS WARRANTY IS APPLIED TO THE BUYER IN PLACE OF ALL OTHER WARRANTIES, EXPRESSED OR IMPLIED. SELLER DOES NOT WARRANT AS TO MERCHANTABILITY OR FITNESS FOR A PARTICULAR USE, NOR WILL ANY ORAL STATEMENT CONSTITUTE A WARRANTY OR AMEND THIS SPECIFIC WARRANTY. ABNORMAL USE, ABUSE OF THE FIXTURE, IMPROPER INSTALLATION, OR REPAIR OR MODIFICATION OF THE FIXTURE WITHOUT PRIOR WRITTEN AUTHORIZATION FROM THE MANUFACTURER WILL RENDER THE WARRANTY VOID.

CHOICE SERIES
JULY 2024