

CATALOG #	TYPE	
JOB NAME	WATTAGE	VOLTAGE

## Choice Series

### IP66 Rated 6" Downlight • COB LED

50,000+ Hours • Type IC • 1.0% Dimming, 0-10V

2 or 3 Step Binning • Wet Listed • LM-80 and LM-79 Certified

## Specifications

### Delivered System Performance

- Nominal Lumens: **Must Specify**

Type IC	Non-IC
-4000L	-7000L
-3000L	-6000L
-2500L	-5000L
-2000L	
-1500L	
-1000L	

- Select trim & beam distribution: see chart
- Select color (CCT): see chart; 80+ CRI standard; Option -HC for 90+ (15% lumen loss)
- 60,000 hour life, 50,000 in insulation

### Thermal Management System

- Aluminum heat sink and components for cool operation, long life, and low maintenance

### LED Driver - INTERNAL

- Indoor/Outdoor: -30°C to 60°C (-22°F to 140°F)
- 0-10V CCR 1.0% dimming standard
- Voltage Options: **Must Specify**
- 120: -120V (50-60Hz); load insensitive
- 277: -277V (50-60Hz); load insensitive

### Trim Assembly/Optics

- Smooth tapered self-flanged cast aluminum trim (-RWF is field paintable)
- RBN: Brushed Nickel finish instead
- Diffuse acrylic lens above. 125" clear polycarbonate; also see Option -WA

### IP66 Sealed & Gasketed Trim

- Liquid silicone seals between trim and lens
- Closed cell flange gasket seals trim to ceiling
- U-channel gasket seals trim to housing
- O-rings seal stainless fasteners to trim
- Meets ASTM E283 restricted airflow of 2CFM

### Acrylic Enameled Aluminum Housing

- Rustproof: exceeds 1000 hour ASTM 5% salt spray test; all components fully sustainable
- Shallow depth fits restricted plenums
- Cool operation extends component life
- Modular design; visible and fully serviceable through aperture

### Outlet Box (Galvanized)

- UL Listed, 14GA, insulated, removable cover
- 1/2" and 3/4" knockouts
- Up to 4 #12 AWG through-branch conductors

## LRC-06IPD

### Trim Options



-RWF



-RBN  
(Brushed Nickel Finish)

### Installation & Hardware

- Indoor/outdoor in ceilings up to 1 1/8" thick
- Compatible with fire rated enclosures (by others)
- 27" hanger bars & adjusting brackets (2) supplied

### UL, C-UL (Canada) & FCC Compliance

- UL Listed: wet, damp or dry locations, covered ceilings
- Type IC up to -4000L; Non-IC for -5000L+
- FCC Part 15 certified for EMI/RFI emissions

### FIVE YEAR Limited Warranty

- Complete standard fixture



## Dimensions

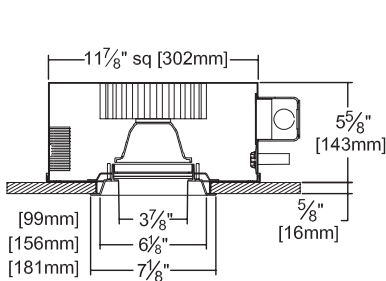

### Ceiling Cut-Out

6 1/2" Dia.

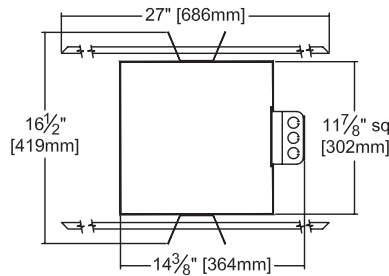

## Available Source Options

See page 2 for ordering configurations

SW

Static White  
5 CCTs Available

TW

Tunable White

WD

Warm Dimming

## Options and Ordering Configuration

(Example: LRC-06IPD-3000L-120-RWF-MFL-30K-BG-FS)

Must Specify						Optional				
Model	Lumens	Volts	Trim	Beam	CCT <sup>†</sup> & CRI	Driver Options	Emergency Options	Trim Options	Other Options	
LRC-06IPD										
	<b>Non-IC</b> -7000L -6000L -5000L <b>Type IC</b> -4000L -3000L -2500L -2000L -1500L -1000L	-120 -277	-RWF -RBN	-NFL -MFL -WFL	<b>80+ CRI*</b> -27K: 2700°K -30K: 3000°K -35K: 3500°K -40K: 4000°K -50K: 5000°K  <b>*Note:</b> Lumen Factor = 0.93 for -27K  <b>90+ CRI**</b> -27K-HC: 2700°K -30K-HC: 3000°K -35K-HC: 3500°K -40K-HC: 4000°K -50K-HC: 5000°K (N/A for -3000L)  <b>**Note:</b> Lumen Factor = 0.79 for -27K-HC; All Others = 0.85	<b>(Blank):</b> Standard 0-10V CCR 1.0% dim  -D2: 0-10V 0.1% dim -D3: DALI 1.0% dim -D4: DALI 100-0.1% dim -D5: DMX512A 0.1% dim; -4000L max -D6: Triac/ELV dim; <b>120 volt only</b> ; -4000L max -ECO: Lutron EcoSys; Dim-to-black; -4000L max	<b>(Blank):</b> None  -EI: Remote emergency inverter for 100% rated lumens up to -3000L; 90+ minutes; N/A for options -FS -E14: Remote emergency inverter for 100% rated lumens up to -4000L; CEC Compliant; 90+ minutes; N/A for options -FS -E15: Remote emergency inverter for 100% rated lumens up to -5000L; 90+ minutes; N/A for options -FS -EM: Internal emergency battery pack; Delivers 700 lumens; CEC Compliant; 90+ minutes -ERH: Remote emergency battery pack; Delivers 1000 lumens; CEC Compliant; 90+ minutes	<b>(Blank):</b> Standard trim finish; see photos above  <b>Trim Finishes (-RWF Only)</b> -35T: Silver enamel trim -37T: Dark bronze enamel trim -38T: Black enamel trim -94: Custom color; consult factory -BG: BioGard™ anti-microbial white  <b>Other Trim Features</b> -CF: Custom color filter (Rosco); Specify -WA: White acrylic (flat) diffuser instead; with -WFL beam only	<b>(Blank):</b> None  <b>Mounting</b> -78: Concrete pour housing with 2" collar -79: Extension collar for ceilings up to 2" thick  <b>Other Options</b> -99: Special modification; consult factory -FS: Fused primary; One per fixture; N/A for Options -EI, -E14, -E15 -SH: Cleanroom rated ISO 5 Class 100 luminaire; Sealed housing; J-Box, trim assembly	

† For 2 SDCM, consult factory

## Dynamic White Options and Ordering Configuration

(Example: LRC-06IPD-1500L-UNV-RWF-MFL-3018-WD-BG-FS)

Must Specify						Optional				
Model	Lumens	Volts	Trim	Beam	CCT & CRI	Driver Options	Emergency Options	Trim Options	Other Options	
LRC-06IPD										
	<b>Type IC</b> -2000L -1500L -1000L	-UNV	-RWF -RBN	-NFL -MFL -WFL	-6527: 6500°K - 2700°K range, 90+ CRI  -4018: 4000°K - 1800°K range, 90+ CRI -3518: 3500°K - 1800°K range, 90+ CRI -3018: 3000°K - 1800°K range, 90+ CRI -2718: 2700°K - 1800°K range, 90+ CRI	-TW: Dual 0-10V Tunable White control with 1.0% dimming -TW7: DALI dual drive 0.1% tunable white dimming driver instead -TW8: DALI DT8 dual drive 0.1% tunable white dimming driver instead -WD: Warm Dimming 0-10V control with 1.0% dimming; N/A for Option -6527 -WD7: DALI 0.1% warm dimming driver instead; N/A for Option -6527	<b>(Blank):</b> None  -EI: Remote emergency inverter for 100% rated lumen output; 90+ minutes; N/A for options -FS -EM: Internal emergency battery pack; Delivers 700 lumens; CEC Compliant; 90+ minutes -ERH: Remote emergency battery pack; Delivers 1000 lumens; CEC Compliant; 90+ minutes	<b>(Blank):</b> Standard trim finish; see photos above  <b>Trim Finishes (-RWF Only)</b> -35T: Silver enamel trim -37T: Dark bronze enamel trim -38T: Black enamel trim -94: Custom color; consult factory -BG: BioGard™ anti-microbial white  <b>Other Trim Features</b> -WA: White acrylic (flat) diffuser instead; with -WFL beam only	<b>(Blank):</b> None  <b>Mounting</b> -78: Concrete pour housing with 2" collar -79: Extension collar for ceilings up to 2" thick  <b>Other Options</b> -99: Special modification; consult factory -FS: Fused primary; One per fixture; N/A for Option -EI, -SH: Cleanroom rated ISO 5 Class 100 luminaire; Sealed housing; J-Box, trim assembly	

# Performance Factors

NOMINAL LUMENS	LUMEN FACTOR	NOMINAL WATTS	LPW FACTOR
-7000L	1.00	79.1	1.00
-6000L	0.89	69.1	1.02
-5000L	0.73	54.4	1.06
-4000L	0.54	36.7	1.17
-3000L	0.41	27.5	1.16
-2500L	0.36	24.7	1.15
-2000L	0.31	20.3	1.20
-1500L	0.23	14.4	1.24
-1000L	0.17	10.7	1.22

\* See notes on page 2 for additional info on Lumen Factors

# Photometry - Installed Complete Fixture

LM-79 IESNA Certified Photometry from Independent Lab

Photometry from I.T.L., Boulder, CO



**-7000L-RWF-NFL**

Lumens: 6352  
LPW: 80  
Beam: ~24°  
SC: 0.40  
ITL Test: 94110

Nominal Lumens	Actual Lumens	Actual LPW
7000L	6352	80.3
6000L	5666	82.0
5000L	4650	85.5
4000L	3449	94.0
3000L	2604	94.7
2500L	2287	92.6
2000L	1969	97.0
1500L	1461	101.5
1000L	1080	100.9

**Cone of Light ▲**

Dist.	FC	Dia.
6	593.7	2.4
8	334.0	3.2
10	213.7	4.0
12	148.4	4.8
14	109.0	5.6
16	83.5	6.3

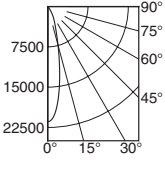

---



**-7000L-RWF-MFL**

Lumens: 6592  
LPW: 83  
Beam: ~48°  
SC: 0.75  
ITL Test: 94112

Nominal Lumens	Actual Lumens	Actual LPW
7000L	6592	83.3
6000L	5880	85.1
5000L	4825	88.7
4000L	3579	97.5
3000L	2703	98.3
2500L	2373	96.1
2000L	2044	100.7
1500L	1516	105.3
1000L	1121	104.7

**Cone of Light ▲**

Dist.	FC	Dia.
6	264.4	4.6
8	148.7	6.1
10	95.2	7.6
12	65.1	9.1
14	48.6	10.6
16	37.2	12.1

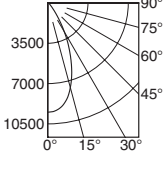

LED manufacturers maintain a tolerance of +/-7% on flux (lumens) and power (electrical) measurements.



**-7000L-RWF-WFL**

Lumens: 6943  
LPW: 88  
Beam: ~59°  
SC: 0.88  
ITL Test: 94113

Nominal Lumens	Actual Lumens	Actual LPW
7000L	6943	87.8
6000L	6193	89.6
5000L	5082	93.4
4000L	3770	102.7
3000L	2847	103.5
2500L	2499	101.2
2000L	2152	106.0
1500L	1597	110.9
1000L	1180	110.3

**Cone of Light ▲**

Dist.	FC	Dia.
6	200.1	5.5
8	112.5	7.4
10	72.0	9.2
12	50.0	11.1
14	36.8	12.9
16	28.1	14.8

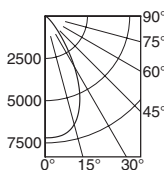

▲ **Cone of Light Key**  
Dist. Distance (Ft.) from fixture  
Dia. (in ft.) shown is where FC value is half the FC at nadir.  
FC Footcandles at nadir (0°)  
Dia. Circle of light at 50% of FC

LIMITED WARRANTY: CATALOGED KIRLIN FIXTURES ARE WARRANTED FREE OF DEFECTS IN WORKMANSHIP OR MATERIAL FOR 5 YEARS FROM DATE OF PURCHASE. INSTALLED TO N.E.C. IN NORMAL USE. Manufacturer at this option will replace or repair such fixture or return the purchase price on presentation of proof of purchase and defective fixture at the offices of manufacturer within the years of original shipment. Liability of manufacturer is limited to the foregoing and manufacturer shall not be liable for any other damages, direct or indirect, sustained or suffered by purchaser or any person. This warranty is applied to the buyer in place of all other warranties, expressed or implied. Seller does not warrant as to merchantability or fitness for a particular use, nor will any oral statement constitute a warranty or amend this specific warranty. Abnormal use, abuse of the fixture, improper installation, or repair or modification of the fixture without prior written authorization from the manufacturer will render the warranty void.

CHOICE SERIES  
AUGUST 2023