

CATALOG #	TYPE	
JOB NAME	WATTAGE	VOLTAGE

Choice Series

"Dead Front" 5" Shower Light • COB LED

50,000+ Hours • Type IC • 1.0% Dimming, 0-10V

2 or 3 Step Binning • Wet Listed • LM-80 and LM-79 Certified

LRC-05DFS

Trim Options

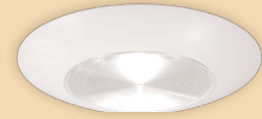

-SHR

Specifications

Delivered System Performance

- Lumen Series: **Must Specify**

Type IC

-2500L

-2000L

-1500L

-1200L

-1000L

- Select trim & beam distribution: see chart
- Select color (CCT): see chart: 80+ CRI standard; Option -HC for 90+ (15% lumen loss)
- 60,000 hour life, 50,000 in insulation (L70)

Thermal Management System

- Aluminum heat sink and components for cool operation, long life, and low maintenance

LED Driver - INTERNAL

- Indoor/Outdoor: -30°C to 60°C (-22°F to 140°F)
- 0-10V CCR 1.0% dimming standard
- Voltage Options: **Must Specify**
- UNV: -120-277/50-60Hz; load insensitive
- 120: -120V input (50-60Hz); for -D6 only

Trim Assembly/Optics

- Electrically non-conducting "dead front" design
- Rustproof; gasketed
- White polycarbonate trim with radial clear polycarbonate lens

Acrylic Enameled Aluminum Housing

- Rustproof: exceeds 1000 hour ASTM 5% salt spray test; all components fully sustainable
- Shallow depth for restricted plenums
- Cool operation extends component life
- Visible and fully serviceable through aperture

Outlet Box (Galvanized)

- UL Listed, 14GA, insulated, removable cover
- ½" and ¾" knockouts
- Up to 4 #12 AWG through-branch conductors

Installation & Hardware

- Indoor/outdoor in ceilings up to 1½" thick
- Compatible with fire rated enclosures (by others)
- 27" hanger bars & adjusting brackets (2) supplied

UL, C-UL (Canada) & FCC Compliance

- UL Listed: wet, damp or dry locations, covered ceilings
- Type IC up to -2500L
- FCC Part 15 certified for EMI/RFI emissions

FIVE YEAR Limited Warranty

- Complete standard fixture

Declare.



Made in the USA
BABAA Compliant



FCC Part 15
Certified



UL Listed
Wet, Damp, Dry

Dimensions

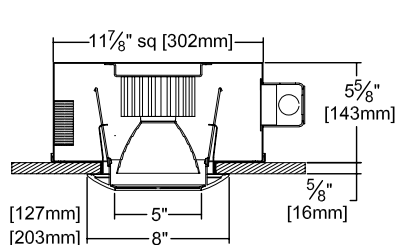

Ceiling Cut-Out

6½" Dia.

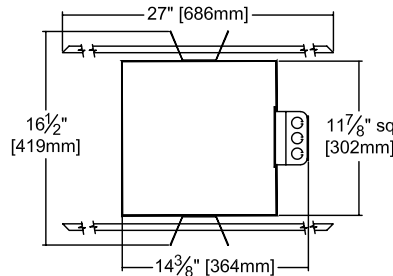

Available Source Options

See page 2 for ordering configurations

SW

Static White
5 CCTs Available

TW

Tunable White

WD

Warm Dimming

Static White Options and Ordering Configuration

(Example: LRC-05DFS-2500L-UNV-SHR-MFL-30K-32-79)

Must Specify						Optional			
Model	Lumens	Volts	Trim	Beam	CCT [†] & CRI	Driver Options	Emergency Options	Trim Options	Other Options
LRC-05DFS									
	Type IC	-UNV	-SHR	-MFL	80+ CRI*	(Blank): Standard 0-10V CCR 1.0% dim	(Blank): None	(Blank): White polycarbonate trim with clear radial lens standard	(Blank): None
	-2500L	-120			-27K: 2700°K				
	-2000L				-30K: 3000°K	-D2: 0-10V 0.1% dim	-EI: Remote emergency inverter for 100% rated lumen output; N/A for Option -FS		Mounting
	-1500L				-35K: 3500°K	-D3: DALI 1.0% dim		-32: White trim extender; specify OD	-79: Extension collar; ceilings up to 2" thick
	-1200L				-40K: 4000°K	-D4: DALI 100-0.1% dim			-RH: Joist mounting hardware instead
	-1000L				-50K: 5000°K	-D5: DMX512A 0.1% dim	-ERH: Remote emergency battery pack; Delivers 1000 lumens; CEC Compliant; 90+ minutes		Other Options *
					*Note: Lumen Factor = 0.93 for -27K	-D6: Triac/ELV dim - 120 volt only			-99: Special modification; consult factory
					90+ CRI**	-ECO: Lutron EcoSys; Dim-to-black			-AT: Air Tight version; Meets ASTM E283 airflow restriction of 2CFM max
					-27K-HC: 2700°K				-AWN: Athena Wireless Node; N/A for Dimming Options D5, D6, ECO
					-30K-HC: 3000°K				-FS: Fused primary; One per fixture; N/A for Option -EI
					-35K-HC: 3500°K				*Note: For other integrated control solutions, such as nLight, contact factory
					-40K-HC: 4000°K				
					-50K-HC: 5000°K (-2500L or below)				
					**Note: Lumen Factor = 0.79 for -27K-HC; All Others = 0.85				
					† For 2 SDCM, consult factory				

Dynamic White Options and Ordering Configuration

(Example: LRC-05DFS-1500L-UNV-SHR-MFL-2718-WD-32-79)

Must Specify						Optional			
Model	Lumens	Volts	Trim	Beam	CCT & CRI	Driver Options	Emergency Options	Trim Options	Other Options
LRC-05DFS									
	Type IC	-UNV	-SHR	-MFL	-6527: 6500°K - 2700°K range, 90+ CRI	-TW: Dual 0-10V Tunable White control with 0.1% dimming	(Blank): None	(Blank): White polycarbonate trim with clear radial lens standard	(Blank): None
	-2000L	-120			-4018: 4000°K - 1800°K range, 90+ CRI	-TW7: DALI dual drive 0.1% tunable white dimming driver instead	-EI: Remote emergency inverter for 100% rated lumen output; N/A for Option -FS		Mounting
	-1500L				-3518: 3500°K - 1800°K range, 90+ CRI	-TW8: DALI DT8 dual drive 0.1% tunable white dimming driver instead	-ERH: Remote emergency battery pack; Delivers 1000 lumens; CEC Compliant; 90+ minutes	-32: White trim extender; specify OD	-79: Extension collar; ceilings up to 2" thick
	-1200L				-3018: 3000°K - 1800°K range, 90+ CRI	-WD: Warm Dimming 0-10V control with 0.1% dimming; N/A for Option -6527			-RH: Joist mounting hardware instead
	-1000L				-2718: 2700°K - 1800°K range, 90+ CRI	-WD7: DALI 0.1% warm dimming driver instead; N/A for Option -6527			Other Options *
									-99: Special modification; consult factory
									-AT: Air Tight version; Meets ASTM E283 airflow restriction of 2CFM max
									-AWN: Athena Wireless Node; N/A for Dimming Options TW, TW7
									-FS: Fused primary; One per fixture; N/A for Option -EI
									*Note: For other integrated control solutions, such as nLight, contact factory

CHOICE SERIES
NOVEMBER 2024

Performance Factors - Static White

NOMINAL LUMENS	LUMEN FACTOR	NOMINAL WATTS	LPW FACTOR
-2500L	1.13	27.5	0.99
-2000L	1.00	24.7	1.00
-1500L	0.86	20.3	1.02
-1200L	0.63	14.4	1.05
-1000L	0.46	10.7	1.04

* See notes on page 2 for additional info on Lumen Factors

Performance Factors - Tunable White

Lumen factors are based on comparable Static White light output.

NOMINAL LUMENS	6500K LUMEN FACTOR	2700K LUMEN FACTOR	NOMINAL WATTS
-2000L	0.65	0.52	20.8
-1500L	0.65	0.52	14.9
-1000L	0.65	0.52	11.4

Photometry - Static White - Installed Complete Fixture

Photometry from I.T.L., Boulder, CO

LM-79 IESNA Certified Photometry from Independent Lab

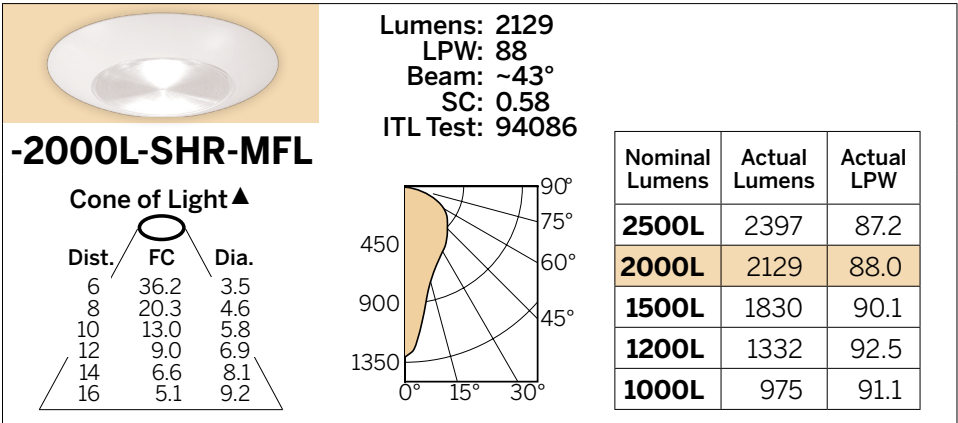

LED manufacturers maintain a tolerance of +/-7% on flux (lumens) and power (electrical) measurements.

▲ **Cone of Light Key**
Dist. (in ft.) shown is where FC value is half the FC at nadir.
Dist. Distance (Ft.) from fixture
FC Footcandles at nadir (0°)
Dia. Circle of light at 50% of FC

LIMITED WARRANTY: KIRLIN LIGHTING FIXTURES ARE WARRANTED FREE OF DEFECTS IN WORKMANSHIP OR MATERIAL FOR FIVE YEARS FROM DATE OF PURCHASE. INSTALLATION, E.G., IN NORMAL USE. Manufacturer at his option will replace or repair such fixture or refund the purchase price on presentation of proof of purchase and defective fixture at the offices of manufacturer within five years of original shipment. Liability of manufacturer is limited to the foregoing and manufacturer shall not be liable for any other damages, direct or indirect, sustained or suffered by purchaser or any person. This warranty is supplied to the buyer in place of all other warranties, expressed or implied. Seller does not warrant as to merchantability or fitness for a particular use, nor will any oral statement constitute a warranty or amend this specific warranty. Abnormal use, abuse of the fixture, improper installation, or repair or modification of the fixture without prior written authorization from the manufacturer will render the warranty void.

CHOICE SERIES
NOVEMBER 2024