

CATALOG #	TYPE	
JOB NAME	WATTAGE	VOLTAGE

Choice Series

IP66 Rated 4" Downlight • COB LED

50,000+ Hours • Type IC • 1.0% Dimming, 0-10V

2 or 3 Step Binning • Wet Listed • LM-80 and LM-79 Certified

Specifications

Delivered System Performance

• Nominal Lumens: **Must Specify**

Type IC

-2500L

-2000L

-1500L

-1000L

- Select trim & beam distribution: see chart
- Select color (CCT): see chart; 80+ CRI standard; Option -HC for 90+ (15% lumen loss)
- 60,000 hour life, 50,000 in insulation

Thermal Management System

- Aluminum heat sink and components for cool operation, long life, and low maintenance

LED Driver - INTERNAL

- Indoor/Outdoor: -30°C to 60°C (-22°F to 140°F)
- 0-10V CCR 1.0% dimming standard
- Voltage Options: **Must Specify**
- UNV** - 120-277V (50-60Hz); load insensitive
- 120:** -120V (50-60Hz); load insensitive

Trim Assembly/Optics

- Smooth tapered self-flanged cast aluminum trim (-RWF is field paintable)
- Diffuse acrylic lens above. 125" clear polycarbonate; also see Option -WA

IP66 Sealed & Gasketed Trim

- Liquid silicone seals between trim and lens
- O-rings seal stainless fasteners to trim
- Meets ASTM E283 restricted airflow of 2CFM

Acrylic Enameled Aluminum Housing

- Rustproof: exceeds 1000 hour ASTM 5% salt spray test; all components fully sustainable
- Shallow depth for restricted plenums
- Cool operation extends component life
- Modular design; visible and fully serviceable through aperture

Outlet Box (Galvanized)

- UL Listed, 14GA, insulated, removable cover
- ½" and ¾" knockouts
- Up to 4 #12 AWG through-branch conductors

Installation & Hardware

- Indoor/outdoor in ceilings up to 1½" thick
- Compatible with fire rated enclosures (by others)

LRC-04IPD

Trim Options



-RWF



-SQR

- 27" hanger bars & adjusting brackets (2) supplied

UL, C-UL (Canada) & FCC Compliance

- UL listed Type IC: up to -2500L
- FCC Part 15 certified for EMI/RFI emissions

FIVE YEAR Limited Warranty

- Complete standard fixture

Made in the USA	Natorium Rated	NSF Certified	IP66	BioGard™ See Option -BG	ISO 5/Class 100 See Option -SH	FCC Part 15 Certified	UL Listed Wet, Damp, Dry

Options and Ordering Configuration

(Example: LRC-04IPD-2500L-120-RWF-MFL-30K-BG-FS)

Must Specify						Optional			
Model	Lumens	Volts	Trim	Beam	CCT [†] & CRI	Driver Options	Emergency Options	Trim Options	Other Options
LRC-04IPD									
	Type IC	-UNV	-RWF	-SPT	80+ CRI*	(Blank): Standard 0-10V CCR 1.0% dim	(Blank): None	(Blank): Standard trim finish; see photos above	(Blank): None
	-2500L	-120	-SQR	-NFL	-27K: 2700°K				
	-2000L			-MFL	-30K: 3000°K	-D6: Triac/ELV dim - 120 volt only	-EI: Remote emergency inverter for 100% rated lumens up to -2500L; 90+ minutes; N/A for options -FS	Trim Finishes	-79: Extension collar for ceilings up to 2" thick
	-1500L			-WFL	-35K: 3500°K				
	-1000L				-40K: 4000°K				
					-50K: 5000°K				
					*Note: Lumen Factor = 0.93 for -27K				
					90+ CRI**	-ERH: Remote emergency battery pack; Delivers 1000 lumens; CEC Compliant; 90+ minutes	-94: Custom color; consult factory	-BG: BioGard™ anti-microbial white	Other Options
					-27K-HC: 2700°K				
					-30K-HC: 3000°K				
					-35K-HC: 3500°K				
					-40K-HC: 4000°K				
					-50K-HC: 5000°K	-99: Special modification; consult factory	-FS: Fused primary; One per fixture; N/A for Options -EI	Other Trim Features	-SH: Cleanroom rated ISO 5 Class 100 luminaire; Sealed housing, J-Box, trim assembly
					**Note: Lumen Factor = 0.79 for -27K-HC; All Others = 0.85				
								-CF: Custom color filter (Rosco); Specify	
								-WA: White acrylic (flat) diffuser instead; with -WFL beam only	

† For 2 SDCM, consult factory

Performance Factors

NOMINAL LUMENS	LUMEN FACTOR	NOMINAL WATTS	LPW FACTOR
-2500L	1.00	27.0	1.00
-2000L	0.89	24.3	0.99
-1500L	0.76	20.4	1.01
-1000L	0.41	10.5	1.05

* See notes on page 1 for additional info on Lumen Factors

Dimensions

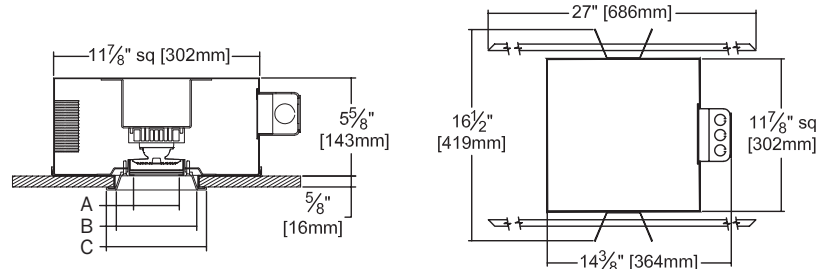

Trim Style	Ceiling Cut-Out	Dimension A	Dimension B	Dimension C
-RWF	5" Dia.	2 5/8"	4 5/8"	5 3/4"
-SQR	5 1/4" Sq.	2 7/8"	4 3/4"	6"

Photometry - Installed Complete Fixture

Photometry from L.L.I., Allentown, PA

LM-79 IESNA Certified Photometry from Light Labs, International

<p>-2500L-RWF-SPT</p> <p>Cone of Light ▲</p> <table border="1"> <thead> <tr> <th>Dist.</th> <th>FC</th> <th>Dia.</th> </tr> </thead> <tbody> <tr><td>6</td><td>227.3</td><td>2.7</td></tr> <tr><td>8</td><td>127.9</td><td>3.6</td></tr> <tr><td>10</td><td>81.8</td><td>4.5</td></tr> <tr><td>12</td><td>56.8</td><td>5.4</td></tr> <tr><td>14</td><td>41.8</td><td>6.3</td></tr> <tr><td>16</td><td>32.0</td><td>7.2</td></tr> </tbody> </table>	Dist.	FC	Dia.	6	227.3	2.7	8	127.9	3.6	10	81.8	4.5	12	56.8	5.4	14	41.8	6.3	16	32.0	7.2	<p>Lumens: 2338 LPW: 86 Beam: ~27° SC: 0.4 LLI Test: 1511-010</p> <table border="1"> <thead> <tr> <th>Nominal Lumens</th> <th>Actual Lumens</th> <th>Actual LPW</th> </tr> </thead> <tbody> <tr><td>2500L</td><td>2338</td><td>86.3</td></tr> <tr><td>2000L</td><td>2096</td><td>85.1</td></tr> <tr><td>1500L</td><td>1784</td><td>87.4</td></tr> <tr><td>1000L</td><td>947</td><td>90.2</td></tr> </tbody> </table>	Nominal Lumens	Actual Lumens	Actual LPW	2500L	2338	86.3	2000L	2096	85.1	1500L	1784	87.4	1000L	947	90.2
Dist.	FC	Dia.																																			
6	227.3	2.7																																			
8	127.9	3.6																																			
10	81.8	4.5																																			
12	56.8	5.4																																			
14	41.8	6.3																																			
16	32.0	7.2																																			
Nominal Lumens	Actual Lumens	Actual LPW																																			
2500L	2338	86.3																																			
2000L	2096	85.1																																			
1500L	1784	87.4																																			
1000L	947	90.2																																			
<p>-2500L-RWF-NFL</p> <p>Cone of Light ▲</p> <table border="1"> <thead> <tr> <th>Dist.</th> <th>FC</th> <th>Dia.</th> </tr> </thead> <tbody> <tr><td>6</td><td>177.1</td><td>3.1</td></tr> <tr><td>8</td><td>99.6</td><td>4.1</td></tr> <tr><td>10</td><td>63.7</td><td>5.1</td></tr> <tr><td>12</td><td>44.3</td><td>6.1</td></tr> <tr><td>14</td><td>32.5</td><td>7.2</td></tr> <tr><td>16</td><td>24.9</td><td>8.2</td></tr> </tbody> </table>	Dist.	FC	Dia.	6	177.1	3.1	8	99.6	4.1	10	63.7	5.1	12	44.3	6.1	14	32.5	7.2	16	24.9	8.2	<p>Lumens: 2212 LPW: 82 Beam: ~31° SC: 0.5 LLI Test: 1511-011</p> <table border="1"> <thead> <tr> <th>Nominal Lumens</th> <th>Actual Lumens</th> <th>Actual LPW</th> </tr> </thead> <tbody> <tr><td>2500L</td><td>2212</td><td>81.6</td></tr> <tr><td>2000L</td><td>1958</td><td>80.6</td></tr> <tr><td>1500L</td><td>1688</td><td>82.7</td></tr> <tr><td>1000L</td><td>896</td><td>85.3</td></tr> </tbody> </table>	Nominal Lumens	Actual Lumens	Actual LPW	2500L	2212	81.6	2000L	1958	80.6	1500L	1688	82.7	1000L	896	85.3
Dist.	FC	Dia.																																			
6	177.1	3.1																																			
8	99.6	4.1																																			
10	63.7	5.1																																			
12	44.3	6.1																																			
14	32.5	7.2																																			
16	24.9	8.2																																			
Nominal Lumens	Actual Lumens	Actual LPW																																			
2500L	2212	81.6																																			
2000L	1958	80.6																																			
1500L	1688	82.7																																			
1000L	896	85.3																																			
<p>-2500L-RWF-MFL</p> <p>Cone of Light ▲</p> <table border="1"> <thead> <tr> <th>Dist.</th> <th>FC</th> <th>Dia.</th> </tr> </thead> <tbody> <tr><td>6</td><td>76.7</td><td>4.8</td></tr> <tr><td>8</td><td>43.1</td><td>6.4</td></tr> <tr><td>10</td><td>27.6</td><td>8.0</td></tr> <tr><td>12</td><td>19.2</td><td>9.6</td></tr> <tr><td>14</td><td>14.1</td><td>11.2</td></tr> <tr><td>16</td><td>10.8</td><td>12.8</td></tr> </tbody> </table>	Dist.	FC	Dia.	6	76.7	4.8	8	43.1	6.4	10	27.6	8.0	12	19.2	9.6	14	14.1	11.2	16	10.8	12.8	<p>Lumens: 2003 LPW: 74 Beam: ~49° SC: 0.7 LLI Test: 1511-012</p> <table border="1"> <thead> <tr> <th>Nominal Lumens</th> <th>Actual Lumens</th> <th>Actual LPW</th> </tr> </thead> <tbody> <tr><td>2500L</td><td>2003</td><td>73.9</td></tr> <tr><td>2000L</td><td>1773</td><td>72.9</td></tr> <tr><td>1500L</td><td>1528</td><td>74.9</td></tr> <tr><td>1000L</td><td>811</td><td>77.3</td></tr> </tbody> </table>	Nominal Lumens	Actual Lumens	Actual LPW	2500L	2003	73.9	2000L	1773	72.9	1500L	1528	74.9	1000L	811	77.3
Dist.	FC	Dia.																																			
6	76.7	4.8																																			
8	43.1	6.4																																			
10	27.6	8.0																																			
12	19.2	9.6																																			
14	14.1	11.2																																			
16	10.8	12.8																																			
Nominal Lumens	Actual Lumens	Actual LPW																																			
2500L	2003	73.9																																			
2000L	1773	72.9																																			
1500L	1528	74.9																																			
1000L	811	77.3																																			
<p>-2500L-RWF-WFL</p> <p>Cone of Light ▲</p> <table border="1"> <thead> <tr> <th>Dist.</th> <th>FC</th> <th>Dia.</th> </tr> </thead> <tbody> <tr><td>6</td><td>61.1</td><td>4.6</td></tr> <tr><td>8</td><td>34.4</td><td>6.2</td></tr> <tr><td>10</td><td>22.0</td><td>7.7</td></tr> <tr><td>12</td><td>15.3</td><td>9.3</td></tr> <tr><td>14</td><td>11.2</td><td>10.8</td></tr> <tr><td>16</td><td>8.6</td><td>12.4</td></tr> </tbody> </table>	Dist.	FC	Dia.	6	61.1	4.6	8	34.4	6.2	10	22.0	7.7	12	15.3	9.3	14	11.2	10.8	16	8.6	12.4	<p>Lumens: 1929 LPW: 71 Beam: ~52° SC: 0.8 LLI Test: 1511-013</p> <table border="1"> <thead> <tr> <th>Nominal Lumens</th> <th>Actual Lumens</th> <th>Actual LPW</th> </tr> </thead> <tbody> <tr><td>2500L</td><td>1929</td><td>71.4</td></tr> <tr><td>2000L</td><td>1707</td><td>70.3</td></tr> <tr><td>1500L</td><td>1472</td><td>72.1</td></tr> <tr><td>1000L</td><td>781</td><td>74.4</td></tr> </tbody> </table>	Nominal Lumens	Actual Lumens	Actual LPW	2500L	1929	71.4	2000L	1707	70.3	1500L	1472	72.1	1000L	781	74.4
Dist.	FC	Dia.																																			
6	61.1	4.6																																			
8	34.4	6.2																																			
10	22.0	7.7																																			
12	15.3	9.3																																			
14	11.2	10.8																																			
16	8.6	12.4																																			
Nominal Lumens	Actual Lumens	Actual LPW																																			
2500L	1929	71.4																																			
2000L	1707	70.3																																			
1500L	1472	72.1																																			
1000L	781	74.4																																			

LED manufacturers maintain a tolerance of +/-7% on flux (lumens) and power (electrical) measurements.

▲ Cone of Light Key Dist. Distance (Ft.) from fixture
Dia. (in ft.) shown is where FC FC Footcandles at nadir (0°)
value is half the FC at nadir. Dia. Circle of light at 50% of FC

LIMITED WARRANTY: KIRLIN ARCHITECTURAL LIGHTING PRODUCTS ARE WARRANTED FREE OF DEFECTS IN WORKMANSHIP OR MATERIAL FOR FIVE YEARS FROM DATE OF PURCHASE. INSTALLATION, IN-NORMAL USE, MANUFACTURER AT HIS OPTION WILL REPLACE OR REPAIR SUCH FIXTURE OR TRIMMINGS. THIS WARRANTY IS VOID IF THE FIXTURE IS NOT INSTALLED IN ACCORDANCE WITH THE MANUFACTURER'S INSTRUCTIONS. THE WARRANTY IS VOID IF THE FIXTURE IS NOT INSTALLED IN ACCORDANCE WITH THE MANUFACTURER'S INSTRUCTIONS. THE WARRANTY IS VOID IF THE FIXTURE IS NOT INSTALLED IN ACCORDANCE WITH THE MANUFACTURER'S INSTRUCTIONS.

CHOICE SERIES
JUNE 2023