

Recessed Type Appearance  
Lensed E-Lamp Pulse Start  
Downlight: 50 to 200 Watt

7" 200W HRR-07026

# THIS PRODUCT IS NO LONGER AVAILABLE

## PLEASE CONSULT QUOTATIONS

# for the best alternative.

**Features**

**Lamp**

- Designed for metal halide E-lamps. See chart below for standard and optional wattages.
- See Option -43 and chart below for lower wattage for HPS availability.

**Socket**

- Vertical. Pulse rated. Glazed porcelain.
- Nickel-plated brass screw shell. Standard leads.

**Reflector**

- Self-flanged clear specular Alzak trim.
- Ten optional reflector finishes available.

**Lens**

- UV absorbing clear tempered glass mounted to reflector. Also see Options.

**Ballast Assembly**

- Whisper back™ fixture for pulse start ballast.

- 50-200 watt: Class H, high ballance, 20 volt and options A, -43, linear reactor for 277 volt.
- 175-200 watt Super-D™ for 120 volt and Options -65, -66, -HL; Class H, linear reactor for 277 volt.
- Capacitor and ignitor supplied.
- Dimming (-39) and electronic (-96) ballasts available. See Options.
- Self-flanged. See Options.
- Color and easy-to-wipe interior coatings including dry wall.
- Acrylic enameled aluminum.
- Cool: Dissipates heat across entire surface.
- Spray test.

- Entire luminaire serviced from below through removable reflector and lens.
- Built-in plaster frame.

**Outlet Box**

- Prewired 14 GA (NEC) galvanized steel, UL listed; with removable insulated cover.
- 1/2" and 3/4" knockouts.

**Installation**

- 27" galvanized hanger bars supplied (2).
- Fully adjustable universal mounting brackets supplied (2).
- Recesses indoor or outdoor in covered locations.

**UL, C-UL (Canada) Listings**

- Wet, damp or dry locations, covered ceilings.
- Through-branch circuit conductors (6 #12).

**Three Year Limited Warranty**

- Complete standard fixture, including ballast.
- Per current NEC

**Wattage Availability and Cut-Out Dimensions**

Catalog No.	Lamp/Base	Standard Wattage		Option -43: Lower Wattage		Max. Standby Wattage (-49-65-66-LS)	Ceiling Cut-Out Diameter
		Pulse MH	-24 (HPS)	Pulse MH	-24 (HPS)		
HRR-07026	ED-17/Med	200	150	50-175	35-150	100	8.0"

**Options**

**Sources and Ballasts**

- 24 HPS ballast instead. See wattage chart above for available wattages. Specify voltage.
- 39 Electronic dimming ballast instead, for pulse start metal halide. Consult factory for wattage and voltage availability.
- 96 Regulating electronic MH ballast instead. Consult factory for availability in 175W or above.

**Wattage and Voltage**

- 43 Lower wattage: See Option -43 chart above for available lower wattages. Specify voltage.
- 120 120 volt, 60 Hz. ballast.
- 277 277 volt, 60 Hz. ballast.
- 347 347 volt, 60 Hz. ballast. Consult factory for dimming or electronic.
- 97 Other voltage ballast instead. Consult factory.

**Relays, Standbys, Lamps (See Chart)**

- 49 Extra circuit DCB socket. Do not energize simultaneously with main source. Also see -LS.
- 65 Electronic standby system and DCB socket.

- Following HID outage, provides immediate light until HID restrikes. Also see -66 and -LS.
- 66 Electronic time delay standby system and DCB socket. Following outage, provides light until HID reaches 70% output. Also see Option -LS.
- HL Hi-Lo wiring modification for use with external relay systems (by others). 175 watt or above. CWA ballast only. Specify system.
- LP With lamp. Specify source, wattage, color temperature, and clear or coated. (3700°K standard for metal halide) Consult factory for other color temperatures.
- LS With T-4 DCB tungsten halogen standby lamp. Use only with Options -49, -65 or -66.

**Reflectors and Trims (Self-Flanged)**

- 16 Champagne Gold specular Alzak reflector. (CP x .93)
- 31 White flange (only) on self-flanged reflector.
- 32 Trim extender. Broadens trim flange O.D. by 1" to cover larger ceiling opening.
- 45 Gasket above reflector flange. Stops dust streaks on ceiling.
- 63 Dune specular Alzak reflector. (CP x .90)
- 69 Wheat specular Alzak reflector. (CP x .88)

- 70 SofTex Clear softly etched reflector. (CP x .90)
- 71 SofTex Dune softly etched reflector. (CP x .81)
- 77 SofTex Pewter softly etched reflector. (CP x .78)
- 90 SofTex Champagne Gold softly etched reflector. (CP x .84)
- 91 SofTex Wheat softly etched reflector. (CP x .80)
- 93 Pewter specular Alzak reflector. (CP x .85)
- 94 Custom color reflector. Consult factory.

**Lenses**

- 15 Prismatic flat C#73 glass instead.
- ML UV absorbing tempered Microlux glass instead. Concentrates distribution.

**Mounting Options**

- 79 Extension collar for up to 2" thick ceilings.
- 82 Sloped ceiling adapter, with mounting hardware. Specify 5° increments up to 30°.
- 85 Ceiling Panel; with recessed fixture hole. Lays-in 2' x 2' grid. White.

**Other Options**

- 99 Special modification. Consult factory.

PS MET HALIDE  
JULY 2002



**THE KIRLIN COMPANY**

3401 EAST JEFFERSON AVENUE • DETROIT, MICHIGAN 48207-4232  
(313) 259-6400 • Fax: (313) 259-9409 or (313) 259-3121 • www.kirlinlighting.com

THE KIRLIN COMPANY RESERVES THE RIGHT TO CHANGE, WITHOUT NOTICE, DETAILS OR SPECIFICATIONS IN PRODUCT DESIGN.

Alzak® is a registered trademark of ALCOA.

### HRR-07026

Plan View

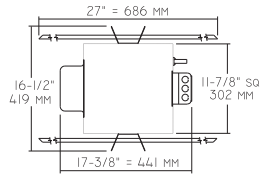

**Cone of Light Key**

- Ft.** Distance from fixture
- FC** Footcandles (average)
- Dia.** Circle of light at 50% of FC
  - Dia. (in ft.) shown is where FC value is half the FC at nadir.

**C.U. (Coefficients of Utilization) Tables are available on request. Please contact your Kirlin representative.**

LIMITED WARRANTY: CATALOGUED KIRLIN FIXTURES ARE WARRANTED FREE OF DEFECTS IN WORKMANSHIP OR MATERIAL FOR THREE YEARS FROM DATE OF PURCHASE, INSTALLED TO N.E.C. IN NORMAL USE. Manufacturer at his option will replace or repair, at no charge, the fixture or any part thereof, if the purchaser or user notifies the manufacturer in writing within the warranty period. This warranty is void if the fixture is used for any other purpose, or if the fixture is altered, modified, repaired, or if the fixture is not installed in accordance with the instructions. This warranty is void if the fixture is used for any other purpose, or if the fixture is altered, modified, repaired, or if the fixture is not installed in accordance with the instructions. This warranty is void if the fixture is used for any other purpose, or if the fixture is altered, modified, repaired, or if the fixture is not installed in accordance with the instructions.

### HRR-07026 200W

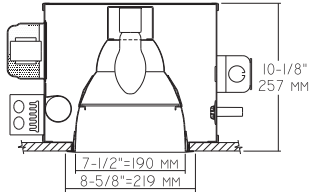

#### HRR-07026 (Coated Lamp)

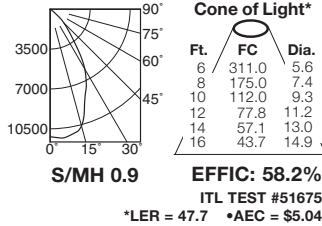

	CANDLEPOWER DISTRIBUTION				
	0.0	22.5	45.0	67.5	90.0
0	11197	11197	11197	11197	11197
5	11358	11358	11358	11358	11358
15	10603	10603	10603	10603	10603
25	7488	7488	7488	7488	7488
35	4083	4083	4083	4083	4083
45	1687	1687	1687	1687	1687
55	211	211	211	211	211
65	97	97	97	97	97
75	0	0	0	0	0
85	0	0	0	0	0
90	0	0	0	0	0

#### HRR-07026-15 (Clear Lamp)

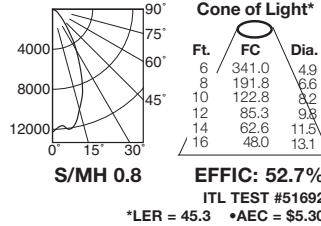

	CANDLEPOWER DISTRIBUTION				
	0.0	22.5	45.0	67.5	90.0
0	12276	12276	12276	12276	12276
5	11676	11676	11676	11676	11676
15	10355	10355	10355	10355	10355
25	6578	6578	6578	6578	6578
35	3135	3135	3135	3135	3135
45	1362	1362	1362	1362	1362
55	690	690	690	690	690
65	332	332	332	332	332
75	12	12	12	12	12
85	0	0	0	0	0
90	0	0	0	0	0

#### HRR-07026-ML (Clear Lamp)

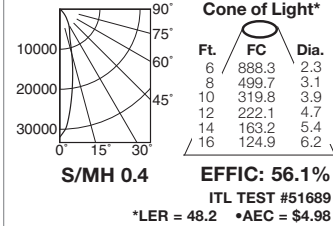

	CANDLEPOWER DISTRIBUTION				
	0.0	22.5	45.0	67.5	90.0
0	31979	31979	31979	31979	31979
5	26645	26645	26645	26645	26645
15	11532	11532	11532	11532	11532
25	5760	5760	5760	5760	5760
35	3129	3129	3129	3129	3129
45	1293	1293	1293	1293	1293
55	420	420	420	420	420
65	222	222	222	222	222
75	15	15	15	15	15
85	2	2	2	2	2
90	0	0	0	0	0

\* LER (Luminaire Efficacy Rating) = Luminaire Effic. x Total Lamp Lumens x Ballast Factor / Input Watts

• AEC = Annual Energy Cost per 1000 lumens (based on 3000 hours use @ \$0.08 KWH).

### SUBMITTAL DATA

### APPROVAL STAMP

JOB NAME

TYPE

WATTAGE

VOLTAGE

CATALOG NUMBER