

Recessed Open PAR Lamp
 "Pulse Start" Downlight:
 70 to 150 Watt

7" 150W HRR-07006

THIS PRODUCT IS NO LONGER AVAILABLE

Features

Lamp

- Designed for metal halide PAR lamps. See chart below for standard and optional lamps and wattage.
- See Option -43 and chart below for lower wattage.

Socket

- Vertical. Medium base. Pulse rated.
- Glazed porcelain.
- Nickel-plated brass screw shell. Silicone leads.

Reflectors

- Upper: Specular Alzak aluminum.
- Lower: Self-flanged semi-specular aluminum with 4-cell parabolic cross-baffle.
- Optional White flange.

Ballast Assembly

- WhisperPack™ fully encapsulated 180°C rated HPF pulse start ballast.

Please consult QUOTATIONS for the best alternative.

Outlet Box

- Prewired 14 GA (NEC) galvanized steel, UL listed; with removable insulated cover.
- 1/2" and 3/4" knockouts.

Installation

- 27" galvanized hanger bars supplied (2).
- Fully adjustable universal mounting brackets supplied (2).
- Recesses indoor or outdoor in covered locations.

UL, C-UL (Canada) Listings

- Wet, damp or dry locations, covered ceilings.
- Through-branch circuit conductors (6 #12).
- UL Listed Warranty
- Complete standard fixture, including ballast.

Thermal Protection

- Per current N.C.

Wattage / Lamp Availability and Cut-out Dimensions

Catalog No.	Designed For:		Option -43: Lower Wattage	Max. Standby Wattage (-49-65-66-LS)	Ceiling Cut-Out Diameter
	Standard Lamp	Optional Lamp(s)			
HRR-07006	150 PAR 38 35° MFL	20° SP 65° FL	70-100	—	8.0"

Options

Sources and Ballasts

- 39 Electronic dimming ballast instead, for pulse start metal halide. Consult factory for wattage and voltage availability.
- 96 Regulating electronic MH ballast instead.

Wattage and Voltage

- 43 Lower wattage. See Option -43 chart above for available lower wattages. Specify voltage.
- 120 120 volt, 60 Hz. ballast.
- 277 277 volt, 60 Hz. ballast.
- 347 347 volt, 60 Hz. ballast. Consult factory for dimming or electronic.
- 97 Other voltage ballast instead. Consult factory.

Relays, Lamps (See Chart)

- LP With lamp. Choose standard lamp shown above or specify wattage, beam spread, style (PAR 20, PAR 30, PAR 38), brand and color temperature.
- LS With T-4 DCB tungsten halogen standby lamp. Use only with Options -49, -65 or -66.

Reflectors and Trims (Self-Flanged) (Consult factory)

- 16 Champagne Gold specular Alzak reflector. (CP x .98)
- 30 All White reflector (CP x .98) or cross baffle.
- 31 White flange (only) on self-flanged reflector or cross baffle.
- 32 Trim extender. Broadens trim flange O.D. by 1" to cover larger ceiling opening.
- 45 Gasket above reflector flange. Stops dust streaks on ceiling.
- 63 Dune specular Alzak reflector. (CP x .97)
- 69 Wheat specular Alzak reflector. (CP x .97)
- 70 SofTex Clear softly etched reflector. (CP x .98)
- 71 SofTex Dune softly etched reflector. (CP x .95)
- 72 Black specular Alzak reflector. (CP x .87)
- 77 SofTex Pewter softly etched reflector. (CP x .90)
- 90 SofTex Champagne Gold softly etched reflector. (CP x .96)
- 91 SofTex Wheat softly etched reflector. (CP x .95)

- 92 Umber specular Alzak reflector. (CP x .92)
- 93 Pewter specular Alzak reflector. (CP x .95)
- 94 Custom color reflector or cross baffle. Consult factory.
- OG OptiGroove; black seamless tapered aluminum reflector. White trim. (CP x .90)
- WW Wall wash cross baffle assembly instead.

Mounting Options

- 79 Extension collar for up to 2" thick ceilings.
- 82 Sloped ceiling adapter, with mounting hardware. Specify 5° increments up to 30°.
- 85 Ceiling Panel; with recessed fixture hole. Lays-in 2' x 2' grid. White.

Other Options

- 99 Special modification. Consult factory.
- TA Top access; for servicing from above ceiling.

HRR-07006

Plan View

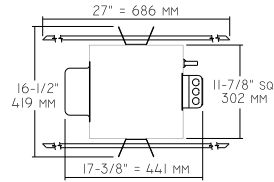

Cone of Light Key

- Ft.** Distance from fixture
- FC** Footcandles (average)
- Dia.** Circle of light at 50% of FC
- * Dia. (in ft.) shown is where FC value is half the FC at nadir.

C.U. (Coefficients of Utilization) Tables are available on request. Please contact your Kirlin representative.

LIMITED WARRANTY: CATALOGED KIRLIN FIXTURES ARE WARRANTED FREE OF DEFECTS IN WORKMANSHIP OR MATERIAL FOR THREE YEARS FROM DATE OF PURCHASE. INSTALLED TO N.E.C. IN NORMAL USE. Manufacturer at his option will replace or repair such fixture or refund the purchase price on presentation of proof of purchase and defective fixture at the office of manufacturer within three years of original shipment. Liability of manufacturer is limited to the foregoing, and manufacturer shall not be liable for any other damages, direct or indirect, sustained or suffered by purchaser of any person. This warranty is supplied to the buyer in place of all other warranties, expressed or implied. Seller does not warrant as to merchantability or fitness for a particular use, nor will any oral statement constitute a warranty or amend this specific warranty. Abnormal use, abuse of the fixture, improper installation, or repair, or modification of the fixture without prior written authorization from the manufacturer, will render the warranty void.

HRR-07006 150W

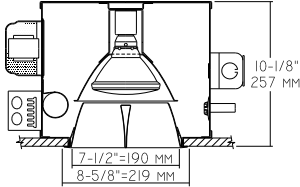

35° MEDIUM FLOOD

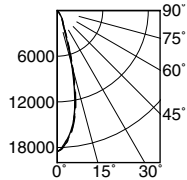

S/MH 0.5

Cone of Light*

Ft.	FC	Dia.
10	185.0	4.7
15	82.2	7.0
20	46.2	9.4
25	29.6	11.7
30	20.6	14.1
35	15.1	16.4

CANDLEPOWER DISTRIBUTION					
	0.0	22.5	45.0	67.5	90.0
0	18498	18498	18498	18498	18498
5	16844	16995	16860	16782	16697
15	7895	7922	7922	7911	7322
25	1743	1697	1720	1720	1774
35	659	647	732	693	682
45	132	70	62	74	116
55	8	4	4	8	8
65	0	0	0	0	0
75	0	0	0	0	0
85	0	0	0	0	0
90	0	0	0	0	0

EFFIC: 56.9%
ITL TEST #51219
 *LER = 25.7
 •AEC = \$9.33

20° SPOT

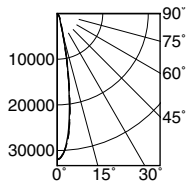

S/MH 0.3

Cone of Light*

Ft.	FC	Dia.
10	319.4	3.2
15	142.0	4.9
20	79.9	6.5
25	51.1	8.1
30	35.5	9.8
35	26.1	11.4

CANDLEPOWER DISTRIBUTION					
	0.0	22.5	45.0	67.5	90.0
0	31942	31942	31942	31942	31942
5	27357	27357	27241	27048	26855
15	4777	5257	5299	5577	5040
25	1337	1523	1608	1569	1345
35	618	715	777	723	611
45	100	70	50	73	100
55	0	0	0	0	0
65	0	0	0	0	0
75	0	0	0	0	0
85	0	0	0	0	0
90	0	0	0	0	0

EFFIC: 57.3%
ITL TEST #51218
 *LER = 25.9
 •AEC = \$9.27

* LER (Luminaire Efficacy Rating) = Luminaire Effic. x Total Lamp Lumens x Ballast Factor / Input Watts

• AEC = Annual Energy Cost per 1000 lumens (based on 3000 hours use @ \$0.08 KWH).

SUBMITTAL DATA

JOB NAME
 TYPE
 WATTAGE
 VOLTAGE
 CATALOG NUMBER

APPROVAL STAMP