

CATALOG #	TYPE	
JOB NAME	WATTAGE	VOLTAGE

6" T6 CERAMIC METAL HALIDE 150 WATT MAXIMUM HRR-06322

Ellipsoidal T6 Downlight: For Shallow Plenums
Uniform Illumination with 1.2 SC

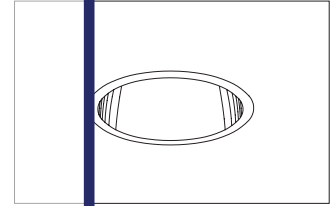

Only 6 1/4" Total Depth

Specifications

Lamp

- Designed for horizontal T6 bi-pin ceramic metal halide lamp.
- Up to 96 CFM, 12,000-15,000 hour life.
- For lower wattages, see Option -43.

Socket (5kV rated)

- G12 bi-pin base.
- Porcelain body. Silicone leads.

Reflectors

- Upper: Ellipsoidal specular Alzak® aluminum.
- Lower: Low brightness specular Alzak® aluminum, self-flanged.
- Optional reflector finishes / colors available.

Lens: UV Absorbing

- Tempered plastic glass mounted to upper reflector. (WFL 1.2 SC)

Electronic Ballast

- Full electronic circuit provides constant color and constant wattage, ensuring consistent performance and long life.

THIS PRODUCT IS NO LONGER AVAILABLE

Please consult

QUOTATIONS

for the best alternative.

- Input voltage 120V-277V AC, 50/60 Hz. For other voltages, see Options.
 - 150 watt standard. Add Option -43 and specify for 100, 70, 39 or Type IC 20 watt.
 - Minimum starting temperature: 20°C/-4°F.
 - Lamp Mounting Crests: less than 1.5mm.
 - Lampily protected. Provides automatic shut-off if rated temperature is exceeded.
 - Internally fused.
 - Power factor greater than 90%.
 - Input current THD less than 15%.
 - Maximum 85°C operation, Sound Rated A.
 - Includes lamp end-of-life detection and auto-restart circuit.
- ### Aluminum Housing
- Acrylic enameled. Rustproof. Corrosion resistant. E-6063 3003 or A6061.
 - Spray finished.
 - Light weight. Makes hanging easy.
 - Cool operation: Extends component life.
 - Minimizes HVAC load.
 - Available in fire spray resistant coating through removable trim.

- Built-in plaster frame.
- ### Outlet Box
- Prewired 14 GA (NEC) galvanized steel, UL listed; with removable insulated cover.
 - 1/2" and 3/4" knockouts.
- ### Installation
- 27" galvanized hanger bars with adjustable mounting brackets (2) supplied.
 - Recesses indoor or outdoor in covered locations.
 - See "MARKED SPACINGS CAUTION" below.
- ### UL, C-UL (Canada) Listings
- Wet, damp or dry locations, covered ceilings.
 - Through-branch circuit conductors (6 #12).
 - Type IC, 20 watt only.
- ### Three Year Limited Warranty
- Complete standard fixture, including ballast.

Performance at a Glance

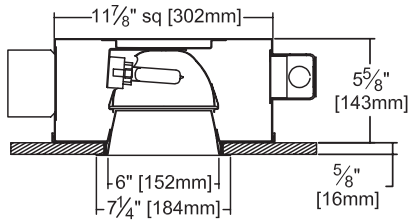

Ceiling Cut-out
6 1/2" Dia.

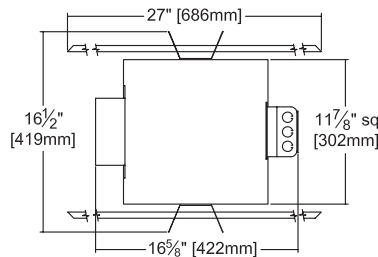

STANDARD

SC: 1.2
Effic: 63.1%
ITL Test: 53648

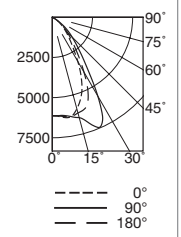

"MARKED SPACINGS CAUTION"

FOR STANDARD 150W ONLY, INSTALL WITH MINIMUM SPACINGS AS FOLLOWS: 2 FEET BETWEEN CENTERS OF ADJACENT FIXTURES; 1/2" BETWEEN FIXTURE TOP AND OVERHEAD BUILDING MEMBER; 1 FOOT BETWEEN FIXTURE CENTER AND SIDE WALL.

THE KIRLIN COMPANY

3401 EAST JEFFERSON AVENUE • DETROIT, MICHIGAN 48207-4232
(313) 259-6400 • Fax: (313) 259-9409 OR (313) 259-3121 • www.kirlinlighting.com

COMPACT PULSE START
METAL HALIDE LIGHTING

MAXIMUM WATTAGE

150

CATALOG NUMBER

HRR-06322

DUE TO OUR CONTINUING EFFORT TO IMPROVE PRODUCTS, TECHNICAL INFORMATION IS SUBJECT TO CHANGE WITHOUT NOTICE.

Alzak® is a registered trademark of ALCOA.

Detailed Photometry - Installed Fixture

Photometry from I.T.L., Boulder, CO

LIMITED WARRANTY: CATALOGED KIRLIN FIXTURES ARE WARRANTED FREE OF DEFECTS IN WORKMANSHIP OR MATERIAL FOR THREE YEARS FROM DATE OF PURCHASE. INSTALLATION IN E.C. IN NORMAL USE. Manufacturer of the fixture will neither be liable for, nor defend the purchase price on replacement of product purchased and defective fixture at the office of manufacturer of Kirlin. In no event shall manufacturer be liable for any consequential or incidental damages. This warranty is applied to the fixture in place of all other warranties expressed or implied. Seller does not warrant as to merchantability or fitness for a particular use, nor will any oral statement constitute a warranty or amend this specific warranty. Abnormal use, abuse of the fixture, improper installation, or repair, or modification of the fixture without prior written authorization from the manufacturer will render the warranty void.

STANDARD

Effic: 63.1%
ITL Test: 53648



Cone of Light ▲

Dist.	FC	Dia.
6	170.2	6.9
8	95.7	9.2
10	61.3	11.4
12	42.5	13.7
14	31.3	16.0
16	23.9	18.3

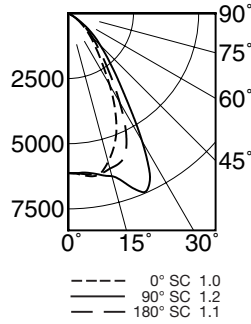

	CANDLEPOWER DISTRIBUTION				
	0.0	45.0	90.0	135.0	180.0
0	6127	6127	6127	6127	6127
5	6233	6208	6132	6183	6183
15	5898	6501	6467	6585	6166
25	4306	5806	7305	6065	5278
35	2178	3309	3678	3418	2714
45	1106	1483	1734	1466	1324
55	436	553	620	511	486
65	17	34	25	25	34
75	0	0	0	0	0
85	0	0	0	0	0
90	0	0	0	0	0

▲ Cone of Light Key

- Ft. Distance from fixture
 - FC Footcandles at nadir (0°)
 - Dia. Circle of light at 50% of FC
- Dia. (in ft.) shown is where FC value is half the FC at nadir.

Photometry based on: 14,000 lumens - 150W

Options

Lower Reflector (Self-Flanged)

- 30 All White. (CP x 1.1)
- 31 White flange (only).
- 32 White trim ring to cover larger ceiling opening. Specify outer diameter of ring.
- 45 Gasket above flange. Stops dust streaks on ceiling.
- 69 Wheat specular Alzak. (CP x .92) Consult factory.
- 70 Clear SofTex. (CP x .92)
- 77 Pewter SofTex. (CP x .85) Consult factory.
- 91 Wheat SofTex. (CP x .88) Consult factory.
- 93 Pewter specular Alzak. (CP x .88) Consult factory.
- 94 Custom color. Consult factory.

Relays, Standbys, Lamps

- 49 Extra circuit DCB socket (up to 75W). Do not energize simultaneously with main source. Also see Option -LS.
- 65 Electronic standby system and DCB socket (up to 75W). Provides immediate light until CMH strikes. Also see Options -66 and -LS.
- 66 Electronic time delay standby system and DCB socket (up to 75W). Provides light until CMH reaches 70% output. Also see Option -LS.
- LP With lamp. Specify source, wattage, color temperature / brand. 3000°K standard; consult factory for others.
- LS With T4 DCB tungsten halogen standby lamp (75W). Use only with Options -49, -65 or -66.

Wattage and Voltage

- 43 Lower wattage. T6: specify for 100W, 70W, 39W or Type IC 20W.
- 347 347 volt.
- 97 Other input voltage instead. Consult factory.

Other Options

- 79 Extension collar for up to 2" thick ceilings.
- 99 Special modification. Consult factory.

SUBMITTAL DATA

APPROVAL STAMP

JOB NAME

TYPE

WATTAGE

VOLTAGE

CATALOG NUMBER