

CATALOG #	TYPE	
JOB NAME	WATTAGE	VOLTAGE

6" T4.5 CERAMIC METAL HALIDE 70 WATT MAXIMUM HRR-06305

Ellipsoidal T4.5 Lensed 6" Wall Wash
LookAlite™ Compatible Downlight Fixture

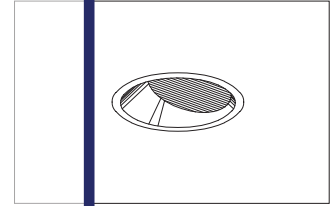

6" Dual Reflector Design (Optional T4)

Specifications

Lamp

- Designed for 25° offset T4.5 bi-pin or T4 twist-and-lock (see Option -T4) ceramic metal halide lamp.
- Up to 95 CPM, 12,000-15,000 hour life.
- For lower wattages, see Option -43.

Socket (5kV rated)

- G8.5 base. G6.5 base for T4 (Option -T4).
- Porcelain body. Silicone leads.

Reflectors

- Upper: Ellipsoidal specular Alzak® aluminum.
- Lower: Low brightness angle cut specular Alzak® aluminum, self-flanged.
- Optional reflector finishes / colors available.

Lens: UV Absorbing

- Frosted linear glass lens mounted on a reflector.

Electronic Ballast

- Full electronic circuitry provides consistent color and constant wattage, ensuring consistent performance and long life.

THIS PRODUCT IS NO LONGER AVAILABLE

Please consult **QUOTATIONS** for the best alternative.

- Input voltage 120V (577V 50/60 Hz). For other voltages, see Options.
- 70 watt standard. Add Option -43 for 39 watt. Specify for 39 watt CDM or 70 watt T4.5.
- T4, 39 watt standard or add Option -43 for Type IC 20 watt.
- Minimum starting temperature 20°C/-4°F.
- Environment Creators: Compliant with 1.5.
- Emergency Protection: Provides automatic shut-off if rated temperature is exceeded.
- Internally fused.
- Power factor greater than 90%.
- Input current THD less than 15%.
- Maximum 90°C operation, Sound Rated A.
- Longest lamp operating life: 15,000 hours.
- UL listed.
- Aluminum Housing
- Acrylic enameled. Bump proof. Corrosion resistant. ETL listed. 1000 psi. AS 1000 psi.
- Lightweight. Minimizes ceiling load.
- Cool operation: Extends component life.
- Microprocessor controlled.
- Removable trim.

- Built-in plaster frame.
- Outlet Box**
- Prewired 14 GA (NEC) galvanized steel, UL listed; with removable insulated cover.
- 1/2" and 3/4" knockouts.
- Installation**
- 27" galvanized hanger bars with adjustable mounting brackets (2) supplied.
- Recesses indoor or outdoor in covered locations.
- UL, C-UL (Canada) Listings**
- Wet, damp or dry locations, covered ceilings.
- Through-brand circuit conductors (6 #12).
- 20 watt only.
- Warranty**
- Complete standard fixture, including ballast.

Performance at a Glance

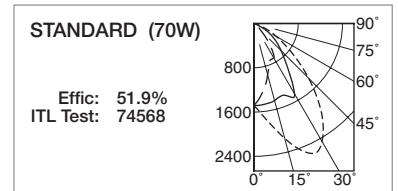
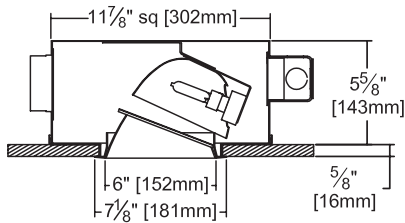

Ceiling Cut-out 6 1/2" Dia.

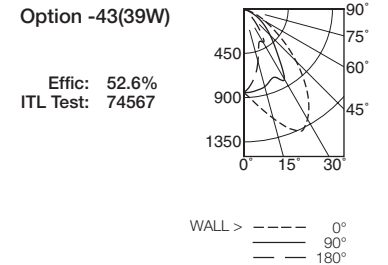
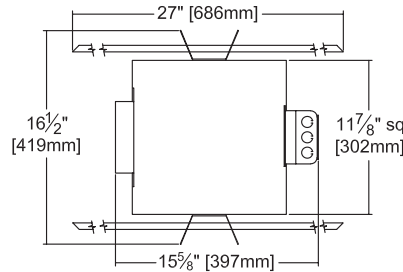

THE KIRLIN COMPANY

3401 EAST JEFFERSON AVENUE • DETROIT, MICHIGAN 48207-4232
(313) 259-6400 • Fax: (313) 259-9409 OR (313) 259-3121 • www.kirlinlighting.com

COMPACT PULSE START
METAL HALIDE LIGHTING

MAXIMUM WATTAGE

70

CATALOG NUMBER

HRR-06305

DUE TO OUR CONTINUING EFFORT TO IMPROVE PRODUCTS, TECHNICAL INFORMATION IS SUBJECT TO CHANGE WITHOUT NOTICE.

Alzak® is a registered trademark of ALCOA.

Detailed Photometry - Installed Fixture

Photometry from I.T.L., Boulder, CO

STANDARD (70W)

Effic: 51.9%
ITL Test: 74568

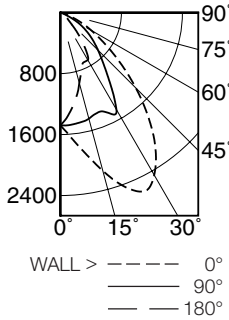

CANDLEPOWER DISTRIBUTION					
	0.0	45.0	90.0	135.0	180.0
0	1479	1479	1479	1479	1479
5	1650	1602	1479	1372	1327
15	2149	1887	1441	1112	957
25	2587	2122	1445	899	720
35	2173	1825	1139	636	560
45	1398	1339	697	252	179
55	707	848	407	101	69
65	277	392	115	7	0
75	46	59	4	0	0
85	0	0	0	0	0
90	0	0	0	0	0

DISTANCE FROM CEILING IN FEET	SINGLE FIXTURE					MULTIPLE FIXTURES					
	1'	2'	3'	4'	3' CENTERS		4' CENTERS				
	FIXTURE INSTALLED 2' FROM WALL Footcandle Distribution on Wall Surface										
1	61.1	38.4	12.9	3.6	1.5	71.1	52.4	71.1	14.9	12.9	14.9
2	126.0	87.8	42.5	17.0	5.6	162.0	133.0	162.0	53.9	50.5	53.9
3	98.4	77.4	42.0	20.1	10.0	143.0	134.0	143.0	79.4	70.7	79.4
4	59.2	50.4	32.1	18.0	10.0	104.0	101.0	104.0	76.7	73.1	76.7
5	33.4	30.6	22.7	14.6	9.0	71.2	72.9	71.2	65.7	63.4	65.7
6	19.7	18.6	15.6	11.5	7.7	51.2	52.0	51.2	52.8	52.2	52.8
7	12.7	12.2	10.7	8.9	6.6	39.3	39.2	39.3	42.1	43.1	42.1
8	8.9	8.7	7.9	6.8	5.6	31.1	31.5	31.1	34.4	35.3	34.4
9	6.9	6.7	6.3	5.6	4.8	26.1	26.8	26.1	29.6	29.7	29.6

Option -43(39W)

Effic: 52.6%
ITL Test: 74567

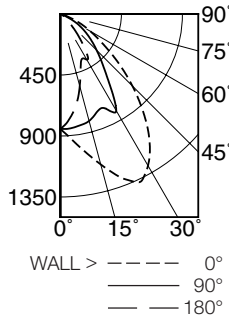

CANDLEPOWER DISTRIBUTION					
	0.0	45.0	90.0	135.0	180.0
0	848	848	848	848	848
5	927	902	847	796	775
15	1149	1028	817	644	551
25	1370	1121	766	469	370
35	1146	950	632	364	319
45	751	694	378	142	103
55	380	445	215	58	40
65	155	221	61	5	1
75	23	30	2	0	0
85	0	0	0	0	0
90	0	0	0	0	0

DISTANCE FROM CEILING IN FEET	SINGLE FIXTURE					MULTIPLE FIXTURES					
	1'	2'	3'	4'	3' CENTERS		4' CENTERS				
	FIXTURE INSTALLED 2' FROM WALL Footcandle Distribution on Wall Surface										
1	33.9	21.6	6.9	1.9	0.8	39.1	25.9	39.1	7.9	6.8	7.9
2	67.5	46.9	22.4	9.0	2.9	86.9	70.6	86.9	29.0	27.7	29.0
3	51.9	40.7	21.8	10.3	5.1	74.9	69.7	74.9	42.4	37.7	42.4
4	31.2	26.5	16.8	9.3	5.1	54.1	52.7	54.1	40.3	38.4	40.3
5	17.6	16.2	12.0	7.6	4.6	37.3	35.4	37.3	34.3	33.2	34.4
6	10.5	9.9	8.3	6.1	4.0	27.1	27.5	27.1	27.6	27.4	27.6
7	6.8	6.5	5.7	4.8	3.5	20.9	20.8	20.9	22.1	22.7	22.1
8	4.8	4.7	4.2	3.6	3.0	16.6	16.9	16.6	18.1	18.6	18.1
9	3.7	3.7	3.4	3.0	2.6	14.1	14.4	14.1	15.7	15.7	15.7

Photometry based on: 6200 lumens - 70W
3300 lumens - 39W

Options

Lower Reflector (Self-Flanged)

- 30 All White. (CP x 1.1)
- 31 White flange (only).
- 32 White trim ring to cover larger ceiling opening. Specify outer diameter of ring.
- 45 Gasket above flange. Stops dust streaks on ceiling.
- 69 Wheat specular Alzak. (CP x .92) Consult factory.
- 70 Clear SofTex. (CP x .92)
- 77 Pewter SofTex. (CP x .85) Consult factory.
- 91 Wheat SofTex. (CP x .88) Consult factory.
- 93 Pewter specular Alzak. (CP x .88) Consult factory.
- 94 Custom color. Consult factory.

Relays, Standbys, Lamps

- 49 Extra circuit DCB socket (up to 75W). Do not energize simultaneously with main source. Also see Option -LS.
- 65 Electronic standby system and DCB socket (up to 75W). Provides immediate light until CMH restrikes. Also see Options -66 and -LS.
- 66 Electronic time delay standby system and DCB socket (up to 75W). Provides light until CMH reaches 70% output. Also see Option -LS.
- LP With lamp. Specify source, wattage, color temperature / brand. 3000°K standard; consult factory for others.
- LS With T4 DCB tungsten halogen standby lamp (75W). Use only with Options -49, -65 or -66.

Wattage and Voltage

- 43 Lower wattage:
T4.5: specify 39W or Type IC 20W
With Option -T4: Type IC 20W only
- 347 347 volt.
- 97 Other input voltage instead. Consult factory.
- T4 Converted to GU6.5 base for twist-and-lock T4 lamp. 39W standard. Add Option -43 for 20 watt Type IC.

Other

- 99 Special modification. Consult factory.

SUBMITTAL DATA

JOB NAME

TYPE

WATTAGE

VOLTAGE

CATALOG NUMBER

APPROVAL STAMP

LIMITED WARRANTY: KIRLIN CATALOGED KIRLIN FIXTURES ARE WARRANTED FREE OF DEFECTS IN WORKMANSHIP OR MATERIAL FOR THREE YEARS FROM DATE OF PURCHASE. INSTALLED TO N.E.C. IN NORMAL USE. Manufacturer of the fixture will replace or repair each fixture or refund the purchase price on replacement of fixture if purchase and defective fixture at the offices of manufacturer. Limited manufacturer's warranty is void if fixture is modified or altered in any way. This warranty is supplied to the buyer on the face of all orders. Warrant does not cover damage to fixture caused by misuse, abuse, or modification of the fixture without prior written authorization from the manufacturer will render the warranty void. does not warrant as to merchantability or fitness for a particular use, nor will any oral statement constitute a warranty or amend this specific warranty. Abnormal use, abuse of the fixture, improper installation, or repair, or modification of the fixture without prior written authorization from the manufacturer will render the warranty void.