

CATALOG #	TYPE	
JOB NAME	WATTAGE	VOLTAGE

6" T4.5 CERAMIC METAL HALIDE 70 WATT MAXIMUM HRR-06303

T4.5 Adjustable: 70, 39, 20 Watt in 6" Aperture  
Three Distributions Available

# THIS PRODUCT IS NO LONGER AVAILABLE

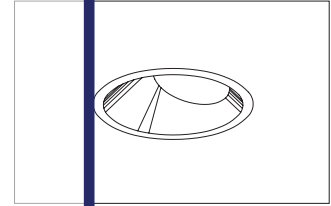

6" Dual Reflector Design (Optional T4)

## Specifications

### Lamp

- Designed for adjustable T4.5 (Option -T4) T4 twist-and-lock (see Option -T4) ceramic metal halide lamp.
- Up to 95 CFM, 12,000-15,000 hour life.
- For lower wattages, see Option -43.

### Socket (5kV rated)

- G8.5 base. (U6.5 base for T4 (Option -T4))
- Porcelain body. Silicone leads.

### Reflectors

- Upper: Parabolic specular Alzak® aluminum. Swivels 358° tilts up to 45°.
- Lower: Low brightness specular Alzak® aluminum, self-flanged.
- Optional reflector finishes / colors available.

### Lens: UV Absorbing

- Clear tempered glass mounted to standard NFL distribution (0.2 SC).
- See Options for -SPT (0.2 SC) and -MFL (0.2 SC) distributions.

### Electronic Ballast

- Full electronic circuit provides constant color and constant wattage, ensuring consistent performance and long life.

- Input voltage 120-277V AC (High Pressure Sodium lamps, see Options)
- 70 watt standard. Arc/Current: 40 and specify for 39 or type IC 20 watt. For Option -T4, 39 watt standard or add Option -43 for Type IC 20 watt.
- Minimum starting temperature: 20°C/-4°F
- Maximum ambient temperature: 1.5°C/2.7°F
- The lamp will shut off if rated temperature is exceeded.
- Internally fused.
- Power factor greater than 90%.
- Input current THD less than 15%.
- Maximum 90°C operation. Sound Rated.

- UL, C-UL (Canada) Listings
- Wet, damp or dry locations, covered ceilings.
- Through-branch circuit conductors (6 #12).
- UL, C-UL (Canada) Listings
- Wet, damp or dry locations, covered ceilings.
- Through-branch circuit conductors (6 #12).

### Aluminum Housing

- Lightweight. Minimizes ceiling load.
- Cool operation. Extends component life.
- Entire luminaire serviced from below through removable trim.

- Built-in plaster frame.
- Outlet Box**
- Prewired 14 GA (NEC) galvanized steel, UL listed; with removable insulated cover.
- 1/2" and 3/4" knockouts.
- Installation**
- 27" galvanized hanger bars with adjustable mounting brackets (2) supplied.
- Recesses indoor or outdoor in covered locations.
- UL, C-UL (Canada) Listings**
- Wet, damp or dry locations, covered ceilings.
- Through-branch circuit conductors (6 #12).
- UL, C-UL (Canada) Listings
- Wet, damp or dry locations, covered ceilings.
- Through-branch circuit conductors (6 #12).
- UL, C-UL (Canada) Listings
- Wet, damp or dry locations, covered ceilings.
- Through-branch circuit conductors (6 #12).
- UL, C-UL (Canada) Listings
- Wet, damp or dry locations, covered ceilings.
- Through-branch circuit conductors (6 #12).

Please consult **QUOTATIONS** for the best alternative.

## Performance at a Glance

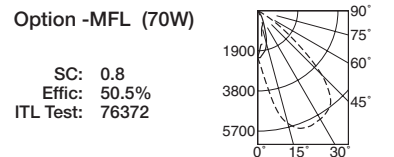
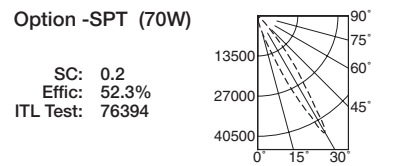
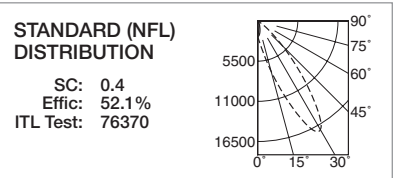
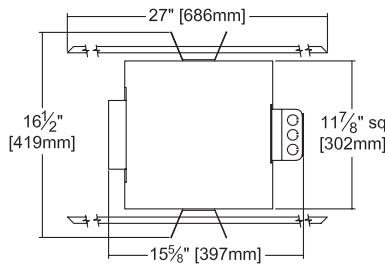
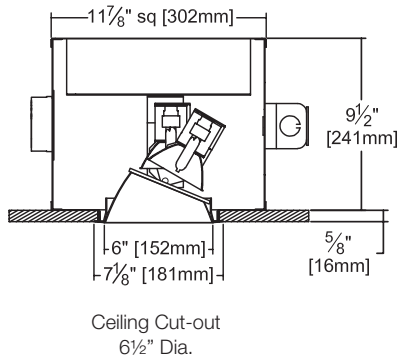

# THE KIRLIN COMPANY

3401 EAST JEFFERSON AVENUE • DETROIT, MICHIGAN 48207-4232  
(313) 259-6400 • Fax: (313) 259-9409 OR (313) 259-3121 • www.kirlinlighting.com

COMPACT PULSE START  
METAL HALIDE LIGHTING

MAXIMUM WATTAGE

70

CATALOG NUMBER

HRR-06303

DUE TO OUR CONTINUING EFFORT TO IMPROVE PRODUCTS, TECHNICAL INFORMATION IS SUBJECT TO CHANGE WITHOUT NOTICE.

Alzak® is a registered trademark of ALCOA.

## Detailed Photometry - Installed Fixture

Photometry from I.T.L., Boulder, CO

### STANDARD (NFL) (70W)

SC: 0.4  
Effic: 52.1%  
ITL Test: 76370

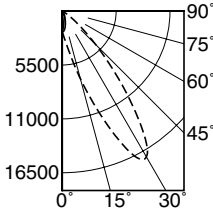

CANDLEPOWER DISTRIBUTION					
	0.0	45.0	90.0	135.0	180.0
0	2076	2076	2076	2076	2076
5	2867	2552	2010	1632	1481
10	7131	3418	1243	799	729
15	15500	2823	622	330	277
20	13710	1366	220	61	36
25	4827	373	32	13	10
30	938	45	8	5	4
35	24	5	2	3	2
40	0	0	0	0	0
45	0	0	0	0	0
90	0	0	0	0	0

### Option -SPT (70W)

SC: 0.2  
Effic: 52.3%  
ITL Test: 76394

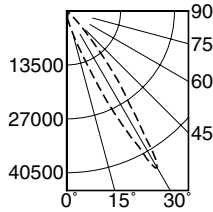

CANDLEPOWER DISTRIBUTION					
	0.0	45.0	90.0	135.0	180.0
0	1864	1864	1864	1864	1864
5	1804	1962	1811	1362	1193
10	5565	2430	860	777	759
15	28085	1877	630	101	50
20	25361	810	62	14	7
25	3767	124	12	10	8
30	124	19	6	7	5
35	12	2	2	0	0
40	0	0	0	0	0
45	0	0	0	0	0
90	0	0	0	0	0

### Option -MFL (70W)

SC: 0.8  
Effic: 50.5%  
ITL Test: 76372

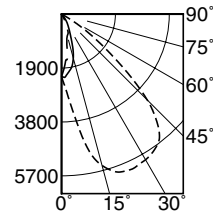

CANDLEPOWER DISTRIBUTION					
	0.0	45.0	90.0	135.0	180.0
0	2193	2193	2193	2193	2193
5	3012	2705	2137	1778	1654
10	5523	4595	1602	876	786
15	6001	4918	678	365	340
20	5771	2433	289	987	51
25	4277	752	54	19	13
30	1241	108	14	5	4
35	32	8	3	2	2
40	2	2	0	0	0
45	0	0	0	0	0
90	0	0	0	0	0

Photometry based on: 7650 lumens - 70W

▲ Cone of Light Key  
(Dia. (in ft.) shown is where FC value is half the FC at nadir)

Ft. Distance from fixture  
FC Footcandles at nadir (0°)  
Dia. Circle of light at 50% of FC

## Options

### Distributions

- SPT Spot distribution. (0.2 SC)
- MFL Medium flood distribution. (0.8 SC)

### Lower Reflector (Self-Flanged)

- 30 All White. (CP x 1.1)
- 31 White flange (only).
- 32 White trim ring to cover larger ceiling opening. Specify outer diameter of ring.
- 45 Gasket above flange. Stops dust streaks on ceiling.
- 69 Wheat specular Alzak. (CP x .92) Consult factory.
- 70 Clear SofTex. (CP x .92)
- 77 Pewter SofTex. (CP x .85) Consult factory.
- 91 Wheat SofTex. (CP x .88) Consult factory.
- 93 Pewter specular Alzak. (CP x .88) Consult factory.

- 94 Custom color. Consult factory.

### Relays, Standbys, Lamps

- 49 Extra circuit DCB socket (up to 75W). Do not energize simultaneously with main source. Also see Option -LS.
- 65 Electronic standby system and DCB socket (up to 75W). Provides immediate light until CMH strikes. Also see Options -66 and -LS.
- 66 Electronic time delay standby system and DCB socket (up to 75W). Provides light until CMH reaches 70% output. Also see Option -LS.
- LP With lamp. Specify source, wattage, color temperature / brand. 3000°K standard; consult factory for others.
- LS With T4 DCB tungsten halogen standby

- lamp (75W). Use only with Options -49, -65 or -66.

### Wattage and Voltage

- 43 Lower wattage:  
T4.5: specify 39W or Type IC 20W  
With Option -T4: Type IC 20W only
- 347 347 volt.
- 97 Other input voltage instead. Consult factory.
- T4 Converted to GU6.5 base for twist-and-lock T4 lamp. 39W standard. Add Option -43 for 20 watt Type IC.

### Other

- 99 Special modification. Consult factory.
- TA Top access; for servicing from above ceiling.

## SUBMITTAL DATA

JOB NAME

TYPE

WATTAGE

VOLTAGE

CATALOG NUMBER

## APPROVAL STAMP

LIMITED WARRANTY: CATALOGED KIRLIN FIXTURES ARE WARRANTED FREE OF DEFECTS IN WORKMANSHIP OR MATERIAL FOR THREE YEARS FROM DATE OF PURCHASE. INSTALLATION IN NORMAL USE. Manufacturer of the fixture will not be held responsible for any damage or injury to property or persons. This warranty is applied to the fixture in place of all other warranties expressed or implied. Seller does not warrant as to merchantability or fitness for a particular use, nor will any oral statement constitute a warranty or amend this specific warranty. Abnormal use, abuse of the fixture, improper installation, or repair, or modification of the fixture without prior written authorization from the manufacturer will render the warranty void.