

Recessed Upper Arm Fixture
Lensed E-Lamp Fixture
Horizontal Downlight:
50 to 100 Watt

THIS PRODUCT IS NO LONGER AVAILABLE

6" 100W HRR-06042

Features

Lamp

- Designed for medium base metal halide or E-lamps. See chart below for standard and optional wattages.
- See Option -43 and chart below for lower wattage if HPS availability.

Socket

- Horizontal. Medium base. Pulse rate porcelain.
- Glazed porcelain.
- Nickel-plated brass screw shell. Silicone leads.

Reflectors

- Upper: Epoisoidal specular Alzak® aluminum.
- Lower: Low brightness parabolic Alzak aluminum, self-flanged.
- Fourteen optional lower reflector finishes.

Lens

- UV absorbing tempered glass mounted to upper reflector. Also see Options.

AVAILABLE

Please consult

QUOTATIONS

for the best alternative.

- Lamp Assembly Specifications**
- Class H, high reactance for 120 volt and Options -65, -66; linear reactor for 277 volt.
 - Capacitor and ignitor supplied.
 - Dimming (-39) and electronic (-96) ballasts available. See Options.
 - Cool: Dissipates heat across entire surface of reflector. Exceeds 1000 hrs. MTBF. Includes spray test.
 - Acrylic enameled aluminum.
 - Through-branch circuit conductors (6 #12).
 - Standard and optional mounting brackets.
 - Per current NEC.

- Entire luminaire serviced from below through removable reflectors.
- Built-in 2" extended plaster frame for thick ceilings.

Outlet Box

- Rewired 14 GA (NEC) galvanized steel, UL listed; with removable insulated cover.
- 1/2" and 3/4" knockouts.

Installation

- 27" galvanized hanger bars supplied (2).
- Fully adjustable universal mounting brackets supplied (2).
- Recesses indoor or outdoor in covered locations.

UL, C-UL (Canada) Listings

- Wet, damp or dry locations, covered ceilings.
- Through-branch circuit conductors (6 #12).
- **Three Year Limited Warranty**
- Includes standard fixture, including ballast.
- Includes UL listing for UL and C-UL.
- Per current NEC.

Wattage / Lamp Availability and Cut-out Dimensions

Catalog No.	Lamp/Base	Standard Wattage		Option -43: Lower Wattage		Max. Standby Wattage (-49-65-66-LS)	Ceiling Cut-Out Diameter
		Pulse MH	-24 (HPS)	Pulse MH	-24 (HPS)		
HRR-06042	ED-17/Med	100	100	50-70	35-70	100	6.5"

Options

Sources and Ballasts

- 24 HPS ballast instead. See wattage chart above for available wattages. Specify voltage.
- 39 Electronic dimming ballast instead, for pulse start metal halide. Consult factory for wattage and voltage availability.
- 96 Regulating electronic MH ballast instead.

Wattage and Voltage

- 43 Lower wattage: See Option -43 chart above for available lower wattages. Specify voltage.
- 120 120 volt, 60 Hz. ballast.
- 277 277 volt, 60 Hz. ballast.
- 347 347 volt, 60 Hz. ballast. Consult factory for dimming or electronic.
- 97 Other voltage ballast instead. Consult factory.

Relays, Standbys, Lamps (See Chart)

- 49 Extra circuit DCB socket. Do not energize simultaneously with main source. Also see -LS.
- 65 Electronic standby system and DCB socket. Following HID outage, provides immediate light until HID restrikes. Also see -66 and -LS.

- 66 Electronic time delay standby system and DCB socket. Following outage, provides light until HID reaches 70% output. Also see Option -LS.
- LP With lamp. Specify source, wattage, color temperature, and clear or coated. (3700°K standard for metal halide) Consult factory for other color temperatures.
- LS With T-4 DCB tungsten halogen standby lamp. Use only with Options -49, -65 or -66.

Reflectors and Trims (Self-Flanged)

- 16 Champagne Gold specular Alzak lower cone. (CP x .95)
- 30 All White lower cone or cross baffle. (CP x .95)
- 31 White flange (only) on lower cone or cross baffle.
- 32 Trim extender. Broadens trim flange O.D. by 1" to cover larger ceiling opening.
- 45 Gasket above reflector flange. Stops dust streaks on ceiling.
- 63 Dune specular Alzak lower cone. (CP x .93)
- 69 Wheat specular Alzak lower cone. (CP x .92)
- 70 SofTex Clear etched lower cone. (CP x .92)
- 71 SofTex Dune etched lower cone. (CP x .89)
- 72 Black specular Alzak lower cone. (CP x .77)
- 77 SofTex Pewter etched lower cone. (CP x .85)

- 90 SofTex Champagne Gold etched lower cone. (CP x .90)
- 91 SofTex Wheat etched lower cone. (CP x .88)
- 92 Umber specular Alzak lower cone. (CP x .83)
- 93 Pewter specular Alzak lower cone. (CP x .88)
- 94 Custom color lower cone or cross baffle. Consult factory.
- OG OptiGroove black seamless tapered aluminum lower cone. White trim. (CP x .75)

Lenses

- 15 Prismatic C#73 flat glass lens instead.
- ML UV absorbing tempered Microlux glass instead.

Mounting Options

- 78 Housing modified for concrete pour for HRR-06042 only.
- 82 Sloped ceiling adapter, with mounting hardware. Specify 5° increments up to 30°.
- 85 Ceiling Panel; with recessed fixture hole. Lays-in 2' x 2' grid. White.

Other Options

- 99 Special modification. Consult factory.

HRR-06042

Plan View

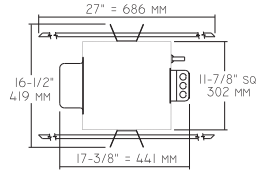

Cone of Light Key

- Ft.** Distance from fixture
- FC** Footcandles (average)
- Dia.** Circle of light at 50% of FC
- * Dia. (in ft.) shown is where FC value is half the FC at nadir.

C.U. (Coefficients of Utilization) Tables are available on request. Please contact your Kirlin representative.

LIMITED WARRANTY: CATALOGED KIRLIN FIXTURES ARE WARRANTED FREE OF DEFECTS IN WORKMANSHIP OR MATERIAL FOR THREE YEARS FROM DATE OF PURCHASE. INSTALLLED TO N.E.C. IN NORMAL USE. Manufacturer at its option will replace or repair, free of charge, the purchase price of the fixture, if it is found to be defective. This warranty is void if the fixture is used in an application not intended by the manufacturer, or if it is used in an application where it is not intended to be used. This warranty is limited to the original purchaser and does not extend to subsequent purchasers. This warranty is supplied to the buyer in place of all other warranties, expressed or implied. Seller does not warrant as to merchantability or fitness for a particular use, nor will any oral statement constitute a warranty or amend this specific warranty. Abnormal use, abuse of the fixture, improper installation, or repair, or modification of the fixture without prior written authorization from the manufacturer will render the warranty void.

HRR-06042 100W

FOR CONCRETE POUR VERSION, SEE OPTION -78

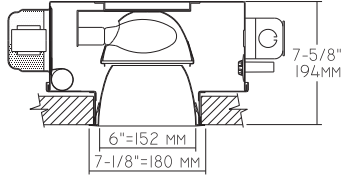

HRR-06042 (Coated Lamp)

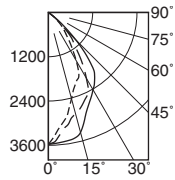

Cone of Light*

Ft.	FC	Dia.
6	99.3	5.7
8	55.8	7.6
10	35.7	9.5
12	24.8	11.4
14	18.2	13.3
16	14.0	15.2

- 0° S/MH 0.7
- 90° S/MH 1.0
- 180° S/MH 1.0

EFFIC: 52.9%

ITL TEST #51347
*LER = 30.0
•AEC = \$8.00

	CANDLEPOWER DISTRIBUTION				
	0.0	45.0	90.0	135.0	180.0
0	3573	3573	3573	3573	3573
5	3166	3326	3540	3515	335
15	2419	2906	3365	3121	2840
25	1941	2285	2655	2582	2486
35	1050	1549	2184	1780	1516
45	481	756	1054	871	696
55	36	42	40	38	24
65	4	6	4	4	4
75	0	0	0	0	0
85	0	0	0	0	0
90	0	0	0	0	0

HRR-06042-15 (Clear Lamp)

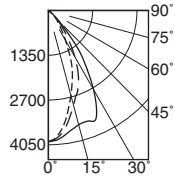

Cone of Light*

Ft.	FC	Dia.
6	109.9	5.6
8	61.8	7.5
10	39.6	9.4
12	27.5	11.2
14	20.2	13.1
16	15.5	15.0

- 0° S/MH 0.7
- 90° S/MH 1.1
- 180° S/MH 0.8

EFFIC: 46.4%

ITL TEST #51348
*LER = 27.7
•AEC = \$8.67

	CANDLEPOWER DISTRIBUTION				
	0.0	45.0	90.0	135.0	180.0
0	3957	3957	3957	3957	3957
5	3727	3820	3882	3867	3801
15	2653	3106	3566	3306	2966
25	1604	2419	3475	2853	2161
35	681	1410	1926	1646	1044
45	266	387	492	460	365
55	16	21	27	27	25
65	3	3	3	4	3
75	0	0	0	0	0
85	0	0	0	0	0
90	0	0	0	0	0

* LER (Luminaire Efficacy Rating) = Luminaire Effic. x Total Lamp Lumens x Ballast Factor / Input Watts

• AEC = Annual Energy Cost per 1000 lumens (based on 3000 hours use @ \$0.08 KWH).

SUBMITTAL DATA

APPROVAL STAMP

JOB NAME

TYPE

WATTAGE

VOLTAGE

CATALOG NUMBER