

CATALOG #	TYPE	
JOB NAME	WATTAGE	VOLTAGE

4" T4.5 CERAMIC METAL HALIDE 70 WATT MAXIMUM

HRR-04302

Parabolic T4.5 Adjustable 70 Watt
Dramatic Highlighting Top Distribution Available

THIS PRODUCT IS NO LONGER AVAILABLE

Specifications

Lamp

- Designed for adjustable T4.5 or for T4 twist-and-lock (see Option -T4) ceramic metal halide lamp.
- Up to 95 CPM, 12,000-15,000 hour life.
- For lower wattages, see Option -43.

Socket (5kV rated)

- G8.5 base. U6.5 base for T4 (Option -T4).
- Porcelain body. Silicone leads.

Reflectors

- Upper: Parabolic specular Alzak® aluminum. Swivels 360° tilts up to 45°.
- Lower: Low brightness specular Alzak® aluminum, self-flanged.
- Optional reflector finishes / colors available.

Lens: UV Absorbing

- Microprismatic glass mounted to wet reflector. Standard NFL distribution.
- See Options for -MFL (0.8 SC) distribution.

Electronic Ballast

- Full electronic circuit provides constant color and constant wattage, ensuring consistent performance and long life.

- Input voltage 120V-277V (6 Hz). For other voltages, see Options.
- 70 watt standard. Add Option -43 and specify for 39 or Type IC 20 watt. For Option -T4, 39 watt standard or add Option -43 for Type IC.
- Minimum starting temperature 20°C/-4°F.
- Large lamp. Tight Fit. Tight Fit.
- Thermally protected. Provides automatic shut-off if rated temperature is exceeded.
- Internally fused.
- Power factor greater than 90%.
- Input current THD less than 15%.
- Operating temperature range -20°C to 50°C.
- Resistor: 1000 ohms, 1000 ohms, 1000 ohms.
- Lightweight. Minimizes ceiling load.
- Operation: Even start, long life.
- AC input: 120V, 277V.
- Entire luminaire serviced from below through

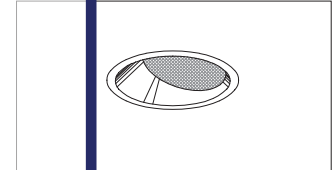

4" Dual Reflector Design (Optional T4)

- removable trim.
 - Built-in plaster frame.
- ### Outlet Box
- Prewired 14 Gauge (NEC) galvanized steel, UL listed; with removable insulated cover.
 - 1/2" and 3/4" knockouts.
- ### Installation
- 27" galvanized hanger bars with adjustable mounting brackets (2) supplied.
 - Recesses indoor or outdoor in covered locations.
- ### UL, C-UL (Canada) Listings
- Wet, damp or dry locations, covered ceilings.
 - Through-branch circuit conductors (6 #12). Type IC: 20 watt only.
- ### Limited Warranty
- 2-year standard fixture, including ballast.

Please consult **QUOTATIONS** for the best alternative.

Performance at a Glance

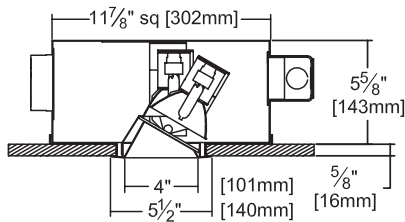

Ceiling Cut-out
5" Dia.

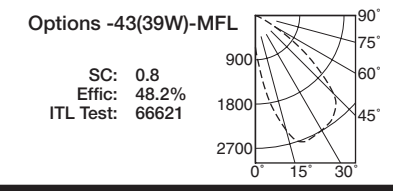
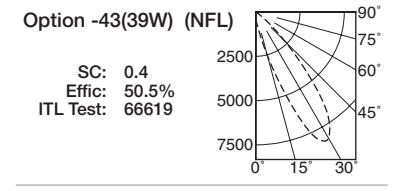
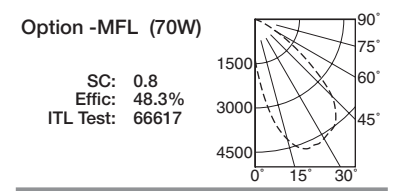
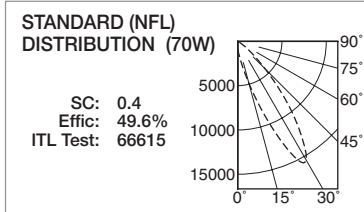
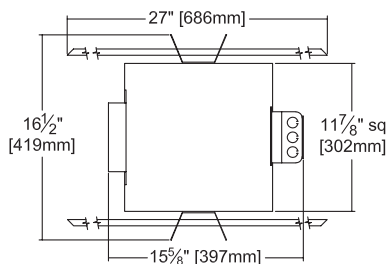

THE KIRLIN COMPANY

3401 EAST JEFFERSON AVENUE • DETROIT, MICHIGAN 48207-4232
(313) 259-6400 • Fax: (313) 259-9409 OR (313) 259-3121 • www.kirlinlighting.com

COMPACT PULSE START
METAL HALIDE LIGHTING

MAXIMUM WATTAGE
70

CATALOG NUMBER
HRR-04302

DUE TO OUR CONTINUING EFFORT TO IMPROVE PRODUCTS, TECHNICAL INFORMATION IS SUBJECT TO CHANGE WITHOUT NOTICE.

Alzak® is a registered trademark of ALCOA.

CATALOG #	TYPE	
JOB NAME	WATTAGE	VOLTAGE

4" T4.5 CERAMIC METAL HALIDE 70 WATT MAXIMUM HRR-04302

Parabolic T4.5 Adjustable: 70, 39, 20 Watt Dramatic Highlighting: Two Distributions Available

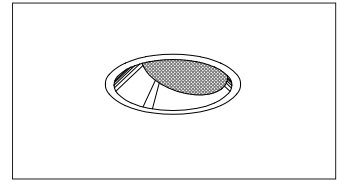

4" Dual Reflector Design
(Optional T4)

Specifications

Lamp

- Designed for adjustable T4.5 bi-pin or T4 twist-and-lock (see Option -T4) ceramic metal halide lamp.
- Up to 95 CRI. 12,000-15,000 hour life.
- For lower wattages, see Option -43.

Socket (5kV rated)

- G8.5 base. GU6.5 base for T4 (Option -T4).
- Porcelain body. Silicone leads.

Reflectors

- Upper: Parabolic specular Alzak® aluminum. Swivels 360°, tilts up to 45°.
- Lower: Low brightness specular Alzak® aluminum, self-flanged.
- Optional reflector finishes / colors available.

Lens: UV Absorbing

- Microprismatic glass mounted to lower reflector. Standard NFL distribution (0.4 SC).
- See Options for -MFL (0.8 SC) distribution.

Electronic Ballast

- Full electronic circuitry provides constant color and constant wattage, ensuring consistent performance and long life.

- Input voltage 120V-277V, 50/60 Hz. For other voltages, see Options.
- 70 watt standard. Add Option -43 and specify for 39 or Type IC 20 watt. For Option -T4, 39 watt standard or add Option -43 for Type IC 20 watt.
- Minimum starting temperature -20°C/-4°F.
- Lamp Current Crest Factor less than 1.5.
- Thermally protected. Provides automatic shut-off if rated temperature is exceeded.
- Internally fused.
- Power factor greater than 90%.
- Input current THD less than 15%.
- Maximum 90°C operation, Sound Rated A.
- Includes lamp end-of-life detection and shutdown circuit.

Aluminum Housing

- Acrylic enameled. Rustproof. Corrosion resistant: Exceeds 1000 hour ASTM 5% salt spray test.
- Lightweight. Minimizes ceiling load.
- Cool operation: Extends component life. Minimizes HVAC load.
- Entire luminaire serviced from below through

- removable trim.
 - Built-in plaster frame.
- #### Outlet Box
- Prewired 14 GA (NEC) galvanized steel, UL listed; with removable insulated cover.
 - 1/2" and 3/4" knockouts.

Installation

- 27" galvanized hanger bars with adjustable mounting brackets (2) supplied.
- Recesses indoor or outdoor in covered locations.

UL, C-UL (Canada) Listings

- Wet, damp or dry locations, covered ceilings.
- Through-branch circuit conductors (6 #12).
- Type IC: 20 watt only.

Three Year Limited Warranty

- Complete standard fixture, including ballast.

Performance at a Glance

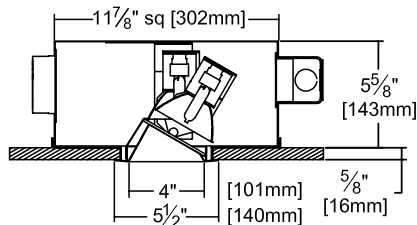

Ceiling Cut-out
5" Dia.

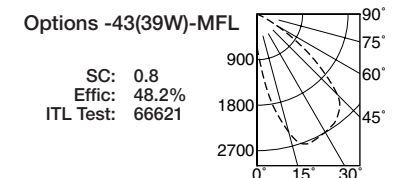
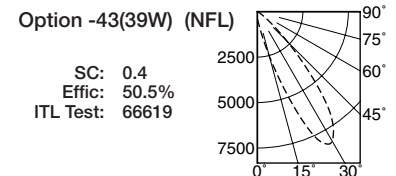
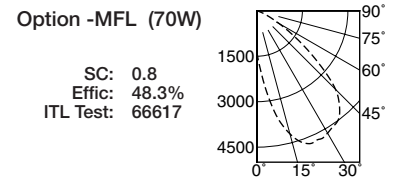
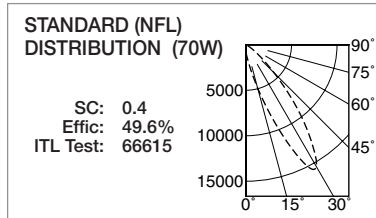
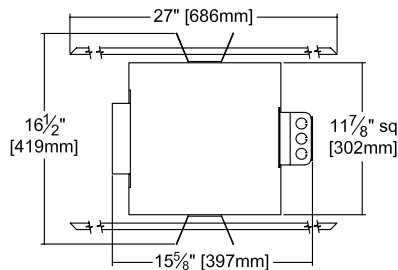

THE KIRLIN COMPANY

3401 EAST JEFFERSON AVENUE • DETROIT, MICHIGAN 48207-4232
(313) 259-6400 • Fax: (313) 259-9409 OR (313) 259-3121 • www.kirlinlighting.com

COMPACT PULSE START
METAL HALIDE LIGHTING

MAXIMUM WATTAGE

70

CATALOG NUMBER

HRR-04302