

CATALOG #	TYPE	
JOB NAME	WATTAGE	VOLTAGE

11" 1 Triple 85 WATT PL-H MAXIMUM

FRR-11133

Downlight with Regressed Lens
Provides Uniform Illumination

THIS PRODUCT IS NO LONGER AVAILABLE

Features

Lamp

- Designed for one 4-pin Philips PL-H triple tube amalgam compact fluorescent lamp: 85 or 60 watt PL-H.
- Long 20,000 hour life.
- High 6,000 lumen output.
- 800 MA high output lamp current.

Ballast: Multi Voltage

- Installed electronic high power factor, thermally protected.
- 120-277 multi-volt; 50/60 Hz. THD <math>< 10\%</math>
- Cold weather -22°F (-30°C).
- End of lamp life protection circuit. RFI filter.
- Internally fused. Also see Option -FS.

Reflector

- Specular Alzak® aluminum.

Trim Assembly

- Tapered aluminum one piece black OptiGroove with white flange. Includes self-flange trim (Option -40) as shown in section view.

- Regressed lens with 17 lenses.
- Acrylic enameled. Rustproof: Exceeds 1000 hour ASTM 5% salt spray test.
- Light weight: limits ceiling load.
- Cool operation: extends lamp life.
- High lumen output through aperture.
- Built-in plaster frame.

Outlet Box

- Prewired 14 GA (NEC) galvanized steel, UL listed. 1/2" and 3/4" knockouts.

Installation

- 27" galvanized trim with adjustable mounting brackets (2) included.
- Recesses indoor or outdoor in covered locations.
- UL, E-UL and dimming.
- Venting of dry pipe or gas pipe calling for through-branch conductors (#12).

Three Year Limited Warranty

- Complete satisfaction guarantee.

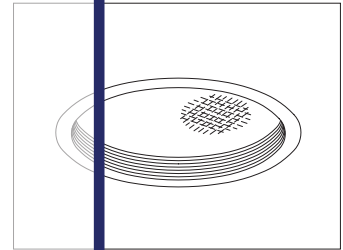

Long Life
High Lumen Output

Selected Optional Trims:

- White Grooveless Flare Option -40
- Fresnel Lens Option -FR

Please consult **QUOTATIONS** for the best alternative.

Performance at a Glance

FRR-11133

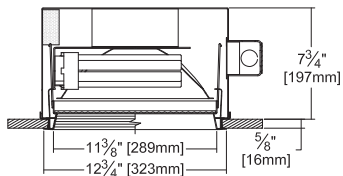

Option -40 Also Shown

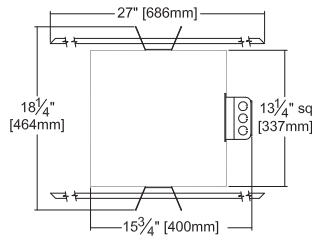

Ceiling Cut-out
12 1/4"

- Cone of Light Key**
- Ft. Distance from fixture
 - FC Footcandles at nadir (0°)
 - Dia. Circle of light at 50% of FC
 - * Dia. (in ft.) shown is where FC value is half the FC at nadir.

FRR-11133 (1 PL-H 85W)

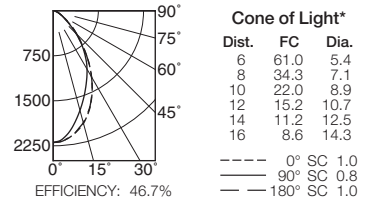

FRR-11133 (1 PL-H 60W)

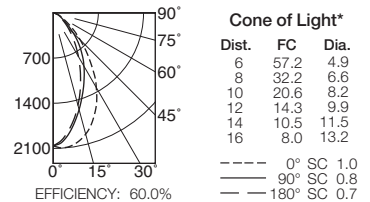

THE KIRLIN COMPANY

3401 EAST JEFFERSON AVENUE • DETROIT, MICHIGAN 48207-4232
(313) 259-6400 • Fax: (313) 259-9409 OR (313) 259-3121 • www.kirlinlighting.com

RENAISSANCE SERIES
COMPACT FLUORESCENT LIGHTING

MAXIMUM WATTAGE

1 PL-H 85

CATALOG NUMBER

FRR-11133

DUE TO OUR CONTINUING EFFORT TO IMPROVE PRODUCTS, TECHNICAL INFORMATION IS SUBJECT TO CHANGE WITHOUT NOTICE.

Alzak® is a registered trademark of ALCOA.

Detailed Photometry - Installed Fixture

Photometry from I.T.L., Boulder, CO

FRR-11133 (1 PL-H 85)

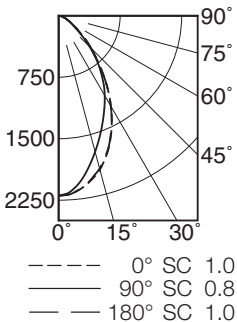

EFFICIENCY : 46.7%

CANDLEPOWER DISTRIBUTION					
	0.0	45.0	90.0	135.0	180.0
0	2195	2195	2195	2195	2195
5	2162	2145	2118	2135	2164
15	1944	1817	1718	1790	1929
25	1525	1413	1306	1372	1520
35	1015	1001	931	959	1014
45	554	558	535	535	559
55	253	276	236	266	265
65	118	122	117	121	120
75	45	48	52	49	52
85	1	2	2	2	2
90	0	0	0	0	0

COEFFICIENTS OF UTILIZATION							
RF	20						
	80				50		
	70	50	30	10	50	30	10
1	52	51	49	48	48	47	46
2	49	46	44	41	43	42	40
3	46	42	39	36	40	37	36
4	43	38	35	32	36	34	32
5	40	35	32	29	34	31	29
6	37	32	29	26	31	28	26
7	35	30	26	24	29	26	24
8	33	28	24	22	27	24	22
9	31	26	22	20	25	22	20
10	29	24	21	19	23	21	19

ITL TEST #56380 *LER=29.0 •AEC=\$8.28

FRR-11133 (1 PL-H 60)

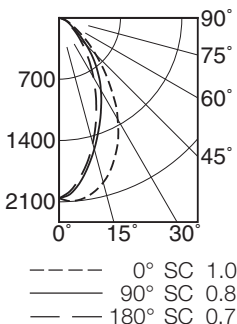

EFFICIENCY : 60.0%

CANDLEPOWER DISTRIBUTION					
	0.0	45.0	90.0	135.0	180.0
0	2060	2060	2060	2060	2060
5	2095	2056	1974	1928	1935
15	1945	1765	1551	1456	1482
25	1582	1378	1133	1001	994
35	1072	990	777	654	599
45	592	554	441	352	326
55	272	271	195	179	156
65	125	124	100	83	79
75	48	47	44	34	33
85	0	0	0	0	0
90	0	0	0	0	0

COEFFICIENTS OF UTILIZATION							
RF	20						
	80				50		
	70	50	30	10	50	30	10
1	67	65	63	62	61	60	59
2	63	59	56	53	56	54	52
3	59	54	50	47	51	48	46
4	55	49	45	42	47	44	41
5	51	45	41	38	43	40	37
6	48	42	37	34	40	37	34
7	45	39	34	31	37	34	31
8	43	36	32	29	35	31	28
9	40	33	29	27	33	29	26
10	38	31	27	25	31	27	24

ITL TEST #56381 *LER=30.3 •AEC=\$7.91

* LER = Luminaire Efficiency Rating
LER = Luminaire Effic. x Total Lamp Lumens x Ballast Factor
Input Watts

• AEC = Annual Energy Cost per 1000 lumens
(based on 3000 hours use @ \$0.08 KWH).

LIMITED WARRANTY: CATALOGED KIRLIN FIXTURES ARE WARRANTED FREE OF DEFECTS IN WORKMANSHIP OR MATERIAL FOR THREE YEARS FROM DATE OF PURCHASE. INSTALL ED TONE, C, INNORMAL USE. Manufacturer at the option will replace or repair such fixture or refund the purchase price on presentation of proof of purchase and defective fixture within the office of manufacturer within ninety days of original shipment. Liability of manufacturer is limited to the foregoing, and manufacturer shall not be liable for any other damages, direct or indirect, sustained or suffered by purchaser or any person. This warranty is applicable to the buyer in place of all other warranties, expressed or implied. Seller does not warrant as to merchantability or fitness for a particular use, nor will any oral statement constitute a warranty or amend this specific warranty. Additional use, abuse or the fixture, improper installation, or repair, or modification of the fixture without prior written authorization from the manufacturer will render the warranty void.

Options

Ballast, Wattage and Voltage

- 39 Installed electronic dimming ballast. Indoor use only. 10°C (50°F) minimum start. Please specify wattage and voltage. CONSULT FACTORY FOR AVAILABILITY.
- 73 Internal emergency battery pack for 60W PL-H lamp maximum (675 lumen output). Test switch and indicator light mounted in reflector. Ambient temp. limits: 0° to 55°C (32° to 131°F). Specify input voltage. Consult factory for 85W.
- 75 Remote emergency battery pack for 60W PL-H lamp maximum (675 lumen output). With test switch and indicator light. Ambient temp. limits:

- 0° to 55°C (32° to 131°F). Specify voltage. Consult factory for 85W. Use this option for outdoor emergency applications, where pack is remote mounted indoors in a heated space. Maintain a maximum distance of 7 feet between emergency pack and lamp.
- 97 Specify other voltage. Consult factory.
- 98 347 volt, 50/60 Hz. input. Consult factory.

Lenses and Trims

- 13 Vandal resistant tempered prismatic C#73 spread lens above 1/8" polycarbonate.
- 18 Opal flat glass diffuser.
- 20 White aluminum 1/2" cube egg-crate louver.
- 32 White oversize trim ring. Specify O.D.
- 40 White grooveless flare trim.
- 45 Gasket between ceiling and trim flange.

- 46 Gasket between trim and lens.
- 79 Extension collar for ceilings up to 2" thick.
- 94 Custom color/finish. Specify. Consult factory.
- CF High temperature color filter. Specify color.
- FR Fresnel tempered glass lens.
- FT Flat white trim.
- UV UV filter. Consult factory.

Other

- 99 Special modification. Consult factory.
- FS Additional in-line fuse.
- LE With 4-pin electronic lamp. 3000°K standard or specify 4100°K. 82 CRI and 20,000 hour life. Specify wattage and color temperature.

SUBMITTAL DATA

APPROVAL STAMP

JOB NAME

TYPE

WATTAGE

VOLTAGE

CATALOG NUMBER