

CATALOG #	TYPE	
JOB NAME	WATTAGE	VOLTAGE

10" 2 Triple 57 WATT MAXIMUM

FRR-10011

2 Lamp High Lumen Package With
Optional Dimming or Switching

**THIS PRODUCT
IS NO LONGER
AVAILABLE**

Features

Lamp

- Designed for two 4-pin triple/four tube maximum compact fluorescent lamps: 57 watt triple/four tube.

Ballast: Multi Voltage

- Installed electronic high power factor, thermally protected. For lower wattages: Option -43.
- 120-277 multi-volt; 50/60 Hz. THD < 10%.
- ClickQuick connectors for easy service.
- Single circuit wiring or see Option -81.
- Cold weather -22°F (-30°C).
- End of lamp life protection circuit. RFI filter.
- Internally fused. Also see Options -FS, -FD.

Reflector

- Low iridescence (L.I.) Alzak® aluminum reflector piece, self-finished.
- See Options for other finishes.

Aluminum Housing

- Acrylic lens. Fast, on-site installation.
- 100 hour ASTM 5% salt spray test.
- Lightweight: Minimizes ceiling load.
- Cool operation. Extends lamp life.
- Entire luminaire served through a single cable.
- Built-in plastic trim.

Outlet Box

- Prewired 14 GA (NEC) galvanized steel, UL listed. 1/2" and 3/4" knockouts.

Installation

- 27" galvanized hanger bars with adjustable mounting brackets (2) provided.
- Resealable for outdoor or high-voltage locations.

UL CUL (Canada) Listings

- UL listed, complete dry locations, damp locations, and wet locations.
- Three Year Limited Warranty
- Complete standard fixture and ballast.

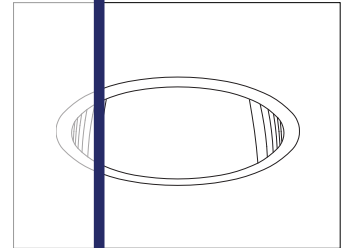

Recessed Round
Open
Single Reflector

Selected Optional Trims:

- Softex Dune Option -71
- Softex Gold Option -90
- Softex Wheat Option -91

**Please consult
QUOTATIONS
for the best alternative.**

Performance at a Glance

FRR-10011

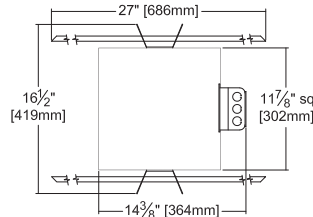
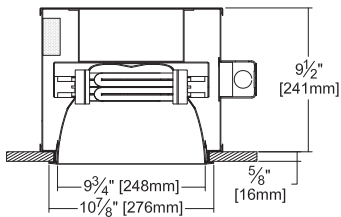

Ceiling Cut-out
10 1/4" Dia.

FRR-10011 (2 Triple 57W)

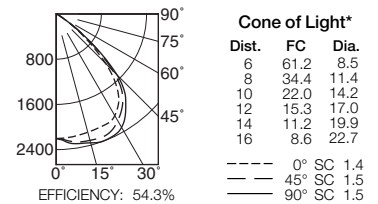

Cone of Light Key

- Ft.** Distance from fixture
- FC** Footcandles at nadir (0°)
- Dia.** Circle of light at 50% of FC
- * Dia. (in ft.) shown is where FC value is half the FC at nadir.

THE KIRLIN COMPANY

3401 EAST JEFFERSON AVENUE • DETROIT, MICHIGAN 48207-4232
(313) 259-6400 • Fax: (313) 259-9409 OR (313) 259-3121 • www.kirlinlighting.com

**RENAISSANCE SERIES
COMPACT FLUORESCENT LIGHTING**

MAXIMUM WATTAGE

2 Triple 57

CATALOG NUMBER

FRR-10011

DUE TO OUR CONTINUING EFFORT TO IMPROVE PRODUCTS,
TECHNICAL INFORMATION IS SUBJECT TO CHANGE WITHOUT NOTICE.

Alzak® is a registered trademark of ALCOA.

Detailed Photometry - Installed Fixture

Photometry from I.T.L., Boulder, CO

LIMITED WARRANTY: CATALOGED KIRLIN FIXTURES ARE WARRANTED FREE OF DEFECTS IN WORKMANSHIP OR MATERIAL FOR THREE YEARS FROM DATE OF PURCHASE. INSTALLATION, E.C., UNUSUAL USE, MANUFACTURE AT THE OPTION WILL REPLACE OR REPAIR SUCH FIXTURES OR REFUND THE PURCHASE PRICE ON PRESENTATION OF PROOF OF PURCHASE AND DEFECTIVE FIXTURE. THE SCOPE OF MANUFACTURE WITHIN THE YEARS OF ORIGINAL TERM. LIABILITY OF MANUFACTURE IS LIMITED TO THE FOREGOING, AND MANUFACTURER SHALL NOT BE LIABLE FOR ANY OTHER DAMAGES, DIRECT OR INDIRECT, SUSTAINED OR SUFFERED BY PURCHASER OR ANY PERSON. THIS WARRANTY IS APPLIED TO THE BUYER IN PLACE OF ALL OTHER WARRANTIES, EXPRESSED OR IMPLIED. SELLER DOES NOT WARRANT AS TO MERCHANTABILITY OR FITNESS FOR A PARTICULAR USE, NOR WILL ANY ORAL STATEMENT CONSTITUTE A WARRANTY OR ALTER THIS SPECIFIC WARRANTY. ABNORMAL USE, ABUSE OF THE FIXTURE, IMPROPER INSTALLATION, OR REPAIR OR MODIFICATION OF THE FIXTURE WITHOUT PRIOR WRITTEN AUTHORIZATION FROM THE MANUFACTURER WILL RENDER THE WARRANTY VOID.

FRR-10011 (2 Triple 57)

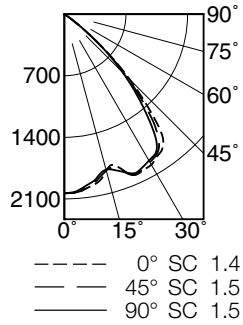

EFFICIENCY : 54.3%

CANDLEPOWER DISTRIBUTION					
	0.0	22.5	45.0	67.5	90.0
0	2203	2203	2203	2203	2203
5	2196	2217	2248	2271	2280
15	2165	2259	2314	2348	2360
25	2140	2238	2291	2347	2383
35	1926	1996	2032	2115	2141
45	1240	1322	1415	1508	1523
55	322	348	387	367	352
65	43	44	46	47	47
75	14	15	15	15	15
85	2	2	2	2	2
90	0	0	0	0	0

COEFFICIENTS OF UTILIZATION							
RF	20						
RC	80			50			
RW	70	50	30	10	50	30	10
1	61	59	57	56	56	54	53
2	57	54	51	49	51	49	47
3	53	49	45	43	46	44	42
4	49	44	40	38	42	39	37
5	46	40	36	33	39	35	33
6	43	37	33	30	35	32	30
7	40	34	30	27	33	29	27
8	37	31	27	24	30	27	24
9	35	29	25	22	28	24	22
10	33	27	23	20	26	22	20

ITL TEST #55299 *LER=34.3 •AEC=\$7.01

* LER = Luminaire Efficiency Rating

$$LER = \frac{\text{Luminaire Effic.} \times \text{Total Lamp Lumens} \times \text{Ballast Factor}}{\text{Input Watts}}$$

• AEC = Annual Energy Cost per 1000 lumens (based on 3000 hours use @ \$0.08 KWH).

Options

Ballast, Wattage and Voltage

- 39 Installed electronic dimming ballast. Indoor use. 10°C (50°F) minimum start. Specify wattage, voltage and brand.
- 43 Lower wattage: for 4-pin 2x42/32/26W triple or 2x26W quad (multi-wattage/voltage); Specify wattage.
- 84 Wired for two circuits. Also see -FD.
- 97 Specify other voltage. Consult factory.
- 98 347 volt, 50/60 Hz. input. Consult factory.

Emergency Ballast - Specify Voltage¹

Internal (factory installed) ballast, test switch and indicator light. Suitable for damp locations from 0° to 50°C (32° to 122°F) or with Cold Weather version (see -CE) -20° to 55°C (-4° to 131°F).

- 73 Internal 1-lamp EM ballast. Specify voltage.
- CE Internal cold weather (-20° to 55°C) 1-lamp EM ballast. Specify voltage.
- HE¹ Internal higher lumen (up to 1250) 1-lamp EM ballast. 13-42W only. Specify voltage.

Trims

- 31 White acrylic enameled reflector flange.
- 32 White oversize trim ring. Specify O.D.
- 45 Gasket between ceiling and reflector flange.
- 70 SofTex Clear reflector. (CP x .89)
- 71 SofTex Dune reflector. (CP x .85)
- 79 Extension collar for ceilings up to 2" thick.
- 82 Sloped ceiling adapter. Specify slope in 5° increments up to 30°.
- 90 SofTex Champagne Gold reflector. (CP x .88)

- 91 SofTex Wheat reflector. (CP x .83)
- 94 Custom color/finish. Specify. Consult factory.

Other

- 99 Special modification. Consult factory.
- FD Two additional in-line fuses. One per ballast. Use with Option -84. Not available with Option -98 (347V).
- FS Additional in-line fuse. Not available with Option -98 (347V).
- LE With 4-pin electronic lamp. 3500°K standard. 82 CRI and 12,000 hour life. Specify wattage, style and color temperature.

¹ Visit www.kirlinlighting.com for most current performance / specifications.

SUBMITTAL DATA

JOB NAME

TYPE

WATTAGE

VOLTAGE

CATALOG NUMBER

APPROVAL STAMP