

CATALOG #	TYPE	
JOB NAME	WATTAGE	VOLTAGE

8" 2 Triple 42 WATT MAXIMUM

FRR-08039

2-Lamp High Wattage with Regressed Lens

**THIS PRODUCT IS NO LONGER AVAILABLE**

**Features**

**Lamp**

- Designed for two 4-pin triple tube amalgam or quad compact fluorescent lamps: 42/32/26W triple or 26W quad.

**Ballast: Multi Wattage/Voltage**

- Installed electronic high power factor ballast protected for lower wattages: Option -42.
- 120-277 multi-volt; 50/60 Hz. THD < 10%.
- ClickQuick connectors for easy service.
- Single circuit wiring or see Option -84.
- Cold weather -22°F (-30°C).
- End of lamp life protection circuit. RFL-100.
- Internally fused. Also see Options -FR.

**Reflector**

- Specular Alzak® aluminum.

**Trim Assembly**

- Tapered aluminum one piece black or white trim with white flange or all white smooth trim (Option -40) as shown in section view.
- Regressed tempered prismatic #7 lens.

- Acrylic enhanced. Rustproof. Exceeds 1000 hour ASTM 5% salt spray test.
- Light weight: Minimum ballast load.
- Operative. Exceeds 50,000 life.
- Extruded aluminum regressed high aperture.
- Built-in ballast for fixture.

**Outlet Box**

- Prewired 14 GA (NEC) galvanized steel, UL listed. 1/2" and 3/4" knockouts.

**Installation**

- 27" galvanized hanger bars with adjustable mounting plate.
- Mounting plate for 1/2" and 3/4" knockouts.
- Mounting plate for 1/2" and 3/4" knockouts.

- Complete standard fixture and ballast.

**Three Year Limited Warranty**

- Complete standard fixture and ballast.

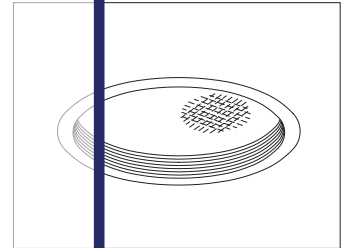

Recessed Round Regressed Lens Shallow Plenum

**Selected Optional Trims:**

- Oval Diffuser Option -18
- White Grooveless Flare Option -40
- Fresnel Lens Option -FR

**Please consult QUOTATIONS for the best alternative.**

**Performance at a Glance**

FRR-08039

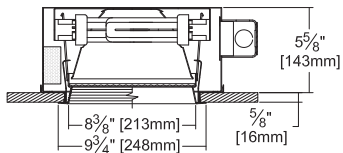

Option -40 Also Shown

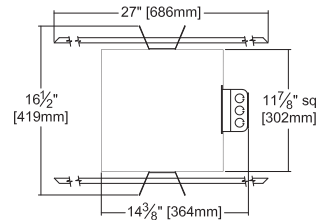

Ceiling Cut-out 9" Dia.

**Cone of Light Key**  
 Ft. Distance from fixture  
 FC Footcandles at nadir (0°)  
 Dia. Circle of light at 50% of FC  
 • Dia. (in ft.) shown is where FC value is half the FC at nadir.

FRR-08039 (2 Triple 42W)

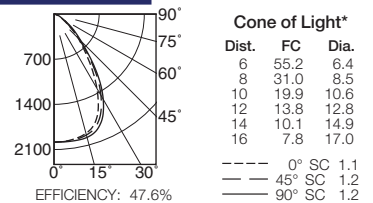

FRR-08039 (2 Triple 32W)

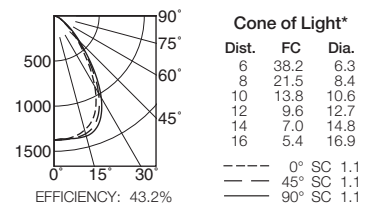

## THE KIRLIN COMPANY

3401 EAST JEFFERSON AVENUE • DETROIT, MICHIGAN 48207-4232  
 (313) 259-6400 • Fax: (313) 259-9409 OR (313) 259-3121 • www.kirlinlighting.com

**RENAISSANCE SERIES  
 COMPACT FLUORESCENT LIGHTING**

MAXIMUM WATTAGE

2 Triple 42

CATALOG NUMBER

FRR-08039

DUE TO OUR CONTINUING EFFORT TO IMPROVE PRODUCTS, TECHNICAL INFORMATION IS SUBJECT TO CHANGE WITHOUT NOTICE.

Alzak® is a registered trademark of ALCOA.

Detailed Photometry - Installed Fixture

Photometry from I.T.L., Boulder, CO

FRR-08039 (2 Triple 42)

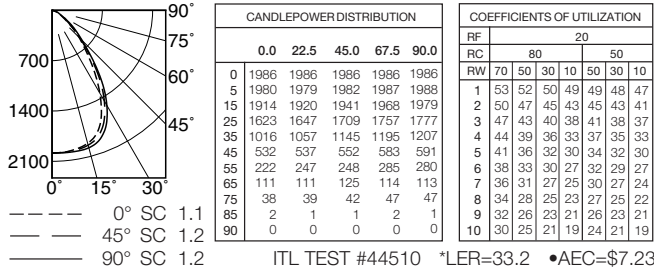

EFFICIENCY : 47.6%

FRR-08039 (2 Triple 32)

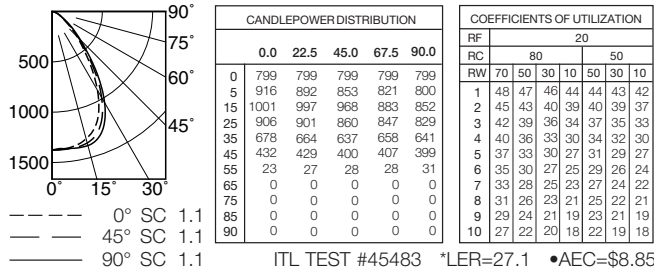

EFFICIENCY : 43.2%

FRR-08039 (2 Quad 26)

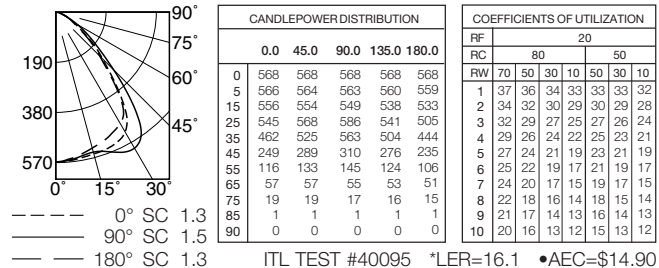

EFFICIENCY : 32.9%

\* LER = Luminaire Efficiency Rating

LER = Luminaire Effic. x Total Lamp Lumens x Ballast Factor  
Input Watts

• AEC = Annual Energy Cost per  
1000 lumens (based on 3000  
hours use @ \$0.08 KWH).

Options

Ballast, Wattage and Voltage

- 39 Installed electronic dimming ballast. Indoor use. 10°C (50°F) minimum start. Specify wattage, voltage and brand.
- 43 Lower wattage: for either 4-pin electronic 2x18W triple/quad or 2x13W quad (only). Specify wattage.
- 84 Wired for two circuits. Also see -FD.
- 97 Specify other voltage. Consult factory.
- 98 347 volt, 50/60 Hz. input. Consult factory.

Emergency Ballast - Specify Voltage<sup>1</sup>

- Internal (factory installed) ballast, test switch and indicator light. Suitable for damp locations from 0° to 50°C (32° to 122°F) or with Cold Weather version (see -CE) -20° to 55°C (-4° to 131°F).
- 73 Internal 1-lamp EM ballast. Specify voltage.

- CE Internal cold weather (-20° to 55°C) 1-lamp EM ballast. Specify voltage.
- HE<sup>1</sup> Internal higher lumen (up to 1250) 1-lamp EM ballast. 13-42W only. Specify voltage.

Lenses and Trims

- 13 Vandal resistant tempered prismatic C#73 spread lens above 1/8" polycarbonate.
- 17 .187" prismatic high strength acrylic lens.
- 18 Opal flat glass diffuser.
- 20 White aluminum 1/2" cube egg-crate louver.
- 21 White flat polycarbonate diffuser.
- 32 White oversize trim ring. Specify O.D.
- 40 White grooveless flare trim. (CP x 1.10)
- 45 Gasket between ceiling and trim flange.
- 46 Gasket between trim and lens.
- 76 Drop white poly diffuser.
- 79 Extension collar for ceilings up to 2" thick.
- 82 Sloped ceiling adapter. Specify slope in 5° increments up to 30°.

- 94 Custom color/finish. Specify. Consult factory.
- CF High temperature color filter. Specify color.
- FR Fresnel tempered glass lens.
- FT Flat white trim.
- UV UV filter. Consult factory.

Other

- 99 Special modification. Consult factory.
- FD Two additional in-line fuses. One per ballast. Use with Option -84.
- FS Additional in-line fuse.
- LE With 4-pin electronic lamp. 3500°K standard. 82 CRI and 12,000 hour life. Specify wattage, style and color temperature.



<sup>1</sup> Visit [www.kirlinlighting.com](http://www.kirlinlighting.com) for most current performance / specifications.

SUBMITTAL DATA

JOB NAME

TYPE

WATTAGE

VOLTAGE

CATALOG NUMBER

APPROVAL STAMP

<sup>2</sup> See GRR-08039 specification sheet or "Gazelle Express Program" brochure for complete details. Limited option availability.

LIMITED WARRANTY: CATALOGUED KIRLIN FIXTURES ARE WARRANTED FREE OF DEFECTS IN WORKMANSHIP OR MATERIAL FOR THREE YEARS FROM DATE OF PURCHASE. INSTALLLED TO N.E.C. IN NORMAL USE. Manufacturer at the option will inspect or repair such fixture or refund the purchase price upon presentation of proof of purchase and defective fixture at the offices of manufacturer within three years of original shipment. Liability of manufacturer is limited to the foregoing, and manufacturer shall not be liable for any other damages, direct or indirect, sustained or suffered by purchaser or any person. This warranty is supplied to the buyer in place of all other warranties, expressed or implied. Seller does not warrant as to merchantability or fitness for a particular use, nor will any oral statement constitute a warranty or amend this specific warranty. Abnormal use, abuse of the fixture, improper installation, or repair, or modification of the fixture without prior written authorization from the manufacturer will render the warranty void.