

CATALOG #	TYPE	
JOB NAME	WATTAGE	VOLTAGE

8" 1 Triple 70 WATT MAXIMUM

FRR-08038

High Wattage, Shallow Plenum  
Regressed Lens Downlight

# THIS PRODUCT IS NO LONGER AVAILABLE

### Features

#### Lamp

- Designed for one 4-pin triple/four tube amalgam compact fluorescent lamp: 70W triple tube
- Ballast: Multi Voltage**
- Installed electronic high power factor (the main power protected. For lower wattages: Option -43.
- 120-277 multi-volt; 50/60 Hz. THD < 10%.
- ClickQuick connectors for easy service.
- Cold weather -22°F (-30°C).
- End of lamp life protection circuit. RFI filter
- Internally fused. Also see Option -FS

#### Reflector

- Specular Alzak® aluminum.

#### Trim Assembly

- Tapered aluminum one piece black or chrome with white flange or all white smooth flange trim (Option -40) as shown in section view.
- Regressed prismatic, C#73 spread lens.

#### Aluminum Housing

- Acrylic finished. Rustproof. Passes 1000 hour ASTM 5% salt spray test.
- Lightweight: Minimizes ceiling load.
- Cool operation. Extends lamp life.
- Easy removal. Can be seen through aperture.
- Built-in clips for easy removal.

#### Outlet Box

- Prewired 14 GA (NEC) galvanized steel, UL listed. 1/2" and 3/4" knockouts.

#### Installation

- 27" galvanized hanger bars with adjustable mounting holes for easy installation in various locations.

#### UL (UL Classified) Listing

- Wet, dry or ordinary locations. Class 1, Division 2. For use in ordinary locations.

#### Three Year Limited Warranty

- Complete standard fixture and ballast.

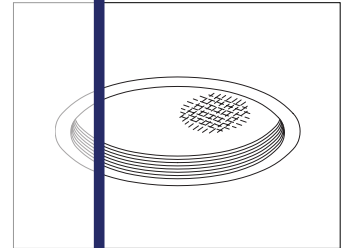

Recessed Round  
Regressed Lens  
Shallow Plenum

#### Selected Optional Trims:

- Oval Diffuser Option -18
- White Grooveless Flare Option -40
- Fresnel Lens Option -FR

# Please consult QUOTATIONS for the best alternative.

### Performance at a Glance

FRR-08038

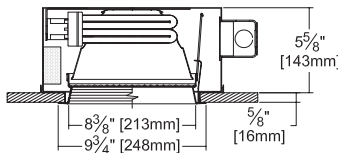

Option -40 Also Shown

**Cone of Light Key**  
**Ft.** Distance from fixture  
**FC** Footcandles at nadir (0°)  
**Dia.** Circle of light at 50% of FC  
 • Dia. (in ft.) shown is where FC value is half the FC at nadir.

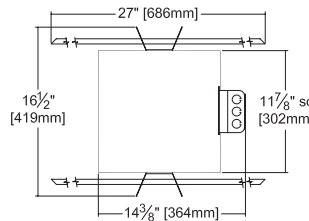

Ceiling Cut-out  
9" Dia.

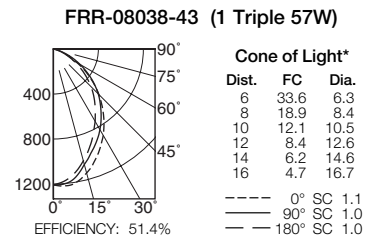
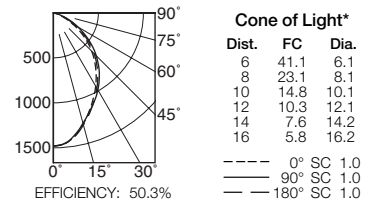

## THE KIRLIN COMPANY

3401 EAST JEFFERSON AVENUE • DETROIT, MICHIGAN 48207-4232  
 (313) 259-6400 • Fax: (313) 259-9409 OR (313) 259-3121 • www.kirlinlighting.com

RENAISSANCE SERIES  
 COMPACT FLUORESCENT LIGHTING

MAXIMUM WATTAGE

1 Triple 70

CATALOG NUMBER

FRR-08038

DUE TO OUR CONTINUING EFFORT TO IMPROVE PRODUCTS, TECHNICAL INFORMATION IS SUBJECT TO CHANGE WITHOUT NOTICE.

Alzak® is a registered trademark of ALCOA.

Detailed Photometry - Installed Fixture

Photometry from I.T.L., Boulder, CO

**FRR-08038 (1 Triple 70)**

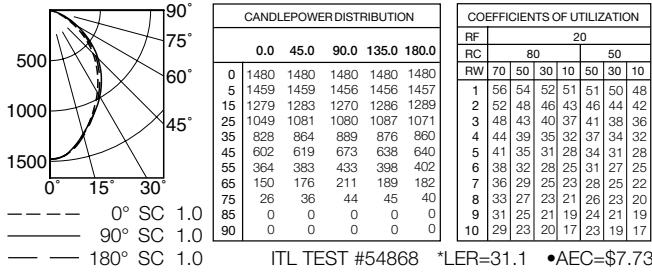

EFFICIENCY : 50.3%

**FRR-08038-43 (1 Triple 57)**

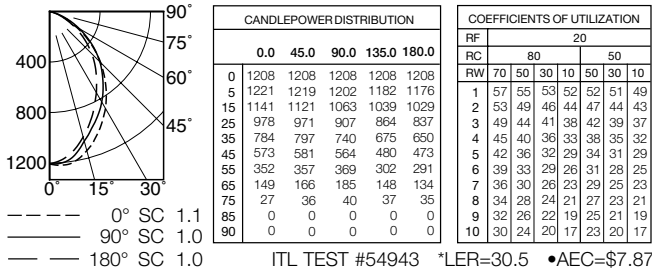

EFFICIENCY : 51.4%

**FRR-08038-43-40 (1 Triple 57 - White Flare)**

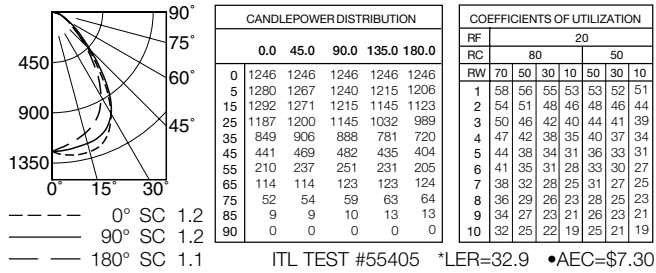

EFFICIENCY : 52.6%

\* LER = Luminaire Efficiency Rating

LER = Luminaire Effic. x Total Lamp Lumens x Ballast Factor  
Input Watts

• AEC = Annual Energy Cost per  
1000 lumens (based on 3000  
hours use @ \$0.08 KWH).

**Options**

**Ballast, Wattage and Voltage**

- 39 Installed electronic dimming ballast. Indoor use. 10°C (50°F) minimum start. Specify wattage, voltage and brand.
- 43 Lower wattage: for 4-pin 57W triple/four tube or 42/32/26W triple or 26W quad (multi-wattage/voltage). Specify wattage.
- 97 Specify other voltage. Consult factory.
- 98 347 volt, 50/60 Hz. input. Consult factory.

**Emergency Ballast - Specify Voltage<sup>1</sup>**

Remote (field mounted) ballast, test switch and indicator light. Suitable for damp locations from 0° to 50°C (32° to 122°F) or with Cold Weather version (see -CR) -20° to 55°C (-4° to 131°F).

- 75 Remote 1-lamp EM ballast. Specify voltage.
- CR Remote cold weather (-20° to 55°C) 1-lamp EM ballast. Specify voltage.
- HR<sup>1</sup> Remote higher lumen (up to 1250) 1-lamp EM ballast. 13-42W only. Specify voltage.

**Lenses and Trims**

- 13 Vandal resistant tempered prismatic C#73 spread lens above 1/8" polycarbonate.
- 17 .187" prismatic high strength acrylic lens.
- 18 Opal flat glass diffuser.
- 20 White aluminum egg-crate louver (1/2" cubes).
- 21 White flat polycarbonate diffuser.
- 32 White oversize trim ring. Specify O.D.
- 40 White grooveless flare trim. (CP x 1.10)
- 45 Gasket between ceiling and trim flange.
- 46 Gasket between trim and lens.

- 76 Drop white polycarbonate diffuser.
- 79 Extension collar for ceilings up to 2" thick.
- 82 Sloped ceiling adapter. Specify slope in 5° increments up to 30°.
- 94 Custom color/finish. Specify. Consult factory.
- CF High temperature color filter. Specify color.
- FR Fresnel tempered glass lens.
- FT Flat white trim
- UV UV filter. Consult factory.
- Other**
- 99 Special modification. Consult factory.
- FS Additional in-line fuse.
- LE With 4-pin electronic lamp. 3500°K standard. 82 CRI and 12,000 hour life. Specify wattage, style and color temperature.

<sup>1</sup> Visit [www.kirlinlighting.com](http://www.kirlinlighting.com) for most current performance / specifications.

**SUBMITTAL DATA**

JOB NAME

TYPE

WATTAGE

VOLTAGE

CATALOG NUMBER

**APPROVAL STAMP**

LIMITED WARRANTY: CATALOGED KIRLIN FIXTURES ARE WARRANTED FREE OF DEFECTS IN WORKMANSHIP OR MATERIAL FOR THREE YEARS FROM DATE OF PURCHASE. INSTALLED TO N.E.C. IN NORMAL USE. Manufacturer at the option will inspect or repair such fixture or refund the purchase price on presentation of proof of purchase and defective fixture at the offices of manufacturer within three years of original shipment. Liability of manufacturer is limited to the foregoing, and manufacturer shall not be liable for any other damages, direct or indirect, sustained or suffered by purchaser or any person. This warranty is supplied to the buyer in place of any other warranty, expressed or implied. Seller does not warrant as to merchantability or fitness for a particular use, nor will any oral statement constitute a warranty or amend this specific warranty. Abnormal use, abuse of the fixture, improper installation, or repair, or modification of the fixture without prior written authorization from the manufacturer will render the warranty void.