

CATALOG #	TYPE	
JOB NAME	WATTAGE	VOLTAGE

7" 1 Triple 42 WATT MAXIMUM

FRR-07037

Type IC (Air Tight Optional) Regressed Lens
Shallow Plenum Downlight

THIS PRODUCT IS NO LONGER AVAILABLE

Features

Lamp

- Designed for one 4-pin triple tube compact fluorescent lamp: 42/32/26W triple or 26W quad.

Ballast: Multi-Wattage/Voltage

- Installed electronic high power factor, thermally protected. For lower wattages: Option -43.
- 120-277 multi-volt; 50/60 Hz. THD < 10%.
- ClickQuick connectors for easy service.
- Cold weather -22°F (-30°C).
- End of lamp life protection circuit. For interior applications.
- Internally fused. Also see Option -FR.

Reflector

- Specular Alzak® aluminum.

Trim Assembly

- Tapered aluminum one piece black or white with white flange or all white smooth self-flanged trim (Option -40) as shown in section view.
- Regressed temperate resistant lens.

- Aluminum housing.
- Acrylic end cap for protection. Exceeds 1000 hours. STV 5% annual depreciation.
- Lightweight: minimizes ceiling load.
- Cool operation: Extends component life.
- Emergency luminaire service through a wire.
- Best-in-class plastic trim.
- Air Tight design. See Option -AT.
- Prewired 14 GA (NEC) galvanized steel, UL listed. 1/2" and 3/4" knockouts.

Installation

- 27" galvanized hanger bars with adjustable mounting brackets (2) supplied.
- For use in conjunction with other lighting locations.

UL, C-UL (Canada) Listings

- UL Listed for use in damp or wet locations.
- UL Type I, Class II, Limited Power Applications.
- Through-branch conductors (6 #12).

Three Year Limited Warranty

- Complete standard fixture and all parts.

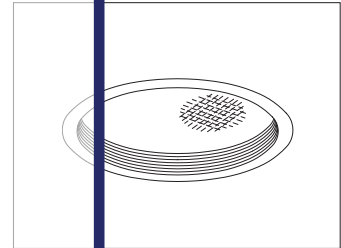

Recessed Round
Regressed Lens
Shallow Plenum
Type IC

Selected Optional Trims:

- Opal Diffuser Option -18
- White Grooveless Flare Option -40
- Fresnel Lens Option -FR

Please consult
QUOTATIONS
for the best alternative.

Performance at a Glance

FRR-07037

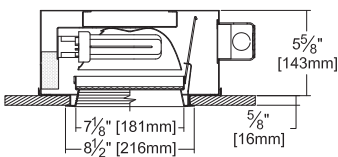

Option -40 Also Shown

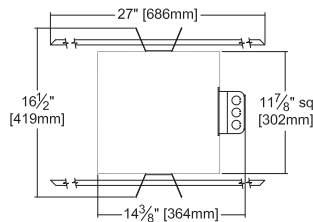

Ceiling Cut-out
8" Dia.

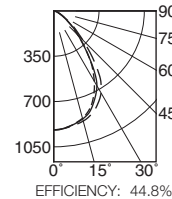

FRR-07037 (1 Triple 42W)

Cone of Light*		
Dist.	FC	Dia.
6	25.5	6.7
8	14.4	8.9
10	9.2	11.2
12	6.4	13.4
14	4.7	15.7
16	3.6	17.9
----	0°	SC 1.1
----	90°	SC 1.1
----	180°	SC 1.2

Cone of Light Key
Ft. Distance from fixture
FC Footcandles at nadir (0°)
Dia. Circle of light at 50% of FC
* Dia. (in ft.) shown is where FC value is half the FC at nadir.



FRR-07037-40 (1 Triple 42W)

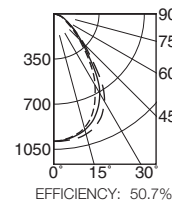

Cone of Light*		
Dist.	FC	Dia.
6	27.4	6.7
8	15.4	8.9
10	9.9	11.1
12	6.9	13.3
14	5.0	15.5
16	3.9	17.7
----	0°	SC 1.0
----	90°	SC 1.1
----	180°	SC 1.2

THE KIRLIN COMPANY

3401 EAST JEFFERSON AVENUE • DETROIT, MICHIGAN 48207-4232
(313) 259-6400 • Fax: (313) 259-9409 OR (313) 259-3121 • www.kirlinlighting.com

RENAISSANCE SERIES
COMPACT FLUORESCENT LIGHTING

MAXIMUM WATTAGE

1 Triple 42

CATALOG NUMBER

FRR-07037

DUE TO OUR CONTINUING EFFORT TO IMPROVE PRODUCTS, TECHNICAL INFORMATION IS SUBJECT TO CHANGE WITHOUT NOTICE.

Alzak® is a registered trademark of ALCOA.

Detailed Photometry - Installed Fixture

Photometry from I.T.L., Boulder, CO

FRR-07037 (1 Triple 42)

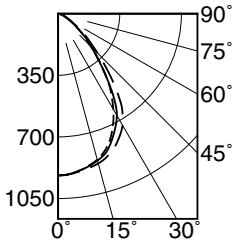

----- 0° SC 1.1
 _____ 90° SC 1.1
 - - - - - 180° SC 1.2

EFFICIENCY : 44.8%

CANDLEPOWER DISTRIBUTION					
	0.0	45.0	90.0	135.0	180.0
0	919	919	919	919	919
5	910	910	910	911	912
15	859	862	864	870	881
25	728	752	750	765	799
35	514	543	527	565	622
45	261	273	270	288	318
55	122	125	118	129	143
65	48	53	57	54	49
75	15	17	17	16	15
85	0	0	0	0	0
90	0	0	0	0	0

COEFFICIENTS OF UTILIZATION								
RF	20							
	RC	80			50			
		70	50	30	10	50	30	10
1	50	49	47	46	46	45	44	
2	47	44	42	40	42	40	39	
3	44	40	37	35	38	36	34	
4	41	37	34	31	35	33	31	
5	38	34	30	28	32	30	27	
6	36	31	28	25	30	27	25	
7	33	28	25	23	27	25	23	
8	31	26	23	21	26	23	21	
9	30	24	21	19	24	21	19	
10	28	23	20	18	22	19	18	

ITL TEST #55413 *LER=33.6 •AEC=\$7.14

FRR-07037-40 (1 Triple 42 - White Flare)

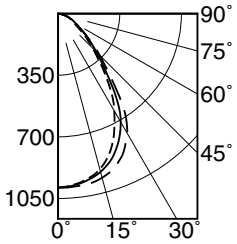

----- 0° SC 1.0
 _____ 90° SC 1.1
 - - - - - 180° SC 1.2

EFFICIENCY : 50.7%

CANDLEPOWER DISTRIBUTION					
	0.0	45.0	90.0	135.0	180.0
0	988	988	988	988	988
5	976	977	980	986	987
15	914	922	931	949	965
25	751	787	808	831	874
35	512	555	570	600	644
45	278	293	306	314	333
55	139	157	167	169	165
65	80	90	93	94	91
75	38	43	47	44	40
85	7	7	6	7	7
90	0	0	0	0	0

COEFFICIENTS OF UTILIZATION								
RF	20							
	RC	80			50			
		70	50	30	10	50	30	10
1	56	55	53	51	51	50	49	
2	52	49	46	44	46	44	43	
3	49	44	41	38	42	40	37	
4	45	40	37	34	39	36	33	
5	42	37	33	30	35	32	30	
6	40	34	30	27	33	29	27	
7	37	31	27	25	30	27	24	
8	35	29	25	23	28	25	22	
9	33	27	23	21	26	23	21	
10	31	25	21	19	24	21	19	

ITL TEST #55414 *LER=38.0 •AEC=\$6.31

Options

Ballast, Wattage and Voltage

- 39 Installed electronic dimming ballast. Not Type IC listed. Indoor use. 10°C (50°F) minimum start. Specify wattage, voltage and brand.
- 43 Lower wattage: for either 4-pin electronic 18W triple/quad or 13W quad (only). Specify wattage.
- 97 Specify other voltage. Consult factory.
- 98 347 volt, 50/60 Hz. input. Consult factory.

Emergency Ballast - Specify Voltage¹

- Internal (factory installed) ballast, test switch and indicator light. Suitable for damp locations from 0° to 50°C (32° to 122°F) or with Cold Weather version (see -CE) -20° to 55°C (-4° to 131°F).
- 73 Internal 1-lamp EM ballast. Specify voltage.
- CE Internal cold weather (-20° to 55°C) 1-lamp EM ballast. Specify voltage.

- HE¹ Internal higher lumen (up to 1250) 1-lamp EM ballast. 13-42W only. Specify voltage.

Lenses and Trims

- 13 Vandal resistant tempered prismatic C#73 spread lens above 1/8" polycarbonate.
- 17 .187" prismatic high strength acrylic lens.
- 18 Opal flat glass diffuser.
- 20 White aluminum egg-crate louver (1/2" cubes).
- 21 White flat polycarbonate diffuser.
- 32 White oversize trim ring. Specify O.D.
- 40 White grooveless flare trim. (CP x 1.10)
- 45 Gasket between ceiling and trim flange.
- 46 Gasket between trim and lens.
- 79 Extension collar for ceilings up to 2" thick.
- 94 Custom color/finish. Specify. Consult factory.
- CF High temperature color filter. Specify color.

- FR Fresnel tempered glass lens.
- FT Flat white trim
- UV UV filter. Consult factory.

Other

- 99 Special modification. Consult factory.
- AT Air tight with Type IC. Meets / exceeds ASTM E283 restricted airflow of 2 CFM maximum.
- FS Additional in-line fuse. Not available with Option -98 (347V).
- LE With 4-pin electronic lamp. 3500°K standard. 82 CRI and 12,000 hour life. Specify wattage, style and color temperature.



¹ Visit www.kirlinlighting.com for most current performance / specifications.

SUBMITTAL DATA

JOB NAME

TYPE

WATTAGE

VOLTAGE

CATALOG NUMBER

APPROVAL STAMP

² See GRR-06037 specification sheet or "Gazelle Express Program" brochure for complete details. Limited option availability.

LIMITED WARRANTY: CATALOGUED KIRLIN FIXTURES ARE WARRANTED FREE OF DEFECTS IN WORKMANSHIP OR MATERIAL FOR THREE YEARS FROM DATE OF PURCHASE. INSTALLLED TO N.E.C. IN NORMAL USE. Manufacturer at the option will inspect or repair such fixture or refund the purchase price on presentation of a proof of purchase and defective fixture at the office of manufacturer within three years of original shipment. Liability of manufacturer is limited to the foregoing, and manufacturer shall not be liable for any other damages, direct or indirect, sustained or suffered by purchaser or any person. This warranty is supplied to the buyer in place of all other warranties, expressed or implied. Seller does not warrant as to merchantability or fitness for a particular use, nor will any oral statement constitute a warranty or amend this specific warranty. Abnormal use, abuse of the fixture, improper installation, or repair, or modification of the fixture without prior written authorization from the manufacturer will render the warranty void.

* LER = Luminaire Efficiency Rating
 LER = Luminaire Effic. x Total Lamp Lumens x Ballast Factor
 Input Watts

* AEC = Annual Energy Cost per
 1000 lumens (based on 3000
 hours use @ \$0.08 KWH).