

CATALOG #	TYPE	
JOB NAME	WATTAGE	VOLTAGE

7" 2 Triple 42 WATT MAXIMUM

FRR-07031

Adjustable 2 x 42 Downlight  
for Sloped Ceiling

**THIS PRODUCT  
IS NO LONGER  
AVAILABLE**

## Features

### Lamp

- Designed for two 4-pin triple tube amalgam or quad compact fluorescent lamps: 42/32/26W triple or 26W quad.

### Ballast: Multi-Wattage/Voltage

- Installed electronic high power factor, thermally protected. For lower wattages: Option -43.
- 120-277 multi-volt; 50/60 Hz. THD < 10%.
- ClickQuick connectors for easy servicing or see Option -84.
- Single circuit wiring or see Option -84.
- Cold weather -22°F (-30°C).
- End of lamp life protection circuit. RFI filter.
- Internally fused. Also see Options -85, -86.

### Reflectors

- Upper: Specular Alzak® aluminum. Tilts to 30° for sloped ceilings.
- Lower: Low iridescent Alzak® aluminum. One piece, self-angled.

### Aluminum Housing

- Acrylic enameled. Rustproof: Exceeds 1000 hours ASTM 5% salt spray test.
- Light weight: Minimizes ceiling load.
- Good operating characteristics of long life.
- Thermal break sleeve for sloped ceilings.
- Built-in plaster frame.

### Outlet Box

- Prewired 14 GA (NEC) galvanized steel, UL listed. 1/2" and 3/4" knockouts.

### Installation

- Specialized hardware for adjustable mounting brackets (2) supplied.
- Recesses indoor or outdoor in covered locations.
- UL Listed and listed for use in wet, damp or dry locations, covered ceilings.
- Through-branch conductors (6 #12).

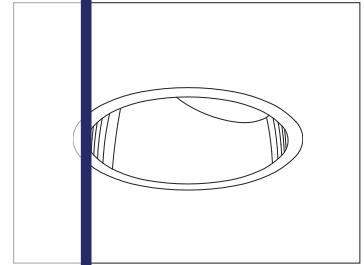

Recessed Round  
Open  
Adjustable  
Sloped Ceilings

### Selected Optional Trims:

- Al White Option -30
- Softex Titanium Option -57
- Softex Dune Option -71
- Softex Pewter Option -77
- Softex Wheat Option -91

**Please consult  
QUOTATIONS  
for the best alternative.**

## Performance at a Glance

FRR-07031

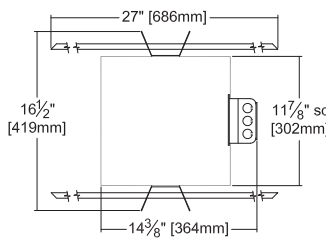
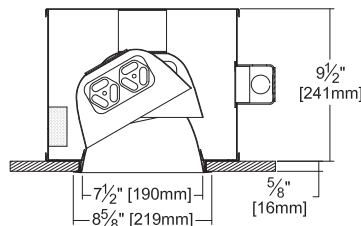

Ceiling Cut-out  
8" Dia.

FRR-07031 (2 Triple 42W - 30° TILT)

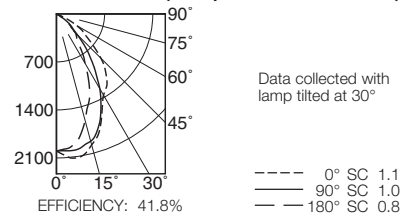

FRR-07031 (2 Triple 32W - 30° TILT)

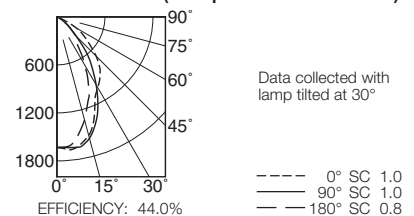

# THE KIRLIN COMPANY

3401 EAST JEFFERSON AVENUE • DETROIT, MICHIGAN 48207-4232  
(313) 259-6400 • Fax: (313) 259-9409 OR (313) 259-3121 • www.kirlinlighting.com

RENAISSANCE SERIES  
COMPACT FLUORESCENT LIGHTING

MAXIMUM WATTAGE

2 Triple 42

CATALOG NUMBER

FRR-07031

DUE TO OUR CONTINUING EFFORT TO IMPROVE PRODUCTS, TECHNICAL INFORMATION IS SUBJECT TO CHANGE WITHOUT NOTICE.

Alzak® is a registered trademark of ALCOA.

Detailed Photometry - Installed Fixture

Photometry from I.T.L., Boulder, CO

FRR-07031 (2 Triple 42 - 30° Tilt)

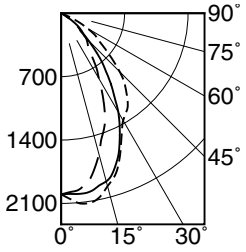

--- 0° SC 1.1  
— 90° SC 1.0  
- - 180° SC 0.8

EFFICIENCY : 41.8%

CANDLEPOWER DISTRIBUTION					
	0.0	45.0	90.0	135.0	180.0
0	1999	1999	1999	1999	1999
5	2101	2071	2004	1969	1967
15	1977	1987	1922	1723	1612
25	1567	1585	1529	1208	1121
35	1277	1118	960	674	609
45	913	777	428	371	386
55	487	414	164	146	134
65	142	63	16	16	16
75	4	4	6	6	6
85	0	2	2	2	0
90	0	0	0	0	0

COEFFICIENTS OF UTILIZATION							
RF	20						
	80			50			
RC	70	50	30	10	50	30	10
RW	47	46	44	43	43	42	41
1	44	42	40	38	40	38	37
2	41	38	36	34	36	34	33
3	39	35	32	30	33	31	30
4	36	32	29	27	31	29	27
5	34	30	27	25	29	26	24
6	32	27	24	22	27	24	22
7	30	25	23	21	25	22	20
8	28	24	21	19	23	21	19
9	27	22	19	18	22	19	17
10							

ITL TEST #54864 \*LER=26.9 •AEC=\$8.91

\* LER = Luminaire Efficiency Rating  
LER = Luminaire Effic. x Total Lamp Lumens x Ballast Factor  
Input Watts

FRR-07031 (2 Triple 32 - 30° Tilt)

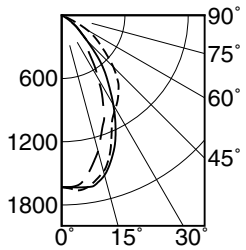

--- 0° SC 1.0  
— 90° SC 1.0  
- - 180° SC 0.8

EFFICIENCY : 44.0%

CANDLEPOWER DISTRIBUTION					
	0.0	45.0	90.0	135.0	180.0
0	1631	1631	1631	1631	1631
5	1667	1663	1640	1624	1624
15	1535	1590	1571	1374	1335
25	1128	1203	1211	1018	931
35	935	801	762	555	482
45	693	531	339	297	333
55	409	346	124	120	108
65	98	47	10	12	12
75	4	4	6	6	6
85	0	2	2	2	0
90	0	0	0	0	0

COEFFICIENTS OF UTILIZATION							
RF	20						
	80			50			
RC	70	50	30	10	50	30	10
RW	49	48	47	46	45	44	44
1	46	44	42	40	42	40	39
2	43	40	38	35	38	36	35
3	41	37	34	32	35	33	31
4	38	34	31	29	33	30	28
5	34	31	28	26	30	28	26
6	34	29	26	24	28	25	23
7	32	27	24	22	26	23	22
8	30	25	22	20	24	22	20
9	28	23	21	19	23	20	19
10							

ITL TEST #54865 \*LER=25.2 •AEC=\$9.51

\* AEC = Annual Energy Cost per  
1000 lumens (based on 3000  
hours use @ \$0.08 KWH).

Options

Ballast, Wattage and Voltage

- 39 Installed electronic dimming ballast. Indoor use. 10°C (50°F) minimum start. Specify wattage, voltage and brand.
- 43 Lower wattage: for either 4-pin electronic 2x18W triple/quad or 2x13W quad (only). Specify wattage.
- 84 Wired for two circuits. Also see -FD.
- 97 Specify other voltage. Consult factory.
- 98 347 volt, 50/60 Hz. input. Consult factory.

Emergency Ballast - Specify Voltage<sup>1</sup>

Internal (factory installed) ballast, test switch and indicator light. Suitable for damp locations from 0° to 50°C (32° to 122°F) or with Cold Weather version (see -CE) -20° to 55°C (-4° to 131°F).

- 73 Internal 1-lamp EM ballast. Specify voltage.
- CE Internal cold weather (-20° to 55°C) 1-lamp EM ballast. Specify voltage.
- HE<sup>1</sup> Internal higher lumen (up to 1250) 1-lamp EM ballast. 13-42W only. Specify voltage.

Trims

- 30 All white lower cone. (CP x .95)
- 31 White flange (only) on lower cone.
- 32 White oversize trim ring. Specify O.D.
- 45 Gasket between ceiling and cone flange.
- 57 SofTex Titanium lower cone. (CP x .80)
- 70 SofTex Clear lower cone. (CP x .92)
- 71 SofTex Dune lower cone. (CP x .88)
- 77 SofTex Pewter lower cone. (CP x .85)
- 79 Extension collar for ceilings up to 2" thick.
- 90 SofTex Champagne Gold lower cone. (CP x .91)

- 91 SofTex Wheat lower cone. (CP x .87)
- 94 Custom color/finish. Specify. Consult factory.

Top Access

- TA Top access service for servicing from above.

Other

- 99 Special modification. Consult factory.
- FD Two additional in-line fuses. One per ballast. Use with Option -84. Not available with Option -98 (347V).
- FS Additional in-line fuse. Not available with Option -98 (347V).
- LE With 4-pin electronic lamp. 3500°K standard. 82 CRI and 12,000 hour life. Specify wattage, style and color temperature.

<sup>1</sup> Visit [www.kirlinlighting.com](http://www.kirlinlighting.com) for most current performance / specifications.

SUBMITTAL DATA

APPROVAL STAMP

JOB NAME \_\_\_\_\_  
TYPE \_\_\_\_\_  
WATTAGE \_\_\_\_\_ VOLTAGE \_\_\_\_\_  
CATALOG NUMBER \_\_\_\_\_

LIMITED WARRANTY: CATALOGED KIRLIN FIXTURES ARE WARRANTED FREE OF DEFECTS IN WORKMANSHIP OR MATERIAL FOR THREE YEARS FROM DATE OF PURCHASE. INSTALLATION TO N.E.C. IN NORMAL USE. Manufacturer at this option will replace or repair such fixture or return the purchase price or presentation of proof of purchase and defective fixture at the offices of manufacturer within three years of original shipment. Liability of manufacturer shall not be liable for any other damages, direct or indirect, sustained or suffered by purchaser or any person. This warranty is supplied to the buyer in place of all other warranties, expressed or implied. Seller does not warrant, express or implied, that the fixture will be suitable for use in any other application than that for which it was designed. Abuse of the fixture, improper installation, or repair, or modification of the fixture without prior written authorization from the manufacturer will void the warranty. REV/SEPT 2011