

CATALOG #	TYPE	
JOB NAME	WATTAGE	VOLTAGE

7" 2 Triple 42 WATT MAXIMUM

FRR-07026

Open Wall Wash in Shallow Housing

**THIS PRODUCT IS NO LONGER AVAILABLE**

**Features**

**Lamp**

- Designed for two 4-pin tri-pin fluorescent lamps: 42/32/26W triple or 26W quad.

**Ballast: Multi Wattage/Voltage**

- Installed electronic high power factor ballast protected. For lower wattages: Opti-Link.
- 120-277 multi-volt; 50/60 Hz. THD < 10%.
- ClickQuick connectors for easy service.
- Single circuit wiring or see Option -84.
- Cold weather -22°F (-30°C).
- End of lamp life protection circuit. RFI filter.
- Internally fused. Also see Options -F, -T.

**Reflectors**

- Adjust 360°.
- Inner: Low incidence (L.I.) Alzak® aluminum one piece, self-flanged.
- Outer: Etched and anodized 100% aluminum uniform wall washing.

- Aluminum housing.
- Acrylic enameled finish. Emission 100%.
- Lightweight: Minimizes ceiling load.
- Cool operation: Extends component life.
- Emiretinal™ lens recovers through aperture.
- Best-in-class plastic trim.
- Pre-wired 14 GA (NEC) galvanized steel, UL listed. 1/2" and 3/4" knockouts.

**Installation**

- 27" galvanized hanger bars with adjustable mounting brackets (2) supplied.

**UL, C-UL (Canada) Listings**

- Wet, damp or dry locations, covered ceilings.
- Complete standard fixture and ballast.

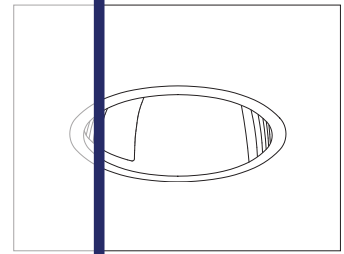

Recessed Round  
Open  
Wall Wash  
Shallow Plenum

Please consult

**QUOTATIONS**

for the best alternative.

Performance at a Glance

FRR-07026 (2 Triple 42W)

FRR-07026

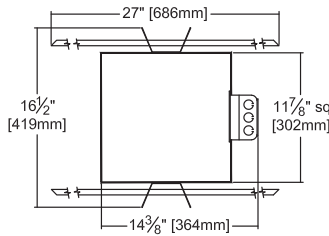
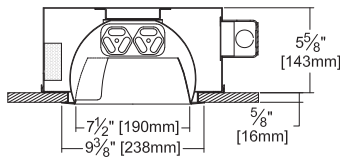

Ceiling Cut-out  
8 3/4" Dia.

WALL > --- 0°  
--- 90°  
--- 180°  
EFFICIENCY: 49.2%

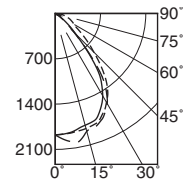

DISTANCE FROM CEILING IN FEET	SINGLE FIXTURE					MULTIPLE FIXTURES					
	1'	2'	3'	4'	3' CENTERS		4' CENTERS				
	FIXTURE INSTALLED 3" FROM WALL										
	Footcandle Distribution on Wall Surface										
1	16.4	13.4	8.2	5.0	3.3	31.1	29.7	31.1	25.9	21.9	25.9
2	20.1	16.2	9.9	5.9	3.7	36.9	35.0	36.9	30.8	25.5	30.8
3	25.2	21.3	12.7	6.7	3.9	43.8	43.7	43.8	36.4	31.4	36.4
4	24.0	21.4	14.9	8.7	4.8	46.9	47.5	46.9	37.1	36.1	37.1
5	18.3	17.1	13.8	9.5	5.8	43.3	43.7	43.3	33.4	34.5	33.4
6	13.6	13.0	11.3	8.9	6.2	38.2	38.1	38.2	29.7	30.0	29.7
7	10.3	10.0	9.0	7.6	6.0	33.0	33.2	33.0	26.3	26.2	26.3
8	8.1	7.9	7.3	6.5	5.5	28.9	29.2	28.9	23.2	23.0	23.2
9	6.7	6.6	6.2	5.7	5.0	26.1	26.3	26.1	21.0	21.2	21.0

## THE KIRLIN COMPANY

3401 EAST JEFFERSON AVENUE • DETROIT, MICHIGAN 48207-4232  
(313) 259-6400 • Fax: (313) 259-9409 OR (313) 259-3121 • www.kirlinlighting.com

RENAISSANCE SERIES  
COMPACT FLUORESCENT LIGHTING

MAXIMUM WATTAGE

2 Triple 42

CATALOG NUMBER

FRR-07026

DUE TO OUR CONTINUING EFFORT TO IMPROVE PRODUCTS, TECHNICAL INFORMATION IS SUBJECT TO CHANGE WITHOUT NOTICE.

Alzak® is a registered trademark of ALCOA.

Detailed Photometry - Installed Fixture

Photometry from I.T.L., Boulder, CO

**FRR-07026 (2 Triple 42)**

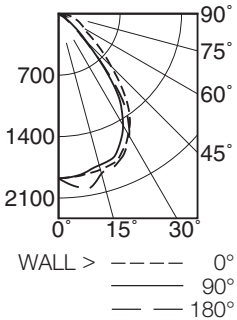

EFFICIENCY : 49.2%

CANDLEPOWER DISTRIBUTION					
	0.0	45.0	90.0	135.0	180.0
0	1877	1877	1877	1877	1877
5	1867	1863	1864	1933	1968
15	1840	1828	1788	1881	1886
25	1722	1713	1644	1745	1763
35	1408	1378	1221	1335	1337
45	844	755	450	471	412
55	437	320	118	84	72
65	282	190	43	47	60
75	170	122	15	0	0
85	41	33	0	0	0
90	0	0	0	0	0

ITL TEST #47220 LER=32.4 AEC=\$7.40

COEFFICIENTS OF UTILIZATION							
RF	20						
	80				50		
	70	50	30	10	50	30	10
1	55	53	52	50	50	49	48
2	51	48	46	44	46	44	42
3	48	44	41	38	42	39	37
4	45	40	37	34	38	36	34
5	42	37	33	31	35	32	30
6	39	34	30	28	33	30	27
7	37	31	28	25	30	27	25
8	35	29	25	23	28	25	23
9	33	27	23	21	26	23	21
10	31	25	22	19	24	21	19

\* LER = Luminaires Efficiency Rating  
LER = Luminaire Effic. x Total Lamp Lumens x Ballast Factor  
Input Watts

**FRR-07026 (2 Quad 26)**

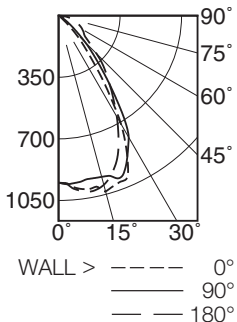

EFFICIENCY : 38.8%

CANDLEPOWER DISTRIBUTION					
	0.0	45.0	90.0	135.0	180.0
0	949	949	949	949	949
5	978	969	956	974	987
15	1034	1087	948	1024	995
25	934	1041	917	921	808
35	422	515	565	565	528
45	102	167	217	302	306
55	9	26	57	156	176
65	26	11	13	100	133
75	0	0	7	63	80
85	0	0	0	22	26
90	0	0	0	0	0

ITL TEST #41194 LER=22.3 AEC=\$10.77

COEFFICIENTS OF UTILIZATION							
RF	20						
	80				50		
	70	50	30	10	50	30	10
1	43	42	41	40	40	39	38
2	41	39	37	35	37	35	34
3	38	35	33	31	34	32	30
4	36	32	30	28	31	29	27
5	34	30	27	25	29	27	25
6	32	28	25	23	27	25	23
7	30	26	23	21	285	23	21
8	28	24	21	20	23	21	19
9	27	22	20	18	22	20	18
10	25	21	18	17	21	18	17

\* AEC = Annual Energy Cost per  
1000 lumens (based on 3000  
hours use @ \$0.08 KWH).

**Options**

**Ballast, Wattage and Voltage**

- 39 Installed electronic dimming ballast. Indoor use. 10°C (50°F) minimum start. Specify wattage, voltage and brand.
- 43 Lower wattage: for either 4-pin electronic 2x18W triple/quad or 2x13W quad (only). Specify wattage.
- 84 Wired for two circuits. Also see -FD.
- 97 Specify other voltage. Consult factory.
- 98 347 volt, 50/60 Hz. input. Consult factory.

**Emergency Ballast - Specify Voltage<sup>1</sup>**

Internal (factory installed) ballast, test switch and indicator light. Suitable for damp locations from 0° to 50°C (32° to 122°F) or with Cold Weather

- version (see -CE) -20° to 55°C (-4° to 131°F).
- 73 Internal 1-lamp EM ballast. Specify voltage.
- CE Internal cold weather (-20° to 55°C) 1-lamp EM ballast. Specify voltage.
- HE<sup>1</sup> Internal higher lumen (up to 1250) 1-lamp EM ballast. 13-42W only. Specify voltage.

**Trims**

- 30 White inner trim. (CP x .95)
- 31 White acrylic enameled inner trim flange.
- 32 White oversize trim ring. Specify O.D.
- 45 Gasket between ceiling and trim flange.
- 57 SofTex Titanium inner trim. (CP x .80)
- 70 SofTex Clear inner trim. (CP x .92)
- 71 SofTex Dune inner trim. (CP x .88)
- 77 SofTex Pewter inner trim. (CP x .85)

- 79 Extension collar for ceilings up to 2" thick.
- 90 SofTex Champagne Gold inner trim. (CP x .91)
- 91 SofTex Wheat inner trim. (CP x .87)
- 94 Custom color/finish. Specify. Consult factory.
- DW Double wall wash. Two cut-outs at 180°.

**Other**

- 99 Special modification. Consult factory.
- FD Two additional in-line fuses. One per ballast. Use with Option -84. Not available with Option -98 (347V).
- FS Additional in-line fuse. Not available with Option -98 (347V).
- LE With 4-pin electronic lamp. 3500°K standard. 82 CRI and 12,000 hour life. Specify wattage, style and color temperature.

<sup>1</sup> Visit [www.kirlinlighting.com](http://www.kirlinlighting.com) for most current performance / specifications.

SUBMITTAL DATA

JOB NAME

TYPE

WATTAGE

VOLTAGE

CATALOG NUMBER

APPROVAL STAMP

LIMITED WARRANTY: CATALOGED KIRLIN FIXTURES ARE WARRANTED FREE OF DEFECTS IN WORKMANSHIP OR MATERIAL FOR THREE YEARS FROM DATE OF PURCHASE. INSTALLLED TO N.E.C. IN NORMAL USE. Manufacturer at the option will replace or repair such fixture or refund the purchase price on presentation of proof of purchase and defective fixture at the offices of manufacturer within three years of original shipment. Liability of manufacturer is limited to the foregoing, and manufacturer shall not be liable for any other damages, direct or indirect, sustained or suffered by purchaser or any person. This warranty is supplied to the buyer in place of all other warranties, expressed or implied. Seller does not warrant as to merchantability or fitness for a particular use, nor will any oral statement constitute a warranty or amend this specific warranty. Abnormal use, abuse of the fixture, improper installation, or repair, or modification of the fixture without prior written authorization from the manufacturer will render the warranty void.