

CATALOG #	TYPE	
JOB NAME	WATTAGE	VOLTAGE

7" 2 Triple 42 WATT MAXIMUM

FRR-07024

X-CELL™ with 2 x 42 in Shallow Housing

# THIS PRODUCT IS NO LONGER AVAILABLE

## Features

### Lamp

- Designed for two 4-pin triple tube amalgam or quad compact fluorescent lamps: 42/32/26W triple or 26W quad.

### Ballast: Multi Wattage/Voltage

- Installed electronic high power factor ballast, protected. For lower wattages: Option -43.
- 120-277 multi-volt; 50/60 Hz. THD < 10%.
- ClickQuick connectors for easy service.
- Single circuit wiring or see Option -84.
- Cold weather -22°F (-30°C).
- End of lamp life protection circuit. For life protection. Also see Options -FS, -F.

### Reflector

- Upper: Spherical Alzak® aluminum.
- Lower: Low-iridescence (L.I.) semi-spherical Alzak® aluminum cone and 4 cell parabolic baffle, self-finished.
- See Options for other finishes.

### Minimum Housing

- Acrylic or polycarbonate. First of its kind. 1000 hour ASTM 5% salt spray test.
- Lightweight: Minimizes ceiling load.
- Cool operation. Extends lamp life.
- Energy saving. Energy saving through aperture.
- Blue-tinted. For glare reduction.

### Outlet Box

- Prewired 14 GA (NEC) galvanized steel, UL listed. 1/2" and 3/4" knockouts.

### Installation

- 27" galvanized hanger bars with adjustable leveling plates.
- For ceiling installation, see Options -C and -C2.
- For wall installation, see Options -W and -W2.

### UL/CUL (Compact) Distinctive

- UL listed, only for locations where code is required. The only UL listed compact fluorescent fixture with a three year limited warranty.
- Complete standard fixture and ballast.

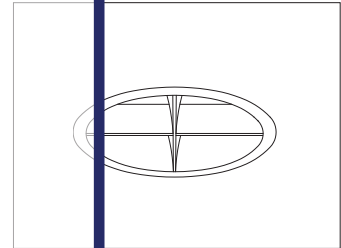

Recessed Round  
Open  
X-CELL™  
Shallow Plenum

Please consult

# QUOTATIONS

for the best alternative.

## Performance at a Glance

FRR-07024

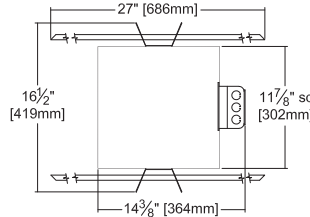
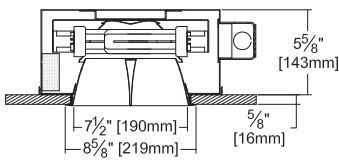

Ceiling Cut-out  
8" Dia.

- Cone of Light Key**
- Ft.** Distance from fixture
  - FC** Footcandles at nadir (0°)
  - Dia.** Circle of light at 50% of FC
  - \* Dia. (in ft.) shown is where FC value is half the FC at nadir.

FRR-07024 (2 Triple 42W)

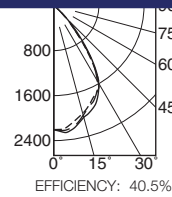

**Cone of Light\***

Dist.	FC	Dia.
6	61.2	6.6
8	34.4	8.8
10	22.0	11.0
12	15.3	13.2
14	11.2	15.4
16	8.6	17.6

--- 0° SC 1.1  
--- 45° SC 1.1  
--- 90° SC 1.1

EFFICIENCY: 40.5%

FRR-07024 (2 Triple 32W)

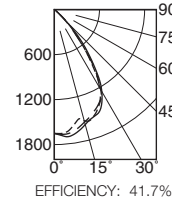

**Cone of Light\***

Dist.	FC	Dia.
6	45.9	6.8
8	25.8	9.1
10	16.5	11.4
12	11.5	13.6
14	8.4	15.9
16	6.4	18.2

--- 0° SC 1.1  
--- 45° SC 1.1  
--- 90° SC 1.1

EFFICIENCY: 41.7%

# THE KIRLIN COMPANY

3401 EAST JEFFERSON AVENUE • DETROIT, MICHIGAN 48207-4232  
(313) 259-6400 • Fax: (313) 259-9409 OR (313) 259-3121 • www.kirlinlighting.com

RENAISSANCE SERIES  
COMPACT FLUORESCENT LIGHTING

MAXIMUM WATTAGE

2 Triple 42

CATALOG NUMBER

FRR-07024

DUE TO OUR CONTINUING EFFORT TO IMPROVE PRODUCTS, TECHNICAL INFORMATION IS SUBJECT TO CHANGE WITHOUT NOTICE.

Alzak® is a registered trademark of ALCOA.

Detailed Photometry - Installed Fixture

Photometry from I.T.L., Boulder, CO

FRR-07024 (2 Triple 42)

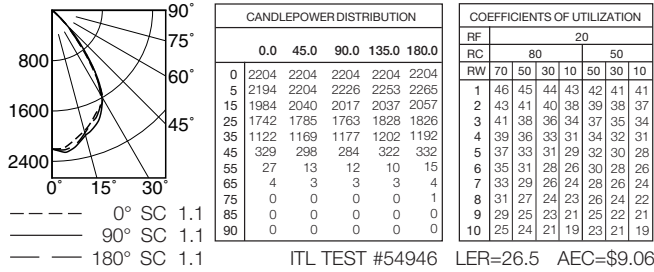

EFFICIENCY : 40.5%

FRR-07024 (2 Triple 32)

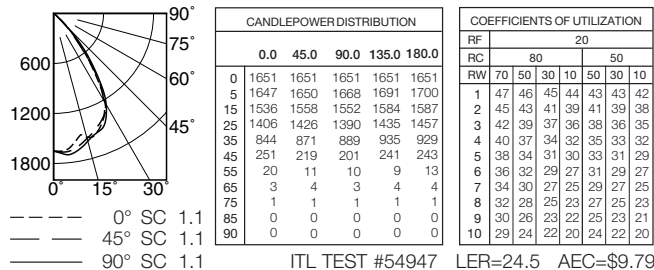

EFFICIENCY : 41.7%

FRR-07024 (2 Quad 26)

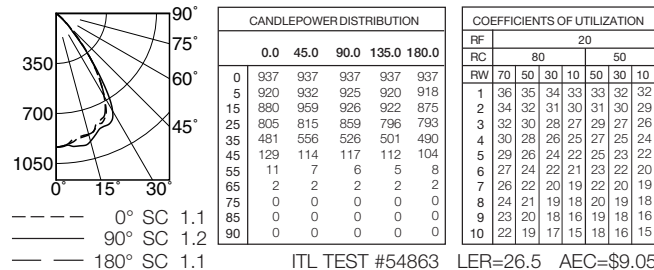

EFFICIENCY : 31.5%

\* LER = Luminaire Efficiency Rating

LER = Luminaire Effic. x Total Lamp Lumens x Ballast Factor / Input Watts

• AEC = Annual Energy Cost per 1000 lumens (based on 3000 hours use @ \$0.08 KWH).

Options

Ballast, Wattage and Voltage

- 39 Installed electronic dimming ballast. Indoor use. 10°C (50°F) minimum start. Specify wattage, voltage and brand.
- 43 Lower wattage: for either 4-pin electronic 2x18W triple/quad or 2x13W quad (only). Specify wattage.
- 84 Wired for two circuits. Also see -FD.
- 97 Specify other voltage. Consult factory.
- 98 347 volt, 50/60 Hz. input. Consult factory.

Emergency Ballast - Specify Voltage<sup>1</sup>

Internal (factory installed) ballast, test switch and indicator light. Suitable for damp locations from 0° to 50°C (32° to 122°F) or with Cold Weather version (see -CE) -20° to 55°C (-4° to 131°F).

- 73 Internal 1-lamp EM ballast. Specify voltage.
- CE Internal cold weather (-20° to 55°C) 1-lamp EM ballast. Specify voltage.
- HE<sup>1</sup> Internal higher lumen (up to 1250) 1-lamp EM ballast. 13-42W only. Specify voltage.

Trims

- 30 All white cross baffle and flange. (CP x .95)
- 31 White flange (only) on cross baffle.
- 32 White oversize trim ring. Specify O.D.
- 45 Gasket between ceiling and baffle flange.
- 70 SofTex Clear cross baffle. (CP x .92)
- 79 Extension collar for ceilings up to 2" thick.
- 94 Custom color/finish. Specify. Consult factory.
- WW Wall wash cross baffle.

ShatterGuard™ Shield (Beneath Lamp)

- 15 Prismatic C#73 tempered glass lens.
- SG .125" clear polycarbonate.

Other

- 99 Special modification. Consult factory.
- FD Two additional in-line fuses. One per ballast. Use with Option -84. Not available with Option -98(347V).
- FS Additional in-line fuse. Not available with Option -98 (347V).
- LE With 4-pin electronic lamp. 3500°K standard. 82 CRI and 12,000 hour life. Specify wattage, style and color temperature.

<sup>1</sup> Visit [www.kirlinlighting.com](http://www.kirlinlighting.com) for most current performance / specifications.

SUBMITTAL DATA

JOB NAME

TYPE

WATTAGE

VOLTAGE

CATALOG NUMBER

APPROVAL STAMP

LIMITED WARRANTY: CATALOGED KIRLIN FIXTURES ARE WARRANTED FREE OF DEFECTS IN WORKMANSHIP OR MATERIAL FOR THREE YEARS FROM DATE OF PURCHASE. INSTALLED TO N.E.C. IN NORMAL USE. Manufacturer at the option will inspect or repair such fixture or refund the purchase price on presentation of proof of purchase and defective fixture in the office of manufacturer within three years of original shipment. Liability of manufacturer is limited to the foregoing, and manufacturer shall not be liable for any other damages, direct or indirect, sustained or suffered by purchaser or any person. This warranty is supplied to the buyer in place of all other warranties, expressed or implied. Seller does not warrant as to merchantability or fitness for a particular use, nor will any oral statement constitute a warranty or amend this specific warranty. Abnormal use, abuse of the fixture, improper installation, or repair, or modification of the fixture without prior written authorization from the manufacturer will render the warranty void.