

CATALOG #	TYPE	
JOB NAME	WATTAGE	VOLTAGE

7" 1 Triple 70 WATT MAXIMUM

FRR-07023

X-CELL™ Parabolic Louver
in Shallow Plenum

THIS PRODUCT IS NO LONGER AVAILABLE

Features

Lamp

- Designed for one 4-pin triple/four tube maximum compact fluorescent lamp:
- 70W triple/four tube.

Ballast: Multi Voltage

- Installed electronic high power factor, thermally protected. For lower wattages: Option -43.
- 120-277 multi-volt; 50/60 Hz. THD < 10%.
- ClickQuick connectors for easy service.
- Cold weather -22°F (-30°C).
- End of lamp life protection circuit. For more information see Option -FC.
- Internally fused. Also see Option -FO.

Reflector

- Upper: Spectular Alzak® aluminum reflector.
- Lower: Low-mercury (L.I.) self-shielding Alzak® aluminum cone and 4 cell reflector baffle, self-fanged.
- See Options for other finishes.

Minimum Fusing

- Acrylic enameled. Rustproof: Exceeds 1000 hour ASTM 5% salt spray test.
- Lightweight: Minimizes air load.
- Cool operation: Extended life expectancy.
- Easy mounting: Designed for high aperture.
- Built-in plaster frame.

Outlet Box

- Prewired 14 GA (NEC) galvanized steel, UL listed. 1/2" and 3/4" knockouts.

Installation

- 27" galvanized hanger bars with adjustable leveling bracket (see Option -L).
- Recesses indoor or outdoor in covered locations.

Three Year Limited Warranty

- Complete standard fixture and ballast.

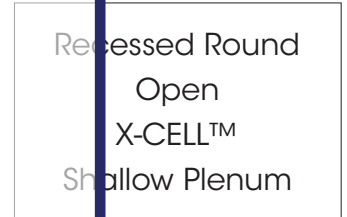
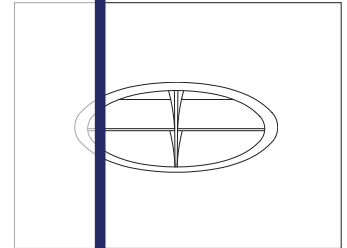

Please consult **QUOTATIONS** for the best alternative.

Performance at a Glance

FRR-07023

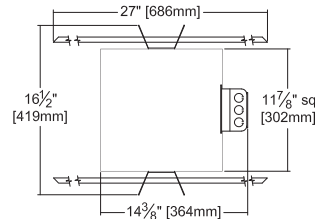
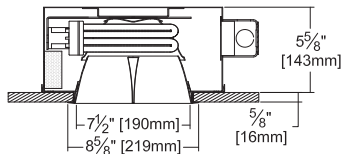

Ceiling Cut-out
8" Dia.

Cone of Light Key

- Ft. Distance from fixture
- FC Footcandles at nadir (0°)
- Dia. Circle of light at 50% of FC
- Dia. (in ft.) shown is where FC value is half the FC at nadir.

FRR-07023 (1 Triple 70W)

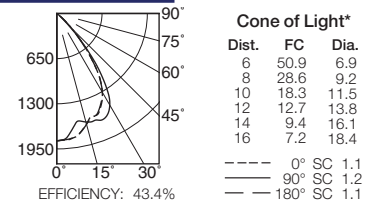

FRR-07023-43 (1 Triple 57W)

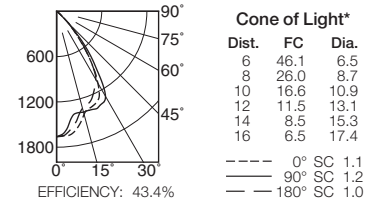

THE KIRLIN COMPANY

3401 EAST JEFFERSON AVENUE • DETROIT, MICHIGAN 48207-4232
(313) 259-6400 • Fax: (313) 259-9409 OR (313) 259-3121 • www.kirlinlighting.com

RENAISSANCE SERIES
COMPACT FLUORESCENT LIGHTING

MAXIMUM WATTAGE

1 Triple 70

CATALOG NUMBER

FRR-07023

DUE TO OUR CONTINUING EFFORT TO IMPROVE PRODUCTS, TECHNICAL INFORMATION IS SUBJECT TO CHANGE WITHOUT NOTICE.

Alzak® is a registered trademark of ALCOA.

Detailed Photometry - Installed Fixture

Photometry from I.T.L., Boulder, CO

FRR-07023 (1 Triple 70)

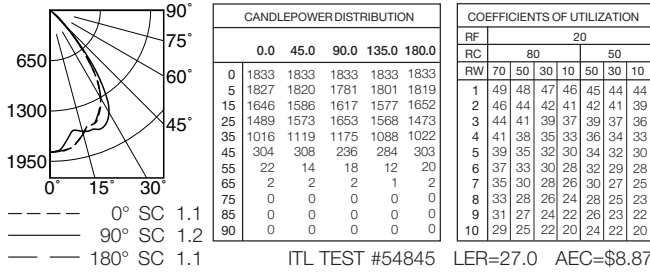

EFFICIENCY : 43.4%

FRR-07023-43 (1 Triple 57)

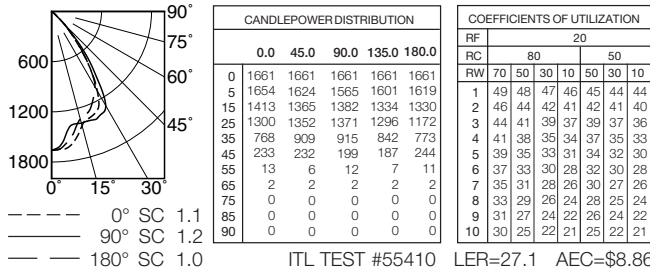

EFFICIENCY : 43.4%

FRR-07023-43 (1 Triple 42)

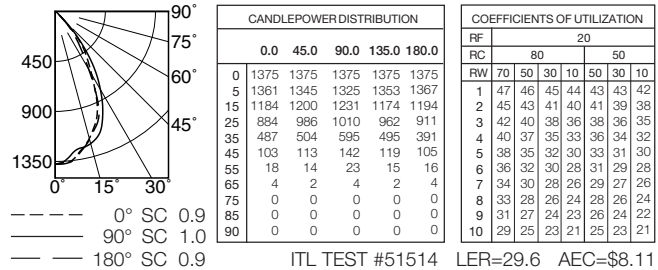

EFFICIENCY : 41.6%

* LER = Luminaire Efficiency Rating

LER = Luminaire Effic. x Total Lamp Lumens x Ballast Factor
Input Watts

• AEC = Annual Energy Cost per
1000 lumens (based on 3000
hours use @ \$0.08 KWH).

Options

Ballast, Wattage and Voltage

- 39 Installed electronic dimming ballast. Not Type IC listed. Indoor use. 10°C (50°F) minimum start. Specify wattage, voltage and brand. Not available with Option -75, -CR or -HR.
- 43 Lower wattage: for 4-pin 57W triple/four tube or 42/32/26W triple or 26W quad (multi-wattage/voltage). Specify wattage.
- 97 Specify other voltage. Consult factory.
- 98 347 volt, 50/60 Hz. input. Consult factory.

Emergency Ballast - Specify Voltage¹

Remote (field mounted) ballast, test switch and indicator light. Suitable for damp locations from

- 0° to 50°C (32° to 122°F) or with Cold Weather version (see -CR) -20° to 55°C (-4° to 131°F).
- 75 Remote 1-lamp EM ballast. Specify voltage.
- CR Remote cold weather (-20° to 55°C) 1-lamp EM ballast. Specify voltage.
- HR¹ Remote higher lumen (up to 1250) 1-lamp EM ballast. 13-42W only. Specify voltage.

Trims

- 30 All white cross baffle and flange. (CP x .95)
- 31 White flange (only) on cross baffle.
- 32 White oversize trim ring. Specify O.D.
- 45 Gasket between ceiling and baffle flange.
- 70 SofTex Clear cross baffle. (CP x .92)
- 79 Extension collar for ceilings up to 2" thick.

- 94 Custom color/finish. Specify. Consult factory.
- WW Wall wash cross baffle.

ShatterGuard™ Shield (Beneath Lamp)

- 15 Prismatic C#73 tempered glass lens.

Other

- 99 Special modification. Consult factory.
- FS Additional in-line fuse. Not available with Option -98 (347V).
- LE With 4-pin electronic lamp. 3500°K standard. 82 CRI and 12,000 hour life. Specify wattage, style and color temperature.

¹ Visit www.kirlinlighting.com for most current performance / specifications.

SUBMITTAL DATA

JOB NAME

TYPE

WATTAGE

VOLTAGE

CATALOG NUMBER

APPROVAL STAMP

LIMITED WARRANTY: CATALOGED KIRLIN FIXTURES ARE WARRANTED FREE OF DEFECTS IN WORKMANSHIP OR MATERIAL FOR THREE YEARS FROM DATE OF PURCHASE. INSTALLLED TO N.E.C. IN NORMAL USE. Manufacturer at the option will repair or replace such fixture or refund the purchase price upon presentation of proof of purchase and defective fixture in the office of manufacturer within three years of original shipment. Liability of manufacturer is limited to the foregoing, and manufacturer shall not be liable for any other damages, direct or indirect, sustained or suffered by purchaser or any person. This warranty is supplied to the buyer in place of all other warranties, expressed or implied. Seller does not warrant as to merchantability or fitness for a particular use, nor will any oral statement constitute a warranty or amend this specific warranty. Abnormal use, abuse of the fixture, improper installation, or repair, or modification of the fixture without prior written authorization from the manufacturer will render the warranty void.