

CATALOG #	TYPE	
JOB NAME	WATTAGE	VOLTAGE

7" 1 Triple 42 WATT MAXIMUM

FRR-07022

X-CELL™ Parabolic Louver with Type IC in Shallow Housing

# THIS PRODUCT IS NO LONGER AVAILABLE

## Features

### Lamp

- Designed for one 4-pin triple tube compact fluorescent lamp: 42/32/26W triple or 26W quad.

### Ballast: Multi Wattage/Voltage

- Installed electronic high power factor, thermally protected. For lower wattages: Option -43.
- 120-277 multi-volt; 50/60 Hz. THD < 10%.
- ClickQuick connectors for easy service.
- Cold weather -22°F (-30°C).
- End of lamp life protection circuit. Full filter.
- Internally fused. Also see Option -FS.

### Reflector

- Upper: Spectular Alzak® aluminum.
- Lower: Low-meridescence (L.I.) self-shielded Alzak® aluminum cone and 4 cell parabolic cross baffle, self-fingering.
- See Options for accessories.

### Maximum Housing

- Acrylenelektro Finish. 100,000 hour L70 maintenance free.
- Lightweight: Minimizes ceiling load.
- Cool operation: Extends component life.
- Entire luminaires viewed through aperture. Built-in plastic trim with no visible joints.
- Prewired 14-GA (NEC) galvanized steel, UL listed. 1/2" and 3/4" knockouts.

### Installation

- 27" galvanized hanger bars with adjustable mounting brackets (2) supplied.

### UL, C-UL (Canada) Listings

- Wet, damp or dry locations, covered ceilings.
- The UL is approved for direct contact with insulation.
- Through-branch conductors (0 #12).

### Three Year Limited Warranty

- Complete standard 3-year limited warranty.

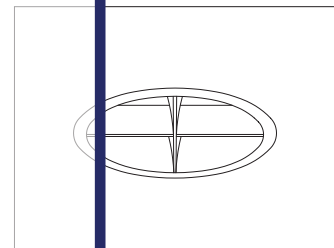

Recessed Round  
Open  
X-CELL™  
Shallow Plenum  
Type IC

Please consult **QUOTATIONS** for the best alternative.

## Performance at a Glance

FRR-07022

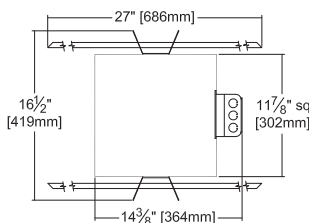
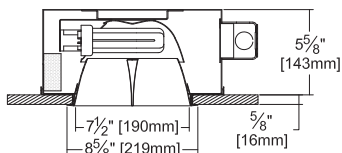

Ceiling Cut-out  
8" Dia.

FRR-07022 (1 Triple 42W)

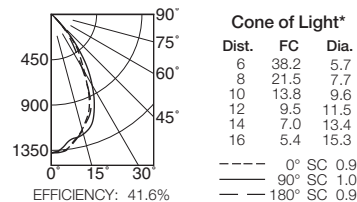

### Cone of Light Key

- Ft. Distance from fixture
- FC Footcandles at nadir (0°)
- Dia. Circle of light at 50% of FC
- \* Dia. (in ft.) shown is where FC value is half the FC at nadir.

# THE KIRLIN COMPANY

3401 EAST JEFFERSON AVENUE • DETROIT, MICHIGAN 48207-4232  
(313) 259-6400 • Fax: (313) 259-9409 OR (313) 259-3121 • www.kirlinlighting.com

RENAISSANCE SERIES  
COMPACT FLUORESCENT LIGHTING

MAXIMUM WATTAGE

1 Triple 42

CATALOG NUMBER

FRR-07022

DUE TO OUR CONTINUING EFFORT TO IMPROVE PRODUCTS, TECHNICAL INFORMATION IS SUBJECT TO CHANGE WITHOUT NOTICE.

Alzak® is a registered trademark of ALCOA.

Detailed Photometry - Installed Fixture

Photometry from I.T.L., Boulder, CO

FRR-07022 (1 Triple 42)

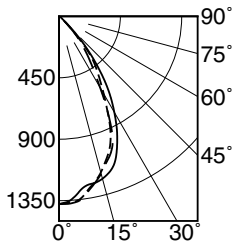

----- 0° SC 0.9  
 ----- 90° SC 1.0  
 ----- 180° SC 0.9

EFFICIENCY : 41.6%

CANDLEPOWER DISTRIBUTION					
	0.0	45.0	90.0	135.0	180.0
0	1375	1375	1375	1375	1375
5	1361	1345	1325	1353	1367
15	1184	1200	1231	1174	1194
25	884	986	1010	962	911
35	487	504	595	495	391
45	103	113	142	119	105
55	18	14	23	15	16
65	4	2	4	2	4
75	0	0	0	0	0
85	0	0	0	0	0
90	0	0	0	0	0

ITL TEST #51514 LER=29.6 AEC=\$8.11

COEFFICIENTS OF UTILIZATION						
RF	20					
	80			50		
RC	70	50	30	10	50	30
RW	70	50	30	10	50	30
1	47	46	45	44	43	42
2	45	43	41	40	41	38
3	42	40	38	36	38	35
4	40	37	35	33	36	32
5	38	35	32	30	33	30
6	36	32	30	28	31	28
7	34	30	28	26	29	26
8	33	28	26	24	28	24
9	31	27	24	23	26	22
10	29	25	23	21	25	21

\* LER = Luminaire Efficiency Rating

LER = Luminaire Effic. x Total Lamp Lumens x Ballast Factor  
 Input Watts

• AEC = Annual Energy Cost per 1000 lumens (based on 3000 hours use @ \$0.08 KWH).

Options

Ballast, Wattage and Voltage

- 39 Installed electronic dimming ballast. Not Type IC listed. Indoor use. 10°C (50°F) minimum start. Specify wattage, voltage and brand.
- 43 Lower wattage: for either 4-pin electronic 2x18W triple/quad or 2x13W quad (only). Specify wattage.
- 97 Specify other voltage. Consult factory.
- 98 347 volt, 50/60 Hz. input. Consult factory.

Emergency Ballast - Specify Voltage<sup>1</sup>

Internal (factory installed) ballast, test switch and indicator light. Suitable for damp locations from 0° to 50°C (32° to 122°F) or with Cold Weather version (see -CE) -20° to 55°C (-4° to 131°F).

- 73 Internal 1-lamp EM ballast. Specify voltage.
- CE Internal cold weather (-20° to 55°C) 1-lamp EM ballast. Specify voltage.
- HE<sup>1</sup> Internal higher lumen (up to 1250) 1-lamp EM ballast. 13-42W only. Specify voltage.

Trims

- 30 All white cross baffle and flange. (CP x .95)
- 31 White flange (only) on cross baffle.
- 32 White oversize trim ring. Specify O.D.
- 45 Gasket between ceiling and baffle flange.
- 70 SofTex Clear cross baffle. (CP x .92)
- 79 Extension collar for ceilings up to 2" thick.
- 94 Custom color/finish. Specify. Consult factory.
- WW Wall wash cross baffle.

ShatterGuard™ Shield (Beneath Lamp)

- 15 Prismatic C#73 tempered glass lens.
- SG .125" clear polycarbonate.

Other

- 99 Special modification. Consult factory.
- FS Additional in-line fuse. Not available with Option -98 (347V).
- LE With 4-pin electronic lamp. 3500°K standard. 82 CRI and 12,000 hour life. Specify wattage, style and color temperature.

<sup>1</sup> Visit [www.kirlinlighting.com](http://www.kirlinlighting.com) for most current performance / specifications.

SUBMITTAL DATA

APPROVAL STAMP

JOB NAME

TYPE

WATTAGE

VOLTAGE

CATALOG NUMBER

LIMITED WARRANTY: CATALOGED KIRLIN FIXTURES ARE WARRANTED FREE OF DEFECTS IN WORKMANSHIP OR MATERIAL FOR THREE YEARS FROM DATE OF PURCHASE. INSTALLLED TO N.E.C. IN NORMAL USE. Manufacturer at his option will repair or replace such fixtures or refund the purchase price on presentation of a proof of purchase and defective fixture at the offices of manufacturer within three years of original shipment. Liability of manufacturer is limited to the foregoing, and manufacturer shall not be liable for any other damages, direct or indirect, sustained or suffered by purchaser or any person. This warranty is supplied to the buyer in place of all other warranties, expressed or implied. Seller does not warrant as to merchantability or fitness for a particular use, nor will any oral statement constitute a warranty or amend this specific warranty. Abnormal use, abuse of the fixture, improper installation, or repair, or modification of the fixture without prior written authorization from the manufacturer will render the warranty void.