

CATALOG #	TYPE	
JOB NAME	WATTAGE	VOLTAGE

7" 2 Triple 42 WATT MAXIMUM

FRR-07018

2 Lamp Dual Reflector
with Excellent Visual Comfort

THIS PRODUCT IS NO LONGER AVAILABLE

Features

Lamp

- Designed for two 4-pin triple tube amalgam or quad compact fluorescent lamps: 42/32/26W triple or 26W quad.

Ballast: Multi Wattage/Voltage

- Installed electronic high power factor, thermally protected. For lower wattages: Option -43.
- 120-277 multi-volt; 50/60 Hz. THD < 10%.
- ClickQuick connectors for easy service.
- Single circuit wiring or see Option -84.
- Cold weather -22°F (-30°C).
- End of lamp life protection circuit. For intermediate life protection circuit, see Option -84.
- Internally fused. Also see Options -FS, -FD.

Reflector

- Upper: Spherical Alzak® aluminum.
- Lower: Low-iridescence (L.I.) Alzak aluminum, one piece, self-flanged.
- See Options for other finishes.

Aluminum Housing

- Acrylic panels. First, second cycle, 100-hour ASTM 5% salt spray test.

- Lightweight: Minimizes ceiling load.
- Quiet operation. Extends life of ballast.
- Entire luminaires are made through a die.
- Built-in blast shields.

Ceiling Box

- Prewired 14 GA (NEC) galvanized steel, UL listed. 1/2" and 3/4" knockouts.

Installation

- 27" galvanized hanger bars with adjustable mounting brackets (2) supplied.
- Please see instructions for mounting locations.

UL, C-UL (Canada) Listings

- UL Type of Listing: Type I, Class II, Division 1, Group C.
- UL Type of Listing: Type I, Class II, Division 1, Group C.
- This listing is limited to the following:
- Complete standard fixture and ballast.

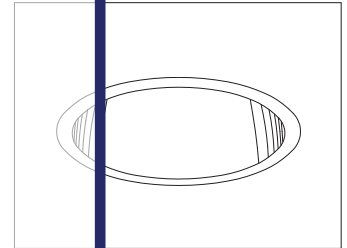

Recessed Round
Open
Dual Reflector

Selected Optional Trims:

- All White Option -30
- Sofluxe Titanium Option -57
- Sofluxe Dune Option -71
- Sofluxe Pewter Option -77
- Sofluxe Wheat Option -91
- Black OptiGroove Option -OG

Please consult

QUOTATIONS

for the best alternative.

Performance at a Glance

FRR-07018

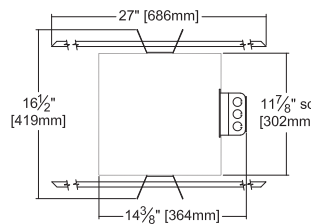
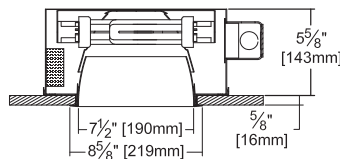

Ceiling Cut-out
8" Dia.

Cone of Light Key
Ft. Distance from fixture
FC Footcandles at nadir (0°)
Dia. Circle of light at 50% of FC
 • Dia. (in ft.) shown is where FC value is half the FC at nadir.

FRR-07018 (2 Triple 42W)

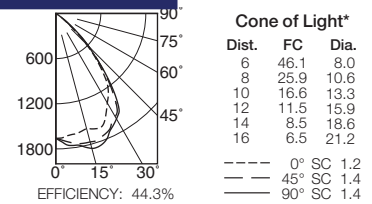

FRR-07018 (2 Triple 32W)

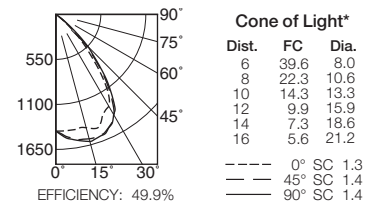

THE KIRLIN COMPANY

3401 EAST JEFFERSON AVENUE • DETROIT, MICHIGAN 48207-4232
 (313) 259-6400 • Fax: (313) 259-9409 OR (313) 259-3121 • www.kirlinlighting.com

RENAISSANCE SERIES
COMPACT FLUORESCENT LIGHTING

MAXIMUM WATTAGE

2 Triple 42

CATALOG NUMBER

FRR-07018

DUE TO OUR CONTINUING EFFORT TO IMPROVE PRODUCTS, TECHNICAL INFORMATION IS SUBJECT TO CHANGE WITHOUT NOTICE.

Alzak® is a registered trademark of ALCOA.

Detailed Photometry - Installed Fixture

Photometry from I.T.L., Boulder, CO

FRR-07018 (2 Triple 42)

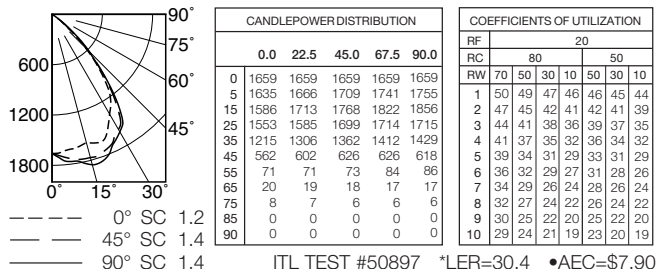

EFFICIENCY : 44.3%

FRR-07018 (2 Triple 32)

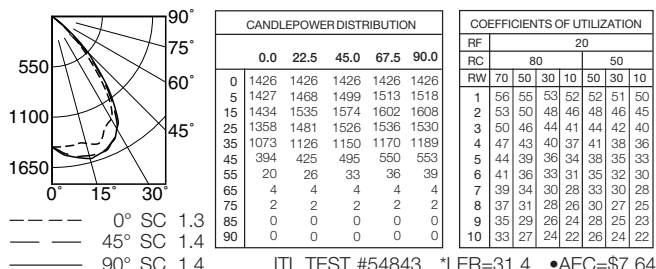

EFFICIENCY : 49.9%

FRR-07018 (2 Quad 26)

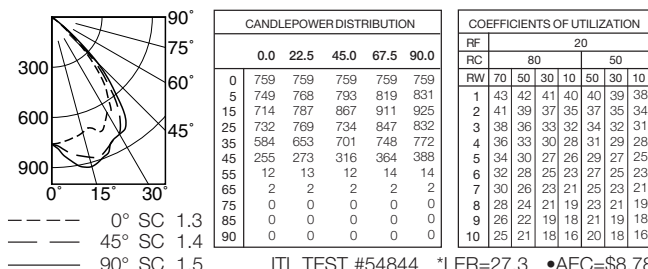

EFFICIENCY : 38.4%

* LER = Luminaire Efficiency Rating

LER = Luminaire Effic. x Total Lamp Lumens x Ballast Factor / Input Watts

• AEC = Annual Energy Cost per 1000 lumens (based on 3000 hours use @ \$0.08 KWH).

Options

Ballast, Wattage and Voltage

- 39 Installed electronic dimming ballast. Indoor use. 10°C (50°F) minimum start. Specify wattage, voltage and brand.
- 43 Lower wattage: for either 4-pin electronic 2x18W triple/quad or 2x13W quad (only). Specify wattage.
- 84 Wired for two circuits. Also see -FD.
- 97 Specify other voltage. Consult factory.
- 98 347 volt, 50/60 Hz. input. Consult factory.

Emergency Ballast - Specify Voltage¹

- Internal (factory installed) ballast, test switch and indicator light. Suitable for damp locations from 0° to 50°C (32° to 122°F) or with Cold Weather version (see -CE) -20° to 55°C (-4° to 131°F).
- 73 Internal 1-lamp EM ballast. Specify voltage.

- CE Internal cold weather (-20° to 55°C) 1-lamp EM ballast. Specify voltage.
- HE¹ Internal higher lumen (up to 1250) 1-lamp EM ballast. 13-42W only. Specify voltage.

ShatterGuard™ Shield (Beneath Lamp)

- 15 Prismatic C#73 tempered glass.
- SG .125" clear polycarbonate.

Trims

- 30 All white lower cone. (CP x .95)
- 31 White acrylic enameled lower cone flange.
- 32 White oversize trim ring. Specify O.D.
- 45 Gasket between ceiling and cone flange.
- 57 Softex Titanium lower cone. (CP x .80)
- 70 Softex Clear lower cone. (CP x .92)
- 71 Softex Dune lower cone. (CP x .88)
- 77 Softex Pewter lower cone. (CP x .85)
- 79 Extension collar for ceilings up to 2" thick.

- 90 Softex Champagne Gold lower cone. (CPx.91)
- 91 Softex Wheat lower cone. (CP x .87)
- 94 Custom color/finish. Specify. Consult factory.
- OG OptiGroove black seamless tapered aluminum cone with white flange. (CPx.70)

Other

- 99 Special modification. Consult factory.
- FD Two additional in-line fuses. One per ballast. Use with Option -84. Not available with Option -98 (347V).
- FS Additional in-line fuse. Not available with Option -98 (347V).
- LE With 4-pin electronic lamp. 3500°K standard. 82 CRI and 12,000 hour life. Specify wattage, style and color temperature.

¹ Visit www.kirlinlighting.com for most current performance / specifications.

SUBMITTAL DATA

APPROVAL STAMP

JOB NAME

TYPE

WATTAGE

VOLTAGE

CATALOG NUMBER

LIMITED WARRANTY: CATALOGED KIRLIN FIXTURES ARE WARRANTED FREE OF DEFECTS IN WORKMANSHIP OR MATERIAL FOR THREE YEARS FROM DATE OF PURCHASE. INSTALLLED TO N.E.C. IN NORMAL USE. Manufacturer at the option will inspect or repair such fixture or refund the purchase price on presentation of proof of purchase and defective fixture in the office of manufacturer within three years of original shipment. Liability of manufacturer is limited to the foregoing, and manufacturer shall not be liable for any other damages, direct or indirect, sustained or suffered by purchaser or any person. This warranty is supplied to the buyer in place of all other warranties, expressed or implied. Seller does not warrant as to merchantability or fitness for a particular use, nor will any oral statement constitute a warranty or amend this specific warranty. Abnormal use, abuse of the fixture, improper installation, or repair, or modification of the fixture without prior written authorization from the manufacturer will render the warranty void.