

CATALOG #	TYPE	
JOB NAME	WATTAGE	VOLTAGE

6" 1 Triple 32 WATT MAXIMUM

FRR-06035

Type IC Lensed Downlight -

Air Tight Option -AT

Note New Housing Dimensions & Option -SN

Features

Lamp

- Designed for one 4-pin triple tube amalgam compact fluorescent lamp: 32/26W triple.

Ballast: Multi-Wattage/Voltage

- Installed electronic high power factor ballast protected. For lower wattages: Option -45.
- 120-277 multi-volt; 50/60 Hz. THD < 10%.
- ClickQuick connectors for easy service.
- Cold weather -22°F (-30°C).
- End of lamp life protection circuit. RFL filter.
- Internally fused. Also see Option -FS.

Reflector

- Specular Alzak® aluminum.

Trim Assembly

- Tapered aluminum one piece black or white flange or all white smooth aluminum trim (Option -40) as shown in section view.
- Regressed tempered prismatic C#73 lens.

Aluminum Housing

- Acrylic enameled finish of: Exceeds 1000

THIS PRODUCT IS NO LONGER AVAILABLE

Please consult

QUOTATIONS

for the best alternative.

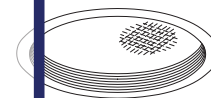

Recessed Round
Regressed Lens
Type IC

Selected Optional Trims:

- Oval Diffuser Option -18
- White Grooveless Flare Option -40
- Fresnel Lens Option -FR

Performance at a Glance

FRR-06035

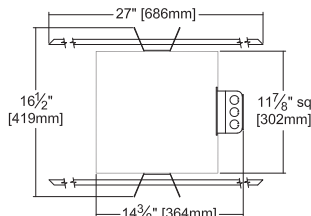
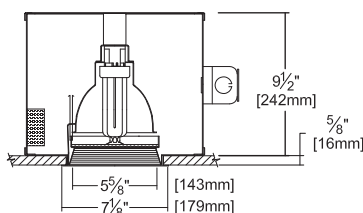

Ceiling Cut-out
6 3/4" Dia.

Cone of Light Key

- Ft. Distance from fixture
- FC Footcandles at nadir (0°)
- Dia. Circle of light at 50% of FC
- Dia. (in ft.) shown is where FC value is half the FC at nadir.

FRR-06035 (1 Triple 32W)

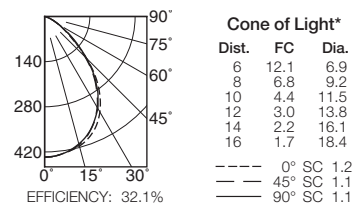

FRR-06035 (1 Triple 26W)

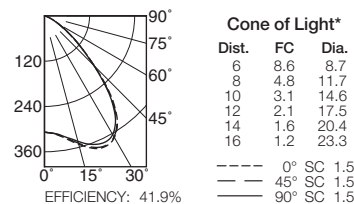

THE KIRLIN COMPANY

3401 EAST JEFFERSON AVENUE • DETROIT, MICHIGAN 48207-4232
(313) 259-6400 • Fax: (313) 259-9409 OR (313) 259-3121 • www.kirlinlighting.com

RENAISSANCE SERIES
COMPACT FLUORESCENT LIGHTING

MAXIMUM WATTAGE

1 Triple 32

CATALOG NUMBER

FRR-06035

DUE TO OUR CONTINUING EFFORT TO IMPROVE PRODUCTS, TECHNICAL INFORMATION IS SUBJECT TO CHANGE WITHOUT NOTICE.

Alzak® is a registered trademark of ALCOA.

Detailed Photometry - Installed Fixture

Photometry from I.T.L., Boulder, CO

FRR-06035 (1 Triple 32)

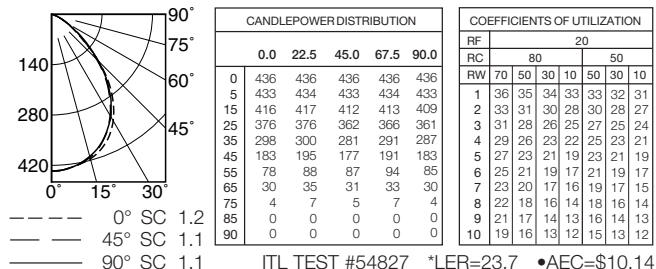

EFFICIENCY : 32.1%

FRR-06035 (1 Triple 26)

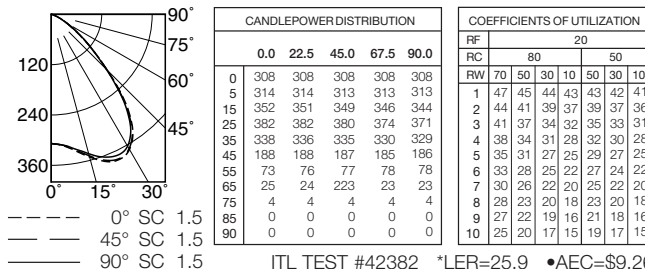

EFFICIENCY : 41.9%

FRR-06035-40 (1 Triple 32 - White Flare)

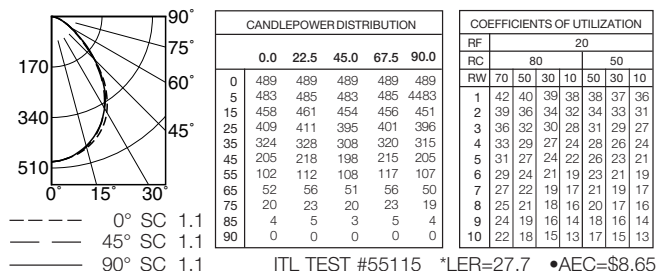

EFFICIENCY : 37.5%

* LER = Luminaire Efficiency Rating

LER = Luminaire Effic. x Total Lamp Lumens x Ballast Factor / Input Watts

• AEC = Annual Energy Cost per 1000 lumens (based on 3000 hours use @ \$0.08 KWH).

Options

Ballast, Wattage and Voltage

- 39 Installed electronic dimming ballast. Not Type IC listed. Indoor use. 10°C (50°F) minimum start. Specify wattage, voltage and brand.
- 43 Lower wattage: for either 4-pin electronic 18W triple/quad or 13W quad (only). Specify wattage.
- 97 Specify other voltage. Consult factory.
- 98 347 volt, 50/60 Hz. input. Consult factory.

Emergency Ballast - Specify Voltage¹

- Internal (factory installed) ballast, test switch and indicator light. Suitable for damp locations from 0° to 50°C (32° to 122°F) or with Cold Weather version (see -CE) -20° to 55°C (-4° to 131°F).
- 73 Internal 1-lamp EM ballast. Specify voltage.

- CE Internal cold weather (-20° to 55°C) 1-lamp EM ballast. Specify voltage.
- HE¹ Internal higher lumen (up to 1250) 1-lamp EM ballast. 13-42W only. Specify voltage.

Lenses and Trims

- 13 Vandal resistant tempered prismatic C#73 spread lens above 1/8" polycarbonate.
- 17 .187" prismatic high strength acrylic lens.
- 18 Opal flat glass diffuser.
- 20 White aluminum egg-crate louver (1/2" cubes).
- 21 White flat polycarbonate diffuser.
- 32 White oversize trim ring. Specify O.D.
- 40 White grooveless flare trim. (CP x 1.10)
- 45 Gasket between ceiling and trim flange.
- 46 Gasket between trim and lens.
- 94 Custom color/finish. Consult factory.

- CF High temperature color filter. Specify color.
- FR Fresnel tempered glass lens.
- FT Flat white trim.
- UV UV filter. Consult factory.

Top Access

- TA Top access for servicing from above.

Other

- 99 Special modification. Consult factory.
- AT Air tight with Type IC. Meets / exceeds ASTM E283 restricted airflow of 2 CFM maximum.
- FS Additional in-line fuse. Not available with Option -98 (347V).
- LE With 4-pin electronic lamp. 3500°K standard. 82 CRI and 12,000 hour life. Specify wattage, style and color temperature.
- SN Super narrow housing instead. 7"W x 11-7/8" L x 10-1/8" plenum depth.

¹ Visit www.kirlinlighting.com for most current performance Lumens / specifications.

SUBMITTAL DATA

JOB NAME

TYPE

WATTAGE

VOLTAGE

CATALOG NUMBER

APPROVAL STAMP

LIMITED WARRANTY: CATALOGED KIRLIN FIXTURES ARE WARRANTED FREE OF DEFECTS IN WORKMANSHIP OR MATERIAL FOR THREE YEARS FROM DATE OF PURCHASE. INSTALLLED TO N.E.C. IN NORMAL USE. Manufacturer at the option will replace or repair such fixture or refund the purchase price upon presentation of a proof of purchase and defective fixture at the office of manufacturer within three years of original shipment. Liability of manufacturer is limited to the foregoing, and manufacturer shall not be liable for any other damages, direct or indirect, sustained or suffered by purchaser or any person. This warranty is supplied to the buyer in place of all other warranties, expressed or implied. Seller does not warrant as to merchantability or fitness for a particular use, nor will any oral statement constitute a warranty or amend this specific warranty. Abnormal use, abuse of the fixture, improper installation, or repair, or modification of the fixture without prior written authorization from the manufacturer will render the warranty void.