

CATALOG #	TYPE	
JOB NAME	WATTAGE	VOLTAGE

6" 1 Triple 26 WATT MAXIMUM

FRR-06033

Super Shallow Lensed Downlight
with Type IC

THIS PRODUCT IS NO LONGER AVAILABLE

Features

Lamp

- Designed for one 4-pin triple tube amalgam compact fluorescent lamp: 26W triple

Ballast: Multi-Voltage

- Installed electronic high power factor ballast protected. For lower wattages: Optional
- 120-277 multi-volt; 50/60 Hz. THD < 10%.
- ClickQuick connectors for easy service.
- Cold weather -22°F (-30°C).
- End of lamp life protection circuit. RFI filter.
- Internally fused. Also see Option -FS.

Reflector

- Specular Alzak® aluminum.

Trim Assembly

- White flat seamless aluminum one-piece self-flanged.
- Tempered prismatic C#73 spread distribution lenses or many optional lenses.

Aluminum Housing: Super Shallow Depth

- Acrylic enamel coated. Passes: E-Test 1, 2, 3, 4, 5, 6, 7, 8, 9, 10, 11, 12, 13, 14, 15, 16, 17, 18, 19, 20, 21, 22, 23, 24, 25, 26, 27, 28, 29, 30, 31, 32, 33, 34, 35, 36, 37, 38, 39, 40, 41, 42, 43, 44, 45, 46, 47, 48, 49, 50, 51, 52, 53, 54, 55, 56, 57, 58, 59, 60, 61, 62, 63, 64, 65, 66, 67, 68, 69, 70, 71, 72, 73, 74, 75, 76, 77, 78, 79, 80, 81, 82, 83, 84, 85, 86, 87, 88, 89, 90, 91, 92, 93, 94, 95, 96, 97, 98, 99, 100.

- Lightweight: Minimizes ceiling load.
- Cool operation: Extends component life.
- Efficacy: 90 lm/w. Efficacy: 90 lm/w. Efficacy: 90 lm/w.
- Efficacy: 90 lm/w. Efficacy: 90 lm/w. Efficacy: 90 lm/w.
- Efficacy: 90 lm/w. Efficacy: 90 lm/w. Efficacy: 90 lm/w.

Outlet Box

- Prewired 14 GA (NEC) galvanized steel, UL listed. 1/2" and 3/4" knockouts.

Installation

- 27" galvanized hanger bars with adjustable spacing (1/2" increments).
- 27" galvanized hanger bars with adjustable spacing (1/2" increments).
- 27" galvanized hanger bars with adjustable spacing (1/2" increments).

UL, CUL (Canada) Listings

- UL, CUL (Canada) Listings.
- UL, CUL (Canada) Listings.
- UL, CUL (Canada) Listings.

- Through-branch conductors (6 #12).

- Through-branch conductors (6 #12).

- Through-branch conductors (6 #12).

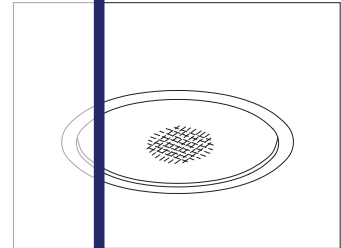

Recessed Round
Flat Lens
Shallow Plenum
Type IC

Please consult
QUOTATIONS
for the best alternative.

Performance at a Glance

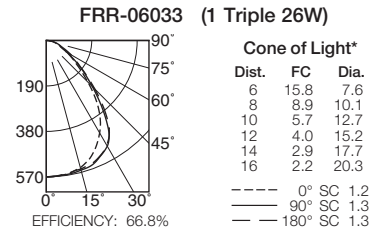
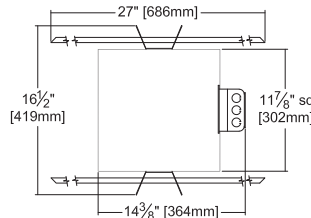
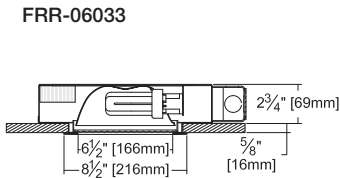

Cone of Light Key
Ft. Distance from fixture
FC Footcandles at nadir (0°)
Dia. Circle of light at 50% of FC
 * Dia. (in ft.) shown is where FC value is half the FC at nadir.

Ceiling Cut-out
8" Dia.

THE KIRLIN COMPANY

3401 EAST JEFFERSON AVENUE • DETROIT, MICHIGAN 48207-4232
 (313) 259-6400 • Fax: (313) 259-9409 OR (313) 259-3121 • www.kirlinlighting.com

RENAISSANCE SERIES
COMPACT FLUORESCENT LIGHTING

MAXIMUM WATTAGE

1 Triple 26

CATALOG NUMBER

FRR-06033

DUE TO OUR CONTINUING EFFORT TO IMPROVE PRODUCTS, TECHNICAL INFORMATION IS SUBJECT TO CHANGE WITHOUT NOTICE.

Alzak® is a registered trademark of ALCOA.

Detailed Photometry - Installed Fixture

Photometry from I.T.L., Boulder, CO

FRR-06033 (1 Triple 26)

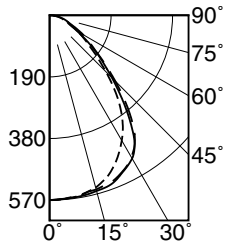

----- 0° SC 1.2
 _____ 90° SC 1.3
 - - - - - 180° SC 1.3

EFFICIENCY : 66.8%

	CANDLEPOWER DISTRIBUTION				
	0.0	45.0	90.0	135.0	180.0
0	570	570	570	570	570
5	568	569	568	566	567
15	550	559	561	559	556
25	491	518	534	524	532
35	392	435	453	450	459
45	246	266	273	276	287
55	136	136	146	146	156
65	69	73	72	78	84
75	40	42	46	47	46
85	12	14	15	16	15
90	0	0	0	0	0

RF	COEFFICIENTS OF UTILIZATION						
	20						
	80			50			
RC	70	50	30	10	50	30	10
1	74	71	69	66	67	65	63
2	68	63	60	56	60	57	54
3	63	57	52	48	54	50	47
4	58	51	46	42	49	45	41
5	54	47	41	37	44	40	37
6	50	42	37	33	41	36	33
7	47	39	33	30	37	33	29
8	44	36	30	27	34	30	27
9	41	33	28	24	32	27	24
10	39	31	26	22	30	25	22

ITL TEST #55661 *LER=45.7 •AEC=\$5.26

* LER = Luminaire Efficiency Rating

LER = Luminaire Effic. x Total Lamp Lumens x Ballast Factor
 Input Watts

• AEC = Annual Energy Cost per 1000 lumens (based on 3000 hours use @ \$0.08 KWH).

Options

Ballast, Wattage and Voltage

- 39 Installed electronic dimming ballast. Not Type IC listed. Indoor use. 10°C (50°F) minimum start. Specify wattage, voltage and brand. Not available with Option -75, -CR or -HR.
- 43 Lower wattage: for either 4-pin electronic 18W triple/quad or 13W quad (only). Specify wattage.
- 97 Specify other voltage. Consult factory.
- 98 347 volt, 50/60 Hz. input. Consult factory.

Emergency Ballast - Specify Voltage¹

Remote (field mounted) ballast, test switch and indicator light. Suitable for damp locations from

- 0° to 50°C (32° to 122°F) or with Cold Weather version (see -CR) -20° to 55°C (-4° to 131°F).
- 75 Remote 1-lamp EM ballast. Specify voltage.
- CR Remote cold weather (-20° to 55°C) 1-lamp EM ballast. Specify voltage.
- HR¹ Remote higher lumen (up to 1250) 1-lamp EM ballast. 13-42W only. Specify voltage.

Lenses and Trims

- 13 Vandal resistant tempered prismatic C#73 spread lens above 1/8" flat polycarbonate.
- 17 .187" prismatic flat high strength acrylic.
- 18 Opal flat glass diffuser.
- 21 White flat polycarbonate diffuser.
- 32 White oversize trim ring. Specify O.D.
- 45 Gasket between ceiling and trim flange.

- 46 Gasket between trim and lens.
- 94 Custom color/finish. Specify. Consult factory.
- FR Fresnel tempered glass lens.
- UV UV filter. Consult factory.

Other

- 99 Special modification. Consult factory.
- AT Air tight with Type IC. Meets / exceeds ASTM E283 restricted airflow of 2 CFM maximum.
- FS Additional in-line fuse. Not available with Option -98 (347V).
- LE With 4-pin electronic lamp. 3500°K standard. 82 CRI and 12,000 hour life. Specify wattage, style and color temperature.

¹ Visit www.kirlinlighting.com for most current performance / specifications.

SUBMITTAL DATA

JOB NAME

TYPE

WATTAGE

VOLTAGE

CATALOG NUMBER

APPROVAL STAMP

LIMITED WARRANTY: CATALOGED KIRLIN FIXTURES ARE WARRANTED FREE OF DEFECTS IN WORKMANSHIP OR MATERIAL FOR THREE YEARS FROM DATE OF PURCHASE. INSTALLATION TO N.E.C. IN NORMAL USE. Manufacturer at the option will replace or repair such fixture or refund the purchase price on presentation of proof of purchase and defective fixture at the offices of manufacturer within three years of original shipment. Liability of manufacturer is limited to the foregoing, and manufacturer shall not be liable for any other damages, direct or indirect, sustained or suffered by purchaser or any person. This warranty is supplied to the buyer in place of all other warranties, expressed or implied. Seller does not warrant as to merchantability or fitness for a particular use, nor will any oral statement constitute a warranty or amend this specific warranty. Abnormal use, abuse of the fixture, improper installation, or repair, or modification of the fixture without prior written authorization from the manufacturer will render the warranty void.