

CATALOG #	TYPE	
JOB NAME	WATTAGE	VOLTAGE

5" 1 Triple 32 WATT MAXIMUM

FRR-05032

Type IC Lensed "Dead Front"
Downlight Ideal for Showers

THIS PRODUCT IS NO LONGER AVAILABLE

Features

Lamp

• Designed for one 4-pin triple tube amalgam compact fluorescent lamp: 32/26W triple.

Ballast: Multi-Wattage/Voltage

- Installed electronic high power factor ballast, normally protected. For lower wattages: Optimize ballast.
- 120-277 multi-volt; 50/60 Hz. THD < 10%.
- ClickQuick connectors for easy service.
- Cold weather rating: -22°F (-30°C).
- End of lamp life protection circuit. RFI filter.
- Internally fused. Also see Option -FS.

Reflector

- Specular Alzak® aluminum.

Trim Assembly

- Electrically non-conducting "dead-front"
- Rustproof.
- Double gasketed. White polycarbonate trim with radial clear polycarbonate lens.

Aluminum Housing

- Acrylic enamel. Rustproof. Exceeds 1000-hour ASTM 9% salt spray test.

- Lightweight: Minimizes ceiling load.
- Cool operation: Extends component life.
- Entire luminaires are constructed with high quality, Best-in-class materials.
- All trim designs meet Option -AT.
- Gasketed.
- Prewired 14 GA (NEC) galvanized steel, UL listed. 1/2" and 3/4" knockouts.

Installation

- 27" galvanized hanger bars with adjustable mounting brackets (2) supplied.
- Use as ceiling or recessed if you have ceiling locations.

UL, C-UL (Canada) Listings

- Type of luminaire depends on the type of trim assembly. Approval of the listing agency is required.
- Through-branch conductors (6 #12).

Three Year Limited Warranty

- Replace standard recessed ballast.

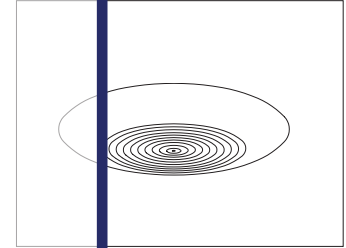

Recessed Round Poly Lens "Dead Front" Type IC

Please consult **QUOTATIONS**

for the best alternative.

Selected Optional Trims:

- Drop Poly Option -76
- Convex Poly Option -CV

Performance at a Glance

FRR-05032

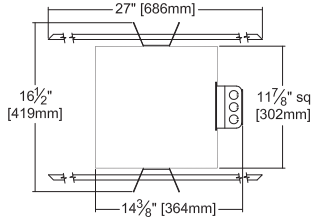
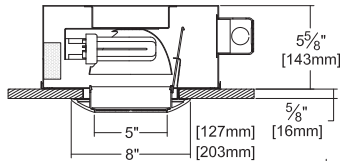

Ceiling Cut-out
6 1/2" Dia.

Cone of Light Key

- Ft. Distance from fixture
- FC Footcandles at nadir (0°)
- Dia. Circle of light at 50% of FC
- Dia. (in ft.) shown is where FC value is half the FC at nadir.

FRR-05032 (1 Triple 32W)

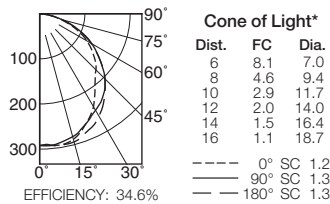

FRR-05032-76 (1 Triple 32W)

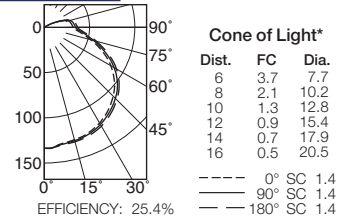

FRR-05032-CV (1 Triple 32W)

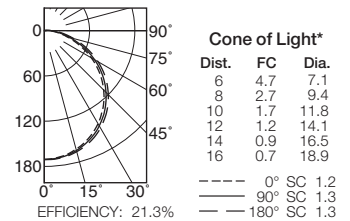

THE KIRLIN COMPANY

3401 EAST JEFFERSON AVENUE • DETROIT, MICHIGAN 48207-4232
(313) 259-6400 • Fax: (313) 259-9409 OR (313) 259-3121 • www.kirlinlighting.com

RENAISSANCE SERIES
COMPACT FLUORESCENT LIGHTING

MAXIMUM WATTAGE

1 Triple 32

CATALOG NUMBER

FRR-05032

DUE TO OUR CONTINUING EFFORT TO IMPROVE PRODUCTS, TECHNICAL INFORMATION IS SUBJECT TO CHANGE WITHOUT NOTICE.

Alzak® is a registered trademark of ALCOA.

Detailed Photometry - Installed Fixture

Photometry from I.T.L., Boulder, CO

FRR-05032 (1 Triple 32 - Radial Clear Poly)

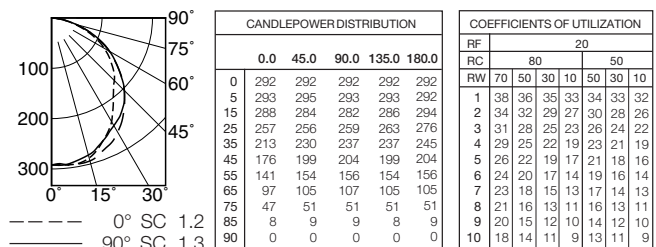

ITL TEST #45415 *LER=20.5 •AEC=\$11.69
EFFICIENCY : 34.6%

FRR-05032 (1 Triple 26 - Radial Clear Poly)

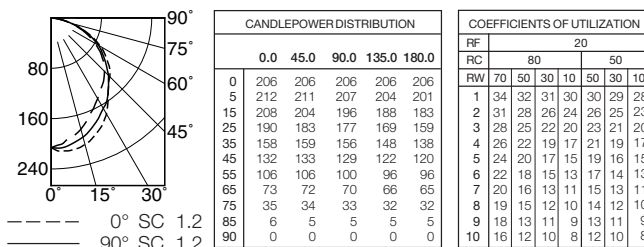

ITL TEST #55112 *LER=19.7 •AEC=\$12.19
EFFICIENCY : 31.0%

FRR-05032-76 (1 Triple 32 - Drop White Poly)

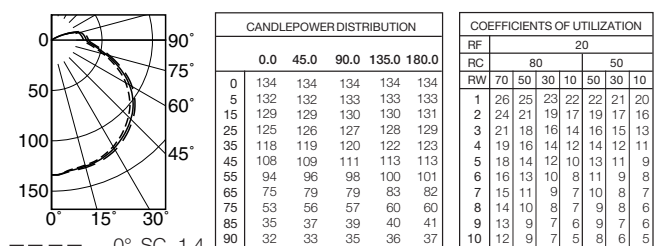

ITL TEST #45416 *LER=15.1 •AEC=\$15.88
EFFICIENCY : 25.4%

FRR-05032-CV (1 Triple 32 - Convex White Poly)

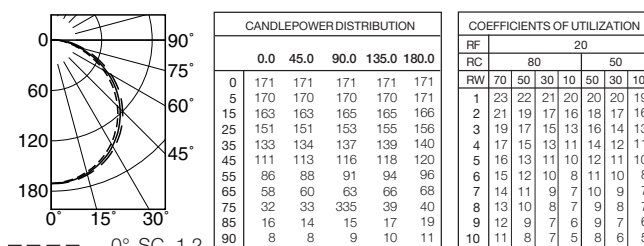

ITL TEST #45418 *LER=12.7 •AEC=\$18.88
EFFICIENCY : 21.3%

* LER = Luminaire Efficiency Rating

LER = Luminaire Effic. x Total Lamp Lumens x Ballast Factor / Input Watts

• AEC = Annual Energy Cost per 1000 lumens (based on 3000 hours use @ \$0.08 KWH).

Options

Ballast, Wattage and Voltage

- 39 Installed electronic dimming ballast. Not Type IC listed. Indoor use. 10°C (50°F) minimum start. Specify wattage, voltage and brand.
- 43 Lower wattage: for either 4-pin electronic 18W triple/quad or 13W quad (only). Specify wattage.
- 97 Specify other voltage. Consult factory.
- 98 347 volt, 50/60 Hz. input. Consult factory.

Emergency Ballast - Specify Voltage¹

Internal (factory installed) ballast, test switch and indicator light. Suitable for damp locations from 0° to 50°C (32° to 122°F) or with Cold Weather

- version (see -CE) -20° to 55°C (-4° to 131°F).
- 73 Internal 1-lamp EM ballast. Specify voltage.
- CE Internal cold weather (-20° to 55°C) 1-lamp EM ballast. Specify voltage.
- HE¹ Internal higher lumen (up to 1250) 1-lamp EM ballast. 13-42W only. Specify voltage.

Lenses and Trims

- 32 White oversize trim ring. Specify O.D.
- 76 Drop white polycarbonate diffuser in white polycarbonate trim.
- 79 Extension collar for ceilings up to 2" thick.
- 94 Custom color/finish. Specify. Consult factory.
- CV Convex white polycarbonate diffuser in white polycarbonate trim.

Other

- 99 Special modification. Consult factory.
- AT Air tight with Type IC. Meets / exceeds ASTM E283 restricted airflow of 2 CFM maximum.
- FS Additional in-line fuse. Not available with Option -98 (347V).
- LE With 4-pin electronic lamp. 3500°K standard. 82 CRI and 12,000 hour life. Specify wattage, style and color temperature.



¹ Visit www.kirlinlighting.com for most current performance / specifications.

SUBMITTAL DATA

JOB NAME _____
TYPE _____
WATTAGE _____ VOLTAGE _____
CATALOG NUMBER _____

APPROVAL STAMP

² See GRR-05032 specification sheet or "Gazelle Express Program" brochure for complete details. Limited option availability.

LIMITED WARRANTY: CATALOGED KIRLIN FIXTURES ARE WARRANTED FREE OF DEFECTS IN WORKMANSHIP OR MATERIAL FOR THREE YEARS FROM DATE OF PURCHASE. INSTALLLED TO N.E.C. IN NORMAL USE. Manufacturer at the option will replace or repair such fixture or refund the purchase price or presentation of proof of purchase and defective fixture at the option of manufacturer within three years of original shipment. Liability of manufacturer is limited to the foregoing, and manufacturer shall not be liable for any other damages, direct or indirect, sustained or suffered by purchaser or any person. This warranty is supplied to the buyer in place of all other warranties, expressed or implied. Seller does not warrant as to merchantability or fitness for a particular use, nor will any oral statement constitute a warranty or amend this specific warranty. Abnormal use, abuse of the fixture, improper installation, or repair, or modification of the fixture without prior written authorization from the manufacturer will render the warranty void.