

CATALOG #	TYPE	
JOB NAME	WATTAGE	VOLTAGE

8" 1 ED17 150 WATT MAXIMUM

VRR-08047

Vandal Resistant Efficient 8" Pulse Start Metal Halide

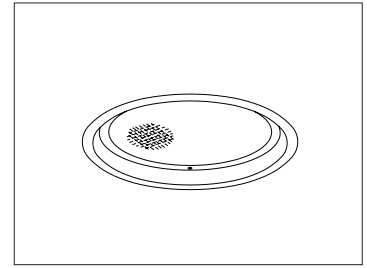

Specifications

Lamp

- Designed for pulse start metal halide lamp: 150W medium base ED17.
- See Option -43 for lower wattages.

Socket

- Medium base. Pulse rated.
- Glazed porcelain. Silicone leads.

Reflector

- Specular ellipsoidal Alzak® aluminum.

Trim / Lens Assembly

- Vandal resistant smooth white seamless tapered aluminum self-flanged trim or see Option -OG.
- Flush center pin tamperproof hex screws and captive nuts secure trim to housing.
- Lens: UV absorbing tempered prismatic C#73 above 1/4" clear tempered glass.
- Continuous ring secures lens to trim.
- Tamperproof tool included.

Ballast Assembly: Specify Voltage

- WhisperPack™ fully encapsulated 180°C rated HPF pulse start ballast.
- Class H, high reactance for 120 volt and Options -65, -66; linear reactor for 277 volt.
- See Option -PR for conventional probe start.
- Capacitor and ignitor supplied.
- Dimming (-39) and electronic (-96) ballasts available. See Options.
- Cool, quiet, long-life. Silicone leads.
- Visible and easily serviced in all ceilings.

Fuse

- Fused primary. Renewable. Aids servicing.

Aluminum Housing

- Acrylic enameled. Rustproof: Exceeds 1000 hour ASTM 5% salt spray test.
- Lightweight: Minimizes ceiling load.
- Cool operation: Extends component life.
- Entire luminaire serviced through aperture.
- Built-in plaster frame.

Outlet Box

- Prewired 14 GA (NEC) galvanized steel, UL listed. 1/2" and 3/4" knockouts.

Installation

- 27" galvanized hanger bars with adjustable mounting brackets (2) supplied.
- Recesses indoor or outdoor in covered locations.

UL, C-UL (Canada) Listings

- Wet, damp or dry locations, covered ceilings.
- Through-branch conductors (6 #12 AWG 90°C).

Three Year Limited Warranty

- Complete standard fixture and ballast.

Thermal Protection

- Per current NEC.

Performance at a Glance

VRR-08047

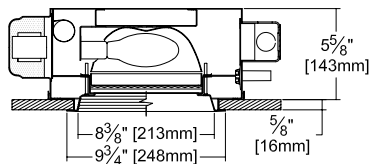

Option -OG Also Shown

Cone of Light Key

- Ft. Distance from fixture
- FC Footcandles at nadir (0°)
- Dia. Circle of light at 50% of FC

* Dia. (in ft.) shown is where FC value is half the FC at nadir.



Exceptional
Energy
Efficiency

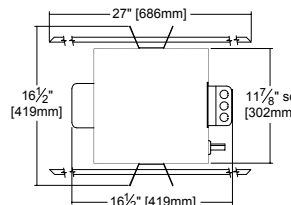

Ceiling Cut-out
9" Dia.

VRR-08047 (150W Coated Lamp)

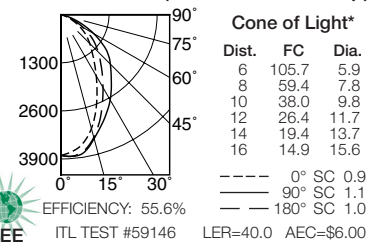

VRR-08047-43 (100W Coated Lamp)

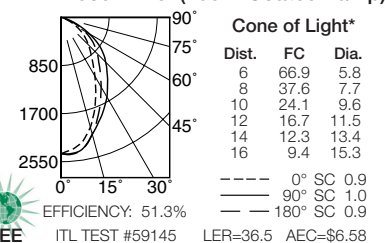

THE KIRLIN COMPANY

3401 EAST JEFFERSON AVENUE • DETROIT, MICHIGAN 48207-4232
(313) 259-6400 • Fax: (313) 259-9409 OR (313) 259-3121 • www.kirlinlighting.com

ENERGY EFFICIENT VANDAL RESISTANT
& MAXIMUM SECURITY LIGHTING

MAXIMUM WATTAGE

ED17 150

CATALOG NUMBER

VRR-08047

DUE TO OUR CONTINUING EFFORT TO IMPROVE PRODUCTS, TECHNICAL INFORMATION IS SUBJECT TO CHANGE WITHOUT NOTICE.

Alzak® is a registered trademark of ALCOA.

Detailed Photometry - Installed Fixture

Photometry from I.T.L., Boulder, CO

VRR-08047 (ED17 150 Coated Lamp)

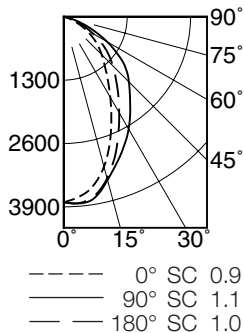

EFFICIENCY : 55.6%

CANDLEPOWER DISTRIBUTION					
	0.0	45.0	90.0	135.0	180.0
0	3804	3804	3804	3804	3804
5	3701	3757	3841	3848	3833
15	3185	3282	3467	3481	3431
25	2309	2549	2923	2784	2649
35	1572	1922	2376	2142	1947
45	1100	1453	1887	1657	1424
55	706	992	1362	1150	952
65	305	466	685	554	449
75	48	93	161	117	83
85	0	0	0	0	0
90	0	0	0	0	0

COEFFICIENTS OF UTILIZATION							
RF	20						
RC	80			50			
RW	70	50	30	10	50	30	10
1	62	60	58	56	56	55	53
2	57	53	50	47	50	48	46
3	53	48	44	41	45	42	40
4	49	43	39	35	41	37	35
5	45	39	34	31	37	33	31
6	42	35	31	28	34	30	27
7	39	32	28	25	31	27	25
8	37	30	25	22	29	25	22
9	34	28	23	20	27	23	20
10	32	26	22	19	25	21	19

ITL TEST #59146 *LER=40.0 •AEC=\$6.00

VRR-08047-43 (ED17 100 Coated Lamp)

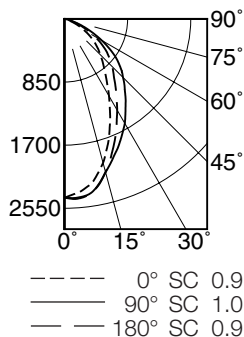

EFFICIENCY : 51.3%

CANDLEPOWER DISTRIBUTION					
	0.0	45.0	90.0	135.0	180.0
0	2407	2407	2407	2407	2407
5	2339	2368	2409	2423	2423
15	2007	2056	2137	2176	2136
25	1455	1587	1791	1728	1650
35	982	1182	1434	1311	1213
45	678	870	1115	986	911
55	440	574	788	664	630
65	187	256	382	314	303
75	27	48	86	63	56
85	0	0	0	0	0
90	0	0	0	0	0

COEFFICIENTS OF UTILIZATION							
RF	20						
RC	80			50			
RW	70	50	30	10	50	30	10
1	57	55	53	52	52	51	49
2	53	49	46	44	47	44	43
3	49	44	41	38	42	39	37
4	45	40	36	33	38	35	32
5	42	36	32	29	35	31	29
6	39	33	29	26	32	28	26
7	36	30	26	23	29	26	23
8	34	28	24	21	27	23	21
9	32	26	22	19	25	21	19
10	30	24	20	18	23	20	18

ITL TEST #59145 *LER=36.5 •AEC=\$6.58

* LER = Luminaire Efficiency Rating
LER = Luminaire Effic. x Total Lamp Lumens x Ballast Factor
Input Watts

• AEC = Annual Energy Cost per 1000 lumens
(based on 3000 hours use @ \$0.08 kWh).

Options

Sources and Ballasts

- 24 HPS ballast instead. Specify wattage, voltage.
- 39 Electronic dimming ballast instead, for pulse start metal halide. Consult factory for wattage and voltage availability.
- 96 Regulating electronic MH ballast instead.

Wattage and Voltage

- 43 Lower wattage: 50-125 pulse, 35-100 HPS; Specify voltage.
- 120 120 volt, 60 Hz. ballast.
- 277 277 volt, 60 Hz. ballast.
- 347 347 volt, 60 Hz. ballast. Consult factory for dimming or electronic.

-97 Other voltage ballast instead. Consult factory.

Relays, Standbys, Lamps

- 49 Extra circuit DCB socket. 100W max. Do not energize simultaneously with main source. Also see Option -LS.
- 65 Electronic standby system and DCB socket. 100W max. Provides immediate light until HID restrikes. Also see Options -66 and -LS.
- 66 Electronic time delay standby system and DCB socket. 100W max. Provides light until HID reaches 70% output. Also see -LS.
- LP With lamp. Specify source, wattage, color temperature, and clear or coated. (3700°K standard for metal halide)

-LS With T-4 DCB tungsten halogen standby lamp. 100W max. Use only with -49, -65, -66.

Lenses and Trims

- 32 White oversize trim ring. Specify O.D.
- 45 Gasket between trim and ceiling.
- 46 Gasket between trim and lens.
- 94 Custom color trim assembly. Consult factory.
- OG Black OptiGroove flare trim instead. (CP x .95)

Other

- 79 Extension collar for up to 2" thick ceilings.
- 99 Special modification. Consult factory.

SUBMITTAL DATA

JOB NAME _____
 TYPE _____
 WATTAGE _____ VOLTAGE _____
 CATALOG NUMBER _____

APPROVAL STAMP

LIMITED WARRANTY: CATALOGED KIRLIN FIXTURES ARE WARRANTED FREE OF DEFECTS IN WORKMANSHIP OR MATERIAL FOR THREE YEARS FROM DATE OF PURCHASE. INSTALL TO N.E.C. IN NORMAL USE. Manufacturer at the option will replace or repair such fixture or refund the purchase price on presentation of proof of purchase and defective fixture at the office of manufacturer within three years of original shipment. Liability of manufacturer is limited to the foregoing, and manufacturer shall not be liable for any other damages, direct or indirect, sustained or suffered by purchaser or any person. This warranty is subject to the buyer in place of all other warranties, expressed or implied. Seller does not warrant as to merchantability or fitness for a particular use, nor will any oral statement constitute a warranty or amend this specific warranty. Abnormal use, abuse of the fixture, improper installation, or repair or modification of the fixture without prior written authorization from the manufacturer will render the warranty void.