

CATALOG #	TYPE	
JOB NAME	WATTAGE	VOLTAGE

7" 1 Triple 32 WATT MAXIMUM Type IC - VRR-07012

Vandal Resistant "IP65 Rated" Sealed & Gasketed Small Aperture

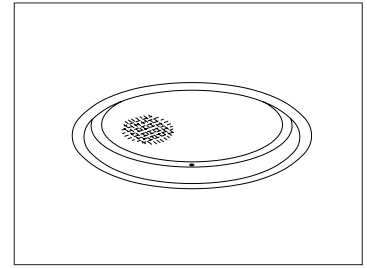

Specifications

Lamp

- Designed for one 4-pin triple tube amalgam or quad compact fluorescent lamp: 32/26W triple.

Ballast: Multi-Wattage/Voltage

- Installed electronic high power factor, thermally protected. For lower wattages: Option -43.
- 120-277 multi-volt; 50-60 Hz. THD <10%.
- ClickQuick connectors for easy service.
- Cold weather -22°F (-30°C).
- End of lamp life protection circuit. RFI filter.
- Internally fused. Also see Option -FS.

Reflector

- Specular Alzak® aluminum.

Trim / Lens Assembly

- Vandal resistant smooth white seamless tapered aluminum self-flanged flare trim or see Option -OG.
- Flush center pin tamperproof hex screws (2) with captive nuts secure trim to housing.
- 3/16" prismatic high strength acrylic lens

above 1/4" clear polycarbonate. Continuous ring secures lens to trim.

- Tamperproof tool included.

5X Sealed and Gasketed

- (1) Silicone seal between trim and lens seals lens to trim, (2) closed cell gasketing between trim and housing flange seals trim to housing, (3) closed cell gasketing on trim flange seals flange to ceiling (4) closed cell gasketing on bottom pan seals housing to ceiling and (5) neoprene O-rings on stainless steel fasteners seal fasteners to trim.

Aluminum Housing

- Acrylic enameled. Rustproof: Exceeds 1000 hour ASTM 5% salt spray test.
- Built-in plaster frame
- Lightweight: Minimizes ceiling load.
- Cool operation: Extends component life.
- Entire luminaire serviced through aperture.
- Air Tight design. Meets / exceeds ASTM E283 restricted airflow of 2 CFM maximum.

Outlet Box

- Prewired 14 GA (NEC) galvanized steel, UL listed. 1/2" and 3/4" knockouts.



Installation

- 27" galvanized hanger bars with adjustable mounting brackets (2) supplied.
- Recesses indoor or outdoor in covered locations.

UL, C-UL (Canada) Listings

- Wet, damp or dry locations, covered ceilings.
- Through-branch conductors (6 #12 AWG 90°C).
- Type IC. Approved for direct contact with insulation.

Three Year Limited Warranty

- Complete standard fixture and ballast.

Performance at a Glance

VRR-07012: Type IC

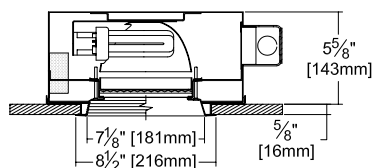

Option -OG Also Shown

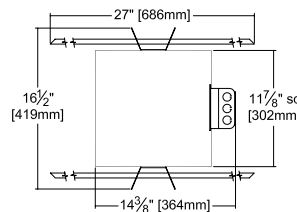

Ceiling Cut-out
8" Dia.

Cone of Light Key
Ft. Distance from fixture
FC Footcandles at nadir (0°)
Dia. Circle of light at 50% of FC

* Dia. (in ft.) shown is where FC value is half the FC at nadir.

VRR-07012 (1 Triple 32W)

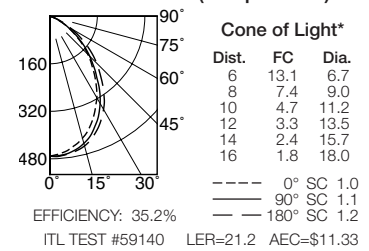

VRR-07012 (1 Triple 26W)

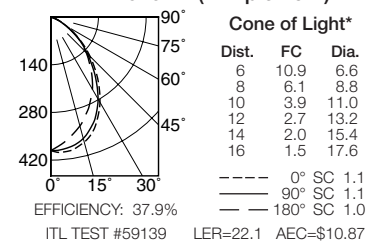

THE KIRLIN COMPANY

3401 EAST JEFFERSON AVENUE • DETROIT, MICHIGAN 48207-4232
 (313) 259-6400 • Fax: (313) 259-9409 OR (313) 259-3121 • www.kirlinlighting.com

**ENERGY EFFICIENT VANDAL RESISTANT
& MAXIMUM SECURITY LIGHTING**

MAXIMUM WATTAGE

1 Triple 32

CATALOG NUMBER

VRR-07012

DUE TO OUR CONTINUING EFFORT TO IMPROVE PRODUCTS, TECHNICAL INFORMATION IS SUBJECT TO CHANGE WITHOUT NOTICE.

Alzak® is a registered trademark of ALCOA.

Detailed Photometry - Installed Fixture

Photometry from I.T.L., Boulder, CO

VRR-07012 (1 Triple 32)

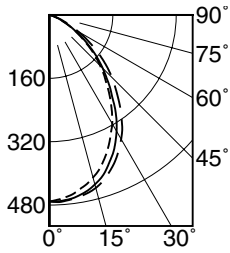

--- 0° SC 1.0
 — 90° SC 1.1
 — 180° SC 1.2

EFFICIENCY : 35.2%

CANDLEPOWER DISTRIBUTION					
	0.0	45.0	90.0	135.0	180.0
0	471	471	471	471	471
5	462	465	469	471	471
15	425	435	443	449	452
25	357	381	382	400	399
35	270	296	289	313	317
45	181	200	190	211	223
55	98	108	103	113	128
65	35	41	37	42	47
75	6	7	6	6	6
85	0	0	0	0	0
90	0	0	0	0	0

COEFFICIENTS OF UTILIZATION							
RF	20						
RC	80			50			
RW	70	50	30	10	50	30	10
1	39	38	37	36	36	35	34
2	37	34	32	31	32	31	30
3	34	31	29	27	29	28	26
4	31	28	25	23	27	25	23
5	29	25	23	21	24	22	20
6	27	23	20	19	22	20	18
7	25	21	19	17	21	18	17
8	24	20	17	15	19	17	15
9	22	18	16	14	18	15	14
10	21	17	14	13	16	14	13

ITL TEST #59140 *LER=21.2 •AEC=\$11.33

VRR-07012 (1 Triple 26)

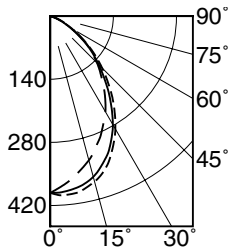

--- 0° SC 1.1
 — 90° SC 1.1
 — 180° SC 1.0

EFFICIENCY : 37.9%

CANDLEPOWER DISTRIBUTION					
	0.0	45.0	90.0	135.0	180.0
0	392	392	392	392	392
5	398	397	390	379	374
15	380	381	369	344	331
25	326	339	315	298	274
35	247	263	234	231	211
45	163	175	152	158	147
55	86	93	81	87	86
65	30	35	29	34	34
75	4	5	4	5	5
85	0	0	0	0	0
90	0	0	0	0	0

COEFFICIENTS OF UTILIZATION							
RF	20						
RC	80			50			
RW	70	50	30	10	50	30	10
1	42	41	40	39	38	38	37
2	39	37	35	33	35	33	32
3	36	33	31	29	32	30	28
4	34	30	27	25	29	27	25
5	32	27	25	22	26	24	22
6	29	25	22	20	24	22	20
7	27	23	20	18	22	20	18
8	26	21	18	16	20	18	16
9	24	20	17	15	19	17	15
10	23	18	16	14	18	15	14

ITL TEST #59139 *LER=22.1 •AEC=\$10.87

* LER = Luminaire Efficiency Rating
 LER = Luminaire Effic. x Total Lamp Lumens x Ballast Factor
 Input Watts

• AEC = Annual Energy Cost per 1000 lumens
 (based on 3000 hours use @ \$0.08 kWh).

Options

Ballast, Wattage and Voltage

- 39 Installed electronic dimming ballast. Not Type IC listed. Indoor use. 10°C (50°F) minimum start. Specify wattage, voltage and brand.
- 43 Lower wattage: for 4-pin 18W triple or 18-13W quad. Specify wattage.
- 97 Specify other voltage. Consult factory.
- 98 347 volt, 50/60 Hz. input. Consult factory.

Emergency Ballast - Specify Voltage¹

- Internal (factory installed) ballast, test switch and indicator light. Suitable for damp locations from 0° to 50°C (32° to 122°F) or with Cold Weather version (see -CE) -20° to 55°C (-4° to 131°F).
- 73 Internal EM ballast. Specify voltage.
- CE Internal cold weather (-20° to 55°C) EM ballast. Specify voltage.
- HE¹ Internal higher lumen (up to 1250) EM ballast. 13-32W only. Specify voltage.

Lenses and Trims

- 94 Custom color/finish. Specify. Consult factory.
- CF High temperature color filter. Specify color.
- OG Black OptiGroove flare trim. (CP x .95)
- UV UV filter. Consult factory.

Other

- 99 Special modification. Consult factory.
- FS Additional in-line fuse. Not available with Option -98(347V).
- LE With 4-pin electronic lamp. 3500°K standard. 82 CRI and 12,000 hour life. Specify wattage, style and color temperature.

¹ Visit www.kirlinlighting.com for most current performance / specifications.

SUBMITTAL DATA

JOB NAME _____
 TYPE _____
 WATTAGE _____ VOLTAGE _____
 CATALOG NUMBER _____

APPROVAL STAMP

LIMITED WARRANTY: CATALOGED KIRLIN FIXTURES ARE WARRANTED FREE OF DEFECTS IN WORKMANSHIP OR MATERIAL FOR THREE YEARS FROM DATE OF PURCHASE. INSTALL TO N.E.C. IN NORMAL USE. Manufacturer of the fixture will replace or repair such fixture or refund the purchase price on presentation of proof of purchase and defective fixture at the offices of manufacturer within three years of original shipment. Liability of manufacturer is limited to the foregoing and manufacturer shall not be liable for any other damages, direct or indirect, sustained or suffered by purchaser or any person. This warranty is supplied in place of all other warranties, expressed or implied. Seller does not warrant as to merchantability or fitness for a particular use, nor will any oral statement constitute a warranty or amend the specific warranty. Abnormal use, abuse of the fixture, improper installation, or repair, or modification of the fixture without prior written authorization from the manufacturer will render the warranty void.