

CATALOG #	TYPE	
JOB NAME	WATTAGE	VOLTAGE

8" x 1' 1 Triple 57 WATT MAXIMUM

VCT-08034

Maximum Security High Efficiency 1' Cornice Mount

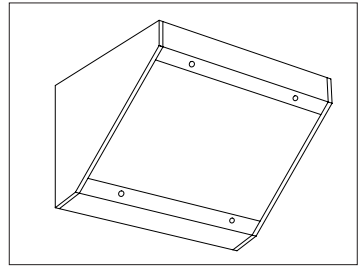

Specifications

Lamp

- Designed for compact fluorescent lamp(s): one 57W triple/four tube.

Ballast

- Installed electronic high power factor, thermally protected, RFI filter. For lower wattages, see Option -43.
- 120-277 multi-volt; 50-60 Hz. THD <10%. End of lamp life protection circuit.
- Internally fused. Also see Options -FS, -FD.
- Dimming optional. See Option -39.

Reflector

- Full size die formed specular Alzak® aluminum.
- Removable for servicing.

Lens

- Prismatic 3/16" high strength acrylic above 1/4" clear polycarbonate.
- Continuous extruded 6063-T6 tempered aluminum, non-removable lens clamps; four

or eight flush mounted center pin tamperproof screws with captive nuts.

- Tamperproof tool included.

Aluminum Housing

- Super strong 6063-T6 extruded and tempered.
- White polyester enamel finish.
- Rustproof: Exceeds 1000 hour ASTM 5% salt spray test.
- Entire luminaire serviced through aperture.

Installation

- Secure with 3/8" lag or molly bolts to ceiling and/or wall structure.
- Two 7/8" diameter access holes (ceiling and wall) with four 1/2" diameter mounting holes.
- Installs indoor or outdoor on all corners, horizontal (ceiling-wall) or vertical (wall-wall), in covered locations.

UL, C-UL (Canada) Listings

- Wet, damp or dry locations, covered ceilings.

Three Year Limited Warranty

- Complete standard fixture and ballast.



**Exceptional
Energy
Efficiency**

Performance at a Glance

VCT-08034

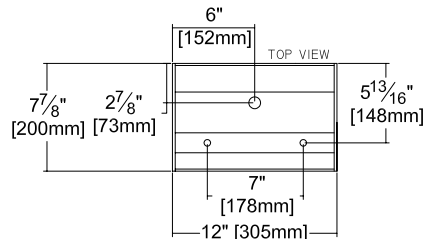
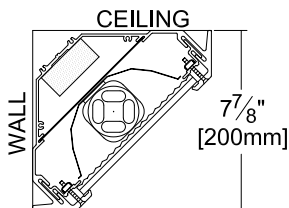

VCT-08034
(1 Triple 57W)

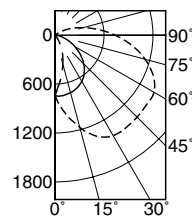

--- 0° SC 2.4
--- 90° SC 1.3
--- 180° SC 0.5



EFFICIENCY: 77.4%
ITL TEST #58939
LER=50.5 AEC=\$4.75

VCT-08034-43
(1 Triple 42W)

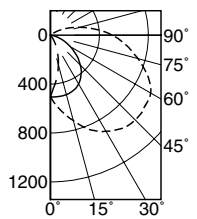

--- 0° SC 2.4
--- 90° SC 1.3
--- 180° SC 0.5



EFFICIENCY: 70.9%
ITL TEST #58938
LER=46.0 AEC=\$5.22

THE KIRLIN COMPANY

3401 EAST JEFFERSON AVENUE • DETROIT, MICHIGAN 48207-4232
(313) 259-6400 • Fax: (313) 259-9409 OR (313) 259-3121 • www.kirlinlighting.com

**ENERGY EFFICIENT VANDAL RESISTANT
& MAXIMUM SECURITY LIGHTING**

MAXIMUM WATTAGE

1 Triple 57

CATALOG NUMBER

VCT-08034

DUE TO OUR CONTINUING EFFORT TO IMPROVE PRODUCTS, TECHNICAL INFORMATION IS SUBJECT TO CHANGE WITHOUT NOTICE.

Alzak® is a registered trademark of ALCOA.

Detailed Photometry - Installed Fixture

Photometry from I.T.L., Boulder, CO

VCT-08034 (1 Triple 57)

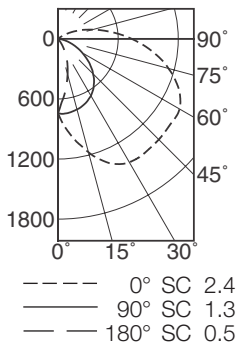

EFFICIENCY : 77.4%

CANDLEPOWER DISTRIBUTION					
	0.0	45.0	90.0	135.0	180.0
0	742	742	742	742	742
10	1038	954	742	550	475
30	1422	1197	656	237	114
50	1413	1079	425	15	0
70	1254	822	147	0	0
90	736	474	0	0	0
110	263	123	0	0	0
130	11	0	0	0	0
150	0	0	0	0	0
170	0	0	0	0	0
180	0	0	0	0	0

COEFFICIENTS OF UTILIZATION							
RF	20						
RC	80			50			
RW	70	50	30	10	50	30	10
1	80	75	71	67	68	64	61
2	71	64	58	52	58	53	49
3	65	55	48	42	50	44	40
4	59	48	41	35	44	38	33
5	54	43	35	30	39	33	28
6	50	38	31	26	35	29	24
7	46	35	28	22	32	26	21
8	43	32	25	20	29	23	19
9	40	29	22	18	27	21	17
10	37	27	20	16	25	19	15

ITL TEST #58939 *LER=50.5 •AEC=\$4.75

VCT-08034-43 (1 Triple 42)

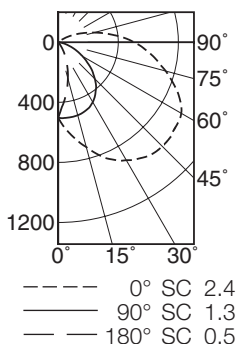

EFFICIENCY : 70.9%

CANDLEPOWER DISTRIBUTION					
	0.0	45.0	90.0	135.0	180.0
0	502	502	502	502	502
10	652	618	506	384	327
30	907	806	460	158	73
50	978	822	296	11	0
70	819	624	93	0	0
90	505	341	0	0	0
110	178	85	0	0	0
130	9	0	0	0	0
150	0	0	0	0	0
170	0	0	0	0	0
180	0	0	0	0	0

COEFFICIENTS OF UTILIZATION							
RF	20						
RC	80			50			
RW	70	50	30	10	50	30	10
1	73	69	65	61	62	59	56
2	65	58	53	48	53	48	44
3	59	50	44	38	45	40	36
4	54	44	37	32	40	34	30
5	49	39	32	27	35	30	26
6	45	35	28	23	32	26	22
7	42	32	25	20	29	23	19
8	39	29	22	18	26	21	17
9	36	26	20	16	24	19	15
10	34	24	18	14	22	17	14

ITL TEST #58938 *LER=46.0 •AEC=\$5.22

* LER = Luminaire Efficiency Rating
 LER = Luminaire Effic. x Total Lamp Lumens x Ballast Factor
 Input Watts

• AEC = Annual Energy Cost per 1000 lumens
 (based on 3000 hours use @ \$0.08 kWh).

Options

Ballast, Wattage and Voltage

- 39 Installed electronic dimming ballast. Indoor use. 10°C (50°F) minimum start. Specify wattage, voltage and brand. Not available with Option -75, -CR or -HR.
- 43 Lower wattage. 42/32/26W triple or 26W quad (multi-wattage/voltage). Specify wattage.
- 97 Specify other voltage. Consult factory.
- 98 347 volt, 50/60 Hz. input. Consult factory.

Emergency Ballast¹

- Remote (field mounted) ballast, test switch and indicator light. Suitable for damp locations from 0° to 50°C (32° to 122°F) or with Cold Weather version (see -CR) -20° to 55°C (-4° to 131°F).
- 75 Remote 1-lamp EM ballast.
- CR Remote cold weather (-20° to 55°C) 1-lamp EM ballast.
- HR¹ Remote higher lumen (up to 1250) 1-lamp EM ballast. 13-42W only.

Housing

- 94 Custom color/finish. Specify. Consult factory.

Other

- 99 Special modification. Consult factory.
- FS Additional in-line fuse. Not available with Option -98(347V).
- LE With 4-pin electronic lamp. 3500°K standard. 82 CRI and 12,000 hour life. Specify wattage, style and color temperature.

¹ Visit www.kirlinlighting.com for most current performance / specifications.

SUBMITTAL DATA

APPROVAL STAMP

JOB NAME
 TYPE
 WATTAGE VOLTAGE
 CATALOG NUMBER

LIMITED WARRANTY: CATALOGED KIRLIN FIXTURES ARE WARRANTED FREE OF DEFECTS IN WORKMANSHIP OR MATERIAL FOR THREE YEARS FROM DATE OF PURCHASE. INSTALL TO N.E.C. IN NORMAL USE. Manufacturer of the option will replace or repair such fixture or refund the purchase price on presentation of proof of purchase and defective fixture at the offices of manufacturer within three years of original shipment. Liability of manufacturer is limited to the foregoing and manufacturer shall not be liable for any other damages, direct or indirect, sustained or suffered by purchaser or any person. This warranty is supplied to the buyer in place of all other warranties, expressed or implied. Seller does not warrant as to merchantability or fitness for a particular use, nor will any oral statement constitute a warranty or amend the specific warranty. Abnormal use, abuse of the fixture, improper installation, or repair, or modification of the fixture without prior written authorization from the manufacturer will render the warranty void.