

CATALOG #	TYPE	
JOB NAME	WATTAGE	VOLTAGE

Symphony Remote Driver Series

Lensed Wall Wash 4" Square • LED

Up to 60,000 Hour Life (L70) • Type IC • Wet Location

LM-80 Qualified • LM-79 Certified Photometry

SRS-04652



Specifications

Delivered System Performance

- Lumen Series: **Must Specify**
- 2500L: 2500 nominal lumens (35W)
- Color temperature: 3500°K standard; Optional: -27K, -30K, -41K or -50K
- CRI: 80+ standard; Optional: -HC (90+)
- 60,000 hour life (L70)
- Fully sustainable: removable for servicing
- Center beam optics positioned at 25°

Thermal Management System

- All aluminum heat sink, components and housing maximize cool operation and long life while minimizing maintenance

Remote Power Supply Required

- For 0-10V use **SYM-CABNT**
- For DMX with RDM use **SYM-DMXPS**

SmartPower™ Battery Backup

- EMI-21220** for emergency power
- See specification sheet; order separately

Trim

- Clear specular aluminum trim
- Self-flanged, low glare angle-cut square; prismatic spread lens above
- Optional colors and finishes available

Acrylic Enameled Aluminum Housing

- Rustproof and corrosion resistant: Exceeds 1000 hour ASTM 5% salt spray test
- Shallow depth fits restricted plenums
- Cool operation: Extends life of all components
- Fully sustainable: Entire luminaire, including LED light engine, is modular, easily visible and serviced through aperture
- Built-in plaster flange

Outlet Box

- UL listed J-box with insulated removable cover; prewired 14 GA (NEC) with ½" and ¾" knockouts

Installation

- Requires minimum 16 AWG shielded twisted pair wire from SmartDMX™ to fixtures

• Maximum cable run from driver to fixture is 250'

- Recesses in ceilings up to 1½" thick
- Compatible with fire rated enclosures (by others)
- 27" galvanized hanger bars with adjustable mounting brackets (2) supplied

UL, C-UL (Canada) Listings

- Wet, damp or dry locations, covered ceilings
- Type IC: for direct contact with insulation

FCC Compliance

- FCC Part 15 certified for EMI/RFI emissions

FIVE YEAR Limited Warranty

- Complete standard fixture (must be used with SYM-CABNT or SYM-DMXPS)



Options and Ordering Configuration

(Example: SRS-04652-2500L-30K-94)

Must Specify		Optional		
Model	Lumens	Color Temp. (CCT)	Lens & Trim	Other Options
SRS-04652				
	-2500L	(Blank): 3500°K -27K: 2700°K instead -30K: 3000°K instead -41K: 4100°K instead -50K: 5000°K instead -HC: 90+ CRI instead	(Blank): Clear specular trim; lens above -30T: White enamel (complete trim) -30F: White enamel (flange only) -32: White oversize trim ring; specify O.D. -37F: Dark bronze enamel (flange only) -38F: Black enamel (flange only) -45: Gasket between trim flange and ceiling -70T: Clear semi-specular SofTex™ (complete trim) -94: Custom color/finish; specify; consult factory	(Blank): None -99: Special modification; consult factory -AT: Air tight version; meets ASTM E283 restricted airflow of 2 CFM maximum -RH: Residential mounting hardware instead; suitable for wood joist ceilings with spacing from 14 ½" to 25 ⅞" with ⅝" vertical adjustability

Dimensions

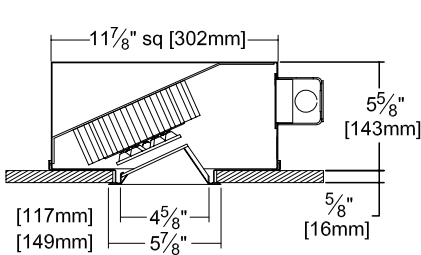

Ceiling
Cut-out
5 1/4" Sq.

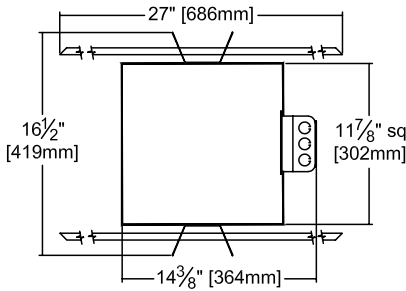

Photometry - Installed Complete Fixture

Photometry from UL Verification Services, Allentown, PA

LM-79 IESNA Certified Photometry from Independent Lab

-2500L STANDARD

Lumens: 2896
LPW: 79
Efficiency: 77.9%
UL Test: 1259209
EEE

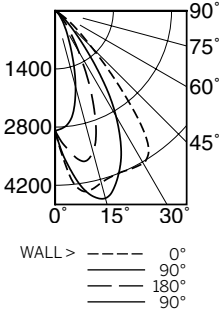

Total System Watts 36.8

	SINGLE FIXTURE				MULTIPLE FIXTURES					
	1'	2'	3'	4'	2' CENTERS	3' CENTERS	4' CENTERS	5' CENTERS	6' CENTERS	7' CENTERS
FIXTURE INSTALLED 2' FROM WALL										
Footcandle Distribution on Wall Surface										
1	9.8	5.6	1.9	1.2	0.8	18.4	18.5	18.5	14.0	9.1
2	110.0	40.8	8.1	2.2	1.0	131.0	132.0	132.0	116.0	39.1
3	175.0	116.0	19.7	4.4	1.6	219.0	219.0	219.0	186.0	104.0
4	96.1	89.0	33.0	7.4	2.4	169.0	169.0	169.0	113.0	127.0
5	55.0	52.6	32.5	10.5	3.3	130.0	130.0	130.0	78.1	94.9
6	34.6	33.8	26.0	11.8	4.2	98.3	98.4	98.4	60.2	69.6
7	23.6	23.5	19.9	11.1	4.8	77.0	77.2	77.1	48.5	52.9
8	17.3	17.4	15.7	10.1	5.1	63.7	63.8	63.8	41.2	42.7
9	14.1	14.1	13.2	9.3	5.3	55.8	56.0	55.9	36.5	37.3

LED manufacturers maintain a tolerance of +/-7% on flux (lumens) and power (electrical) measurements.

LIMITED WARRANTY: CATALOGED KIRLIN FIXTURES ARE WARRANTED FREE OF DEFECTS IN WORKMANSHIP OR MATERIAL FOR THE YEARS FROM DATE OF PURCHASE. INSTALLATION, E.G., IN NORMAL USE. Manufacturer at his option will replace or repair such fixture or refund the purchase price on presentation of proof of purchase and defective fixture at the offices of manufacturer within the years of original shipment. Liability of manufacturer is limited to the foregoing and manufacturer shall not be liable for any other damages, direct or indirect, sustained or suffered by purchaser or any person. This warranty is supplied to the buyer in place of all other warranties, expressed or implied. Seller does not warrant as to merchantability or fitness for a particular use, nor will any oral statement constitute a warranty or amend this specific warranty. Abnormal use, abuse of the fixture, improper installation or repair or modification of the fixture without prior written authorization from the manufacturer will render the warranty void.