

CATALOG #	TYPE	
JOB NAME	WATTAGE	VOLTAGE

# Symphony Remote Driver Series

## Open Appearance 4" Square • LED

Up to 60,000 Hour Life (L70) • Type IC • Wet Location

LM-80 Qualified • LM-79 Certified Photometry

**SRS-04640**



## Specifications

### Delivered System Performance

- Lumen Series: **Must Specify**
- 2500L: 2500 nominal lumens (35W)
- Distribution: MFL standard; Optional: -SPT or -NFL
- Color temperature: 3500°K standard; Optional: -27K, -30K, -41K or -50K
- CRI: 80+ standard; Optional: -HC (90+)
- 60,000 hour life (L70)
- Fully sustainable: removable for servicing

### Thermal Management System

- All aluminum heat sink, components and housing maximize cool operation and long life while minimizing maintenance

### Remote Power Supply Required

- For 0-10V use **SYM-CABNT**
- For DMX with RDM use **SYM-DMXPS**

### SmartPower™ Battery Backup

- EMI-21220** for emergency power
- See specification sheet; order separately

### Trim

- Clear specular aluminum trim
- Self-flanged, low glare square; prismatic spread lens above
- Optional colors and finishes available

### Acrylic Enameled Aluminum Housing

- Rustproof and corrosion resistant: Exceeds 1000 hour ASTM 5% salt spray test
- Shallow depth fits restricted plenums
- Cool operation: Extends life of all components
- Fully sustainable: Entire luminaire, including LED light engine, is modular, easily visible and serviced through aperture
- Built-in plaster flange

### Outlet Box

- UL listed J-box with insulated removable cover; prewired 14 GA (NEC) with ½" and ¾" knockouts

### Installation

- Requires minimum 16 AWG shielded twisted pair wire from SmartDMX™ to fixtures
- Maximum cable run from driver to fixture is 250'**

- Recess indoor or outdoor
- Accommodates ceilings up to 1¼" thick or see Option -79
- Compatible with fire rated enclosures (by others)
- 27" galvanized hanger bars with adjustable mounting brackets (2) supplied

### UL, C-UL (Canada) Listings

- Wet, damp or dry locations, covered ceilings
- Type IC: for direct contact with insulation

### FCC Compliance

- FCC Part 15 certified for EMI/RFI emissions

### FIVE YEAR Limited Warranty

- Complete standard fixture (must be used with SYM-CABNT or SYM-DMXPS)



## Options and Ordering Configuration

(Example: SRS-04640-2500L-HC-70T-AT)

Must Specify		Optional			
Model	Lumens	Color Temp. (CCT)	Distribution	Lens & Trim	Other Options
SRS-04640					
	-2500L	<b>(Blank):</b> 3500°K <b>-27K:</b> 2700°K instead <b>-30K:</b> 3000°K instead <b>-41K:</b> 4100°K instead <b>-50K:</b> 5000°K instead <b>-HC:</b> 90+ CRI instead	<b>(Blank):</b> MFL <b>-NFL:</b> Narrow flood distribution <b>-SPT:</b> Spot distribution	<b>(Blank):</b> Clear specular trim; lens above <b>-30T:</b> White enamel (complete trim) <b>-30F:</b> White enamel (flange only) <b>-32:</b> White oversize trim ring; specify O.D. <b>-33:</b> Tempered glass Glow Ring suspended beneath trim; shape <b>-37F:</b> Dark bronze enamel (flange only) <b>-38F:</b> Black enamel (flange only) <b>-45:</b> Gasket between trim flange and ceiling <b>-70T:</b> Clear semi-specular SofTex™ (complete trim) <b>-94:</b> Custom color/finish; specify; consult factory <b>-CF:</b> Custom color filter (Rosco); specify	<b>(Blank):</b> None <b>-79:</b> Extension collar for ceilings up to 2" thick <b>-99:</b> Special modification; consult factory <b>-AT:</b> Air tight version; meets ASTM E283 restricted airflow of 2 CFM maximum <b>-DL:</b> Downlight square trim instead; clear specular finish standard or add optional trim selection <b>-RH:</b> Residential mounting hardware instead; suitable for wood joist ceilings with spacing from 14 ½" to 25 ⅞" with ⅝" vertical adjustability

# Dimensions

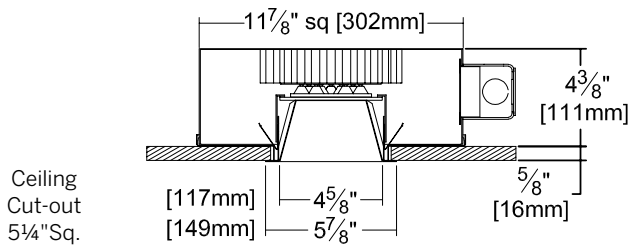

Ceiling  
Cut-out  
5 1/4" Sq.

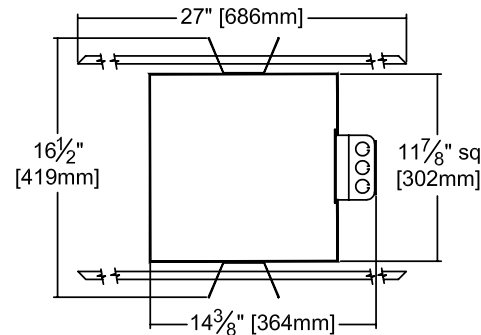

## Photometry - Installed Complete Fixture

Photometry from UL Verification Services, Allentown, PA

LM-79 IESNA Certified Photometry from Independent Lab

### -2500L STANDARD (MFL)

Lumens: 2944  
Beam: ~43°  
SC: 0.7  
LPW: 80  
Efficiency: 79.2%  
UL Test: 1259197



Total System Watts 36.6

CANDLEPOWER DISTRIBUTION					
	0.0	22.5	45.0	67.5	90.0
0	4811	4811	4811	4811	4811
5	4798	4846	4857	4824	4835
15	4282	4538	4803	4624	4438
25	1706	1777	2054	1901	1752
35	385	380	400	478	501
45	71	104	118	98	85
55	10	9	12	10	10
65	1	1	1	1	1
75	1	1	1	1	0
85	0	0	0	0	0
90	0	0	0	0	0

Cone of Light ▲

Dist.	FC	Dia.
6	134.0	4.7
8	75.2	6.3
10	48.1	7.8
12	33.4	9.4
14	24.5	10.9
16	18.8	12.5

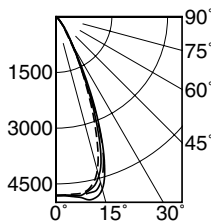

### -2500L Option -SPT

Lumens: 3016  
Beam: ~16°  
SC: 0.3  
LPW: 82  
Efficiency: 81.1%  
UL Test: 1259196



Total System Watts 36.6

CANDLEPOWER DISTRIBUTION					
	0.0	22.5	45.0	67.5	90.0
0	22540	22540	22540	22540	22540
5	17780	17940	17920	17970	18040
15	3487	3365	3339	3262	3300
25	825	902	1032	782	715
35	192	213	280	255	198
45	43	56	69	58	50
55	5	5	5	4	4
65	2	1	1	1	1
75	1	1	1	1	0
85	1	1	1	1	1
90	2	1	1	1	1

Cone of Light ▲

Dist.	FC	Dia.
6	626.0	1.7
8	352.0	2.3
10	225.0	2.9
12	157.0	3.5
14	115.0	4.0
16	88.0	4.6

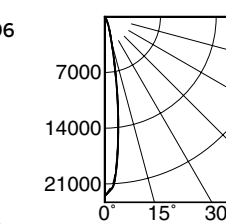

### -2500L Option -NFL

Lumens: 2753  
Beam: ~30°  
SC: 0.5  
LPW: 75  
Efficiency: 74.1%  
UL Test: 1264621



Total System Watts 36.5

CANDLEPOWER DISTRIBUTION					
	0.0	22.5	45.0	67.5	90.0
0	7099	7099	7099	7099	7099
5	6533	6581	6615	6643	6663
15	3935	3956	3959	3958	4008
25	1484	1472	1555	1423	1363
35	417	423	423	473	477
45	86	114	123	108	102
55	8	8	10	9	9
65	1	1	1	1	1
75	0	0	0	0	0
85	0	0	0	0	0
90	0	0	0	0	0

Cone of Light ▲

Dist.	FC	Dia.
6	197.0	3.2
8	111.0	4.3
10	71.0	5.4
12	49.3	6.5
14	36.2	7.5
16	27.7	8.6

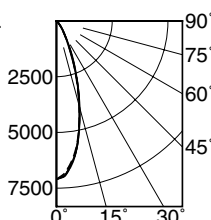

▲ Cone of Light Key  
Dia. (in ft.) shown is where FC value is half the FC at nadir.

Dist. Distance (Ft.) from fixture  
FC Footcandles at nadir (0°)  
Dia. Circle of light at 50% of FC

LED manufacturers maintain a tolerance of +/-7% on flux (lumens) and power (electrical) measurements.