

CATALOG #	TYPE	
JOB NAME	WATTAGE	VOLTAGE

# Symphony Remote Driver Series

## Open Appearance 4" Downlight • LED

Up to 90,000 Hour Life • Type IC • Wet Location

LM-80 Qualified • LM-79 Certified Photometry

**SRS-04150**



### Specifications

#### Delivered System Performance

- Lumen Series: **Must Specify**
- 1500L: 1500 nominal lumens (20W)
- Distribution: MFL standard; Optional: -SPT or -NFL
- Color temperature: 3500°K standard; Optional: -27K, -30K, -41K or -50K
- CRI: 80+ standard; Optional: -HC (90+)
- 90,000 hour life (L70) in open plenum; 60,000 hour life in insulation (Type IC)
- Fully sustainable: removable for servicing

#### Thermal Management System

- All aluminum heat sink, components and housing maximize cool operation and long life while minimizing maintenance

#### Remote Power Supply Required

- For 0-10V use **SYM-CABNT**
- For DMX with RDM use **SYM-DMXPS**

#### SmartPower™ Battery Backup

- EMI-21220** for emergency power
- See specification sheet; order separately

#### Trim

- Clear specular aluminum trim
- Self-flanged, low glare square; prismatic spread lens above
- Optional colors and finishes available

#### Acrylic Enamelled Aluminum Housing

- Rustproof and corrosion resistant: Exceeds 1000 hour ASTM 5% salt spray test
- Shallow depth fits restricted plenums
- Cool operation: Extends life of all components
- Fully sustainable: Entire luminaire, including LED light engine, is modular, easily visible and serviced through aperture
- Built-in plaster flange

#### Outlet Box

- UL listed J-box with insulated removable cover. Prewired 14 GA (NEC) with ½" and ¾" knockouts

#### Installation

- Requires minimum 16 AWG shielded twisted pair wire from SmartDMX™ to fixtures
- Maximum cable run from driver to fixture is 250'**

- Recess indoor or outdoor
- Accommodates ceilings up to 1¼" thick or see Option -79
- Compatible with fire rated enclosures (by others)
- 27" galvanized hanger bars with adjustable mounting brackets (2) supplied

#### UL, C-UL (Canada) Listings

- Wet, damp or dry locations, covered ceilings
- Type IC: for direct contact with insulation
- Through-branch conductors (4 #12 AWG 90°C) for Type IC Listing

#### FCC Compliance

- FCC Part 15 certified for EMI/RFI emissions

#### FIVE YEAR Limited Warranty

- Complete standard fixture (must be used with SYM-CABNT or SYM-DMXPS)



### Options and Ordering Configuration

(Example: SRS-04150-1500L-30K-NFL)

Must Specify		Optional			
Model	Lumens	Color Temp. (CCT)	Distribution	Lens & Trim	Other Options
SRS-04150	-1500L	<b>(Blank):</b> 3500°K <b>-27K:</b> 2700°K instead <b>-30K:</b> 3000°K instead <b>-41K:</b> 4100°K instead <b>-50K:</b> 5000°K instead <b>-HC:</b> 90+ CRI instead	<b>(Blank):</b> MFL <b>-NFL:</b> Narrow flood distribution <b>-SPT:</b> Spot distribution	<b>(Blank):</b> Clear specular trim; lens above <b>-23:</b> Frosted micropismatic lens instead <b>-30T:</b> White enamel (complete trim) <b>-30F:</b> White enamel (flange only) <b>-32:</b> White oversize trim ring; specify O.D. <b>-33:</b> Tempered glass Glow Ring suspended beneath trim; shape matches reflector <b>-37F:</b> Dark bronze enamel (flange only) <b>-38F:</b> Black enamel (flange only) <b>-70T:</b> Clear semi-specular SofTex™ (complete trim) <b>-94:</b> Custom color/finish; specify; consult factory <b>-CF:</b> Custom color filter (Rosco); specify <b>-WA:</b> White acrylic (flat) diffuser instead (for soft wide flood distribution)	<b>(Blank):</b> None <b>-79:</b> Extension collar for ceilings up to 2" thick <b>-99:</b> Special modification; consult factory <b>-AT:</b> Air tight version. Meets ASTM E283 restricted airflow of 2 CFM maximum <b>-RH:</b> Residential mounting hardware instead. Suitable for wood joist ceilings with spacing from 14 ½" to 25 ⅞" with ⅝" vertical adjustability <b>-TA:</b> Top Access for servicing from above ceiling

# Dimensions

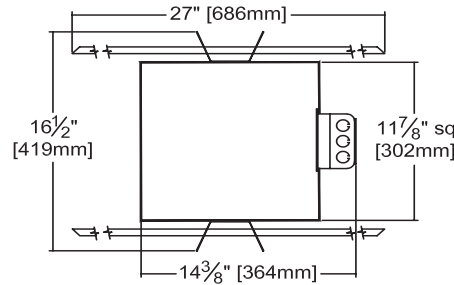
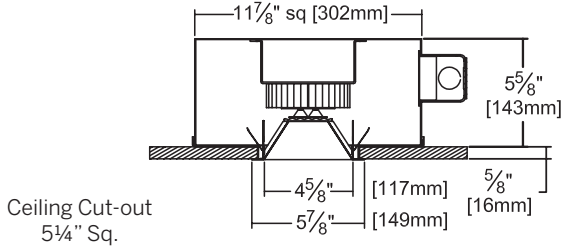

# Photometry - Installed Complete Fixture

Photometry from I.T.L., Boulder, CO

LM-79 IESNA Certified Photometry from Independent Lab

## -1500L STANDARD (MFL)

Lumens: 1579  
Beam: ~42°  
SC: 0.7  
LPW: 75  
Efficiency: 78.1%  
ITL Test: 87231



Total System Watts 21.1

	CANDLEPOWER DISTRIBUTION				
	0.0	22.5	45.0	67.5	90.0
0	2613	2613	2613	2613	2613
5	2657	2655	2645	2630	2622
15	2386	2430	2428	2297	2212
25	1023	1091	1127	1002	904
35	240	249	257	229	211
45	40	45	59	43	37
55	1	3	7	2	1
65	0	0	0	0	0
75	0	0	0	0	0
85	0	0	0	0	0
90	0	0	0	0	0

### Cone of Light ▲

Dist.	FC	Dia.
6	72.6	4.6
8	40.8	6.1
10	26.1	7.7
12	18.1	9.2
14	13.3	10.7
16	10.2	12.3

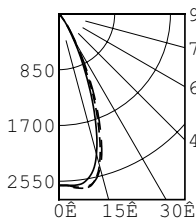

## -1500L Option -SPT

Lumens: 1704  
Beam: ~20°  
SC: 0.3  
LPW: 82  
Efficiency: 84.3%  
ITL Test: 87200



Total System Watts 20.9

	CANDLEPOWER DISTRIBUTION				
	0.0	22.5	45.0	67.5	90.0
0	10838	10838	10838	10838	10838
5	9827	9795	9710	9759	9805
15	2095	2067	2073	2139	2167
25	472	375	315	361	473
35	121	78	74	74	107
45	14	19	25	20	14
55	0	1	5	1	0
65	0	0	0	0	0
75	0	0	0	0	0
85	0	0	0	0	0
90	0	0	0	0	0

### Cone of Light ▲

Dist.	FC	Dia.
6	301.1	2.1
8	169.3	2.9
10	108.4	3.6
12	75.3	4.3
14	55.3	5.0
16	42.3	5.7

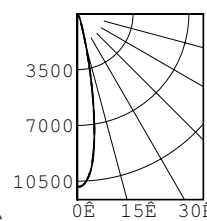

## -1500L Option -NFL

Lumens: 1634  
Beam: ~36°  
SC: 0.6  
LPW: 69  
Efficiency: 70.9%  
ITL Test: 87937



Total System Watts 20.9

	CANDLEPOWER DISTRIBUTION				
	0.0	22.5	45.0	67.5	90.0
0	2475	2475	2475	2475	2475
5	2391	2393	2397	2397	2393
15	1732	1737	1723	1722	1701
25	927	915	913	885	881
35	357	367	393	352	341
45	82	96	126	91	80
55	2	6	18	6	2
65	0	0	0	0	0
75	0	0	0	0	0
85	0	0	0	0	0
90	0	0	0	0	0

### Cone of Light ▲

Dist.	FC	Dia.
6	68.8	4.0
8	38.7	5.3
10	24.8	6.6
12	17.2	7.9
14	12.6	9.2
16	9.7	10.5

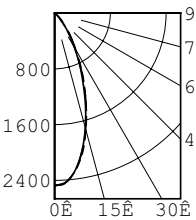

### ▲ Cone of Light Key

Dist. (in ft.) shown is where FC value is half the FC at nadir.

FC Footcandles at nadir (0°)  
Dia. Circle of light at 50% of FC

LED manufacturers maintain a tolerance of +/-7% on flux (lumens) and power (electrical) measurements.

LIMITED WARRANTY: CATALOGED KIRLIN FIXTURES ARE WARRANTED FREE OF DEFECTS IN WORKMANSHIP OR MATERIAL FOR 10 YEARS FROM DATE OF PURCHASE. INSTALLED TO N.E.C. / IN-NORMAL USE. Manufacturer at the option will replace or repair such fixture or refund the purchase price on presentation of proof of purchase and defective fixture at the offices of manufacturer within the years of original shipment. Liability of manufacturer is limited to the foregoing and manufacturer shall not be liable for any other damages, direct or indirect, sustained or suffered by purchaser or any person. This warranty is applied to the buyer in place of all other warranties, expressed or implied. Seller does not warrant as to merchantability or fitness for a particular use, nor will any oral statement constitute a warranty or amend this specific warranty. Abnormal use, abuse of the fixture, improper installation, or repair or modification of the fixture without prior written authorization from the manufacturer will render the warranty void.