

CATALOG #	TYPE	
JOB NAME	WATTAGE	VOLTAGE

Symphony Remote Driver Series

Lensed 6" Wall Wash • LED

Up to 60,000 Hour Rated Life (L70) • Wet Location
LM-80 Qualified • LM-79 Certified Photometry

SRR-06616



Specifications

Delivered System Performance

- Lumen Series: **Must Specify**
- 5000L: 5000 nominal lumens (55W)
- 4000L: 4000 nominal lumens (42W)
- 2500L: 2500 nominal lumens (35W)
- Color temperature: 3500°K standard; Optional: -27K, -30K, -41K or -50K
- CRI: 80+ standard; Optional: -HC (90+)
- 60,000 hour rated life (L70)
- Fully sustainable: removable for servicing
- Center beam optics positioned at 25°

Thermal Management System

- All aluminum heat sink, components and housing maximize cool operation and long life while minimizing maintenance

Remote Power Supply Required

- For 0-10V use **SYM-CABNT**
- For DMX with RDM use **SYM-DMXPS**
- The **Symphony Configurator** can help determine the necessary components

SmartPower™ Battery Backup

- EMI-21220** for emergency power
- See specification sheet; order separately

Trim

- Clear specular aluminum trim
- Self-flanged, low glare angle-cut cone; prismatic spread lens above
- Optional colors and finishes available

Acrylic Enameled Aluminum Housing

- Rustproof and corrosion: Exceeds 1000 hour ASTM 5% salt spray test
- Shallow depth fits restricted plenums
- Cool operation: Extends life of all components
- Fully sustainable: Entire luminaire, including LED light engine, easily visible and serviced through aperture
- Built-in plaster flange

Outlet Box

- UL listed J-box with insulated removable cover. Prewired 14 GA (NEC) with ½" and ¾" knockouts

Installation

- Requires minimum 16 AWG shielded twisted pair wire from driver to fixtures

Maximum cable run from driver to fixture is 250'

- Recesses in ceilings up to 1½" thick
- Compatible with fire rated enclosures (by others)
- 27" galvanized hanger bars with adjustable mounting brackets (2) supplied

UL, C-UL (Canada) Listings

- Wet, damp, dry locations, covered ceilings
- 2500L (only): Type IC - for direct contact with insulation

FCC Compliance

- FCC Part 15 certified for EMI/RFI emissions

FIVE YEAR Limited Warranty

- Complete standard fixture (must be used with SYM-CABNT or SYM-DMXPS)

Options and Ordering Configuration

(Example: SRR-06616-6500L-30K-45)



Must Specify		Optional		
Model	Lumens	Color Temp. (CCT)	Lens & Trim	Other Options
SRR-06616				
	<ul style="list-style-type: none"> -5000L -4000L -2500L 	<ul style="list-style-type: none"> (Blank): 3500°K -27K: 2700°K instead -30K: 3000°K instead -41K: 4000°K instead -50K: 5000°K instead -HC: 90+ CRI instead 	<ul style="list-style-type: none"> (Blank): Clear specular trim; lens above -30T: White enamel (complete trim) -30F: White enamel (flange only) -32: White oversize trim ring; specify O.D. -37F: Dark bronze enamel (flange only) -38F: Black enamel (flange only) -45: Gasket between trim flange and ceiling -70T: Clear semi-specular SofTex™ (complete trim) -94: Custom color/finish; specify; consult factory 	<ul style="list-style-type: none"> (Blank): None -99: Special modification; consult factory -AT: Air tight version; meets ASTM E283 restricted airflow of 2 CFM maximum -RH: Residential mounting hardware instead. Suitable for wood joist ceilings with spacing from 14 ½" to 25 ⅞" with ⅝" vertical adjustability -SH: Sealed housing and junction box for -6500L or -5000L; see Option -AT for use with -2500L

Dimensions

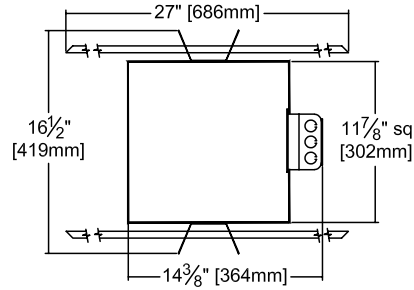
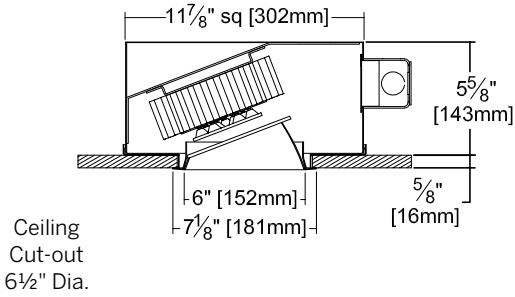

LIMITED WARRANTY: KIRLIN FIXTURES ARE WARRANTED FREE OF DEFECTS IN WORKMANSHIP OR MATERIAL FOR THE DATE OF PURCHASE. INSTALLATION, IN-NORMAL USE, MANUFACTURING AT THE OPTION WILL REPLACE OR REPAIR SUCH FIXTURE OR RETURN THE PURCHASE PRICE ON PRESENTATION OF PROOF OF PURCHASE AND DEFECTIVE FIXTURE AT THE OFFICES OF MANUFACTURER WITHIN THE YEARS OF ORIGINAL SHIPMENT. LIABILITY OF MANUFACTURER IS LIMITED TO THE FOREGOING AND MANUFACTURER SHALL NOT BE LIABLE FOR ANY OTHER DAMAGES, DIRECT OR INDIRECT, INSTALLED OR SUFFERED BY PURCHASER OR ANY PERSON. THIS WARRANTY IS APPLIED TO THE BUYER IN PLACE OF ALL OTHER WARRANTIES, EXPRESSED OR IMPLIED. SELLER DOES NOT WARRANT AS TO MERCHANTABILITY OR FITNESS FOR A PARTICULAR USE, NOR WILL ANY ORAL STATEMENT CONSTITUTE A WARRANTY OR AMEND THIS SPECIFIC WARRANTY. ABNORMAL USE, ABUSE OF THE FIXTURE, IMPROPER INSTALLATION OR REPAIR OR MODIFICATION OF THE FIXTURE WITHOUT PRIOR WRITTEN AUTHORIZATION FROM THE MANUFACTURER WILL RENDER THE WARRANTY VOID.

Photometry - Installed Complete Fixture

Photometry from I.T.L., Boulder, CO

LM-79 IESNA Certified Photometry from Independent Lab

-5000L Performance

Lumens: 4141
 LPW: 72
 Efficiency: 69.6%
 ITL Test: 87512

WALL > --- 0°
 --- 90°
 --- 180°

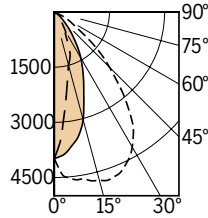

Total System Watts 57.4

DISTANCE FROM CEILING IN FEET	SINGLE FIXTURE				MULTIPLE FIXTURES						
	1'	2'	3'	4'	2' CENTERS	3' CENTERS					
FIXTURE INSTALLED 2' FROM WALL											
Footcandle Distribution on Wall Surface											
1	50.8	22.8	4.9	1.9	1.2	67.6	67.8	67.7	57.0	26.0	56.8
2	189.0	102.0	24.6	6.2	2.2	246.0	246.0	246.0	205.0	109.0	205.0
3	167.0	118.0	43.6	12.7	4.4	265.0	265.0	265.0	196.0	159.0	196.0
4	103.0	83.1	45.4	17.9	6.6	212.0	212.0	212.0	141.0	140.0	141.0
5	62.3	53.8	35.4	18.8	8.4	157.0	157.0	157.0	104.0	103.0	104.0
6	39.6	35.3	26.0	16.4	9.0	118.0	119.0	119.0	78.9	77.2	78.9
7	26.7	24.5	19.2	13.5	8.6	92.0	92.8	92.8	61.2	60.7	61.2
8	19.4	18.1	14.9	11.2	7.8	75.8	76.8	76.7	50.0	50.5	49.9
9	15.5	14.6	12.4	9.8	7.2	66.7	67.0	67.0	43.3	44.1	43.3

-4000L Performance

Lumens: 3330
 LPW: 78
 Efficiency: 69.8%
 ITL Test: 88285

WALL > --- 0°
 --- 90°
 --- 180°

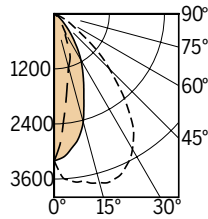

Total System Watts 42.9

DISTANCE FROM CEILING IN FEET	SINGLE FIXTURE				MULTIPLE FIXTURES						
	1'	2'	3'	4'	2' CENTERS	3' CENTERS					
FIXTURE INSTALLED 2' FROM WALL											
Footcandle Distribution on Wall Surface											
1	40.9	18.3	3.9	1.5	1.0	54.4	54.6	54.5	45.9	21.0	45.7
2	152.0	81.7	19.8	5.0	1.8	198.0	198.0	198.0	165.0	87.6	165.0
3	135.0	95.2	35.0	10.2	3.5	213.0	213.0	213.0	158.0	128.0	158.0
4	82.4	66.8	36.5	14.4	5.3	170.0	171.0	170.0	114.0	113.0	114.0
5	50.1	43.2	28.5	15.1	6.8	126.0	126.0	126.0	83.8	83.1	83.7
6	31.8	28.4	20.9	13.1	7.2	95.2	95.3	95.3	63.5	62.1	63.4
7	21.4	19.7	15.4	10.9	6.9	74.0	74.7	74.6	49.2	48.8	49.2
8	15.6	14.5	12.0	9.0	6.3	60.9	61.7	61.7	40.2	40.6	40.2
9	12.4	11.7	10.0	7.9	5.8	53.7	53.9	53.8	34.8	35.4	34.8

-2500L Performance

Lumens: 2772
 LPW: 79
 Efficiency: 74.6%
 ITL Test: 87769

WALL > --- 0°
 --- 90°
 --- 180°

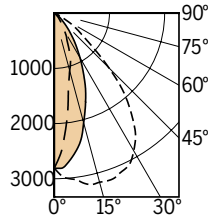

Total System Watts 35.2

DISTANCE FROM CEILING IN FEET	SINGLE FIXTURE				MULTIPLE FIXTURES						
	1'	2'	3'	4'	2' CENTERS	3' CENTERS					
FIXTURE INSTALLED 2' FROM WALL											
Footcandle Distribution on Wall Surface											
1	23.6	11.5	2.9	1.3	0.8	34.0	34.1	34.1	27.7	13.5	27.6
2	124.0	62.7	13.8	3.6	1.4	157.0	157.0	157.0	134.0	62.7	134.0
3	114.0	81.0	28.2	7.8	2.7	178.0	178.0	178.0	132.0	107.0	132.0
4	69.4	56.7	29.6	11.4	4.0	140.0	140.0	140.0	94.2	94.2	94.2
5	41.4	37.2	24.2	12.1	5.3	105.0	105.0	105.0	68.5	70.6	68.5
6	26.4	24.2	18.1	10.8	5.8	79.8	79.9	79.9	52.2	53.5	52.2
7	17.8	16.8	13.5	9.3	5.6	62.3	62.4	62.4	41.2	41.8	41.2
8	13.1	12.4	10.6	7.9	5.3	51.8	52.0	51.9	34.1	34.5	34.1
9	10.5	10.0	8.8	6.9	4.9	45.7	45.8	45.8	29.7	30.1	29.7

LED manufacturers maintain a tolerance of +/-7% on flux (lumens) and power (electrical) measurements.

Symphony Driver Modules

Fully Digital Controlled Power Source for LED Luminaires

Mounted in Kirlin's **SYM-CABNT**

Drivers wired in series



Driver Module	Maximum Capacity	Fixture Load Examples
DVR-1400A	Qty 1: 2500L Luminaires	<ul style="list-style-type: none"> Qty 1: SRR-06616-2500L
DVR-1400B *Not available with DMX dimming	Up to Qty 2: 2500L Luminaires	<ul style="list-style-type: none"> Qty 1: SRR-06616-2500L Qty 2: SRR-06616-2500L Qty 1: SRR-06616-2500L and Qty 1: SRR-06610-2500L
DVR-1050A	Qty 1: 4000L Luminaires	<ul style="list-style-type: none"> Qty 1: SRR-06616-4000L
DVR-1400B *Not available with DMX dimming	Qty 1: 5000L Luminaires	<ul style="list-style-type: none"> Qty 1: SRR-06616-5000L