

CATALOG #	TYPE	
JOB NAME	WATTAGE	VOLTAGE

Symphony Remote Driver Series

Open Appearance 6" Adjustable • LED

Up to 60,000 Hour Rated Life (L70) • Wet Location

LM-80 Qualified • LM-79 Certified Photometry

SRR-06610

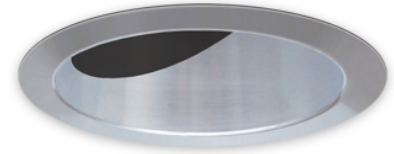

Specifications

Delivered System Performance

- Lumen Series: **Must Specify**
 - 5000L: 5000 nominal lumens (55W)
 - 4000L: 4000 nominal lumens (42W)
 - 2500L: 2500 nominal lumens (35W)
- Distributions: NFL standard; Optional: -SPT or -MFL
- Color temperature: 3500°K standard; Optional: -27K, -30K, -41K or -50K
- CRI: 80+ standard; Optional: -HC (90+)
- 60,000 hour rated life (L70)
- Fully sustainable: removable for servicing

Center Beam Optics

- Tilts up to 35° and locks in place
- Rotates full 360° and locks in place
- Accommodates sloped ceilings up to 35°

Thermal Management System

- All aluminum heat sink, components and housing maximize cool operation and long life while minimizing maintenance

Remote Power Supply Required

- For 0-10V use **SYM-CABNT**
- For DMX with RDM use **SYM-DMXPS**
- The **Symphony Configurator** can help determine the necessary components

SmartPower™ Battery Backup

- EMI-21220** for emergency power
- See specification sheet; order separately

Trim

- Clear specular aluminum trim
- Self-flanged, low glare angle-cut cone; tempered glass lens above
- Optional colors and finishes available

Acrylic Enameled Aluminum Housing

- Rustproof and corrosion: Exceeds 1000 hour ASTM 5% salt spray test
- Shallow depth fits restricted plenums
- Cool operation: Extends life of all components
- Fully sustainable: Entire luminaire, including LED light engine, easily visible and serviced through aperture
- Built-in plaster flange

Outlet Box

- UL listed J-box with insulated removable cover; Prewired 14 GA (NEC) with 1/2" and 3/4" knockouts

Installation

- Requires minimum 16 AWG shielded twisted pair wire from driver to fixtures

• Maximum cable run from driver to fixture is 250'

- Recesses in ceilings up to 1 1/8" thick
- Compatible with fire rated enclosures (by others)
- 27" galvanized hanger bars with adjustable mounting brackets (2) supplied

UL, C-UL (Canada) Listings

- Wet, damp, dry locations, covered ceilings
- 2500L (only): Type IC - for direct contact with insulation

FCC Compliance

- FCC Part 15 certified for EMI/RFI emissions

FIVE YEAR Limited Warranty

- Complete standard fixture (must be used with SYM-CABNT or SYM-DMXPS)

Options and Ordering Configuration

(Example: SRR-06610-6500L-30K-SPT)



Must Specify		Optional			
Model	Lumens	Color Temp. (CCT)	Distribution	Lens & Trim	Other Options
SRR-06610					
	-5000L -4000L -2500L	(Blank): 3500°K -27K: 2700°K instead -30K: 3000°K instead -41K: 4000°K instead -50K: 5000°K instead -HC: 90+ CRI instead	(Blank): NFL -MFL: Medium flood distribution -SPT: Spot distribution	(Blank): Clear specular trim; lens above -30T: White enamel (complete trim) -30F: White enamel (flange only) -32: White oversize trim ring; specify O.D. -37F: Dark bronze enamel (flange only) -38F: Black enamel (flange only) -45: Gasket between trim flange and ceiling -70T: Clear semi-specular SofTex™ (complete trim) -94: Custom color/finish; specify; consult factory -DL: Downlight version instead	(Blank): None -99: Special modification; consult factory -AT: Air tight version; meets ASTM E283 restricted airflow of 2 CFM maximum -RH: Residential mounting hardware instead; suitable for wood joist ceilings with spacing from 14 1/8" to 25 7/8" with 5/8" vertical adjustability -SH: Sealed housing and junction box for -6500L or -5000L; see Option -AT for use with -2500L -TA: Top Access for servicing from above ceiling

Dimensions

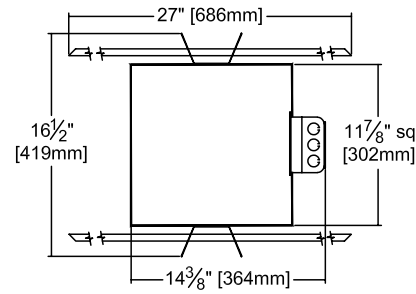
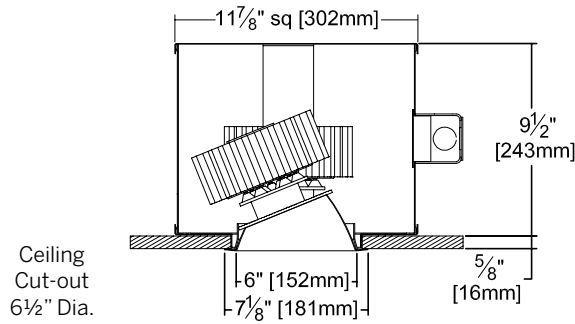

Photometry - Installed Complete Fixture

Photometry from I.T.L., Boulder, CO

LM-79 IESNA Certified Photometry from Independent Lab

-5000L STANDARD (NFL)

Lumens: 4413
 Beam: ~35°
 SC: 0.6
 LPW: 77
 Efficiency: 74.2%
 ITL Test: 87784

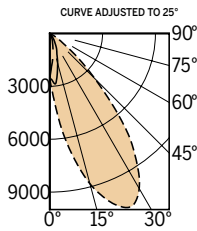

Total System Watts 57.2

CANDLEPOWER DISTRIBUTION					
	0.0	45.0	90.0	135.0	180.0
0	2515	2515	2515	2515	2515
5	4351	3844	2831	1985	1662
15	8831	5316	1752	843	674
25	10855	4621	905	384	283
35	8451	2560	381	117	69
45	3631	885	116	30	17
55	815	251	25	3	1
65	129	40	5	2	0
75	9	4	1	0	0
85	0	0	0	0	0
90	0	0	0	0	0

-5000L Option -SPT

Lumens: 4359
 Beam: ~16°
 SC: 0.3
 LPW: 77
 Efficiency: 73.3%
 ITL Test: 87509

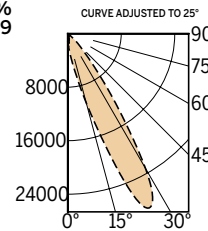

Total System Watts 57.0

CANDLEPOWER DISTRIBUTION					
	0.0	45.0	90.0	135.0	180.0
0	1135	1135	1135	1135	1135
5	2355	2060	1392	992	685
15	10723	4106	850	444	398
25	28756	3483	476	223	185
35	11771	1470	212	75	51
45	2411	432	67	14	11
55	384	161	11	1	0
65	91	13	1	0	0
75	3	1	0	0	0
85	0	0	0	0	0
90	0	0	0	0	0

-5000L Option -MFL

Lumens: 4345
 Beam: ~47°
 SC: 0.8
 LPW: 76
 Efficiency: 73.1%
 ITL Test: 87510

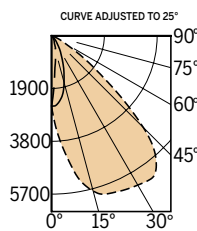

Total System Watts 57.0

CANDLEPOWER DISTRIBUTION					
	0.0	45.0	90.0	135.0	180.0
0	2536	2536	2536	2536	2536
5	3866	3499	2462	1683	1323
15	5786	5002	1742	664	506
25	6133	5081	886	290	230
35	6273	3197	374	132	91
45	4672	1243	141	42	21
55	1466	386	48	7	2
65	300	95	8	0	0
75	28	9	0	0	0
85	0	0	0	0	0
90	0	0	0	0	0

See following page for -4000L and -2500L performance

LED manufacturers maintain a tolerance of +/-7% on flux (lumens) and power (electrical) measurements.

LIMITED WARRANTY: CATALOGED KIRLIN FIXTURES ARE WARRANTED FREE OF DEFECTS IN WORKMANSHIP OR MATERIAL FOR ONE YEAR FROM DATE OF PURCHASE. INSTALLED TO N.E.C. / IN-NORMAL USE. Manufacturer at the option will replace or repair such fixture or refund the purchase price on presentation of proof of purchase and defective fixture at the office of manufacturer within the years of original shipment. Liability of manufacturer is limited to the foregoing and manufacturer shall not be liable for any other damages, direct or indirect, sustained or suffered by purchaser or any person. This warranty is applied to the buyer in place of all other warranties, expressed or implied. Seller does not warrant as to merchantability or fitness for a particular use, nor will any oral statement constitute a warranty or amend this specific warranty. Abnormal use, abuse of the fixture, improper installation, or repair or modification of the fixture without prior written authorization from the manufacturer will render the warranty void.

SYNAPHONY
 NOVEMBER 2024

Detailed Photometry - Installed Fixture

Photometry from I.T.L., Boulder, CO

SRR-06610-4000L PERFORMANCE

-4000L STANDARD (NFL)

Lumens: 3548
Beam: ~35°
SC: 0.5
LPW: 83
Efficiency: 74.4%
ITL Test: 88279

Total System Watts 42.7

CANDLEPOWER DISTRIBUTION					
	0.0	45.0	90.0	135.0	180.0
0	2022	2022	2022	2022	2022
5	3498	3091	2276	1596	1336
15	7100	4274	1409	678	542
25	8727	3715	728	309	228
35	6795	2058	306	94	55
45	2919	712	93	24	14
55	655	202	20	2	1
65	104	32	4	2	0
75	7	3	1	0	0
85	0	0	0	0	0
90	0	0	0	0	0

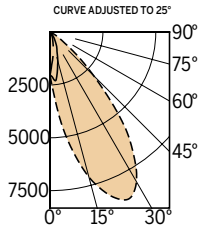

SRR-06610-2500L PERFORMANCE

-2500L STANDARD (NFL)

Lumens: 2732
Beam: ~34°
SC: 0.6
LPW: 78
Efficiency: 73.5%
ITL Test: 88094

Total System Watts 35.2

CANDLEPOWER DISTRIBUTION					
	0.0	22.5	45.0	67.5	90.0
0	1579	1579	1579	1579	1579
5	2462	2129	1578	1256	1177
15	5117	3210	1266	590	453
25	6470	2772	622	268	198
35	5038	1648	269	76	44
45	2264	600	88	17	13
55	559	164	14	1	1
65	89	21	2	1	0
75	5	2	0	0	0
85	0	0	0	0	0
90	0	0	0	0	0

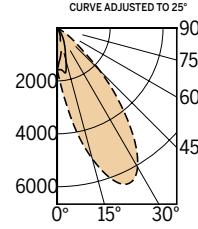

-4000L Option -SPT

Lumens: 3504
Beam: ~17°
SC: 0.3
LPW: 82
Efficiency: 73.5%
ITL Test: 88280

Total System Watts 42.6

CANDLEPOWER DISTRIBUTION					
	0.0	45.0	90.0	135.0	180.0
0	913	913	913	913	913
5	1893	1656	1119	798	551
15	8621	3301	683	357	320
25	23120	2800	383	179	149
35	9464	1182	170	60	41
45	1938	347	54	11	9
55	309	129	9	1	0
65	73	10	1	0	0
75	2	1	0	0	0
85	0	0	0	0	0
90	0	0	0	0	0

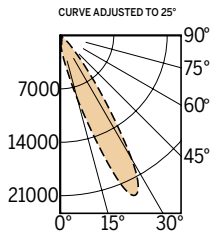

-2500L Option -SPT

Lumens: 3008
Beam: ~16°
SC: 0.3
LPW: 86
Efficiency: 80.9%
ITL Test: 87766

Total System Watts 35.1

CANDLEPOWER DISTRIBUTION					
	0.0	22.5	45.0	67.5	90.0
0	638	638	638	638	638
5	1289	1052	689	464	440
15	7940	2048	646	260	213
25	23864	1730	314	136	112
35	9013	812	127	39	28
45	1382	228	38	4	5
55	215	58	1	0	0
65	28	3	0	0	0
75	1	1	0	0	0
85	0	0	0	0	0
90	0	0	0	0	0

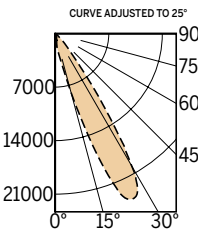

-4000L Option -MFL

Lumens: 3493
Beam: ~47°
SC: 0.8
LPW: 82
Efficiency: 73.3%
ITL Test: 88281

Total System Watts 42.6

CANDLEPOWER DISTRIBUTION					
	0.0	45.0	90.0	135.0	180.0
0	2039	2039	2039	2039	2039
5	3108	2813	1979	1353	1064
15	4652	4022	1401	534	407
25	4931	4085	712	233	185
35	5043	2570	301	106	73
45	3756	999	113	34	17
55	1179	310	39	6	2
65	241	76	6	0	0
75	23	7	0	0	0
85	0	0	0	0	0
90	0	0	0	0	0

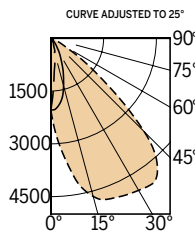

-2500L Option -MFL

Lumens: 2997
Beam: ~45°
SC: 0.8
LPW: 85
Efficiency: 80.6%
ITL Test: 87767

Total System Watts 35.1

CANDLEPOWER DISTRIBUTION					
	0.0	22.5	45.0	67.5	90.0
0	1679	1679	1679	1679	1679
5	2889	2497	1646	1036	854
15	4253	4036	1307	617	464
25	4219	3861	580	250	207
35	4477	2115	274	105	82
45	2982	697	90	33	21
55	610	194	29	7	3
65	98	42	3	0	0
75	6	2	0	0	0
85	0	0	0	0	0
90	0	0	0	0	0

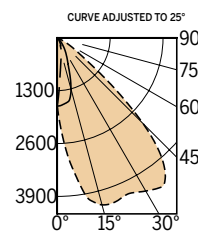

LED manufacturers maintain a tolerance of +/-7% on flux (lumens) and power (electrical) measurements.

LIMITED WARRANTY: CATALOGED KIRLIN FIXTURES ARE WARRANTED FREE OF DEFECTS IN WORKMANSHIP OR MATERIAL FOR FIVE YEARS FROM DATE OF PURCHASE. INSTALLED TO N.E.C. - IN NORMAL USE. Manufacturer at his option will replace or repair such fixture or refund the purchase price on presentation of proof of purchase and defective fixture at the offices of manufacturer within five years of original shipment. Liability of manufacturer is limited to the foregoing, and manufacturer shall not be liable for any other damages, direct or indirect, sustained or suffered by purchaser or any person. This warranty is void where prohibited by law. Seller does not warrant as to merchantability or fitness for a particular use, nor will any oral statement constitute a warranty or amend this specific warranty. Abnormal use, abuse of the fixture, improper installation, or repair, or modification of the fixture without prior written authorization from the manufacturer will render the warranty void.

Symphony Driver Modules

Fully Digital Controlled Power Source for LED Luminaires

Mounted in Kirlin's **SYM-CABNT**

Drivers wired in series



Driver Module	Maximum Capacity	Fixture Load Examples
DVR-1400A	Qty 1: 2500L Luminaires	<ul style="list-style-type: none"> Qty 1: SRR-06610-2500L
DVR-1400B *Not available with DMX dimming	Up to Qty 2: 2500L Luminaires	<ul style="list-style-type: none"> Qty 1: SRR-06610-2500L Qty 2: SRR-06610-2500L Qty 1: SRR-06610-2500L and Qty 1: SRR-07604-2500L
DVR-1050A	Qty 1: 4000L Luminaires	<ul style="list-style-type: none"> Qty 1: SRR-06610-4000L
DVR-1400B *Not available with DMX dimming	Qty 1: 5000L Luminaires	<ul style="list-style-type: none"> Qty 1: SRR-06610-5000L