

| | | |
|-----------|---------|---------|
| CATALOG # | TYPE | |
| JOB NAME | WATTAGE | VOLTAGE |

Symphony Remote Driver Series

Open Appearance 6" Adjustable • LED

Up to 90,000 Hour Life • Type IC • Wet Location

LM-80 Qualified • LM-79 Certified Photometry

SRR-06120

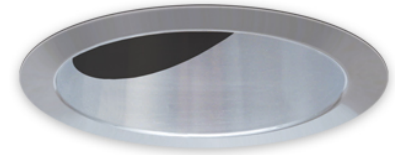

Specifications

Delivered System Performance

- Lumen Series: **MUST SPECIFY**
- 1500L: 1500 nominal lumens (20W)
- Distribution: NFL standard; Optional: -SPT or -MFL
- Color temperature: 3500°K standard; Optional: -27K, -30K, -41K or -50K
- CRI: 80+ standard. Optional: -HC (90+)
- 90,000 hour life (L70) in open plenum; 60,000 hour life in insulation (Type IC)
- Fully sustainable: removable for servicing

Thermal Management System

- All aluminum heat sink, components and housing maximize cool operation and long life while minimizing maintenance

Remote Power Supply Required

- For 0-10V use **SYM-CABNT**
- For DMX with RDM use **SYM-DMXPS**

SmartPower™ Battery Backup

- EMI-21220** for emergency power
- See specification sheet; order separately

Trim

- Clear specular aluminum trim
- Self-flanged, low glare angle-cut cone; tempered glass lens above
- Optional colors and finishes available

Acrylic Enameled Aluminum Housing

- Rustproof and corrosion resistant: Exceeds 1000 hour ASTM 5% salt spray test
- Shallow depth fits restricted plenums
- Cool operation: Extends life of all components
- Fully sustainable: Entire luminaire, including LED light engine, is modular, easily visible and serviced through aperture
- Built-in plaster flange

Outlet Box

- UL listed J-box with insulated removable cover. Prewired 14 GA (NEC) with ½" and ¾" knockouts

Installation

- Requires minimum 16 AWG shielded twisted pair wire from driver to fixtures
- Maximum cable run from driver to fixture is 250'**

- Recess indoor or outdoor
- Accommodates ceilings up to 1½" thick or see Option -79
- Compatible with fire rated enclosures (by others)
- 27" galvanized hanger bars with adjustable mounting brackets (2) supplied

UL, C-UL (Canada) Listings

- Wet, damp or dry locations, covered ceilings
- Type IC: for direct contact with insulation
- Through-branch conductors (4 #12 AWG 90°C) for Type IC Listing

FCC Compliance

- FCC Part 15 certified for EMI/RFI emissions

FIVE YEAR Limited Warranty

- Complete standard fixture (must be used with SYM-CABNT or SYM-DMXPS)



Options and Ordering Configuration

(Example: SRR-06120-1500L-30K-MFL)

| Must Specify | | Optional | | | |
|--------------|--------|---|--|---|---|
| Model | Lumens | Color Temp. (CCT) | Distribution | Lens & Trim | Other Options |
| SRR-06120 | -1500L | (Blank): 3500°K -27K: 2700°K instead -30K: 3000°K instead -41K: 4100°K instead -50K: 5000°K instead -HC: 90+ CRI instead | (Blank): NFL -MFL: Medium flood distribution -SPT: Spot distribution | (Blank): Clear specular trim; lens above -23: Frosted microprismatic lens instead -30T: White enamel (complete trim) -30F: White enamel (flange only) -32: White oversize trim ring; specify O.D. -37F: Dark bronze enamel (flange only) -38F: Black enamel (flange only) -45: Gasket between trim and ceiling -70T: Clear semi-specular SofTex™ (complete trim) -94: Custom color/finish; specify; consult factory -CF: Custom color filter (Rosco); specify -DL: Downlight cone instead; clear specular finish standard or add optional trim selection -WA: White acrylic (flat) diffuser instead | (Blank): None -79: Extension collar for ceilings up to 2" thick -99: Special modification; consult factory -AT: Air tight version; meets ASTM E283 restricted airflow of 2 CFM maximum -RH: Residential mounting hardware instead; suitable for wood joist ceilings with spacing from 14 1/8" to 25 7/8" with 5/8" vertical adjustability |

Dimensions

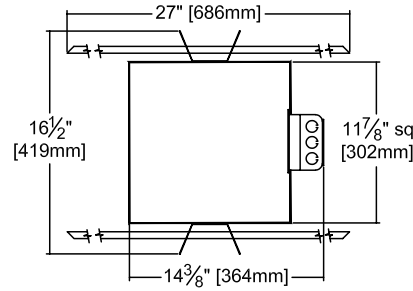
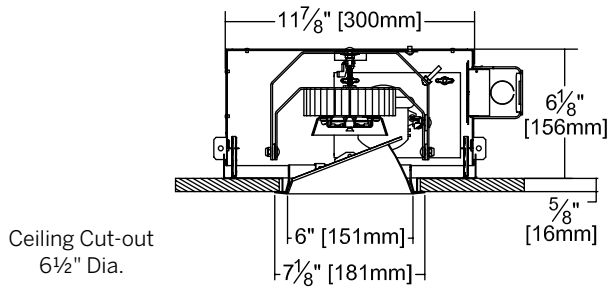

Photometry - Installed Complete Fixture

Photometry from I.T.L., Boulder, CO

LM-79 IESNA Certified Photometry from Independent Lab

-1500L STANDARD (NFL)

Lumens: 1508
Beam: ~37°
SC: 0.6
LPW: 72
Efficiency: 74.6%
ITL Test: 87940

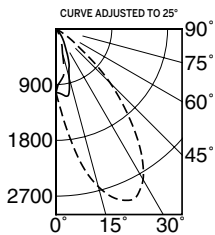

Total System Watts 21.0

| | CANDLEPOWER DISTRIBUTION | | | | |
|----|--------------------------|------|------|-------|-------|
| | 0.0 | 45.0 | 90.0 | 135.0 | 180.0 |
| 0 | 1025 | 1025 | 1025 | 1025 | 1025 |
| 5 | 1498 | 1339 | 1058 | 886 | 844 |
| 15 | 2636 | 1810 | 815 | 475 | 403 |
| 25 | 3015 | 1568 | 397 | 165 | 122 |
| 35 | 2373 | 940 | 172 | 54 | 36 |
| 45 | 1237 | 386 | 50 | 13 | 10 |
| 55 | 270 | 62 | 7 | 1 | 1 |
| 65 | 12 | 5 | 1 | 0 | 0 |
| 75 | 2 | 1 | 0 | 0 | 0 |
| 85 | 0 | 0 | 0 | 0 | 0 |
| 90 | 0 | 0 | 0 | 0 | 0 |

-1500L Option -SPT

Lumens: 1581
Beam: ~18°
SC: 0.3
LPW: 75
Efficiency: 78.2%
ITL Test: 87515

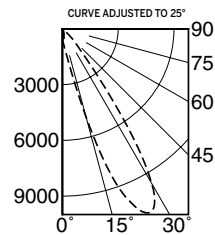

Total System Watts 21.0

| | CANDLEPOWER DISTRIBUTION | | | | |
|----|--------------------------|------|------|-------|-------|
| | 0.0 | 45.0 | 90.0 | 135.0 | 180.0 |
| 0 | 536 | 536 | 536 | 536 | 536 |
| 5 | 886 | 752 | 515 | 403 | 384 |
| 15 | 4904 | 1070 | 247 | 197 | 197 |
| 25 | 10926 | 964 | 115 | 79 | 78 |
| 35 | 4798 | 538 | 64 | 38 | 29 |
| 45 | 739 | 110 | 21 | 7 | 5 |
| 55 | 31 | 10 | 2 | 0 | 0 |
| 65 | 4 | 1 | 0 | 0 | 0 |
| 75 | 0 | 0 | 0 | 0 | 0 |
| 85 | 0 | 0 | 0 | 0 | 0 |
| 90 | 0 | 0 | 0 | 0 | 0 |

-1500L Option -MFL

Lumens: 1559
Beam: ~46°
SC: 0.8
LPW: 74
Efficiency: 77.1%
ITL Test: 87516

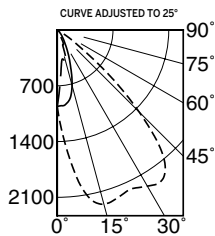

Total System Watts 21.0

| | CANDLEPOWER DISTRIBUTION | | | | |
|----|--------------------------|------|------|-------|-------|
| | 0.0 | 45.0 | 90.0 | 135.0 | 180.0 |
| 0 | 958 | 958 | 958 | 958 | 958 |
| 5 | 1555 | 1372 | 952 | 634 | 533 |
| 15 | 2262 | 2121 | 720 | 469 | 428 |
| 25 | 2200 | 1994 | 322 | 181 | 180 |
| 35 | 2297 | 1104 | 126 | 53 | 47 |
| 45 | 1454 | 361 | 49 | 22 | 18 |
| 55 | 253 | 69 | 14 | 6 | 4 |
| 65 | 8 | 5 | 2 | 1 | 0 |
| 75 | 1 | 0 | 0 | 0 | 0 |
| 85 | 0 | 0 | 0 | 0 | 0 |
| 90 | 0 | 0 | 0 | 0 | 0 |

LED manufacturers maintain a tolerance of +/-7% on flux (lumens) and power (electrical) measurements.

LIMITED WARRANTY: CATALOGED KIRLIN FIXTURES ARE WARRANTED FREE OF DEFECTS IN WORKMANSHIP OR MATERIAL FOR 10 YEARS FROM DATE OF PURCHASE. INSTALLATION, IN NORMAL USE, MANUFACTURER AT HIS OPTION WILL REPLACE OR REPAIR SUCH FIXTURE OR RETURN THE PURCHASER TO THE DATE OF PURCHASE. THIS WARRANTY IS LIMITED TO THE ORIGINAL PURCHASER AND DOES NOT COVER DAMAGE TO THE FIXTURE CAUSED BY IMPROPER INSTALLATION, REPAIR, OR MODIFICATION OF THE FIXTURE WITHOUT PRIOR WRITTEN AUTHORIZATION FROM THE MANUFACTURER. THE WARRANTY WILL BE VOID IF THE FIXTURE IS USED FOR ANY OTHER PURPOSES, DIRECT OR INDIRECT, SUSPECTED OR UNEXPECTED DAMAGE TO THE FIXTURE, OR IF THE FIXTURE IS USED IN AN AREA WHERE THE MANUFACTURER'S WARRANTY IS NOT APPLICABLE. THE WARRANTY IS VOID IF THE FIXTURE IS USED IN AN AREA WHERE THE MANUFACTURER'S WARRANTY IS NOT APPLICABLE. THE WARRANTY IS VOID IF THE FIXTURE IS USED IN AN AREA WHERE THE MANUFACTURER'S WARRANTY IS NOT APPLICABLE.