

CATALOG #	TYPE	
JOB NAME	WATTAGE	VOLTAGE

Symphony Remote Driver Series

Open Appearance 4" Downlight • LED

Up to 60,000 Hour Rated Life • Type IC • Wet Location

LM-80 Qualified • LM-79 Certified Photometry

SRR-04600



Specifications

Delivered System Performance

- Lumen Series: **MUST SPECIFY**
- 2500L: 2500 nominal lumens (35W)
- Distribution: MFL standard; Optional: -SPT or -NFL
- Color temperature: 3500°K standard; Optional: -27K, -30K, -41K or -50K
- CRI: 80+ standard; Optional: -HC (90+)
- 60,000 hour rated life (L70)
- Fully sustainable: removable for servicing

Thermal Management System

- All aluminum heat sink, components and housing maximize cool operation and long life while minimizing maintenance

Remote Power Supply Required

- For 0-10V use **SYM-CABNT**
- For DMX with RDM use **SYM-DMXPS**
- The **Symphony Configurator** can help determine the necessary components

SmartPower™ Battery Backup

- EMI-21220** for emergency power
- See specification sheet; order separately

Trim

- Clear specular aluminum trim
- Self-flanged, low glare cone; prismatic spread lens above
- Optional colors and finishes available

Acrylic Enameled Aluminum Housing

- Rustproof and corrosion resistant: Exceeds 1000 hour ASTM 5% salt spray test
- Shallow depth fits restricted plenums
- Cool operation: Extends life of all components
- Fully sustainable: Entire luminaire, including LED light engine, is modular, easily visible and serviced through aperture
- Built-in plaster flange

Outlet Box

- UL listed J-box with insulated removable cover; prewired 14 GA (NEC) with ½" and ¾" knockouts

Installation

- Requires minimum 16 AWG shielded twisted pair wire from driver to fixtures

• Maximum cable run from driver to fixture is 250'

- Recesses in ceilings up to 1½" thick or see Option -79
- Compatible with fire rated enclosures (by others)
- 27" galvanized hanger bars with adjustable mounting brackets (2) supplied

UL, C-UL (Canada) Listings

- Wet, damp or dry locations, covered ceilings
- Type IC: for direct contact with insulation

FCC Compliance

- FCC Part 15 certified for EMI/RFI emissions

FIVE YEAR Limited Warranty

- Complete standard fixture (must be used with SYM-CABNT or SYM-DMXPS)

Options and Ordering Configuration

(Example: SRR-04600-2500L-30K-NFL)

Must Specify		Optional				
Model	Lumens	Dimming	Color Temp. (CCT)	Distribution	Lens & Trim	Other Options
SRR-04600						
	-2500L	-010V: 0-10V Dimming -DMX: DMX-RDM Dimming	(Blank): 3500°K -27K: 2700°K instead -30K: 3000°K instead -41K: 4000°K instead -50K: 5000°K instead -HC: 90+ CRI instead	(Blank): MFL -NFL: Narrow flood distribution -SPT: Spot distribution	(Blank): Clear specular trim; lens above -13: Clear flat polycarbonate below with prismatic flat lens above -23: Frosted microprismatic lens instead -30T: White enamel (complete trim) -30F: White enamel (flange only) -32: White oversize trim ring. Specify O.D. -33: Decorative Glow Ring; see last page for details -37F: Dark bronze enamel (flange only) -38F: Black enamel (flange only) -45: Gasket between trim and ceiling -70T: Clear semi-specular SofTex™ (complete trim) -94: Custom color/finish; specify; consult factory -WA: White acrylic (flat) diffuser instead	(Blank): None -79: Extension collar for ceilings up to 2" thick -99: Special modification; consult factory -RH: Residential mounting hardware instead; suitable for wood joist ceilings with spacing from 14 1/8" to 25 7/8" with 3/8" vertical adjustability -TA: Top Access for servicing from above ceiling

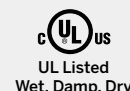

Dimensions

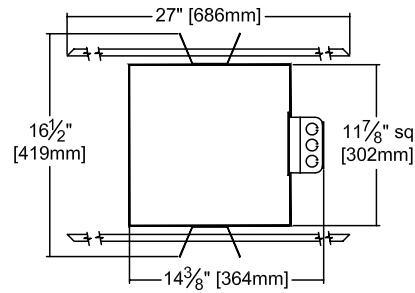
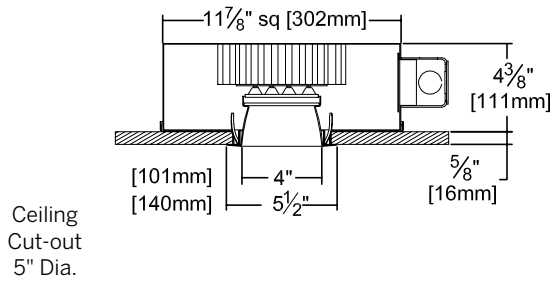

Photometry - Installed Complete Fixture

Photometry from UL Verification Services, Allentown, PA

LM-79 IESNA Certified Photometry from Independent Lab

-2500L STANDARD (MFL)

Lumens: 2838
Beam: ~37°
SC: 0.7
LPW: 78
Efficiency: 76.4%
UL Test: 1259172

Total System Watts 36.4

Cone of Light ▲

Dist.	FC	Dia.
6	138.0	4.4
8	77.4	5.9
10	49.5	7.3
12	34.4	8.8
14	25.3	10.3
16	19.4	11.7

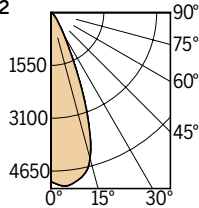

40 CANDLEPOWER DISTRIBUTION					
	0.0	22.5	45.0	67.5	90.0
0	4954	4954	4954	4954	4954
5	5101	5101	5101	5101	5101
15	4419	4419	4419	4419	4419
25	1539	1539	1539	1539	1539
35	411	411	411	411	411
45	154	154	154	154	154
55	40	40	40	40	40
65	2	2	2	2	2
75	1	1	1	1	1
85	0	0	0	0	0
90	0	0	0	0	0

-2500L Option -SPT

Lumens: 2858
Beam: ~14°
SC: 0.3
LPW: 79
Efficiency: 76.9%
UL Test: 1259171

Total System Watts 36.4

Cone of Light ▲

Dist.	FC	Dia.
6	673.0	1.7
8	378.0	2.2
10	242.0	2.8
12	168.0	3.3
14	124.0	3.9
16	94.6	4.4

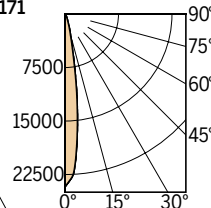

CANDLEPOWER DISTRIBUTION					
	0.0	22.5	45.0	67.5	90.0
0	24210	24210	24210	24210	24210
5	18710	18710	18710	18710	18710
15	2898	2898	2898	2898	2898
25	717	717	717	717	717
35	246	246	246	246	246
45	87	87	87	87	87
55	26	26	26	26	26
65	2	2	2	2	2
75	2	2	2	2	2
85	1	1	1	1	1
90	1	1	1	1	1

-2500L Option -NFL

Lumens: 2726
Beam: ~21°
SC: 0.5
LPW: 75
Efficiency: 73.3%
UL Test: 1264615

Total System Watts 36.4

Cone of Light ▲

Dist.	FC	Dia.
6	200.0	3.1
8	112.0	4.1
10	71.9	5.1
12	49.9	6.1
14	36.7	7.1
16	28.1	8.2

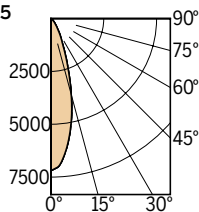

CANDLEPOWER DISTRIBUTION					
	0.0	22.5	45.0	67.5	90.0
0	7192	7192	7192	7192	7192
5	6628	6628	6628	6628	6628
15	3716	3716	3716	3716	3716
25	1292	1292	1292	1292	1292
35	488	488	488	488	488
45	173	173	173	173	173
55	57	57	57	57	57
65	2	2	2	2	2
75	1	1	1	1	1
85	0	0	0	0	0
90	0	0	0	0	0

▲ Cone of Light Key

Dist. (in ft.) shown is where FC value is half the FC at nadir.

FC Footcandles at nadir (0°)
Dia. Circle of light at 50% of FC

LED manufacturers maintain a tolerance of +/-7% on flux (lumens) and power (electrical) measurements.

Symphony Driver Modules

Fully Digital Controlled Power Source for LED Luminaires

Mounted in Kirlin's **SYM-CABNT**

Drivers wired in series



Driver Module	Maximum Capacity	Fixture Load Examples
DVR-1400A	Qty 1: 2500L Luminaires	<ul style="list-style-type: none">• Qty 1: SRR-04600-2500L
DVR-1400B *Not available with DMX dimming	Up to Qty 2: 2500L Luminaires	<ul style="list-style-type: none">• Qty 1: SRR-04600-2500L• Qty 2: SRR-04600-2500L• Qty 1: SRR-04600-2500L and Qty 1: SRR-06602-2500L

Classic Glow Rings: Option -33 for Symphony Remote Driver Series

To order a Kirlin Glow Ring, begin by adding -33 to the product number. Then, configure your Glow Ring by selecting each of the 7 design elements listed below:

(Example: SRR-04600-2500L-30K-**33-GLM-1L-FRR-ROF-SIF-ROS-SIS**)

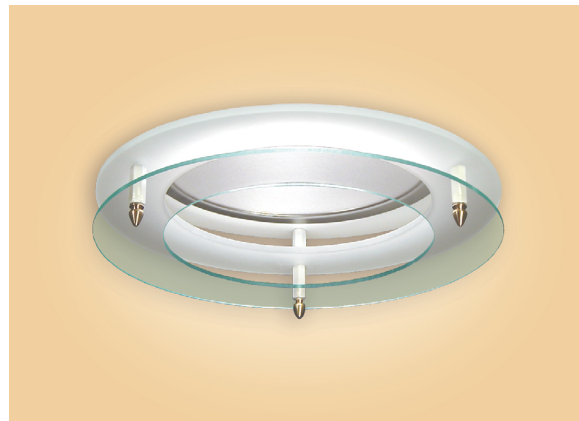

1. Ring Material (choose one)



Glass (-GLM)



Acrylic (-ACM)



Custom (-CUM)

2. # of Rings (choose one)

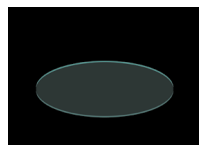

1 Ring (1L)

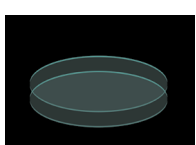

2 Rings (-2L)

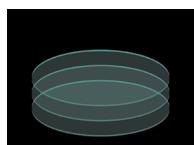

3 Rings (-3L)

3. Ring Design (choose one)



Frosted Ring (-FRR)



Clear Ring (-CRR)

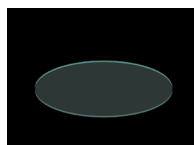

Solid Disk (-SDR)

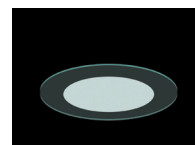

Frosted Center (-FCR)

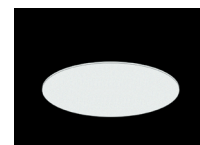

Frosted Disk (-FDR)

4. Finial Design (choose one)

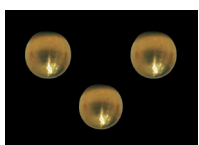

Round (-ROF)



Knurled (-KNF)



Cone (-COF)

5. Finial Color (choose one)



Brass (-BRF)



Silver (-SIF)



Black (-BLF)



White (-WHF)



Custom (-CUF)

6. Standoff Design (choose one)

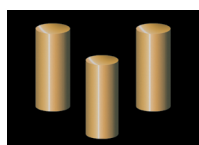

Round (-ROS)

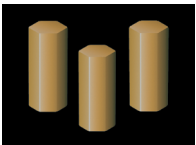

Hexagonal (-HOS)

7. Standoff Color (choose one)



Brass (-BRS)



Silver (-SIS)



Black (-BLS)



White (-WHS)



Custom (-CFS)

LED manufacturers maintain a tolerance of +/-7% on flux (lumens) and power (electrical) measurements.