

CATALOG #	TYPE	
JOB NAME	WATTAGE	VOLTAGE

Symphony Remote Driver Series

Lensed 4" Wall Wash • LED

Up to 90,000 Hour Rated Life • Type IC • Wet Location
LM-80 Qualified • LM-79 Certified Photometry

SRR-04110

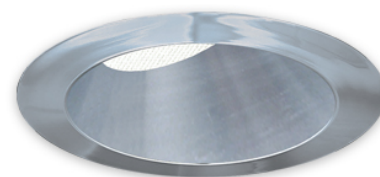

Specifications

Delivered System Performance

- Lumen Series: **MUST SPECIFY**
- 1500L: 1500 nominal lumens (20W)
- Color temperature: 3500°K standard; Optional: -27K, -30K, -41K or -50K
- CRI: 80+ standard; Optional: -HC (90+)
- 90,000 hour rated life (L70) in open plenum; 60,000 hour rated life in insulation (Type IC)
- Fully sustainable: removable for servicing
- Center beam optics positioned at 25°

Thermal Management System

- All aluminum heat sink, components and housing maximize cool operation and long life while minimizing maintenance

Remote Power Supply Required

- For 0-10V use **SYM-CABNT**
- For DMX with RDM use **SYM-DMXPS**
- The **Symphony Configurator** can help determine the necessary components

SmartPower™ Battery Backup

- EMI-21220** for emergency power
- See specification sheet; order separately

Trim

- Clear specular aluminium trim
- Self-flanged, low glare cone; prismatic spread lens above
- Optional colors and finishes available

Acrylic Enameled Aluminum Housing

- Rustproof and corrosion resistant: Exceeds 1000 hour ASTM 5% salt spray test
- Shallow depth fits restricted plenums
- Cool operation: Extends life of all components
- Fully sustainable: Entire luminaire, including LED light engine, is modular, easily visible and serviced through aperture
- Built-in plaster flange

Outlet Box

- UL listed J-box with insulated removable cover; prewired 14 GA (NEC) with ½" and ¾" knockouts

Installation

- Requires minimum 16 AWG shielded twisted pair wire from driver to fixtures
- Maximum cable run from driver to fixture is 250'**

- Recess indoor or outdoor
- Accommodates ceilings up to 1½" thick
- Compatible with fire rated enclosures (by others)
- 27" galvanized hanger bars with adjustable mounting brackets (2) supplied

UL, C-UL (Canada) Listings

- Wet, damp or dry locations, covered ceilings
- Type IC: for direct contact with insulation
- Through-branch conductors (4 #12 AWG 90°C) for Type IC Listing

FCC Compliance

- FCC Part 15 certified for EMI/RFI emissions

FIVE YEAR Limited Warranty

- Complete standard fixture (must be used with SYM-CABNT or SYM-DMXPS)



Options and Ordering Configuration

(Example: SRR-04110-1500L-30K-38F)

Must Specify		Optional			
Model	Lumens	Dimming	Color Temp. (CCT)	Lens & Trim	Other Options
SRR-04110					
	-1500L	-010V: 0-10V Dimming -DMX: DMX-RDM Dimming	(Blank): 3500°K -27K: 2700°K instead -30K: 3000°K instead -41K: 4000°K instead -50K: 5000°K instead -HC: 90+ CRI instead	(Blank): Clear specular trim; lens above -30T: White enamel (complete trim) -30F: White enamel (flange only) -32: White oversize trim ring; specify O.D. -37F: Dark bronze enamel (flange only) -38F: Black enamel (flange only) -45: Gasket between trim and ceiling -70T: Clear semi-specular SofTex™ (complete trim) -94: Custom color/finish; specify; consult factory -CF: Custom color filter (Rosco); specify	(Blank): None -99: Special modification; consult factory -AT: Air tight version; meets ASTM E283 restricted airflow of 2 CFM maximum -RH: Residential mounting hardware instead; suitable for wood joist ceilings with spacing from 14 ½" to 25 ⅞" with ⅝" vertical adjustability

Dimensions

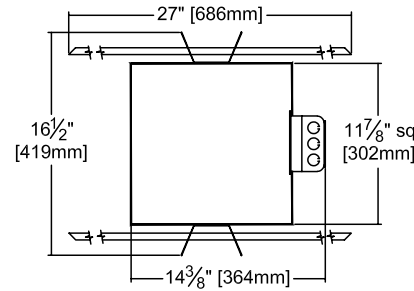
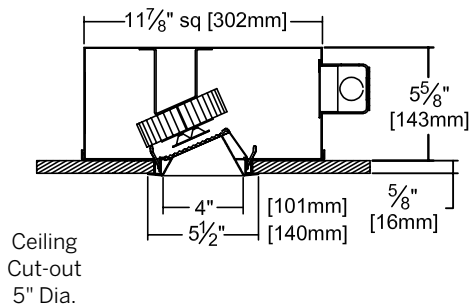

Photometry - Installed Complete Fixture

Photometry from I.T.L., Boulder, CO

LM-79 IESNA Certified Photometry from Independent Lab

-1500L STANDARD

Lumens: 1375
LPW: 66
Efficiency: 68.0%
ITL Test: 87229

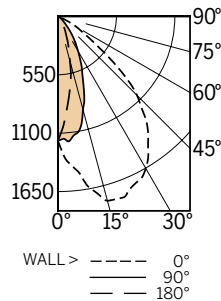

Total System Watts 20.8

DISTANCE FROM CEILING IN FEET	SINGLE FIXTURE					MULTIPLE FIXTURES					
	1'	2'	3'	4'		2' CENTERS		3' CENTERS			
	FIXTURE INSTALLED 2' FROM WALL										
	Footcandle Distribution on Wall Surface										
1	18.0	3.9	0.8	0.6	0.4	21.9	22.0	22.0	20.2	4.0	20.1
2	93.6	45.9	8.2	1.4	0.5	112.0	112.0	112.0	95.7	43.3	95.7
3	66.3	45.8	16.5	4.3	1.1	102.0	102.0	102.0	75.9	60.3	75.9
4	39.2	31.0	15.7	6.1	2.1	76.3	76.4	76.4	52.4	49.3	52.4
5	23.3	19.7	12.1	6.1	2.7	54.7	54.7	54.7	36.6	36.3	36.6
6	14.9	13.2	9.0	5.3	2.8	40.8	40.8	40.8	27.5	27.1	27.5
7	10.0	9.2	6.8	4.5	2.7	31.8	31.9	31.9	21.1	21.1	21.1
8	7.1	6.7	5.3	3.8	2.5	26.0	26.1	26.0	17.1	17.2	17.1
9	5.5	5.3	4.5	3.4	2.3	22.7	22.8	22.8	14.7	15.1	14.7

LED manufacturers maintain a tolerance of +/-7% on flux (lumens) and power (electrical) measurements.

Symphony Driver Modules

Fully Digital Controlled Power Source for LED Luminaires

Mounted in Kirlin's **SYM-CABNT**

Drivers wired in series



Driver Module	Maximum Capacity	Fixture Load Examples
DVR-1400A	Up to Qty 2: 1500L Luminaires	<ul style="list-style-type: none"> Qty 1: SRR-04110-1500L Qty 2: SRR-04110-1500L Qty 1: SRR-04110-1500L and Qty 1: SRR-04405-1500L
DVR-1400B *Not available with DMX dimming	Up to Qty 3: 1500L Luminaires	<ul style="list-style-type: none"> Qty 3: SRR-04110-1500L Qty 2: SRR-04110-1500L and Qty 1: SRR-04405-1500L

LIMITED WARRANTY: CATALOGED KIRLIN FIXTURES ARE WARRANTED FREE OF DEFECTS IN WORKMANSHIP OR MATERIAL FOR ONE YEAR FROM DATE OF PURCHASE. INSTALLATION, E.G., IN NORMAL USE. Manufacturer at his option will replace or repair such fixture or refund the purchase price on presentation of proof of purchase and defective fixture at the offices of manufacturer within five years of original shipment. Liability of manufacturer is limited to the foregoing and manufacturer shall not be liable for any other damages, direct or indirect, sustained or suffered by purchaser or any person. This warranty is supplied to the buyer in place of all other warranties, expressed or implied. Seller does not warrant as to merchantability or fitness for a particular use, nor will any oral statement constitute a warranty or amend this specific warranty. Abnormal use, abuse of the fixture, improper installation, or repair or modification of the fixture without prior written authorization from the manufacturer will render the warranty void.