

CATALOG #	TYPE	
JOB NAME	WATTAGE	VOLTAGE

## Symphony Remote Driver Series

### Open Appearance 4" Adjustable • LED

Up to 90,000 Hour Rated Life • Type IC • Wet Location

LM-80 Qualified • LM-79 Certified Photometry

## Specifications

### Delivered System Performance

- Lumen Series: **MUST SPECIFY**
- 1500L: 1500 nominal lumens (20W)
- Distribution: NFL standard;  
Optional: -SPT or -MFL
- Color temperature: 3500°K standard;  
Optional: -27K, -30K, -41K or -50K
- CRI: 80+ standard; Optional: -HC (90+)
- 90,000 hour rated life (L70) in open plenum;  
60,000 hour rated life in insulation (Type IC)
- Fully sustainable: removable for servicing

### Center Beam Optics

- Tilts up to 35°
- Rotates full 360° and locks in place
- Accommodates sloped ceilings up to 45°

### Thermal Management System

- All aluminum heat sink, components and housing maximize cool operation and long life while minimizing maintenance

### Remote Power Supply Required

- For 0-10V use **SYM-CABNT**
- For DMX with RDM use **SYM-DMXPS**
- The **Symphony Configurator** can help determine the necessary components

### SmartPower™ Battery Backup

- EMI-21220** for emergency power
- See specification sheet; order separately

### Trim

- Clear specular aluminum trim
- Self-flanged, low glare cone with lens above
- Optional colors and finishes available

### Acrylic Enameled Aluminum Housing

- Rustproof and corrosion resistant: Exceeds 1000 hour ASTM 5% salt spray test
- Shallow depth fits restricted plenums
- Cool operation: Extends life of all components
- Fully sustainable: Entire luminaire, including LED light engine, is modular, easily visible and serviced through aperture
- Built-in plaster flange

### Outlet Box

- UL listed J-box with insulated removable cover; prewired 14 GA (NEC) with ½" and ¾" knockouts

### Installation

- Requires minimum 16 AWG shielded twisted pair wire from driver to fixtures

## SRR-04105

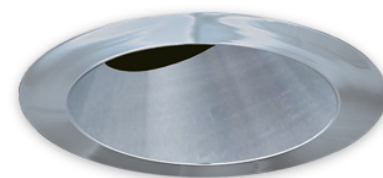

### • Maximum cable run from driver to fixture is 250'

- Recess indoor or outdoor
- Accommodates ceilings up to 1½" thick or see Option -79
- Compatible with fire rated enclosures (by others)
- 27" galvanized hanger bars with adjustable mounting brackets (2) supplied

### UL, C-UL (Canada) Listings

- Wet, damp or dry locations, covered ceilings
- Type IC: for direct contact with insulation
- Through-branch conductors (4 #12 AWG 90°C) for Type IC Listing

### FCC Compliance

- FCC Part 15 certified for EMI/RFI emissions

### FIVE YEAR Limited Warranty

- Complete standard fixture (must be used with SYM-CABNT or SYM-DMXPS)



## Options and Ordering Configuration

(Example: SRR-04105-1500L-30K-MFL)

Must Specify		Optional			
Model	Lumens	Color Temp. (CCT)	Distribution	Lens & Trim	Other Options
SRR-04105					
	-1500L	(Blank): 3500°K -27K: 2700°K instead -30K: 3000°K instead -41K: 4000°K instead -50K: 5000°K instead -HC: 90+ CRI instead	(Blank): NFL -MFL: Medium flood distribution -SPT: Spot distribution	(Blank): Clear specular trim; lens above -30T: White enamel (complete trim) -30F: White enamel (flange only) -32: White oversize trim ring; specify O.D. -37F: Dark bronze enamel (flange only) -38F: Black enamel (flange only) -45: Gasket between trim and ceiling -70T: Clear semi-specular SofTex™ (complete trim) -94: Custom color/finish; specify; consult factory -CF: Custom color filter (Rosco); specify -DL: Downlight trim instead; clear specular finish standard or add optional trim selection	(Blank): None -79: Extension collar for ceilings up to 2" thick -99: Special modification; consult factory -AT: Air tight version; meets ASTM E283 restricted airflow of 2 CFM maximum -RH: Residential mounting hardware instead; suitable for wood joist ceilings with spacing from 14 ½" to 25 ⅞" with ⅝" vertical adjustability -TA: Top Access for servicing from above ceiling

## Dimensions

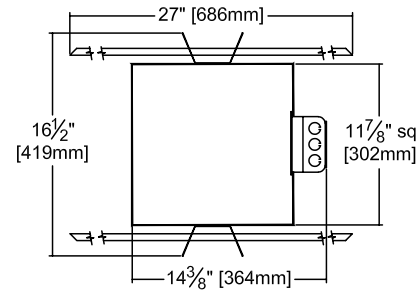
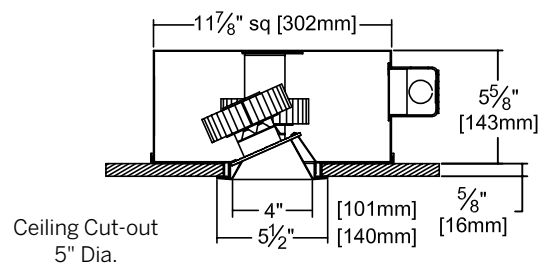

## Photometry - Installed Complete Fixture

Photometry from I.T.L., Boulder, CO

LM-79 IESNA Certified Photometry from Independent Lab

### -1500L STANDARD (NFL)

Lumens: 1564  
Beam: ~27°  
SC: 0.5  
LPW: 75  
Efficiency: 77.3%  
ITL Test: 87186

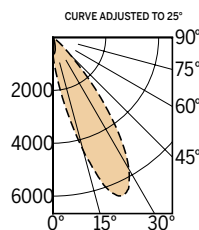

Total System Watts 20.8

CANDLEPOWER DISTRIBUTION					
	0.0	45.0	90.0	135.0	180.0
0	628	628	628	628	628
5	1313	1071	610	359	291
15	4402	2006	324	100	70
25	6503	1548	108	35	25
35	4202	700	37	13	10
45	949	140	10	3	3
55	73	11	1	1	0
65	1	1	0	0	0
75	0	0	0	0	0
85	0	0	0	0	0
90	0	0	0	0	0

### -1500L Option -SPT

Lumens: 1566  
Beam: ~24°  
SC: 0.4  
LPW: 75  
Efficiency: 77.4%  
ITL Test: 87185

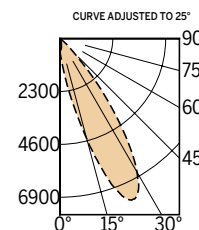

Total System Watts 20.8

CANDLEPOWER DISTRIBUTION					
	0.0	45.0	90.0	135.0	180.0
0	510	510	510	510	510
5	1084	862	489	289	242
15	4525	1774	244	85	62
25	7693	1397	86	31	23
35	4626	587	32	12	9
45	845	117	9	4	3
55	57	10	1	1	0
65	0	0	0	0	0
75	0	0	0	0	0
85	0	0	0	0	0
90	0	0	0	0	0

### -1500L Option -MFL

Lumens: 1557  
Beam: ~43°  
SC: 0.8  
LPW: 75  
Effic: 77.0%  
ITL Test: 87187

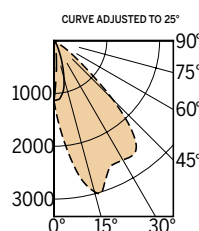

Total System Watts 20.8

CANDLEPOWER DISTRIBUTION					
	0.0	45.0	90.0	135.0	180.0
0	1133	1133	1133	1133	1133
5	1807	1635	1113	641	534
15	2961	2446	729	184	124
25	2601	1996	242	61	41
35	2631	1034	67	21	15
45	1571	284	20	7	4
55	288	34	3	1	1
65	2	1	0	0	0
75	0	0	0	0	0
85	0	0	0	0	0
90	0	0	0	0	0

LED manufacturers maintain a tolerance of +/-7% on flux (lumens) and power (electrical) measurements.

Symphony Driver Modules

Fully Digital Controlled Power Source for LED Luminaires

Mounted in Kirlin's **SYM-CABNT**

Drivers wired in series



Driver Module	Maximum Capacity	Fixture Load Examples
DVR-1400A	Up to Qty 2: 1500L Luminaires	<ul style="list-style-type: none"><li>• Qty 1: SRR-04105-1500L</li><li>• Qty 2: SRR-04105-1500L</li><li>• Qty 1: SRR-04100-1500L and Qty 1: SRR-04405-1500L</li></ul>
DVR-1400B *Not available with DMX dimming	Up to Qty 4: 1500L Luminaires	<ul style="list-style-type: none"><li>• Qty 3: SRR-04105-1500L</li><li>• Qty 4: SRR-04105-1500L</li><li>• Qty 2: SRR-04100-1500L and Qty 2: SRR-04405-1500L</li></ul>