

Regressed Lens: 200 Watt Incandescent Equivalent

Features

Lamps

- Designed for:
2 horizontal Quad 26 watt.
- 2 pin G24d-3 base.
- See Option -43 for lower wattage.

Ballast

- Thermally protected, encased and potted standard.
- High power factor standard.
- Single circuit wiring. Optional two-circuit wiring. (See Option -84)
- 120 volt standard or see optional voltages.
- Dimming optional. (See Option -89)
- Electronic ballast. (See Option -90)
- Visible and/or serviced.

Fuse

- Available as `CFLAGS` or `-DFD` (double)

Reflecto

- GlasSurfaced™ multi-faceted specular aluminum.

Trim Assembly

- Tapered black OptiGroove with self-flanged trim.
- Regressed prismatic, tempered low brightness C#73 spread distribution.
- Torsion springs retain snug fit.

- White grooveless flare trim or eggcrate louver available. (See Options)
- Acrylic or fresnel lens; anopal or polycarbonate available. (See Options)

Housing

- Acrylic enameled aluminum
- Cool: Dissipates heat from the surface area. Very durable.
- Dust proof: Endures 1000 hours of dust spray test.
- Entire luminaires serviceable through removable front panel.
- New 1" outlet box: 14GA. 1600 series sized steel. 1/4" hole for cable possible through fixed frame.
- Built-in cast frame.

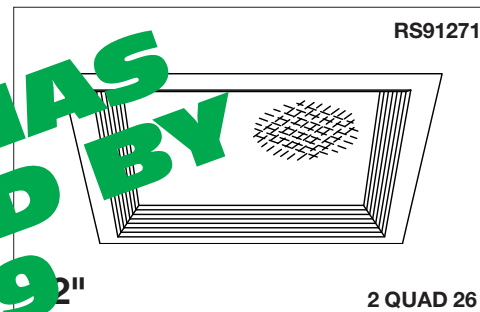

Dimming / Electronic Optional

Performance at a Glance

RS91271

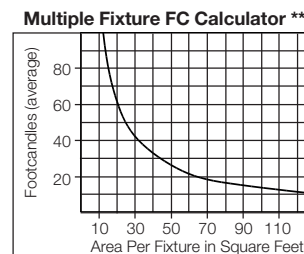
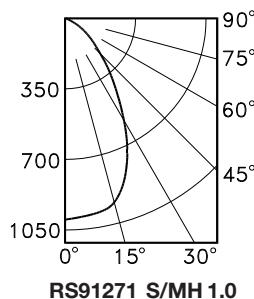
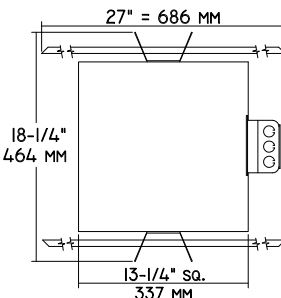
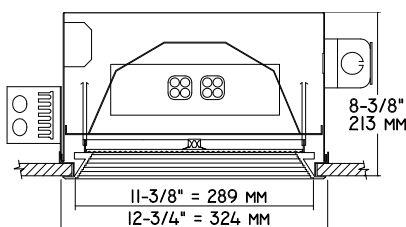

Cone of Light Key

- Ft.** Distance from fixture
FC Footcandles (average)
Dia. Circle of light at 50% of FC

* Dia. (in ft.) shown is where FC value is half the FC at nadir.

** Based on RCR2; ceiling 70%; wall 50%; floor 20%. Use S/MH shown for each fixture.

Distribution curves and S/MH data shown are 90° to lamp axis.

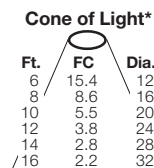

RS91271

THE KIRLIN COMPANY

3401 EAST JEFFERSON AVENUE • DETROIT, MICHIGAN 48207-4232
(313) 259-6400 • Fax: (313) 259-9409 OR (313) 259-3121

**CENTURY SERIES
ARCHITECTURAL
COMPACT FLUORESCENT LIGHTING**

MAXIMUM WATTAGE

CATALOG NUMBER

2 Quad 26

RS91271

THE KIRLIN COMPANY RESERVES THE RIGHT TO CHANGE, WITHOUT NOTICE, DETAILS OR SPECIFICATIONS IN PRODUCT DESIGN.

RS91271

RECESSED SQUARE: QUAD 26 WATT COMPACT FLUORESCENT

KIRLIN

Detailed Photometry - Installed Fixture

FROM I.T.L. (BOULDER, CO) TEST NUMBER 36506

CANDLEPOWER DISTRIBUTION

	0.0	45.0	90.0	135.0	180.0
0	970	970	970	970	970
5	950	958	968	970	961
15	858	888	917	919	884
25	684	714	755	740	704
35	444	479	480	498	445
45	222	260	221	260	219
55	96	110	99	108	92
65	39	44	44	47	39
75	17	20	20	18	17
85	0	0	0	0	0
95	0	0	0	0	0

RS91271

*LER = 18.9

•AEC = \$12.69

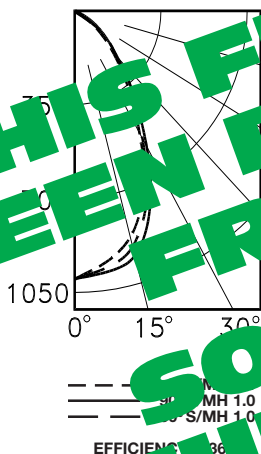

COEFFICIENTS OF UTILIZATION

RF	20	30	40	50	60	70	80	90	100
1	4	9	14	19	24	29	34	39	44
2	9	18	27	36	45	54	63	72	81
3	14	27	40	53	66	79	92	105	118
4	19	36	54	72	90	108	126	144	162
5	24	45	68	90	113	136	159	182	205
6	29	54	81	108	136	164	192	220	248
7	34	63	92	126	159	192	225	258	291
8	39	72	105	144	182	220	258	296	334
9	44	81	118	162	205	248	291	334	377
10	49	90	136	182	225	268	311	354	397

* LER = Luminaire Efficiency Rating

LER = Luminaire Effic. x Total Lamp Lumens x Ballast Factor
Input WattsAEC = Annual Energy Cost per
lumens (based on 3000
hours use @ \$0.08 KWH).

Options

- 13 Clear 1/8" flat polycarbonate below, with tempered prismatic flat C#73 lens above.
- 17 Prismatic 3/16" high strength acrylic instead.
- 18 Anopal flat glass. Not enameled. Diffusing.
- 20 White 1/2" cube eggcrate aluminum louver.
- 21 White translucent flat polycarbonate instead.
- 39 Installed Quad electronic dimming ballast. consult factory for quantity and type required. Also see Options -LE and -WD. Indoor use.
- 40 White grooveless flare trim with regressed tempered C#73 or specify optional lens.
- 43 Lower wattage: Specify 2Q18 or 2TT13.
- 45 Gasket between trim and ceiling.
- 46 Gasket between trim and lens.
- 58 277 volt 60 Hz. ballast instead.
- 73 Internal emergency "Ni-Cad" battery pack

- concealed in housing. Controls one lamp. Switch and visible light located above lens. For indoor use.
- 74 Internal 2 lamp emergency "Ni-Cad" battery pack for use with 4-pin electronic lamps only. Use with Option -96. Indoor use.
- 84 Fixture wired for two circuits. See Options -FD and -RD.
- 94 Custom color trim assembly. Consult factory.
- 96 Regulating electronic high power factor 0°F single circuit Quad ballast instead. See Options -74, -84 and -LE.
- 97 Other voltage ballast. Consult factory.
- 98 347 volt 50 Hz. ballast instead. Consult factory for dimming.
- 99 Special modification. Consult factory.
- FD Double Fused primary. One per ballast. Replaceable. For use with Option -84.

- FR Fresnel tempered lens instead. Concentric prisms.
- FS Fused primary. One per fixture. Replaceable. Aids servicing.
- LE With 4-pin electronic lamps for use with Options -39, -74 or -96. 2700°K or consult factory. Specify wattage and color temperature.
- LP With lamps. 2700°K or consult factory. Specify wattage and color temperature. Also see -LE.
- RD Double radio interference filter. For use with Option -84.
- RF Radio interference filter. Eliminates line feedback.
- WD Wall Dimmer for use with Option -39.

SUBMITTAL DATA

APPROVAL STAMP

JOB NAME _____

TYPE _____

WATTAGE _____ VOLTAGE _____

CATALOG NUMBER _____