

Type IC PAR 38 Halogen Open Square

Features

Lamp / Socket

- Designed for:
120 watt (max.) Par 38 tungsten halogen lamp (by others).
- Rated 4200 hour life; 100 CRI.
- Dimmable (controls by others).
- Glazed porcelain medium base socket.

Reflector

- Low brightness specular Alzak® aluminum in cast aluminum white trim frame.

Housing

- Acrylic enameled 100% aluminum.
- Rustproof: Exceeds 1000 hour ASTM 5% salt spray test.
- Cool: Dissipates heat across entire surface area.
- Entire luminaire visible and serviceable from below through removable reflector.
- Built-in plaster frame.

Outlet Box

- Prewired 14 GA (NEC) galvanized steel. UL listed. With removable insulated cover.

- 1/2" and 3/4" knockouts.

Installation

- 27" galvanized hanger bars supplied (2).
- Fully adjustable universal galvanized mounting brackets supplied (2). Accepts 3/4" or 1-1/4" lathers channel or 1/2" T.S. conduit.
- Recesses indoor or outdoor in covered ceilings.

UL, C-UL (Canada) Listings

- Wet, damp or dry locations, covered ceilings.
- Through-branch circuit conductors (6 #12 AWG 90°C).
- Type IC - Approved for direct contact with insulation.

Three Year Limited Warranty

- Complete standard fixture.

Thermal Protection (Per Current NEC)

- Thermal protector included which provides automatic cut-off if rated wattage is exceeded.

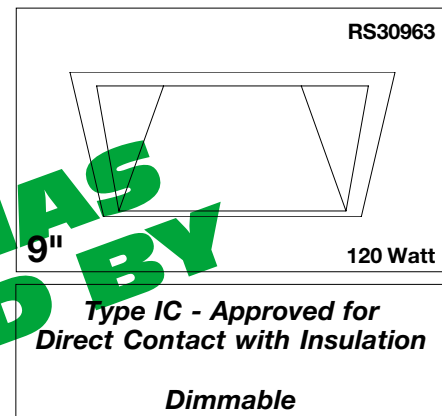

Performance at a Glance

RS30963

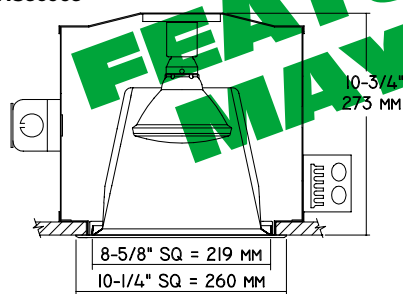

RS30963 (120W Flood Shown)

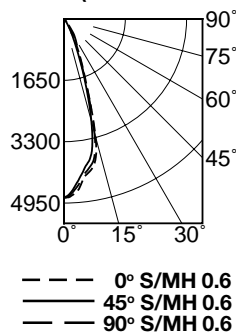

Cone of Light*

Ft.	FC	Dia.
6	133.4	3.5
8	75.0	4.6
10	48.0	5.8
12	33.4	7.0
14	24.5	8.1
16	18.8	9.3

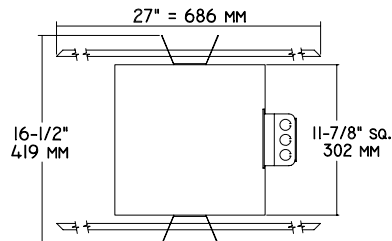

Cone of Light Key

- Ft. Distance from fixture
- FC Footcandles (average)
- Dia. Circle of light at 50% of FC
- * Dia. (in ft.) shown is where FC value is half the FC at nadir.

THE KIRLIN COMPANY

3401 EAST JEFFERSON AVENUE • DETROIT, MICHIGAN 48207-4232
(313) 259-6400 • Fax: (313) 259-9409 OR (313) 259-3121

NEW MILLENNIUM
TUNGSTEN HALOGEN and
INCANDESCENT LIGHTING

PAR 38

120

RS30963

THE KIRLIN COMPANY RESERVES THE RIGHT TO CHANGE, WITHOUT NOTICE, DETAILS OR SPECIFICATIONS IN PRODUCT DESIGN.

Alzak® is a registered trademark of ALCOA.

RS30963

RECESSED SQUARE: 120 WATT (MAX.) PAR 38 HALOGEN TYPE IC DOWNLIGHT

Detailed Photometry - Installed Fixture

FROM I.T.L. (BOULDER, CO) TEST NUMBER 47039

RS30963 120W FL

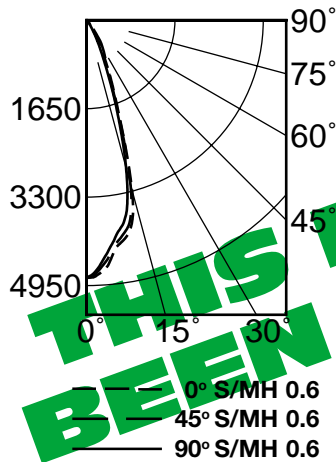

EFFICIENCY = 93.5%

Estimated Multiplier

-30 All white: CP x .98

CANDLEPOWER DISTRIBUTION

	0.0	22.5	45.0	67.5	90.0
0	4803	4803	4803	4803	4803
5	4591	4549	4478	4416	4368
15	3272	3106	3164	3090	2848
25	832	875	871	782	629
35	147	166	318	151	121
45	43	49	23	44	31
5	0	0	0	0	0
35	0	0	0	0	0
75	0	0	0	0	0
85	0	0	0	0	0
90	0	0	0	0	0

COEFFICIENTS OF UTILIZATION

RF	BC	50	30	20	10	5
1	107	105	103	101	99	98
2	103	99	96	94	95	93
3	99	94	91	88	91	88
4	96	90	86	83	87	84
5	92	86	82	78	84	80
6	89	82	78	75	80	77
7	86	79	75	71	77	74
8	83	76	71	68	74	71
9	80	73	69	66	72	68
10	77	70	66	63	69	66

Options

- 30 All white reflector. (CP x .98)
- 32 Trim extender. Broadens trim flange O.D. by 1" to cover larger ceiling opening.

- 45 Gasket above reflector flange. Stops dust streaks on ceiling.
- 94 Custom color trim frame or reflector. Consult factory.

- 99 Special modification. Consult factory.
- LP With PAR 38 lamp. Specify wattage, beam spread and color temperature.

SUBMITTAL DATA

JOB NAME _____

TYPE _____

WATTAGE _____ VOLTAGE _____

CATALOG NUMBER _____

APPROVAL STAMP

LIMITED WARRANTY: CATALOGED KIRLIN FIXTURES ARE WARRANTED FREE OF DEFECTS IN WORKMANSHIP OR MATERIAL FOR THREE YEARS FROM DATE OF PURCHASE. INSTALLATION, IN NORMAL USE. Manufacturer at the option will replace or repair such fixture or refund the purchase price or presentation of proof of purchase and defective fixture at the offices of manufacturer within three years of original shipment. Liability of manufacturer is limited to the foregoing, and manufacturer shall not be liable for any other damages, direct or indirect, sustained or suffered by purchaser or any person. This warranty is supplied from the manufacturer will render this warranty void.