

150, 300 Watt Square Regressed Lens

Features

Lamp / Socket

- Designed for:
 - RS20933: Horizontal 150 watt (max.) A-21 inside frosted incandescent lamp (by others).
 - RS21234: Horizontal 300 watt (max.) PS-25 inside frosted incandescent lamp (by others).
- Dimmable (controls by others).
- Glazed porcelain medium base socket.

Reflector

- GlasSurfaced™ multi-faceted specular aluminum. Highly efficient.

Trim Assembly

- Tapered black OptiGroove with white flange.
- Self-flanged trim.
- Regressed tempered prismatic low brightness C#73 spread distribution lens.
- Torsion springs retain snug fit to ceiling.
- White grooveless flare trim available. (See Option -40)
- Anopal, vandal resistant or fresnel lens available. Eggcrate louver optional. See Options.

Housing

- Acrylic enameled 100% aluminum.
- Rustproof: Exceeds 1000 hour ASTM 5% salt spray test.

- Cool: Dissipates heat across entire surface area.
- Entire luminaire serviced through removable trim assembly.
- Built-in plaster frame.

Outlet Box

- Prewired 14GA (NEC) galvanized steel. UL listed. With removable insulated cover.
- 1/2" and 3/4" knockouts.

Installation

- 27" galvanized hanger bars supplied (2).
- Fully adjustable universal galvanized mounting brackets supplied (2). Accepts 3/4" or 1-1/4" lathers channel or 1/2" T.S. conduit.
- Recesses indoor or outdoor in covered ceilings.

UL, C-UL (Canada) Listings

- Wet, damp or dry locations, covered ceilings.
- Through-branch circuit conductors (6 #12 AWG 90°C).

Three Year Limited Warranty

- Complete standard fixture.

Thermal Protection (Per Current NEC)

- Thermal protector included which provides automatic cut-off if rated temperature is exceeded. (Insulation related)

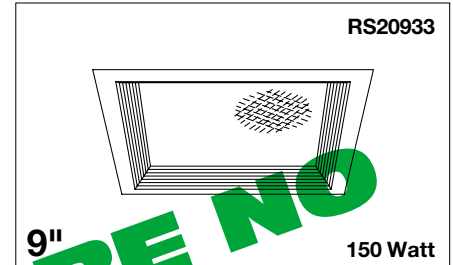

9"

150 Watt

Higher Incandescent Output
Shallow Housing Depth

Attractive Ceiling Appearance

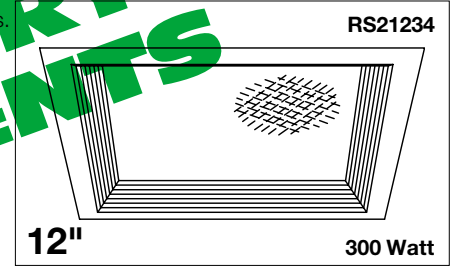

12"

300 Watt

Performance at a Glance

RS20933

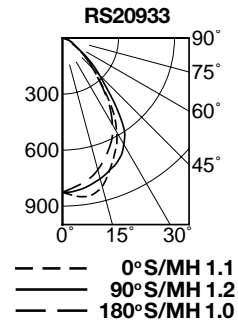
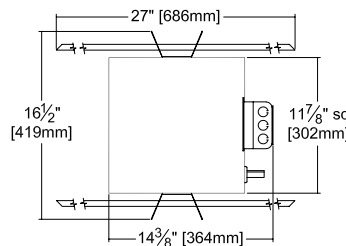
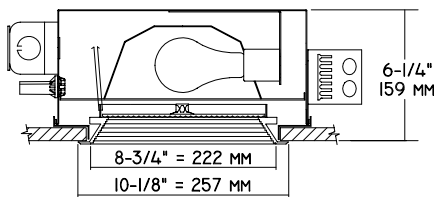

Cone of Light*

Ft.	FC	Dia.
6	22.9	6.6
8	12.9	8.9
10	8.3	11.1
12	5.7	13.3
14	4.2	15.5
16	3.2	17.7

Cone of Light Key
 Ft. Distance from fixture
 FC Footcandles (average)
 Dia. Circle of light at 50% of FC

RS21234

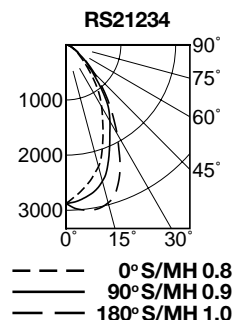
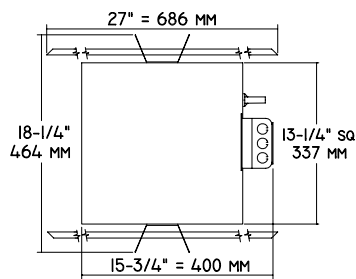
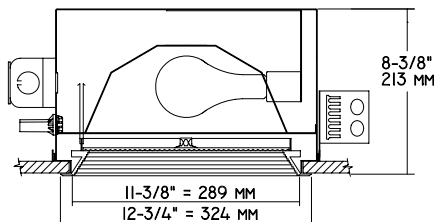

Cone of Light*

Ft.	FC	Dia.
6	79.9	5.7
8	45.0	7.6
10	28.8	9.5
12	20.0	11.4
14	14.7	13.3
16	11.2	15.3

* Dia. (in. ft.) shown is where FC value is half the FC at nadir.

THE KIRLIN COMPANY

3401 EAST JEFFERSON AVENUE • DETROIT, MICHIGAN 48207-4232
 (313) 259-6400 • Fax: (313) 259-9409 OR (313) 259-3121

NEW MILLENNIUM

TUNGSTEN HALOGEN and
INCANDESCENT LIGHTING

LAMP

**A-21
PS-25**

MAXIMUM WATTAGE

**150
300**

CATALOG NUMBERS

**RS20933
RS21234**

THE KIRLIN COMPANY RESERVES THE RIGHT TO CHANGE, WITHOUT NOTICE, DETAILS OR SPECIFICATIONS IN PRODUCT DESIGN.

**RS20933
RS21234**

RECESSED SQUARE: 150 A-21 / 300 PS-25 (MAX.) INCANDESCENT DOWNLIGHTS



Detailed Photometry - Installed Fixture

FROM I.T.L. (BOULDER, CO)

RS20933 (150W): TEST NUMBER 47034
RS20933 (100W): TEST NUMBER 47035
RS21234 (300W): TEST NUMBER 47037

RS20933

150 WATT

EFFICIENCY = 45.9%

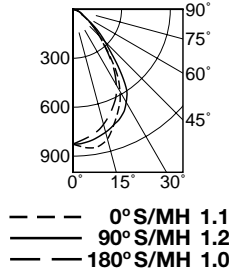

CANDLEPOWER DISTRIBUTION					
	0.0	45.0	90.0	135.0	180.0
0	826	826	826	826	826
5	850	843	821	806	799
15	823	824	780	742	730
25	668	693	716	641	616
35	466	491	562	451	436
45	230	273	280	256	228
55	107	122	115	119	107
65	47	59	58	59	54
75	21	19	25	21	26
85	0	0	0	0	0
90	0	0	0	0	0

COEFFICIENTS OF UTILIZATION						
RF	20					
	80			50		
RC	70	50	30	10	50	10
1	51	50	48	47	47	46
2	48	45	43	41	43	41
3	45	41	38	36	39	37
4	42	37	34	31	36	31
5	39	34	31	28	33	28
6	36	31	28	25	30	25
7	34	29	25	23	28	23
8	33	27	23	21	26	21
9	30	25	22	19	24	21
10	28	23	20	18	22	18

RS20933

100 WATT

EFFICIENCY = 43.2%

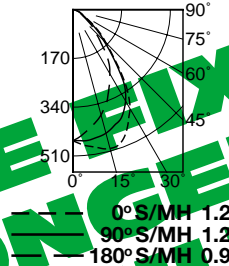

CANDLEPOWER DISTRIBUTION					
	0.0	45.0	90.0	135.0	180.0
0	457	457	457	457	457
5	475	472	459	441	434
15	501	489	446	395	380
25	451	455	408	327	299
35	323	330	309	247	215
45	163	180	182	183	111
55	76	76	76	61	59
65	49	38	34	30	28
75	13	15	11	9	11
85	0	0	0	0	0
90	0	0	0	0	0

COEFFICIENTS OF UTILIZATION						
RF	20					
	80			50		
RC	70	50	30	10	50	10
1	48	47	45	44	44	42
2	45	42	40	38	40	37
3	42	38	35	33	36	33
4	39	35	32	30	33	29
5	36	32	29	26	31	26
6	34	29	26	24	28	24
7	32	27	24	22	26	21
8	30	25	22	20	24	20
9	28	23	20	18	23	18
10	27	22	19	17	21	17

RS21234

300 WATT

EFFICIENCY = 61.6%

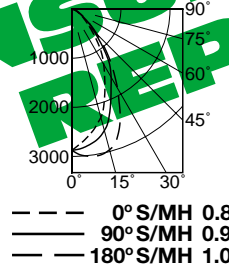

CANDLEPOWER DISTRIBUTION					
	0.0	45.0	90.0	135.0	180.0
0	2877	2877	2877	2877	2877
5	2699	2744	2828	2952	2998
15	2285	2379	2560	2842	2965
25	1586	1782	1889	2264	2326
35	1027	1209	1322	1519	1434
45	506	672	656	833	732
55	254	301	296	363	338
65	115	141	137	166	143
75	51	50	59	60	64
85	2	1	1	1	0
90	0	0	0	0	0

COEFFICIENTS OF UTILIZATION						
RF	20					
	80			50		
RC	70	50	30	10	50	10
1	69	67	65	63	62	60
2	64	61	58	55	58	53
3	60	55	52	48	53	50
4	56	51	46	43	48	47
5	53	46	42	39	45	41
6	49	43	38	35	41	38
7	47	40	35	32	38	35
8	44	37	33	30	36	32
9	41	34	30	27	33	29
10	39	32	28	25	31	28

Options

- 13 Clear 1/8" flat polycarbonate below, with prismatic flat C#73 lens above. (RS20933 only)
- 18 Anopal flat glass. Not enameled. Diffusing.
- 20 White 1/2" cube eggcrate aluminum louver instead of lens.
- 27 Clear 1/4" tempered glass beneath prismatic C#73 flat lens, for vandal resistance.
- 40 White grooveless flare trim with regressed tempered C#73 or specify optional lens.
- 45 Gasket between trim and ceiling.
- 46 Gasket between trim and lens.
- 58 277/120V stepdown transformer for 277 volt line input, prewired into fixture.
- 94 Custom color trim assembly. Consult factory.
- 99 Special modification. Consult factory.
- FR Fresnel tempered lens. Concentric prisms.

SUBMITTAL DATA

APPROVAL STAMP

JOB NAME _____

TYPE _____

WATTAGE _____ VOLTAGE _____

CATALOG NUMBER _____

THESE FIXTURES ARE AVAILABLE FOR LONGER LEAD TIMES. CONSULT FACTORY FOR REPLACEMENTS.

LIMITED WARRANTY: CATALOGED KIRLIN FIXTURES ARE WARRANTED FREE OF DEFECTS IN WORKMANSHIP OR MATERIAL FOR THREE YEARS FROM DATE OF PURCHASE. INSTALLATION, ETC., IS NORMAL USE. Manufacturer at his option will replace or repair such fixture or refund the purchase price on presentation of proof of purchase and defective fixture at the offices of manufacturer within the first year of original shipment. Liability of manufacturer is limited to the foregoing, and manufacturer shall not be liable for any other damages, direct or indirect, sustained or suffered by purchaser or any person. This warranty is supplied for the fixture and does not cover other warranties expressed or implied. Seller does not warrant as to merchantability or fitness for a particular use, nor liability or statement constitute a warranty or amend this specific warranty. Abnormal use, abuse of fixture, improper installation, or repair, or modification of the fixture without prior written authorization from the manufacturer will void this warranty void.