

CATALOG #	TYPE	
JOB NAME	WATTAGE	VOLTAGE

8" x 8" 1 A21 150 WATT MAXIMUM

RS00844

MRI Recessed K-Lens Square: Efficient and Shallow

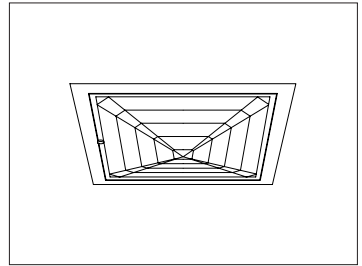

Features

Non-Magnetic Lamp/Socket

- Designed for: 150 watt (max.) A-21 frosted incandescent lamp (by others).
- Dimmable (controls by others).
- For operation on D.C. circuits.
- Glazed porcelain medium base horizontal socket. Nickel plated brass screw shell. Silicone leads.

Reflector

- GlasSurfaced™ multi-faceted specular aluminum. Highly efficient.

Trim Assembly

- Tempered prismatic shock resisting spread Kirlin lens. See Options for other lens / trim.
- Non-magnetic rustfree polished nickel stainless door (304-L) and captive thumb screw. Slender with concealed hinges for fast relamping.
- Attractively beveled cast aluminum frame rooled to ensure close fit with door. White acrylic finish.

Housing

- Cool. Acrylic enameled 100% aluminum.

- Rustproof: Exceeds 1000 hour ASTM 5% salt spray test.
- Dissipates heat across entire surface area.
- Entire luminaire visible and serviceable from below through hinged door.

Outlet Box

- Prewired. 100% aluminum. UL listed.
- Accessible. 1/2" and 3/4" knockouts.

Installation

- Lightweight. Recesses in any ceiling type. For wet plaster, see Option -47.
- 27" aluminum hanger bars supplied (2).
- Fully adjustable universal non-magnetic mounting brackets supplied (2).

UL C-UL (Canada) Listings

- Wet, damp or dry locations, covered ceilings.
- Through-branch circuit conductors (up to 6 #12). Supply wire rating, 90°C.

Three Year Limited Warranty

- Complete standard fixture.

Thermal Protection (Per Current NEC)

- Thermal protector included which provides automatic cut-off if rated temperature is exceeded. (Insulation related)

Recessed Square
K-Lens
MRI

THIS FIXTURE IS NO LONGER AVAILABLE FOR AN ALTERNATIVE PLEASE CONSULT FACTORY

NOT RESTRICTED TO END-OF-RUN USE

Performance at a Glance

RS00844

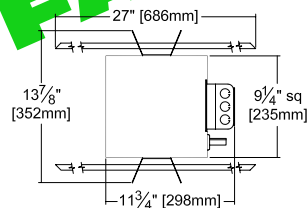
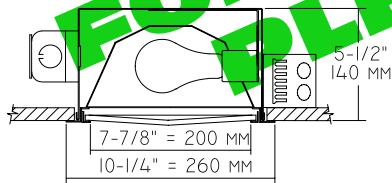

Ceiling Cut-out
9 1/2" Sq.

Cone of Light Key
Ft. Distance from fixture
FC Footcandles at nadir (0°)
Dia. Circle of light at 50% of FC

* Dia. (in ft.) shown is where FC value is half the FC at nadir.

RS00844 (150 Watt)

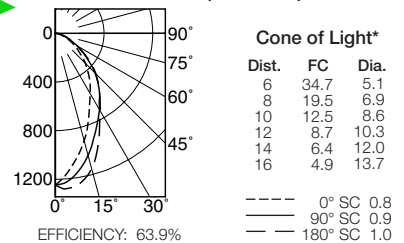

RS00844-15 (150 Watt)

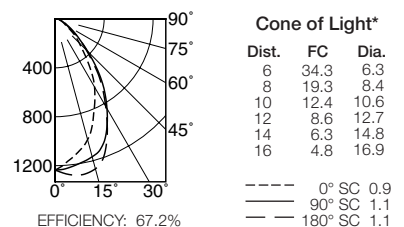

THE KIRLIN COMPANY

3401 EAST JEFFERSON AVENUE • DETROIT, MICHIGAN 48207-4232
(313) 259-6400 • Fax: (313) 259-9409 OR (313) 259-3121 • www.kirlinlighting.com

HEALTHCARE FACILITY
& PATIENT LIGHTING

MAXIMUM WATTAGE

1 A21 150

CATALOG NUMBER

RS00844

DUE TO OUR CONTINUING EFFORT TO IMPROVE PRODUCTS, TECHNICAL INFORMATION IS SUBJECT TO CHANGE WITHOUT NOTICE.

Detailed Photometry - Installed Fixture

Photometry from I.T.L., Boulder, CO

RS00844 (150 Watt)

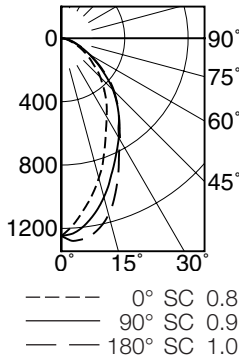

EFFICIENCY : 63.9%

CANDLEPOWER DISTRIBUTION					
	0.0	45.0	90.0	135.0	180.0
0	1248	1248	1248	1248	1248
5	1149	1167	1218	1268	1278
15	913	905	1038	1100	1152
25	663	649	815	819	859
35	497	474	634	596	639
45	349	326	461	392	470
55	215	205	278	236	287
65	113	118	144	130	150
75	48	54	56	62	70
85	11	15	13	17	21
90	3	4	4	5	8

COEFFICIENTS OF UTILIZATION							
RF	20						
RC	80			50			
RW	70	50	30	10	50	30	10
1	71	68	66	64	64	62	61
2	66	61	57	54	58	55	53
3	61	55	51	47	52	49	46
4	56	50	45	41	47	43	40
5	52	45	40	37	43	39	36
6	49	41	36	33	40	35	32
7	46	38	33	30	37	32	29
8	43	35	30	27	34	30	27
9	40	33	28	25	32	27	25
10	38	30	26	23	30	25	23

ITL TEST #47019

RS00844-15 (150 Watt)

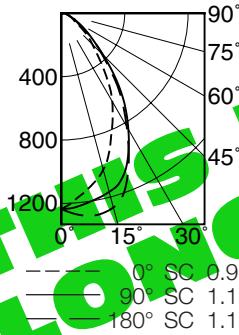

EFFICIENCY : 67.2%

CANDLEPOWER DISTRIBUTION					
	0.0	45.0	90.0	135.0	180.0
0	1236	1236	1236	1236	1236
5	1169	1188	1223	1266	1277
15	922	908	1167	1250	1269
25	764	889	996	1122	1008
35	503	640	694	764	664
45	277	354	376	401	360
55	140	171	187	188	172
65	75	89	89	97	94
75	40	50	50	54	51
85	11	13	16	16	19
90	0	0	0	0	0

COEFFICIENTS OF UTILIZATION							
RF	20						
RC	80			50			
RW	70	50	30	10	50	30	10
1	75	72	70	68	68	66	65
2	70	65	62	59	62	59	57
3	65	59	55	51	56	53	50
4	60	54	49	45	51	48	44
5	56	49	44	41	47	43	40
6	52	45	40	37	44	39	36
7	50	42	37	33	40	36	33
8	47	39	34	30	37	33	30
9	44	36	31	28	35	31	28
10	41	34	29	26	33	29	26

ITL TEST #47018

Options

- 14 Dropped Anopal glass. 1-1/4" deep. Not enameled.
- 15 Tempered prismatic flat C#73 lens instead.
- 18 Anopal flat glass. Not enameled. Diffusing.
- 20 Louver, aluminum, egg-crate. 1/2" cube. White.
- 27 Clear 1/4" tempered glass with C#73 above for added vandal resistance.
- 32 Trim extender. Broadens trim flange O.D. by 1" to cover larger ceiling opening.
- 45 Gasket between trim and ceiling.
- 46 Gasket between lens and trim.
- 94 Custom color frame finish. Consult factory.
- 99 Special modification. Consult factory.
- TC Teflon safety coating for standard or -15 lens. Consult factory for other lenses.

SUBMITTAL DATA

APPROVAL STAMP

JOB NAME
TYPE
WATTAGE
VOLTAGE
CATALOG NUMBER

THIS FIXTURE IS NO LONGER AVAILABLE FOR AN ALTERNATIVE PLEASE CONTACT FACTORY

LIMITED WARRANTY: CATALOGED KIRLIN FIXTURES ARE WARRANTED FREE OF DEFECTS IN WORKMANSHIP OR MATERIAL FOR THREE YEARS FROM DATE OF PURCHASE. INSTALLED TO N.E.C. / IN-NORMAL USE. Manufacturer at this option will replace or repair each fixture or refund the purchase price on presentation of proof of purchase and defective fixture at the offices of manufacturer within three years of original shipment. Liability of manufacturer is limited to the foregoing, and manufacturer shall not be liable for any other damages, direct or indirect, sustained or suffered by purchaser or any person. This warranty is supplied in the box in place of all other warranties, expressed or implied. Seller does not warrant as to merchantability or fitness for a particular use, nor will any oral statement constitute a warranty or amend this specific warranty. Abnormal use, abuse of the fixture, improper installation, or repair, or modification of the fixture without prior written authorization from the manufacturer will render the warranty void.