

High Output Downlight for Higher Ceilings

Outstanding Efficiency with Visual Comfort

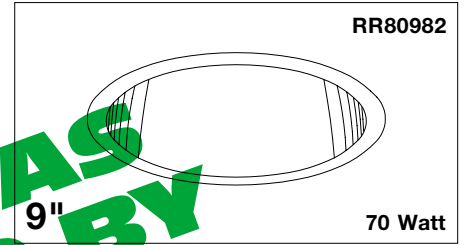

Features

Lamp

- Designed for one 4-pin triple tube amalgam compact fluorescent lamp: 70W triple.

Ballast: Multi-Voltage

- Electronic high power factor, thermally protected. For lower wattages: Option -49.
- 120-277 multi-volt; 50/60 Hz.
- QuickConnect connectors for easy service.
- Cold weather -22°F (-30°C).
- End of lamp life protection circuit. RFI filter. THD less than 10%.
- Internally fused. Also see Option -FS.

Reflector

- Low iridescence (L.I.) specular Alzak® aluminum, one piece, self-flanged.
- See Options for others.

Aluminum Housing

- Acrylic enameled. Rustproof. Exceeds 1000 hour ASTM 5% salt spray test.

- Lightweight. Minimizes ceiling load.
- Cool operation. Extends component life.
- Entire luminaire serviced through aperture.
- Built-in plaster frame.

Outlet Box

- Prewired 14 GA (NEC) galvanized steel, UL listed. 1/2" and 3/4" knockouts.

Installation

- 27" galvanized hanger bars with adjustable mounting brackets (2) supplied.
- Recesses indoor or outdoor in covered locations.

UL, C-UL (Canada) Listings

- Wet, damp or dry locations, covered ceilings.
- Through-branch conductors (6 #12).

Three Year Limited Warranty

- Complete standard fixture and ballast.

Performance at a Glance

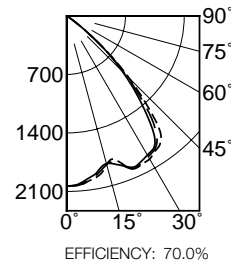
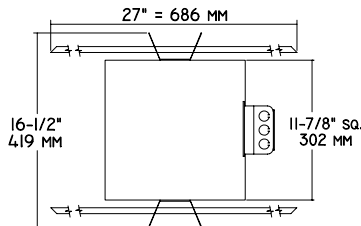
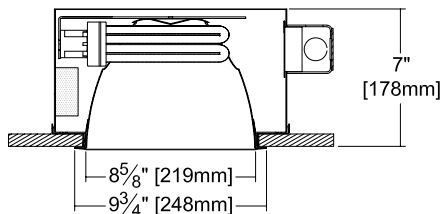

Cone of Light*

Dist.	FC	Dia.
6	56.6	8.4
8	31.8	11.2
10	20.4	14.0
12	14.1	16.8
14	10.4	19.7
16	8.0	22.5

--- 0° SC 1.4
 - - - 45° SC 1.4
 ——— 90° SC 1.4

Cone of Light Key

Dist. Distance from fixture
FC Footcandles (average)
Dia. Circle of light at 50% of FC

* Dia. (in ft.) shown is where FC value is half the FC at nadir.

THE KIRLIN COMPANY

3401 EAST JEFFERSON AVENUE • DETROIT, MICHIGAN 48207-4232
 (313) 259-6400 • Fax: (313) 259-9409 OR (313) 259-3121 • www.kirlinlighting.com

SECOND CENTURY SERIES
 TRIPLE TUBE
 COMPACT FLUORESCENT LIGHTING

MAXIMUM WATTAGE

CATALOG NUMBER

70

RR80982

THE KIRLIN COMPANY RESERVES THE RIGHT TO CHANGE, WITHOUT NOTICE, DETAILS OR SPECIFICATIONS IN PRODUCT DESIGN.

Alzak® is a registered trademark of ALCOA.

Detailed Photometry - Installed Fixture

FROM I.T.L. (BOULDER, CO) RR80982: TEST #54851
RR80982-43: TEST #54942

RR80982 70W

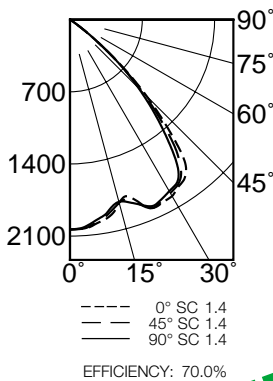

*LER = 43.2

•AEC = \$5.56

CANDLEPOWER DISTRIBUTION					
	0.0	22.5	45.0	67.5	90.0
0	2036	2036	2036	2036	2036
5	2026	2022	2020	2002	2002
15	1840	1854	1838	1823	1830
25	1998	1969	1991	1935	1975
35	1911	1884	1869	1810	1834
45	1051	1049	995	958	939
55	64	67	77	76	91
65	2	2	2	2	2
75	0	0	0	0	0
85	0	0	0	0	0
90	0	0	0	0	0

C.U. (Coefficients of Utilization) Tables are available on request. Please contact your Kirlin representative.

RR80982-43 57W

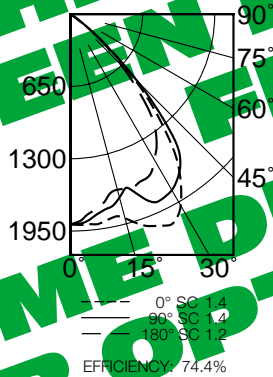

*LER = 44.0

•AEC = \$5.45

CANDLEPOWER DISTRIBUTION					
	0.0	45.0	90.0	135.0	180.0
0	1890	1890	1890	1890	1890
5	1895	1903	1861	1829	1805
15	1899	1832	1707	1599	1634
25	2095	1904	1860	1590	1626
35	1707	1796	1716	1485	1349
45	786	875	857	705	646
55	57	47	45	67	73
65	2	3	2	4	2
75	0	0	0	0	0
85	0	0	0	0	0
90	0	0	0	0	0

• AEC = Annual Energy Cost (kWh) (based on 3000 hours use @ 0.10/kWh)

* LER (Luminaire Efficacy) = Total Lamp Lumens x Ballast Factor / Input Watts

THIS FIXTURE HAS BEEN REPLACED BY RR-09008 SOME DESIGN FEATURES OR OPTIONS MAY HAVE CHANGED

Options

Wattage and Voltage

- 39 Installed electronic dimming ballast. Indoor use only. 10°C (50°F) minimum start. Please specify wattage and voltage; consult factory for 57 or 70 watt or to request brand.
- 43 Lower wattage for 4-pin 57W triple or 42/32/26W triple.
- 75 Remote emergency battery pack. Test switch and indicator light in reflector. Damp location. Ambient temp. limits: 0°-50°C (32°-122°F). Specify voltage.
- 97 Specify other voltage. Consult factory.
- 98 347 volt, 50/60 Hz. input. Consult factory.
- GT Generator transfer device. Damp location. Ambient temp. limits: 0°-50°C (32°-122°F). Specify voltage.

Trims

- 31 White acrylic enameled reflector flange.
 - 32 White oversize trim ring. Specify O.D.
 - 33 Decorative Glow Ring trim assembly suspended beneath trim. See pages 6-7.
 - 45 Gasket between ceiling and reflector flange.
 - 70 SofTex Clear reflector. (CP x .93)
 - 71 SofTex Dune reflector. (CP x .87)
 - 77 SofTex Pewter reflector. (CP x .85)
 - 79 Extension collar for ceilings up to 2" thick.
 - 82 Sloped ceiling adapter. Specify slope in 5° increments up to 30°.
 - 90 SofTex Champagne Gold reflector. (CP x .90)
 - 91 SofTex Wheat reflector. (CP x .87)
 - 94 Custom color/finish. Specify. Consult factory.
- ShatterGuard™ Shield (Beneath Lamp)**
- 17 Prismatic high strength acrylic.
 - SG Clear polycarbonate.

Other

- 99 Special modification. Consult factory.
- FS Additional in-line fuse.
- LE With 4-pin electronic lamp. 3500°K standard. 82 CRI and 12,000 hour life. Specify wattage, style and color temperature.
- RF Radio frequency interference (RFI) filter.
- WC Wireless dimming control. Use with -39. Consult factory.
- WD Wall dimmer. Use with Option -39. Consult factory.

SUBMITTAL DATA

APPROVAL STAMP

JOB NAME _____

TYPE _____

WATTAGE _____ VOLTAGE _____

CATALOG NUMBER _____

LIMITED WARRANTY: CATALOGUED KIRLIN FIXTURES ARE WARRANTED FREE OF DEFECTS IN WORKMANSHIP OR MATERIAL FOR THREE YEARS FROM DATE OF PURCHASE. INSTALLATION IN NORMAL USE. Manufacturer at his option will replace or repair such fixture or refund the purchase price or replacement of good of purchase and defective fixture at the office of manufacturer within three years of original shipment. Liability of manufacturer is limited to the foregoing, and manufacturer shall not be liable for any damages, direct or indirect, sustained or suffered by purchaser or any person. This warranty is supplied to the buyer in place of all other warranties, expressed or implied. Seller does not warrant as to mechanical ability or fitness for a particular use, or warranty of any kind, or shall not constitute a warranty of any kind or assume any liability. A normal use, abuse of the fixture, improper installation, or regular, or modification of the fixture without prior written authorization from the manufacturer will render this warranty void.