

# Shallow Plenum Triple Tube Wall Washes

## Features

### Lamp

- Designed for:
  - 1 horizontal Triple Tube 42 watt: RR80754.
  - 2 horizontal Triple Tube 42 watt: RR80755.
- 4 pin GX24q-4 base.
- See Option -43 for lower wattage.

### Ballast

- Regulating electronic high power factor ballast, thermally protected, enclosed in a thermally protected, enclosed, aluminum housing.
- Cold weather. -18°C (-0.4°F) to 50°C (122°F).
- Built-in RIF filter. Total harmonic distortion < 10%.
- Single circuit ballast. Optional two circuit ballast wiring for RR80755; see Option -43.
- 120 volt standard ballast. Optional voltages.
- See Option -43 for wiring availability.
- Visit [www.kirlin.com](http://www.kirlin.com) for service in all states.
- Available as Option -43. See -FD.

### Reflector Assembly

- Etched and anodized outer reflector for uniform wall washing.
- Self-flanged low iridescent aluminum inner reflector.
- Reflector assembly adjusts for precise wall washing. Optional double beam (100W).
- Optional SofTex soft coating. Clear, Dune, Champagne, and White. And all white custom color reflectors available.

### Housing

- Acrylic enameled 100% aluminum housing.
- Rustproof: Exceeds 1000 hours of 5% salt spray test.
- Cool. Dissipates heat across entire surface area and ventilated.
- Removable reflector assembly. Removable reflector assembly.
- Powder coated. 14GA (NEC) aluminum housing. UL listed. Acceptable for outdoor use.
- Built-in mounting frame.

### Installation

- 2" hanger bars supplied (2).
- Fully adjustable universal mounting brackets supplied (2).
- Reflector and socket bracket adjustable. See Option -43 for separation. (RR80754)
- Recesses indoor or outdoor. Recessed ceilings.

### UL Classification Listings

- Wet, damp or dry location. Type I, II, III.
- Through-the-ceiling. (6 #12).

### Three Year Limited Warranty

- Standard fixture.

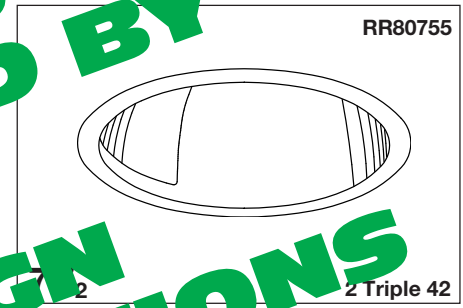
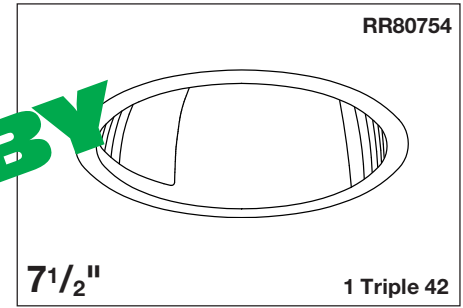

RR80754 HAS BEEN REPLACED BY FRR-07025-43  
RR80755 HAS BEEN REPLACED BY FRR-07026  
SOME DESIGN FEATURES OR OPTIONS MAY HAVE CHANGED

## Performance at a Glance

RR80754

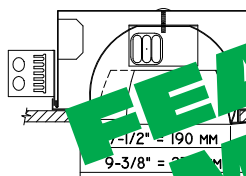

RR80755

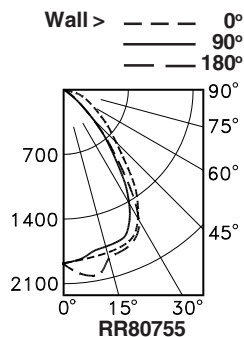
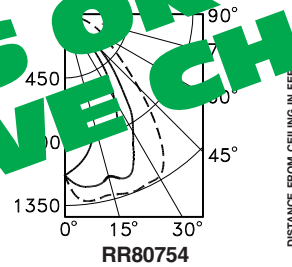
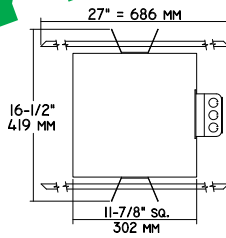
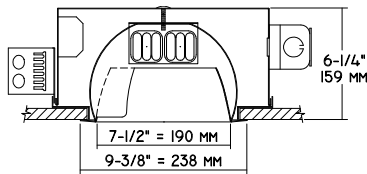

DISTANCE FROM CEILING IN FEET	SINGLE FIXTURE				MULTIPLE FIXTURES						
	1'	2'	3'	4'	3' CENTERS	4' CENTERS	4' CENTERS	4' CENTERS			
FIXTURE INSTALLED 3" FROM WALL Footcandle Distribution on Wall Surface											
1	11.7	9.1	5.0	2.7	1.8	20.7	19.5	20.6	17.4	14.0	17.3
2	15.8	11.5	6.1	3.1	1.9	26.3	24.8	26.2	22.1	17.6	22.0
3	20.7	16.6	8.5	3.7	2.0	33.8	33.6	33.7	27.8	23.7	27.8
4	19.9	17.4	11.4	5.6	2.6	36.8	37.3	36.7	28.8	28.0	28.8
5	14.7	13.6	10.7	6.9	3.5	33.6	33.5	33.4	25.4	26.3	25.3
6	10.4	9.9	8.5	6.6	4.2	28.8	28.4	28.6	21.9	22.3	21.8
7	7.6	7.2	6.6	5.5	4.1	24.2	24.1	23.9	18.9	18.8	18.8
8	5.8	5.6	5.2	4.6	3.7	20.8	20.7	20.4	16.4	16.3	16.3
9	4.7	4.6	4.3	3.9	3.4	18.5	18.4	18.1	14.6	14.7	14.5

DISTANCE FROM CEILING IN FEET	SINGLE FIXTURE				MULTIPLE FIXTURES						
	1'	2'	3'	4'	3' CENTERS	4' CENTERS	4' CENTERS	4' CENTERS			
FIXTURE INSTALLED 3" FROM WALL Footcandle Distribution on Wall Surface											
1	16.4	13.4	8.2	5.0	3.3	31.1	29.7	31.1	25.9	21.9	25.9
2	20.1	16.2	9.9	5.9	3.7	36.9	35.0	36.9	30.8	25.5	30.8
3	25.2	21.3	12.7	6.7	3.9	43.8	43.7	43.8	36.4	31.4	36.4
4	24.0	21.4	14.9	8.7	4.8	46.9	47.5	46.9	37.1	36.1	37.1
5	18.3	17.1	13.8	9.5	5.8	43.3	43.7	43.3	33.4	34.5	33.4
6	13.6	13.0	11.3	8.9	6.2	38.2	38.1	38.2	29.7	30.0	29.7
7	10.3	10.0	9.0	7.6	6.0	33.0	33.2	33.0	26.3	26.2	26.3
8	8.1	7.9	7.3	6.5	5.5	28.9	29.2	28.9	23.2	23.2	23.2
9	6.7	6.6	6.2	5.7	5.0	26.1	26.3	26.1	21.0	21.2	21.0

# THE KIRLIN COMPANY

3401 EAST JEFFERSON AVENUE • DETROIT, MICHIGAN 48207-4232  
(313) 259-6400 • Fax: (313) 259-9409 OR (313) 259-3121 • [www.light-link.com/kirlin](http://www.light-link.com/kirlin)

**SECOND CENTURY SERIES  
TRIPLE TUBE  
COMPACT FLUORESCENT LIGHTING**

MAXIMUM WATTAGE

**1 Triple 42  
2 Triple 42**

CATALOG NUMBERS

**RR80754  
RR80755**

THE KIRLIN COMPANY RESERVES THE RIGHT TO CHANGE, WITHOUT NOTICE, DETAILS OR SPECIFICATIONS IN PRODUCT DESIGN.

Alzak® is a registered trademark of ALCOA.

Detailed Photometry - Installed Fixture

FROM I.T.L. (BOULDER, CO) RR80754: TEST NUMBER 47219  
RR80755: TEST NUMBER 47220

RR80754

\*LER = 36.1  
•AEC = \$6.64

CANDLEPOWER DISTRIBUTION

	0.0	90.0	180.0	270.0
0	1151	1151	1151	1151
5	1305	1231	1054	1197
15	1322	1189	850	1118
25	1334	1077	894	939
35	1187	808	514	585
45	707	337	52	3
55	354	90	1	3
65	215	27	13	
75	90	0	0	
85	0	0	0	
90	0	0	0	

COEFFICIENTS OF UTILIZATION

RF	20							
	80			50				
RC	70	50	30	10	50	30	10	
RW	1	67	65	63	62	61	60	59
	2	63	59	56	54	56	54	52
	3	59	54	51	47	51	48	46
	4	55	50	47	42	47	44	41
	5	51	47	44	38	43	40	37
	6	47	42	37	34	40	36	34
	7	45	38	34	31	37	33	31
	8	42	36	31	28	35	31	28
	9	40	33	29	26	32	28	26
	10	38	31	27	24	30	26	24

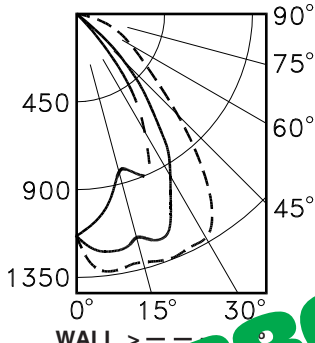

WALL > --- 90°  
--- 75°  
--- 60°  
--- 45°  
0° 15° 30°  
EFFICIENCY = 60.2%

RR80755

\*LER = 29.5  
•AEC = \$8.1

CANDLEPOWER DISTRIBUTION

	0.0	90.0	180.0	270.0
0	1840	1863	1877	1877
5	1840	1863	1877	1877
15	1840	1863	1877	1877
25	1840	1863	1877	1877
35	1840	1863	1877	1877
45	1840	1863	1877	1877
55	1840	1863	1877	1877
65	1840	1863	1877	1877
75	1840	1863	1877	1877
85	1840	1863	1877	1877
90	1840	1863	1877	1877

COEFFICIENTS OF UTILIZATION

RF	20							
	80			50				
RC	70	50	30	10	50	30	10	
RW	1	55	53	52	50	50	49	48
	2	51	48	46	44	46	44	42
	3	48	44	41	38	42	39	37
	4	45	40	37	34	38	36	34
	5	42	37	34	31	35	33	31
	6	40	35	30	28	32	30	28
	7	38	31	28	26	30	27	25
	8	35	28	24	23	28	25	23
	9	33	26	23	21	26	23	21
	10	31	25	22	20	24	21	19

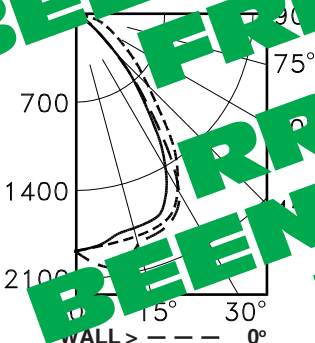

WALL > --- 90°  
--- 75°  
--- 60°  
--- 45°  
--- 30°  
--- 15°  
--- 0°  
--- 180°  
EFFICIENCY = 49.2%

Options

- 30 All white inner reflector, self-flanged inner reflector.
- 31 White reflector trim, self-flanged inner reflector.
- 32 Trim extender. Replaces the O.D. by 1" to cover the inner reflector.
- 39 Installed with dimming ballast. Consult factory for use with 18 watt ballast and type required. Also see Option -LE, and -WD. Indoor use.
- 43 Lower wattage triple tube: Specify 1-32, 1-26 or 1-18 (RR80754); 2-32, 2-26 or 2-18 (RR80755).
- 45 Gasket above reflector flange. Stops dust streaks on ceiling.
- 58 277 volt 60 Hz. ballast instead.
- 70 SofTex Clear softly etched self-flanged inner reflector. Resists smudges. (CP x .87)
- 71 SofTex Champagne Gold softly etched self-flanged inner reflector. Resists smudges. (CP x .90)
- 72 SofTex Pewter softly etched self-flanged inner reflector. Resists smudges. (CP x .87)
- 73 SofTex Umber softly etched self-flanged inner reflector. Resists smudges. (CP x .87)
- 74 SofTex Custom color softly etched self-flanged inner reflector. Resists smudges. (CP x .87)
- 75 SofTex Clear softly etched self-flanged inner reflector. Resists smudges. (CP x .87)
- 76 SofTex Champagne Gold softly etched self-flanged inner reflector. Resists smudges. (CP x .90)
- 77 SofTex Pewter softly etched self-flanged inner reflector. Resists smudges. (CP x .87)
- 78 SofTex Umber softly etched self-flanged inner reflector. Resists smudges. (CP x .87)
- 79 Extension collar for up to 2" thick ceilings.
- 84 Fixture RR80755 wired for two circuits. Also see Option -FD.
- 90 SofTex Champagne Gold softly etched self-flanged inner reflector. Resists smudges. (CP x .90)
- 91 SofTex Wheat softly etched self-flanged inner reflector. Resists smudges. (CP x .87)
- 94 Specular Pewter or Umber or other specified custom color self-flanged inner reflector. Consult factory.
- 97 Other voltage ballast. Consult factory.
- 98 347 volt 60 Hz. ballast instead. Consult factory for dimming.
- 99 Special modification. Consult factory.
- DW Double wall wash. 180° opposite.
- FD Double Fused primary (RR80755 only). Replaceable. Use with -84.
- FS Fused primary. Replaceable. Aids servicing.
- LE With 4-pin electronic Triple Tube amalgam lamp. 82 CRI and 10,000 hour life. 3500°K or consult factory for 2700°K, 3000°K, 4100°K. Specify wattage and color temperature.
- WD Wall Dimmer for use with Option -39. Consult factory for use with 18 watt.

SUBMITTAL DATA

APPROVAL STAMP

JOB NAME \_\_\_\_\_  
 TYPE \_\_\_\_\_  
 WATTAGE \_\_\_\_\_ VOLTAGE \_\_\_\_\_  
 CATALOG NUMBER \_\_\_\_\_

RR80754 HAS BEEN REPLACED BY FRR-07025-43  
 RR80755 HAS BEEN REPLACED BY FRR-07026  
 SOME DESIGN FEATURES OR OPTIONS MAY HAVE CHANGED

\* LER = Luminaire Efficacy Rating  
 LER = Luminaire Efficacy x Total Lamp Lumens x Ballast Factor  
 Input Watts

\* AEC = Annual Energy Cost per 1000 lumens  
 (based on 3000 hours use @ \$0.08 KWH)

LIMITED WARRANTY: CATALOGUED KIRLIN FIXTURES ARE WARRANTED FREE OF DEFECTS IN WORKMANSHIP OR MATERIAL FOR THREE YEARS FROM DATE OF PURCHASE. INSTALLATION, IN-NORMAL USE, MANUFACTURER AT HIS OPTION WILL REPAIR OR REPLACE SUCH FIXTURE OR RETURN THE PURCHASE PRICE ON PRESENTATION OF PROOF OF PURCHASE AND DEFECTIVE FIXTURE AT THE OFFICE OF MANUFACTURER WITHIN THE REAR YEARS OF ORIGINAL INPEMENT. LIABILITY OF MANUFACTURER IS LIMITED TO THE FOREGOING, AND MANUFACTURER SHALL NOT BE LIABLE FOR ANY OTHER DAMAGES, DIRECT OR INDIRECT, SUSTAINED OR SUFFERED BY PURCHASER OR ANY PERSON. THIS WARRANTY IS SUPPLIED FOR THE EXCLUSIVE PLACE OF OTHER WARRANTIES, EXPRESSED OR IMPLIED. SELLER DOES NOT WARRANT AS TO MERCHANTABILITY OR FITNESS FOR A PARTICULAR USE, NOR WILL ANY STATEMENT CONSTITUTE A WARRANTY OF AIDMENT OF THIS SPECIFIC WARRANTY. ABNORMAL USE, ABUSE OF FIXTURE, IMPROPER INSTALLATION, OR REPAIR, OR MODIFICATION OF THE FIXTURE WITHOUT PRIOR WRITTEN AUTHORIZATION FROM THE MANUFACTURER WILL VOID THIS WARRANTY.