

14-1/2"

REGRESSED LENS: AUDITORIUM / ATRIUM

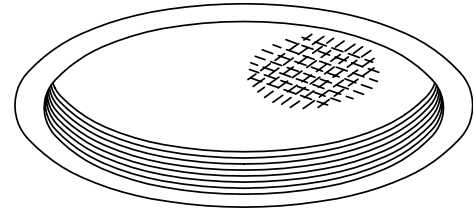

Features

Lamp

- Designed for 400 watt coated E/ED/BT-37 horizontal.
- See Option -43 for optional lower wattage.
- Option -23 for Mercury, Option -24 for HPS.

Socket

- Horizontal. Mogul base.
- Glazed porcelain.
- Nickel-plated brass screw shell. Silicone leads.

Reflector

- Specular Alzak® aluminum.

Trim Assembly

- Seamless tapered black OptiGroove with white flange.
- Self-flanged trim.
- UV absorbing tempered low brightness prismatic glass.
- Torsion springs retain snug fit to ceiling.

Ballast Assembly

- WhisperPack™ fully encapsulated 180°C rated HPF ballast.
- Premium Class H; CWA 10:10 regulation.
- Capacitor supplied.
- 120 volt standard or see optional voltages.
- Cool, quiet, long-life. Silicone leads.
- Visible and easily serviced in all ceilings including dry wall.

Fuse

- Fused primary. Renewable. Aids servicing.

Housing

- Acrylic enameled aluminum.

- Cool: Dissipates heat across entire surface area.
- Rustproof: Exceeds 1000 hour ASTM 5% salt spraytest.
- Entire luminaire serviced through removable trim assembly.
- Built-in plaster frame.

Outlet box

- Prewired 14 GA (NEC) galvanized steel, UL listed.
- Removable insulated cover.
- 1/2" and 3/4" knockouts.

Installation

- 27" galvanized channel bar hanger supplied (2).
- Fully adjustable universal mounting brackets supplied (2).
- Recesses indoor or outdoor in covered locations.

UL Listing

- Wet, damp or dry locations, covered ceilings.
- Through-branch circuit conductors (6 #12).

Three Year Limited Warranty

- Complete standard fixture.

Thermal Protection

- Per current NEC.

THIS FIXTURE HAS BEEN REPLACED BY HPR-13074. SOME DESIGN FEATURES OR OPTIONS MAY HAVE CHANGED

APPROVAL STAMP

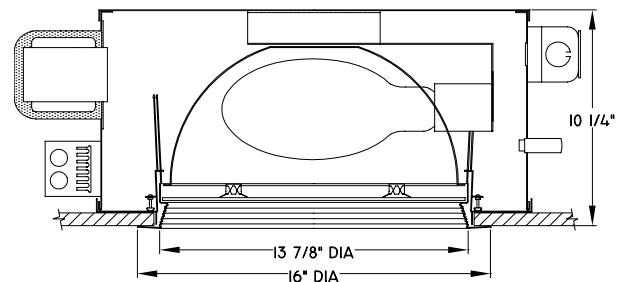
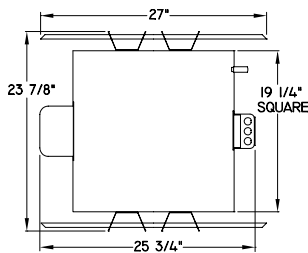

THE KIRLIN COMPANY

3401 EAST JEFFERSON AVENUE ■ DETROIT, MICHIGAN 48207-4232
(313) 259-6400 ■ FAX: (313) 259-9409 OR (313) 259-3121

**HIGH EFFICIENCY
METAL HALIDE LIGHTING**

LAMP WATTAGE
E/ED/BT-37 400

RR51484

RR51484 RECESSED ROUND: 400 WATT MOGUL BASE METAL HALIDE



Performance at a Glance - Installed Fixture

Cones of Light

Cone of Light Key

Ft. Distance to surface from fixture (mounting height)
FC Footcandles
DIA. Diameter (in feet) of the circle of light when FC value is half the FC at nadir.

Ft.	FC	DIA.
6	378.3	6.2
8	212.8	8.2
10	136.2	10.3
12	94.6	12.3
14	69.5	14.4
16	53.2	16.5

RR51484

Ft.	FC	DIA.
6	241.8	6.1
8	136.0	8.2
10	87.1	10.2
12	60.5	12.3
14	44.4	14.3
16	34.0	16.3

RR51484-32

Photometric Data - Installed Fixture

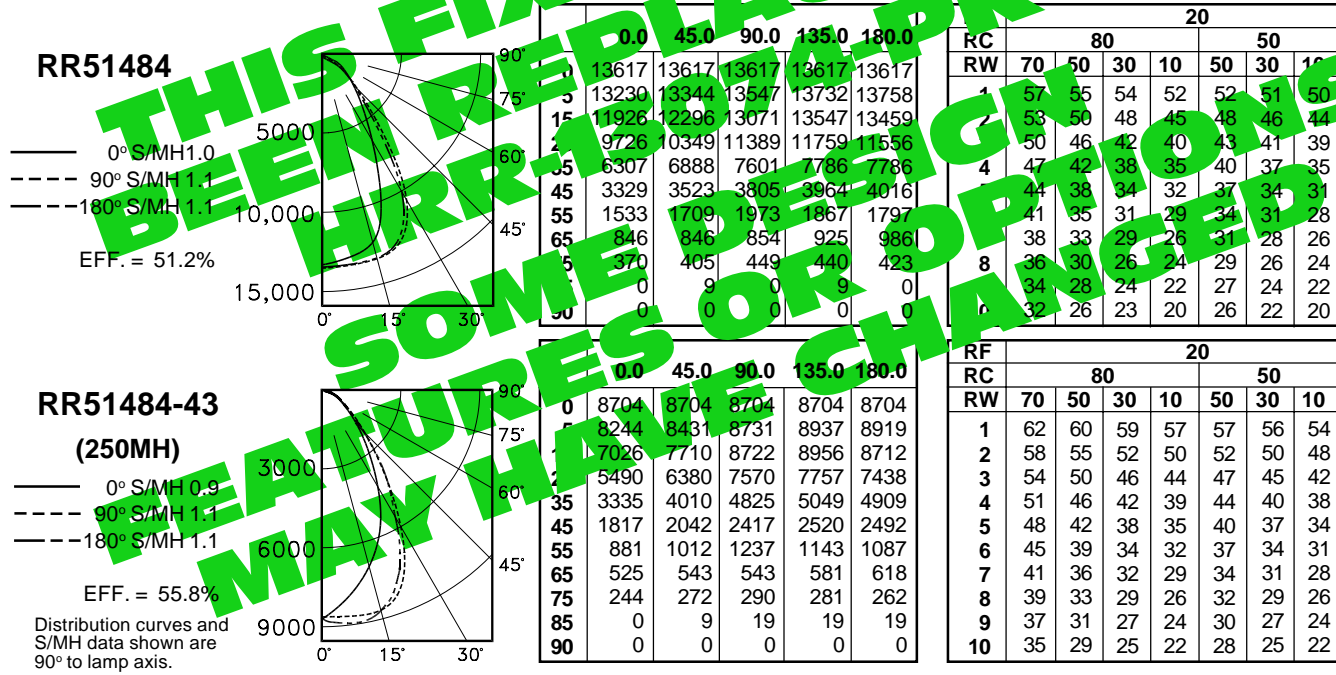

Options

- 23 Mercury ballast instead. 400 watt standard or see Option -43. Specify voltage.
- 24 HPS ballast instead. 400 watt standard or see Option -43. Specify voltage.
- 40 White grooveless flare trim assembly instead.
- 43 Lower wattage mogul base - specify voltage and wattage for: Metal Halide: 250, 175; Mercury: 250, 175; HPS: 250, 150.
- 45 Gasket above trim flange
- (between trim and ceiling).
- 46 Gasket between trim and lens.
- 49 Extra circuit DCB socket. (250 watt max.) Must not be energized simultaneously with main source.
- 58 277 volt 60 Hz. ballast instead.
- 65 Relay and DCB socket. (250 watt max.) With fixture energized, provides immediate light during HID outage. Also see Option -66.
- 66 Time delay relay and DCB socket. (250 watt max.) When energized, provides light until HID reaches 70% output.
- 94 Custom color trim assembly.
- Consult factory.
- 97 Other voltage ballasts. Consult factory.
- 99 Special modification. Consult factory.
- FT Flat white trim with UV absorbing tempered prismatic glass instead.
- LP With lamp. Specify source, wattage, color temperature, and clear or coated (3200°K standard for MH). Consult factory for other color temperatures.
- LS With tungsten halogen standby lamp. (250 watt max.) Use only with Options -49, -65 or -66.

THE KIRLIN COMPANY

3401 EAST JEFFERSON AVENUE ■ DETROIT, MICHIGAN 48207-4232
(313) 259-6400 ■ FAX: (313) 259-9409 OR (313) 259-3121

RR51484

WATTAGE

400

LAMP

E/ED/BT-37

HIGH EFFICIENCY
METAL HALIDE LIGHTING

LIMITED WARRANTY: CATALOGUED KIRLIN FIXTURES ARE WARRANTED FREE OF DEFECTS IN WORKMANSHIP OR MATERIAL FOR THREE YEARS FROM DATE OF PURCHASE. INSTALLATION TO N.E.C. IN NORMAL USE. Manufacturer at his option will replace or repair such fixture or refund the purchase price on presentation of proof of purchase and defective fixture at the office of manufacturer within three years of original shipment. Liability of manufacturer is limited to the foregoing. A manufacturer, dealer or distributor shall not be liable for any other damages, direct or indirect, sustained or suffered by purchaser of any person. This warranty is applied to the buyer in place of the manufacturer's, dealer's, distributor's, or other printed literature. Seller does not warrant that the fixture is suitable for the intended use or that the fixture will be used for the intended use. Abuse of the fixture, improper installation, or repair, or modification of the fixture without prior written authorization from the manufacturer will render the warranty void.