

Regressed Lens: Streamlined Depth

Features

Lamp

- 100 watt coated E/ED-17 universal.
- See Option -43 for optional lower wattage.
- Option -23 for Mercury, Option -24 for HPS.

Socket

- Horizontal. Medium base pulse rated.
- Glazed porcelain.
- Nickel-plated brass screw shell. Silicone leads.

Reflector

- Specular Alzak® aluminum.

Trim Assembly

- Seamless tapered black OptiGroove with white flange.
- Self-flanged trim.
- UV absorbing tempered low brightness prismatic glass.
- Torsion springs retain snug fit to ceiling.
- Optional white grooveless flare assembly instead (Option -40).

Ballast Assembly

- WhisperPack™ fully encapsulated 180°C rated HPF ballast.
- Premium Class H; high reactance 5:12 regulation.
- Capacitor and ignitor supplied.
- 120 volt standard or see optional voltages.

- Cool, quiet, long-life. Silicone leads.

- Visible and easily serviced in all ceilings including dry wall.

Fuse

- Fused primary. Renewable. Aids servicing.

Housing

- Acrylic enameled aluminum.
- Cool. Dissipates heat across entire surface area.
- Rustproof: Exceeds 1000 hour ASTM 5% salt spray test.
- Entire luminaire serviced through removable trim assembly.
- Built-in plaster frame.

Outlet Box

- Prewired 14 GA (NEC) galvanized steel. UL listed.

- Removable insulated cover.
- 1/2" and 3/4" knockouts.

Installation

- 27" galvanized channel bar hanger supplied (2).
- Fully adjustable universal mounting brackets supplied (2).
- Recesses indoor or outdoor in covered locations.

UL Listing

- Wet, damp or dry locations, covered ceilings.
- Through-branch circuit conductors (6#12).

Three Year Limited Warranty

- Complete standard fixture.

Thermal Protection

- Per current NEC.

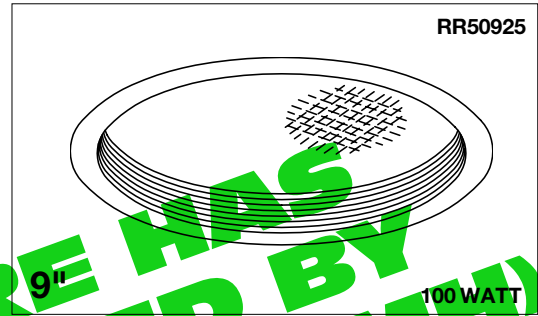

THIS FIXTURE HAS BEEN REPLACED BY RR-0807243 (100W MH) FEATURES OR OPTIONS MAY HAVE CHANGED

Performance at a Glance

RR50925

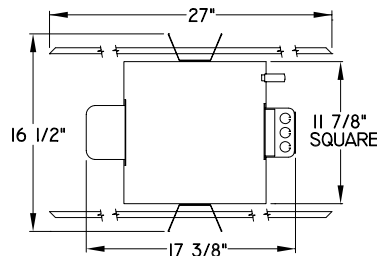
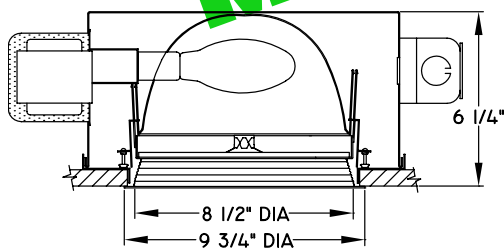

Cone of Light*

Ft.	FC	Dia.
6	80.3	6.3
8	45.2	8.4
10	28.9	10.5
12	20.1	12.6
14	14.8	14.7
16	11.3	16.8

RR50925

Cone of Light*

Ft.	FC	Dia.
6	129.0	4.7
8	72.6	6.3
10	46.4	7.8
12	32.3	9.4
14	23.7	11.0
16	18.1	12.6

RR50925-FR

Cone of Light*

Ft.	FC	Dia.
6	96.2	5.6
8	54.1	7.5
10	34.6	9.3
12	24.0	11.2
14	17.7	13.1
16	13.5	14.9

RR50925-HO

Cone of Light Key

- Ft. Mounting height
 - FC Footcandles
 - Dia. Circle of light at 50% of FC
- * Dia. (in ft.) shown is where FC value is half the FC at nadir.
- Distribution curves and S/MH data shown are 90° to lamp axis.

THE KIRLIN COMPANY

3401 EAST JEFFERSON AVENUE • DETROIT, MICHIGAN 48207-4232
(313) 259-6400 • Fax: (313) 259-9409 OR (313) 259-3121

HIGH EFFICIENCY
METAL HALIDE
LIGHTING

LAMP

WATTAGE

CATALOG NUMBER

E/ED-17

100

RR50925

THE KIRLIN COMPANY RESERVES THE RIGHT TO CHANGE, WITHOUT NOTICE, DETAILS OR SPECIFICATIONS IN PRODUCT DESIGN.

Detailed Photometry - Installed Fixture

RR50925

— 0° S/MH 1.0
 - - - 90° S/MH 1.2
 - · - 180° S/MH 1.0
 EFFICIENCY = 55.2%

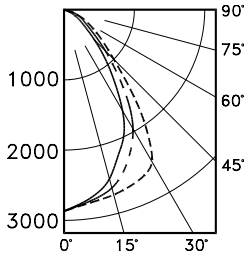

CANDLEPOWER DISTRIBUTION					
	0.0	45.0	90.0	135.0	180.0
0	2892	2892	2892	2892	2892
5	2852	2837	2875	2861	2847
15	2503	2604	2771	2683	2592
25	2018	2268	2676	2402	2196
35	1340	1650	2040	1737	1496
45	671	818	1014	861	720
55	305	396	485	409	325
65	167	171	174	179	169
75	44	51	59	49	38
85	0	0	0	0	0
90	0	0	0	0	0

COEFFICIENTS OF UTILIZATION							
RF	20						
	80		50				
RC	70	50	30	10	50	30	10
1	62	60	58	57	56	55	54
2	58	54	52	49	52	49	48
3	54	49	46	43	47	44	42
4	50	45	41	38	43	40	38
5	47	41	37	34	40	36	34
6	44	38	34	31	37	33	31
7	41	35	31	28	34	30	28
8	39	32	28	24	31	27	26
9	37	30	26	22	28	24	22
10	35	28	24	20	26	22	20

RR50925-FR

— 0° S/MH 0.7
 - - - 90° S/MH 0.9
 - · - 180° S/MH 0.9
 EFFICIENCY = 60.9%

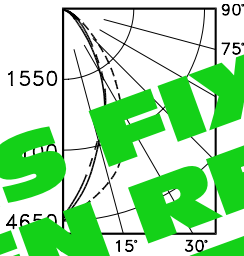

CANDLEPOWER DISTRIBUTION					
	0.0	45.0	90.0	135.0	180.0
0	4644	4644	4644	4644	4644
5	4347	4371	4465	4411	4371
15	2983	3161	3988	3201	2901
25	1961	2312	3121	2312	1961
35	1151	1371	1677	1318	1151
45	602	683	897	624	602
55	383	508	651	451	383
65	202	160	157	154	202
75	96	96	96	96	96
85	0	0	0	0	0
90	0	0	0	0	0

COEFFICIENTS OF UTILIZATION							
RF	20						
	80		50				
RC	70	50	30	10	50	30	10
1	63	61	60	58	57	56	54
2	59	55	53	49	52	49	48
3	56	51	49	45	49	46	44
4	53	47	44	40	45	42	39
5	50	43	39	36	41	38	36
6	47	40	36	33	38	35	33
7	44	36	32	29	35	30	28
8	42	33	29	26	32	28	26
9	40	31	27	24	29	26	24
10	38	29	25	22	27	24	22

RR50925-HO

— 0° S/MH 1.1
 - - - 90° S/MH 1.1
 - · - 180° S/MH 0.9
 EFFICIENCY = 63.8%



CANDLEPOWER DISTRIBUTION					
	0.0	45.0	90.0	135.0	180.0
0	3462	3462	3462	3462	3462
5	3296	3344	3438	3384	3296
10	2721	2861	3459	2870	2570
15	2079	2379	2875	2247	2079
20	1449	1749	2149	1749	1449
25	932	1132	1449	1132	932
30	513	613	802	613	513
35	279	329	449	329	279
40	157	187	247	187	157
45	87	107	147	107	87
50	45	55	75	55	45
55	23	28	38	28	23
60	12	15	20	15	12
65	6	8	11	8	6
70	3	4	6	4	3
75	1	2	3	2	1
80	0	0	0	0	0
85	0	0	0	0	0
90	0	0	0	0	0

COEFFICIENTS OF UTILIZATION							
RF	20						
	80		50				
RC	70	50	30	10	50	30	10
1	65	64	62	60	59	57	55
2	62	59	57	55	54	52	50
3	59	55	53	49	51	48	46
4	56	52	49	44	48	45	43
5	54	47	42	39	45	41	38
6	50	43	38	35	42	38	35
7	47	40	35	32	38	34	32
8	44	37	32	29	36	32	29
9	42	34	30	27	33	29	26
10	39	32	28	25	31	27	24

THIS FIXTURE HAS BEEN REPLACED BY HPR-08072-43 (100W MH) SOME DESIGN FEATURES OR OPTIONS MAY HAVE CHANGED

Distribution data shown are based on lamp axis.

Options

- 23 Mercury ballast instead. 100ME standard or see Option -43. Specify voltage.
- 24 HPS ballast instead. 100ME standard or see Option -43. Specify voltage.
- 26 Tamper-proof trim. Flush recessed hex screws with center pin secure trim to housing. Continuous ring and four screws secure lens. One key provided/ten fixtures. Also see Option -27.
- 27 Clear 1/4" tempered glass beneath prismatic flat lens, for vandal resistance. Also see Option -26.
- 29 White Son ballast instead. For ED-17 medium base lamp. 100 watt standard in 120 volt only. Consult factory for 277 volt.
- 40 White grooveless flare trim assembly instead.
- 43 Lower wattage medium base - specify voltage and wattage for: Metal Halide: 70, 50; Mercury: 75, 50; HPS: 70, 50, 35; White Son: 50.
- 45 Gasket above trim flange (between trim and ceiling).
- 46 Gasket between trim and lens.
- 49 Extra circuit DCB socket. (100W max.) Must not be energized simultaneously with main source.
- 58 277 volt 60 Hz. ballast instead.
- 65 Relay and DCB socket. (100W max.) With fixture energized, provides immediate light during HID outage. Also see Option -66.
- 66 Time delay relay and DCB socket. (100W max.) When energized, provides light until HID reaches 70% output.
- 94 Custom color trim assembly. Consult factory.
- 97 Other voltage ballasts. Consult factory.
- 99 Special modification. Consult factory.
- FR Fresnel tempered lens instead. Concentric prisms.
- FT Flat white trim instead. Standard with UV absorbing tempered prismatic glass or add Option -FR or -HO.
- HO Holophane tempered concave prismatic lens instead.
- LP With lamp. Specify source, wattage, color temperature, and clear or coated (3200°K standard for MH). Consult factory for other color temperatures.
- LS With tungsten halogen standby lamp. (100 watt max.) Use only with Options -49, -65 or -66.

SUBMITTAL DATA

APPROVAL STAMP

JOB NAME _____

TYPE _____

WATTAGE _____ VOLTAGE _____

CATALOG NUMBER _____

LIMITED WARRANTY: CATALOGUED KIRLIN FIXTURES ARE WARRANTED FREE OF DEFECTS IN WORKMANSHIP OR MATERIAL FOR THREE YEARS FROM DATE OF PURCHASE. INSTALLATION TO BE COMPLETED BY AN INDUSTRY PROFESSIONAL. THE PURCHASER'S OBLIGATION IS TO PROVIDE PROPER INSTALLATION AND MAINTENANCE. THE MANUFACTURER SHALL NOT BE LIABLE FOR ANY DAMAGES, DIRECT OR INDIRECT, SUSTAINED OR SUFFERED BY THE PURCHASER OR ANY PERSON. THIS WARRANTY IS APPLIED TO THE FIXTURE IN PLACE AT THE TIME OF PURCHASE AND DOES NOT COVER REPAIRS, REPLACEMENTS, OR MODIFICATIONS TO THE FIXTURE WITHOUT PRIOR WRITTEN AUTHORIZATION FROM THE MANUFACTURER. SEE THE WARRANTY CARD FOR FULL DETAILS.