

## Low Brightness PAR 38 Designer Series

### Features

#### Lamp/Socket

- Designed for 250 watt (max.) PAR 38 tungsten halogen lamp (by others).
- Rated 4200 hour life. 100 CRI.
- Glazed porcelain medium base socket. Nickel plated brass screw shell. Silicone leads.
- Dimmable (controls by others).

#### Trim

- Self-flanged parabolic specular Alzak® aluminum reflector.
- Optional reflector colors and finishes available, see Options.

#### Housing

- Cool. Acrylic enameled 100% aluminum.
- Rustproof: Exceeds 1000 hours of ASTM 5% salt spray test.
- Dissipates heat from its entire surface area extending component life.
- Entire luminaire visible, removable trim.
- For top trim see Option -TA.
- Built-in power frame. Also see Option -79.

#### Outlet Box

- Prewired 14 GA (NEC) galvanized steel with removable insulated cover. UL listed.
- 1/2" and 3/4" knockouts.

#### Installation

- 27" galvanized hanger bars supplied (2).
- Fully adjustable universal galvanized mounting brackets supplied.
- Recesses into ceiling in covered ceiling.

#### UL (Canada) Listings

- Damp or dry location listed.
- Ceilings.
- Through the wall, circuit conductors not over 14 AWG (G). Use supplementary listing for over 90°C.

#### Three Year Limited Warranty

- One year on hard fixture.
- **Overheat Protection (Per Customer)**
- Thermal protector included which provides automatic cut-off if temperature is exceeded (insulation related).

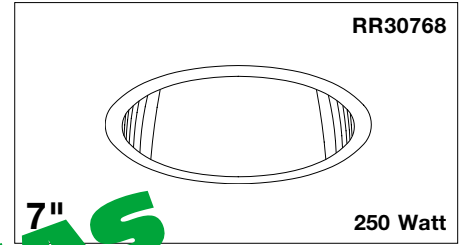

90-79% Efficiency

THIS FIXTURE HAS BEEN REPLACED BY IRR-07084 SOME DESIGN FEATURES OR OPTIONS MAY HAVE CHANGED

### Performance at a Glance

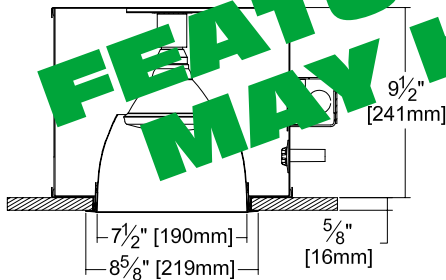

(250W FL Shown)

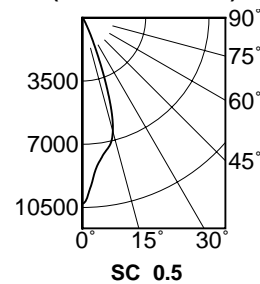

#### Cone of Light\*

Dist.	FC	Dia.
6	286.0	3.5
8	160.9	4.7
10	103.0	5.9
12	71.5	7.1
14	52.5	8.3
16	40.2	9.4

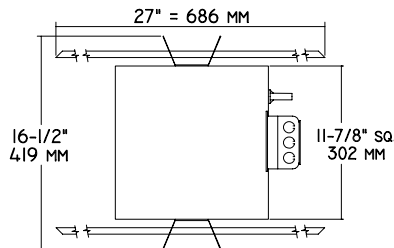

#### Cone of Light Key

- Dist. Distance from fixture
- FC Footcandles (average)
- Dia. Circle of light at 50% of FC

\* Dia. (in ft.) shown is where FC value is half the FC at nadir.

## THE KIRLIN COMPANY

3401 EAST JEFFERSON AVENUE • DETROIT, MICHIGAN 48207-4232  
 (313) 259-6400 • Fax: (313) 259-9409 OR (313) 259-3121 • www.kirlinlighting.com

NEW MILLENNIUM

TUNGSTEN HALOGEN and  
 INCANDESCENT LIGHTING

LAMP

PAR 38

MAXIMUM WATTAGE

250

CATALOG NUMBER

RR30768

DUE TO OUR CONTINUING EFFORT TO IMPROVE PRODUCTS, TECHNICAL INFORMATION IS SUBJECT TO CHANGE WITHOUT NOTICE.

Alzak® is a registered trademark of ALCOA.

## RR30768

## RECESSED ROUND: 250 WATT (MAX.) PAR 38 TUNGSTEN HALOGEN

### Detailed Photometry - Installed Fixture

FROM I.T.L. (BOULDER, CO) RR30768 (250W FL): TEST #47281  
(120W FL): TEST #47282

#### RR30768 - 250W PAR 38 FL

#### CANDLEPOWER DISTRIBUTION

#### COEFFICIENTS OF UTILIZATION

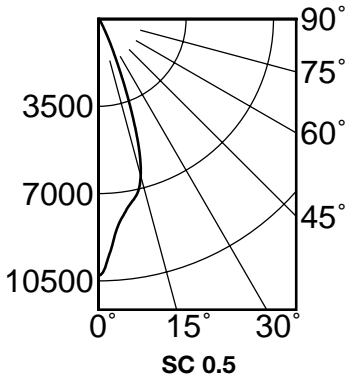

	0.0	22.5	45.0	67.5	90.0
0	10296	10296	10296	10296	10296
5	8437	8437	8437	8437	8437
15	6504	6504	6504	6504	6504
25	1225	1225	1225	1225	1225
35	178	178	178	178	178
45	39	39	39	39	39
55	0	0	0	0	0
65	0	0	0	0	0
75	0	0	0	0	0
85	0	0	0	0	0
90	0	0	0	0	0

RF	20					
	80			50		
	70	50	30	10	50	10
RC						
RW						
1	104	102	100	99	97	95
2	100	97	94	92	93	91
3	97	92	89	86	89	86
4	94	88	85	82	86	83
5	90	85	82	78	82	79
6	87	82	79	74	81	76
7	85	79	76	71	77	73
8	82	76	73	68	74	71
9	79	73	70	66	72	68
10	77	70	67	64	69	66

EFFICIENCY = 90.7%

#### RR30768 - 120W PAR 38 FL

#### CANDLEPOWER DISTRIBUTION

#### COEFFICIENTS OF UTILIZATION

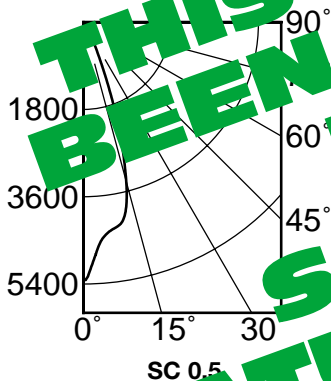

	0.0	22.5	45.0	67.5	90.0
0	5326	5326	5326	5326	5326
5	4483	4483	4483	4483	4483
15	3403	3403	3403	3403	3403
25	661	661	661	661	661
35	97	97	97	97	97
45	21	21	21	21	21
55	0	0	0	0	0
65	0	0	0	0	0
75	0	0	0	0	0
85	0	0	0	0	0
90	0	0	0	0	0

RF	20					
	80			50		
	70	50	30	10	50	10
RC						
RW						
1	105	103	100	98	96	93
2	102	99	96	93	91	88
3	99	95	92	89	87	84
4	95	90	87	84	82	79
5	91	86	83	79	83	80
6	88	82	79	75	80	77
7	85	79	76	72	78	74
8	83	76	72	70	75	72
9	80	74	70	67	73	69
10	78	71	67	65	70	67

EFFICIENCY = 91.6%

#### Estimated Luminaires

- 16 Champagne Gold specular Alzak®: CP x .98
- 70 SofTex Clear: CP x .98
- 90 SofTex Champagne Gold: CP x .98
- 30 White: CP x .98
- 71 SofTex Dune: CP x .95
- 91 SofTex Wheat: CP x .95
- 63 Dune Alzak: CP x .97
- 72 Black Alzak: CP x .80
- 93 Pewter Alzak: CP x .95
- 69 Wheat Alzak: CP x .97
- 77 SofTex Pewter: CP x .90

### Options

- 16 Champagne Gold specular Alzak trim. (CP x .98)
- 63 Dune specular Alzak trim. (CP x .97)
- 91 SofTex Wheat softly etched trim. (CP x .95)
- 30 White self-flanged trim. (CP x .98)
- 69 Wheat specular Alzak trim. (CP x .97)
- 93 Pewter specular Alzak trim. (CP x .95)
- 31 White flange (only) on self-flanged reflector.
- 70 SofTex Clear softly etched trim. (CP x .98)
- 94 Custom color trim. Consult factory.
- 32 White oversize trim ring. Specify O.D.
- 71 SofTex Dune softly etched trim. (CP x .95)
- 99 Special modification. Consult factory.
- 45 Gasket between trim flange and ceiling. Stops dust streaks on ceiling.
- 72 Black specular Alzak trim. (CP x .80)
- LP With PAR 38 lamp. Specify wattage, beam spread and color temperature.
- 58 277/120 volt stepdown transformer for 277 volt line input, prewired into fixture; with 277 volt thermal protector.
- 77 SofTex Pewter softly etched trim. (CP x .90)
- TA Top access; for servicing from above ceiling.
- 79 Extension collar for up to 2" thick ceilings.
- 82 Sloped ceiling adapter. Specify slope in 5° increments up to 30°.
- 90 SofTex Champagne Gold softly etched trim. (CP x .96)

### SUBMITTAL DATA

### APPROVAL STAMP

JOB NAME \_\_\_\_\_

TYPE \_\_\_\_\_

WATTAGE \_\_\_\_\_ VOLTAGE \_\_\_\_\_

CATALOG NUMBER \_\_\_\_\_

LIMITED WARRANTY: CATALOGUED KIRLIN FIXTURES ARE WARRANTED FREE OF DEFECTS IN WORKMANSHIP OR MATERIAL FOR THREE YEARS FROM DATE OF PURCHASE. INSTALLATION IN NORMAL USE. Manufacturer at this option will replace or repair such fixture or refund the purchase price or replacement of good of purchase and defective fixture at the office of manufacturer within three years of original shipment. Liability of manufacturer is limited to the foregoing, and manufacturer shall not be liable for any other damages, direct or indirect, sustained or suffered by purchaser or any person. This warranty is supplied to the buyer in place of all other warranties, expressed or implied. Seller does not warrant as to mechanical ability or fitness for a particular use, nor will any oral statement constitute a warranty or amend this specific warranty. Abnormal use, abuse of the fixture, improper installation or repair, or modification of the fixture without prior written authorization from the manufacturer will render this warranty void.