

Type IC 150 Watt Downlight: 7¹/₂" Alzak® Reflector

Features

Lamp / Socket

- Designed for:
Vertical 150 watt (max.) A-21 inside frosted incandescent lamp (by others).
- Dimmable (controls by others).
- Glazed porcelain medium base socket.

Reflector

- Self-flanged compound curved specular Alzak aluminum.
- Ten optional self-flanged colors and finishes available. See Options.

Housing

- Acrylic enameled 100% aluminum.
- Rustproof: Exceeds 1000 hour ASTM 5% salt spray test.
- Cool: Dissipates heat across entire surface area.
- Entire luminaire visible and serviceable from below through removable reflector.
- Built-in plaster frame. Also see Option -79.

Outlet Box

- Prewired 14GA (NEC) galvanized steel. UL

listed. With removable insulated cover.

- 1/2" and 3/4" knockouts.

Installation

- 27" galvanized hanger bars supplied (2).
- Fully adjustable universal galvanized mounting brackets supplied (2). Accepts 3/4" or 1-1/4" lathers channel or 1/2" T.S. conduit.

- Recesses indoor or outdoor in covered ceilings.

UL, C-UL (Canada) Listings

- Wet, damp or dry locations, covered ceilings.
- Through-branch circuit conductors (6 #12 AWG 90°C).
- Type IC - Approved for direct contact with insulation.

Three Year Limited Warranty

- Complete standard fixture.

Thermal Protection (Per Current NEC)

- Thermal protector included which provides automatic cut-off if rated wattage is exceeded.

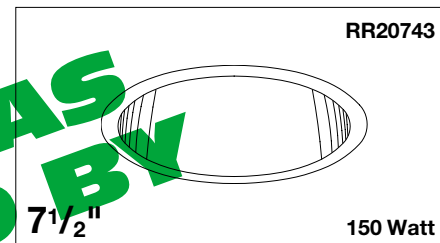

**High Efficiencies (71 - 73%)
with Low Brightness**

Popular Size and Wattage

10 Optional Reflector Finishes

Performance at a Glance

RR20743

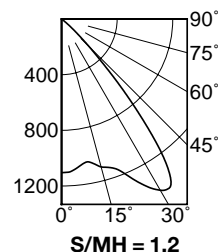
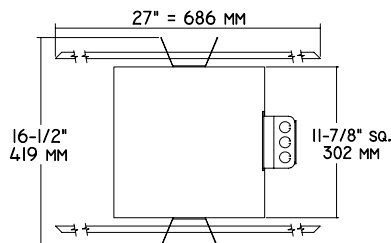
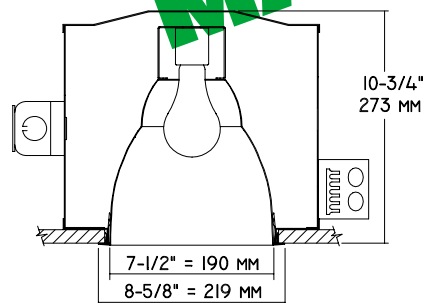

Cone of Light*

Ft.	FC	Dia.
6	30.7	9.2
8	17.3	12.3
10	11.0	15.4
12	7.7	18.5
14	5.6	21.6
16	4.3	24.6

Cone of Light Key

Ft. Distance from fixture
FC Footcandles (average)
Dia. Circle of light at 50% of FC

* Dia. (in ft.) shown is where FC value is half the FC at nadir.

THE KIRLIN COMPANY

3401 EAST JEFFERSON AVENUE • DETROIT, MICHIGAN 48207-4232
(313) 259-6400 • Fax: (313) 259-9409 OR (313) 259-3121

**NEW MILLENNIUM
TUNGSTEN HALOGEN and
INCANDESCENT LIGHTING**

LAMP

MAXIMUM WATTAGE

CATALOG NUMBER

A-21

150

RR20743

THE KIRLIN COMPANY RESERVES THE RIGHT TO CHANGE, WITHOUT NOTICE, DETAILS OR SPECIFICATIONS IN PRODUCT DESIGN.

Alzak® is a registered trademark of ALCOA.

Detailed Photometry - Installed Fixture

FROM I.T.L. (BOULDER, CO) TEST NUMBER 47259

RR20743 150W

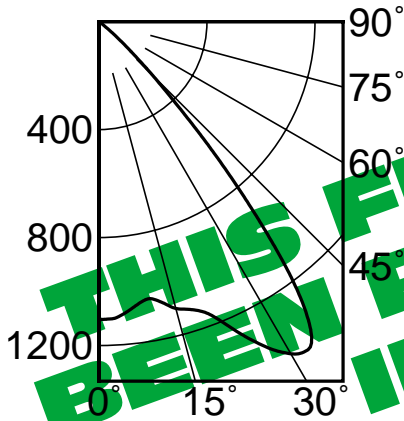

S/MH 1.2

EFFICIENCY = 72.4%

Estimated Multipliers

- 16 Champagne Gold Alzak: CP x .93
- 63 Dune Alzak: CP x .90
- 69 Wheat Alzak: CP x .88
- 70 SofTex Clear: CP x .90
- 71 SofTex Dune: CP x .81
- 90 SofTex Champagne Gold: CP x .84
- 91 SofTex Wheat: CP x .80
- 93 Pewter Alzak: CP x .85
- OG Black OptiGroove: CP x .75

CANDLEPOWER DISTRIBUTION

	0.0	22.5	45.0	67.5	90.0
0	1104	1104	1104	1104	1104
5	1085	1085	1085	1085	1085
15	1100	1100	1100	1100	1100
25	1289	1289	1289	1289	1289
35	1354	1354	1354	1354	1354
45	279	279	279	279	279
55	5	5	5	5	5
65	3	3	3	3	3
75	0	0	0	0	0
85	0	0	0	0	0
90	0	0	0	0	0

COEFFICIENT OF UTILIZATION

Room Dimensions	Room Dimensions	Room Dimensions	Room Dimensions	Room Dimensions	Room Dimensions	Room Dimensions
RW	7	8	10	12	15	20
1	82	80	78	76	75	72
2	77	73	70	67	69	65
3	72	67	63	60	64	58
4	68	62	57	54	59	53
5	64	57	52	49	55	48
6	60	52	48	44	51	43
7	56	48	43	40	47	40
8	53	45	40	36	44	36
9	50	42	37	33	40	33
10	47	39	34	31	38	30

Options

- 16 Champagne Gold specular Alzak self-flanged reflector. (CP x .93)
- 31 White flange (only) on self-flanged reflector.
- 32 Trim extender. Broadens trim flange O.D. by 1" to cover larger ceiling opening.
- 45 Gasket above reflector flange. Stops dust streaks on ceiling.
- 63 Dune specular Alzak self-flanged reflector. (CP x .90)
- 69 Wheat specular Alzak self-flanged reflector. (CP x .88)
- 70 SofTex Clear softly etched self-flanged reflector. Resists smudges. (CP x .90)
- 71 SofTex Dune softly etched self-flanged reflector. Resists smudges. (CP x .81)
- 79 Extension collar for up to 2" thick ceilings.
- 82 Sloped ceiling adapter. Specify slope in 5° increments up to 30°.
- 90 SofTex Champagne Gold softly etched self-flanged reflector. Resists smudges. (CP x .84)
- 91 SofTex Wheat softly etched self-flanged reflector. Resists smudges. (CP x .80)
- 93 Pewter specular Alzak self-flanged reflector. (CP x .85)
- 94 Specular or SofTex custom color/finish reflector, self-flanged. Consult factory.
- 99 Special modification. Consult factory.
- OG OptiGroove black seamless tapered aluminum reflector. White trim, self-flanged. (CP x .75)

SUBMITTAL DATA

APPROVAL STAMP

JOB NAME _____

TYPE _____

WATTAGE _____ VOLTAGE _____

CATALOG NUMBER _____